

Light and Circadian Rhythm  
Karrie Jacobs on the TWA Terminal  
Better Community Engagement  
An Acoustical Ceiling by LMN  
New Contract Furniture  
The Open Workshop: A Portfolio

architectmagazine.com  
The Journal of The American  
Institute of Architects

## Inside? Outside?

**Challenging conventions of  
enclosure and containment**

Dehlin Brattgård  
Jennifer Bonner / MALL  
John Ronan  
Koning Eizenberg  
Michael K Chen



MORE HIGH-IMPACT RESISTANCE







## MORE CONFIDENCE BUILT INTO EVERY VT DOOR

When you source a high-impact door from VT, you can be confident that it's built to the highest commercial standards. Now available in more styles and finishes including our new Palladium® Doors giving you even more impact resistant options. More durable. More beautiful. There's more to a VT door.



Palladium Door with Removable Edge, Cardinal 0236.

[vtindustries.com](http://vtindustries.com)  
© 2019 VT Industries, Inc. All rights reserved.



A rustic commercial space, likely a restaurant or cafe, featuring a prominent wooden staircase with a dark metal handrail and balustrade. The space is characterized by extensive wood paneling on the walls and ceiling, with exposed wooden beams. A mezzanine level is visible above the main dining area, also featuring wood railings. The dining area is furnished with wooden tables and black metal chairs. Warm, ambient lighting is provided by several pendant lights hanging from the ceiling. Large windows allow natural light to enter the space. The overall aesthetic is warm, inviting, and rustic.

WHAT ITALY DID FOR DESIGNER FASHION,  
**B&D BUILDERS DO FOR  
COMMERCIAL SPACES.**

*B&D*  
BUILDERS

custombarnbuilding.com • 717.687.0292





Private Residence, Chicago    Installing contractor: Custom Installations  
Architect: Kipnis Architecture + Planning    Distributor: Sheet Metal Supply    General contractor: Shardon Builders  
Photographer: A.J. Brown    Profile: Snap-Clad metal roofing    Color: Weathered Zinc

# Sustainable Success



"The Snap-Clad standing seam roof is just a nice element. It's so easy to attach solar panels to it – it's easy to clip on and it's raised up off the roof. We like the color selections and the Cool Roof technology in the finish."

-Nate Kipnis, FAIA, Principal, Kipnis Architecture + Planning



Case Study at [PAC-CLAD.COM/CHICAGO-RES](https://PAC-CLAD.COM/CHICAGO-RES)

[PAC-CLAD.COM](https://PAC-CLAD.COM) | [INFO@PAC-CLAD.COM](mailto:INFO@PAC-CLAD.COM)

IL: 800 PAC CLAD    MD: 800 344 1400    TX: 800 441 8661  
GA: 800 272 4482    MN: 877 571 2025    AZ: 833 750 1935





# A Contents

Volume 108, number 6, June 2019.

On the cover: *Boxen at the Swedish Centre for Architecture and Design, in Stockholm, designed by Dehlin Brattgård Arkitekter; Photo by Johan Dehlin.*

- 14 Modernism in America
- 16 Just Desserts
- 18 The Pragmatic Outlaw

## Tech + Practice

- 22 Best Practices: Making a Name for Yourself
- 26 Detail: Octave 9 Handcrafted Acoustical Ceiling
- 30 Next Progressives: The Open Workshop
- 34 Products: Contract Furniture
- 38 Opinion: Every Community Is Our Client
- 42 Architectural Lighting: The Merit or Myth of Circadian Lighting



- 48 Residential: MALL

## AIA Architect

- 61 Design for Communities, by Communities
- 63 Architecture Firm Billings by Fixed Fee and More
- 64 Finding a Way Home
- 67 Interiors Projects are Contractually Different. Here's Why.
- 69 In Kansas, Healthy Food for Healthier Communities
- 70 Social Justice by Design

## Columns

- 73 The Bittersweet Revival of Saarinen's TWA Terminal  
by Karrie Jacobs

## Editorial

- 112 Don't Ban Glass, Cap Emissions  
by Ned Cramer



- 86 John Ronan Architects



- 92 Michael K Chen Architecture



- 96 Dehlin Brattgård Arkitekter



- 102 Koning Eizenberg Architecture



# BUILDING LEGACIES.

© 2019 Kawneer Company, Inc.



Building on the past to advance the future. Kawneer solutions draw on a long history of innovation to create next-generation technologies that inspire architects, contractors and glaziers to create buildings with better performance, protection and productivity. At Kawneer we are always building. Build your legacy.



ARCHITECTURAL SYSTEMS  
ENTRANCES + FRAMING  
CURTAIN WALLS  
WINDOWS

[kawneer.com](http://kawneer.com)



Blade Butte Ranch, Hacker Architects, Photographer: Jeremy Bittermann, Joel B. Sanders Agency

# SOME VIEWS ARE WORTH A MORE CAREFULLY ENGINEERED WINDOW.

The way a window is made determines the way it will perform. That's why we make our own insulated glass with state-of-the-art glazing equipment, why we continuously upgrade our glass technology to address specific weather and environmental conditions, and why we use non-metal foam spacers that dramatically improve energy efficiency and seal integrity. Our no-compromise approach means every window and door we create is designed to withstand the elements, one stunning season after another.

[WWW.SIERRAPACIFICWINDOWS.COM](http://WWW.SIERRAPACIFICWINDOWS.COM) | 800-824-7744 | A DIVISION OF





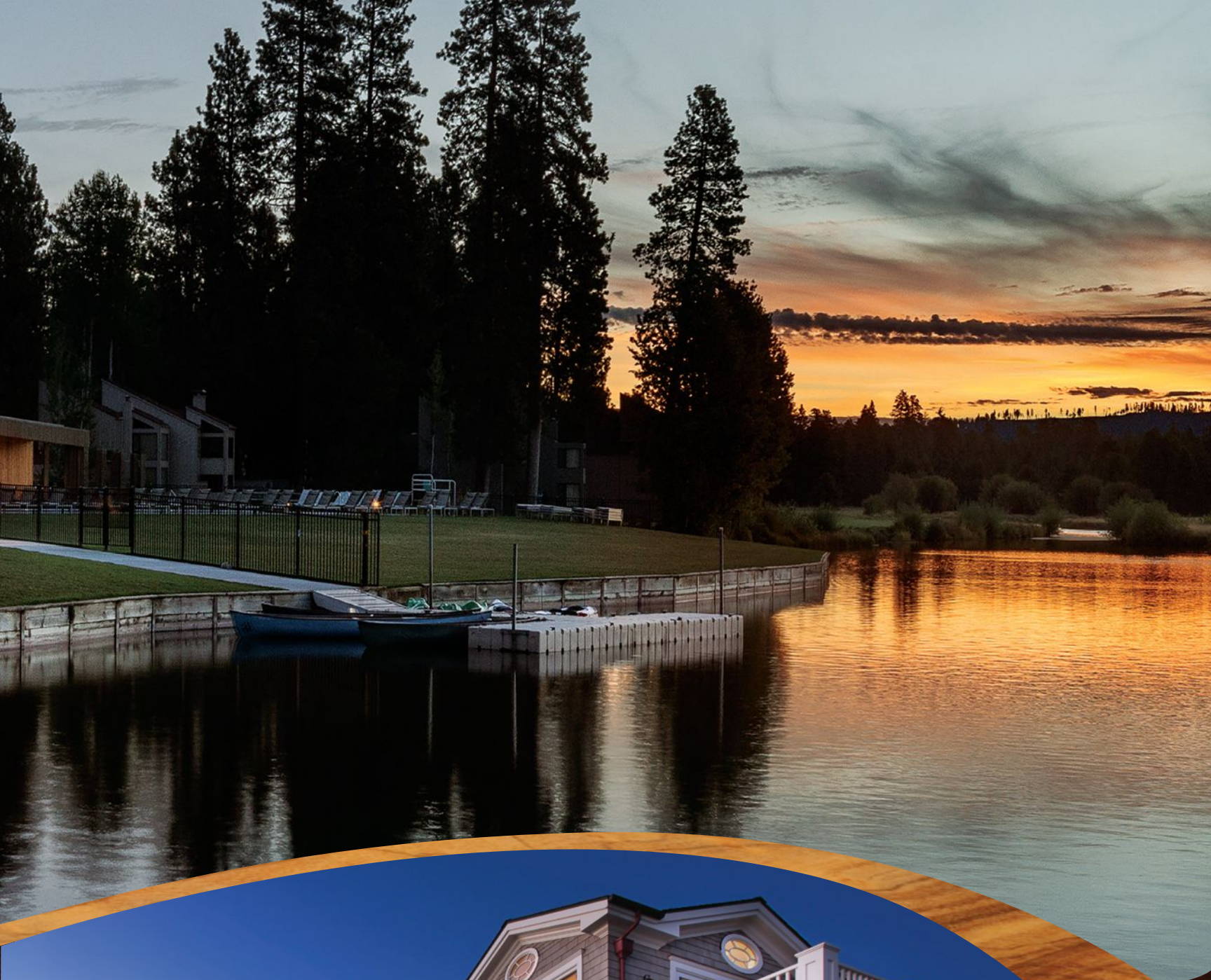

SIERRA  
PACIFIC  
WINDOWS



Facade Designer: SHoP Architects  
Structural Engineer and Facade Consultant: Thornton Tomasetti

# Instant Replay

With four consecutive Stanley Cup victories in its history, the **Nassau Veterans Memorial Coliseum** is a beloved fixture of Long Island life. When the owner of the 1972 arena decided to reward fans with a renovation worthy of its storied past, it reimagined the venue with an overcladding that would bring new life to the facility. With a design by **SHoP Architects** and **Thornton Tomasetti**, the new folded-ribbon facade of composite aluminum fins connects to the original structure with a minimum of intervention, ensuring thoughtful reuse of a venue that still has a lot of wins in its future. Read more about it in **Metals in Construction** online.

 **Ornamental Metal Institute of New York**

WWW.OMINY.ORG

## ARCHITECT

The Journal of The American  
Institute of Architects

### Editor-in-Chief

Ned Cramer, ASSOC. AIA  
ncramer@hanleywood.com  
@NedCramer

### Managing Editor

Greig O'Brien  
gobrien@hanleywood.com

### Design

Editor  
Katie Gerfen  
kgerfen@hanleywood.com

### Features

Senior Editor  
Eric Wills  
ewills@hanleywood.com

### Editorial Intern

Miabelle Salzano

### Technology and Practice

Editor  
Wanda Lau  
wlau@hanleywood.com  
@wandawlau

### Associate Editor

Katharine Keane  
kkeane@hanleywood.com

### Multimedia

Video Production Manager  
Lauren Honesty  
lhonesty@hanleywood.com

Videographer/Video Editor  
Daniel Tayag

### Art Director

Robb Ogle  
rogle@hanleywood.com

### Contributing Editors

Aaron Betsky  
Blaine Brownell, AIA  
Thomas de Monchau  
Elizabeth Evitts Dickinson  
John Morris Dixon, FAIA  
Eva Hagberg Fisher  
Thomas Fisher, ASSOC. AIA  
Cathy Lang Ho  
Karrie Jacobs  
Edward Keegan, AIA  
Ian Volner  
Mimi Zeiger

### Design Group

Executive Vice President, Build/Design Group  
Ron Spink  
rspink@hanleywood.com  
202.736.3431

### Vice President, Sales, Remodeling/Distribution/Design

Dan Colunio  
dcolunio@hanleywood.com  
617.304.7297

### Advertising

#### West

Director, Design Market  
Solutions  
Suren Sagadevan  
ssagadevan@hanleywood.com  
310.863.1153

#### Digital & Amplify Solutions Manager

Mattie Hanley  
mhanley@hanleywood.com  
202.380.3983

Account Coordinator  
Danielle Washington  
dwashington@hanleywood.com  
202.380.3719

#### Emerging Accounts

Sarah Mueller  
smueller@hanleywood.com  
202.736.3619

#### List Rentals

The Information Refinery  
Brian Clotworthy  
brian@info refinery.com  
800.529.9020

#### East

Director, Design Market  
Solutions  
Michael Gilbert  
mgilbert@hanleywood.com  
773.824.2435

#### Digital & Amplify Solutions Manager

Erika Taylor  
etaylor@hanleywood.com  
202.380.3942

Account Coordinator  
Heidi Pieroni  
hpieroni@hanleywood.com  
773.824.2457

#### Production

Senior Director,  
Print Production  
Margaret Coulter

#### Ad Production Coordinator

Bernadette Couture  
Inside Sales  
Ad Traffic Manager  
Annie Clark

#### Lighting/U.K. & Europe

Cliff Smith  
csmith@hanleywood.com  
864.642.9598

#### Canada

D. John Magner  
jmagner@yorkmedia.net  
416.598.0101, ext. 220

#### China, Hong Kong, Taiwan

Judy Wang  
judywang2000@vip.126.com  
86.13810325171

#### Hanley Wood University/ Education

Jim Bagan  
jbagan@hanleywood.com  
773.824.2428

#### Marketing

Vice President, Marketing  
Matthew Carollo

Audience Marketing  
Director  
Chris Lustan

Copyright 2019 by Hanley Wood. 1152 15th Street NW, Suite 750, Washington, DC 20005.  
202.452.0800. Reproduction in whole or in part prohibited without written authorization.  
All rights reserved. Printed in the USA.



# Nine more to go.

One in ten new apartments in the U.S. are  
being built with Latch.





Lead Design Firm: HNTB New York Engineering and Architecture PC  
Structural Engineer: WSP USA, New York, NY  
Photo: Skanska USA



# Kosciuszko à Gogo

The design of urban infrastructure affects city life as much as the design of its buildings. That's why replacing the **Kosciuszko Bridge**—a notorious pinch point in traffic between Brooklyn and Queens—was a high priority for Governor Cuomo. With heavy lifting from **HNTB**, **WSP USA**, and **Skanska**, a striking cable-stayed span has risen where the outdated bridge once stood, ensuring New Yorkers may still have trouble saying its name, but they never have trouble getting home. Read more about it in **Metals in Construction** online.

 **Steel Institute of New York**

WWW.SINY.ORG

## ARCHITECT

The Journal of The American Institute of Architects

### Hanley Wood Media

Chief Operating Officer  
Andrew Reid

Executive Vice President,  
Executive Programs  
Paul Tourbaf

Senior Vice President,  
Digital and Residential  
Construction  
Christie Bardo

Executive Vice President,  
Chief Content Officer  
Jennifer Pearce

Vice Presidents,  
Editorial  
Ned Cramer  
John McManus

Vice President,  
Digital Strategy and  
Operations  
Bridget Forbes

Executive Vice President,  
Operations  
Sarah Welcome

Vice President,  
Client Operations  
Mari Skelnik

Director of Analytics  
Jennifer Malkasian

### Hanley Wood

Chief Executive Officer  
Jeff Meyers

Executive Vice President,  
Marketing  
Dobby Gibson

Executive Vice President,  
National Sales  
Amy Dudley

Director of Sales,  
Emerging Accounts Group  
Philip Hernandez

Chief Financial Officer  
Melissa Billiter

Senior Managing Principal,  
Advisory Group  
Tim Sullivan

Vice President,  
Corporate Controller  
Keith Rosenbloom

Chief Operating Officer  
Andrew Reid

Group Vice President,  
Talent Strategy  
Kurt Nelson

Vice President,  
Finance  
Ron Kraft



The American  
Institute  
of Architects

### 2019 Board of Directors

William J. Bates, FAIA, President  
L. Jane Frederick, FAIA, First Vice President  
Jason C. Winters, AIA, Secretary  
Patrick P. Panetta, AIA, Treasurer  
Peter J. Exley, FAIA, At-Large Director  
Emily A. Grandstaff-Rice, FAIA, At-Large Director  
Daniel S. Hart, FAIA, At-Large Director  
Timothy C. Hawk, AIA, At-Large Director  
Evelyn M. Lee, AIA, At-Large Director  
Jessica A. Sheridan, AIA, At-Large Director  
Heather B. Koury, HON. AIA, CACE Director  
Amelia Rosen, ASSOC. AIA, Student Director  
Ryan Gann, ASSOC. AIA, Associate Director  
Robert A. Ivy, FAIA, EVP/Chief Executive Officer  
AIA Strategic Council: Bruce D. Turner, AIA, Moderator

The AIA Architect section of this magazine is produced by the Institute as a benefit to its members in partnership with ARCHITECT's editorial and production teams. Please direct any questions or comments to Frank Scanlan, MD, Strategic Communications & Content for AIA.

hanleywood





# THE ONLY LIMIT IS THE IMAGINATION

What's your dream ceiling? WoodWorks® Ceiling & Wall Systems with ACGI Custom capabilities let you dream big. Our expanded expertise in custom wood design can take ideas from planning to installation without compromise – in almost any wood species or stain.

See all the ways WoodWorks with ACGI Custom capabilities can turn your next idea into a reality at [armstrongceilings.com/acgiwood](http://armstrongceilings.com/acgiwood)

WOODWORKS® CUSTOM ACGI BEAMS AND ENCORE™ ACOUSTICAL PANELS  
TEMPLE UNIVERSITY, PHILADELPHIA, PA / MGA PARTNERS, PHILADELPHIA, PA

Inspiring Great Spaces®

**Armstrong**®  
CEILING & WALL SOLUTIONS



# 20+ Linear

# whitegoods



20 Linear Perimeter Recessed with Louver

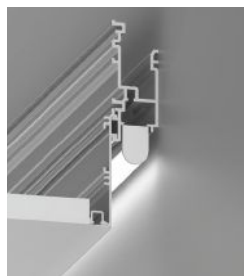

20 Linear Perimeter Recessed with Narrow Lens

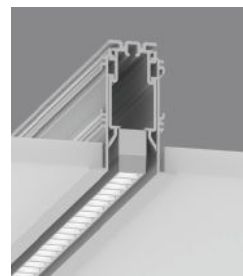

20 Linear Flush with Louver

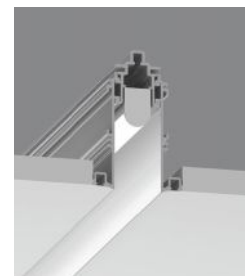

20 Linear Recessed with Narrow Lens

Whitegoods greatly expands the applications for the successful 20 Linear Range by adding the Perimeter and Linear Recessed housings, as well as cut-off Louver and Narrow grazing Lens.

The housings will integrate with any ceiling type and offer an ultra-narrow aperture.

Specify the Louver for a 45 degree beam or the Narrow Lens for a high output, 35 degree grazing beam.

The 20 Linear Range can truly be used for any interior application.

**inter•lux**  
tools for lighting

[inter-lux.com/20L](http://inter-lux.com/20L)  
[answers@inter-lux.com](mailto:answers@inter-lux.com)



# DESIGN WITHOUT LIMITATIONS.



**Crafted to blend in while standing out.**

Our new CITY MULTI® N-Generation with VRF technology provides a smaller footprint and expanded vertical piping limits for more design freedom.

Learn more at [NextGenVRF.com](http://NextGenVRF.com)

CITYMULTI® N-GENERATION







### Modernism in America

Docomomo U.S. has announced the winners of its 2019 Modernism in America Awards: restorations of Mies' Des Moines, Iowa, Catholic Pastoral Center, Saarinen's Gateway Arch Museum in St. Louis, Lautner's Silvertop house in Los Angeles; Johnson and Knoll's Schlumberger Research Center Administration Building (above) in Ridgefield, Conn., and Olav Hammarstrom's Pond House in Wellfleet, Mass.; surveys of two Eichler neighborhoods in California and 400 midcentury buildings in Michigan; and advocacy for Isami Enomoto murals in Hawaii, the Portland Building, and SOM's Terrace Plaza Hotel in Cincinnati. —MIABELLE SALZANO

> To learn more about the 2019 Modernism in America Award winners, visit [bit.ly/DocomomoUS2019Awards](https://bit.ly/DocomomoUS2019Awards).





**Finally hand dryers that don't require ear plugs.**

By the sound of it, it seems that some manufacturers think they are manufacturing jack hammers, not hand dryers. With ASI you don't need to sacrifice performance for quiet. ASI offers the largest and quietest collection of hand dryers anywhere. To see more, visit [www.americanspecialties.com](http://www.americanspecialties.com) or call 914.476.9000.

**ASI** Group  
Integrated Building Products





### Just Desserts

Every year, the Architectural League Prize recognizes talented young practitioners who submit based on a theme. The 2019 theme was “just,” and the winners are Cyrus Peñarroyo of Extents, Ann Arbor, Mich.; Virginia Black, Gabrielle Printz, and Rosana Elkhatib of Feminist Architecture Collaborative (F-Architecture), New York; Gregory Melitonov of Taller Ken, New York, Guatemala City, and San José, Costa Rica; Jennifer Bonner of MALL, Boston; Mira Hasson Henry of Henry Architecture (HA), Los Angeles; and Rachel Barnard of Young New Yorkers, which is a New York–based arts program for youths (shown) in the criminal justice system.

> For more information about this year's winners, visit [bit.ly/LeaguePrize2019](http://bit.ly/LeaguePrize2019).



# CableRail Conceal... a new twist on cable infill

Feeney's new *CableRail Conceal Kits* are a great alternative for customers who want the beauty of our original CableRail Kits, but with a lower profile finish on the end posts. Special *Conceal Quick-Connect*® fittings are hidden inside the posts with only a slender cap visible, and their automatic-locking jaws make installation a breeze. Made of 316-grade stainless steel, our CableRail products offer exceptional beauty, long lasting durability, and ultra-low maintenance, which makes choosing the look that meets your style...easy!

Free catalog,  
1-800-888-2418 or  
[www.feeneyinc.com/conceal](http://www.feeneyinc.com/conceal)

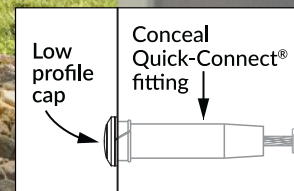

Nat Rea Photography  
Laschever Building Co. LLC



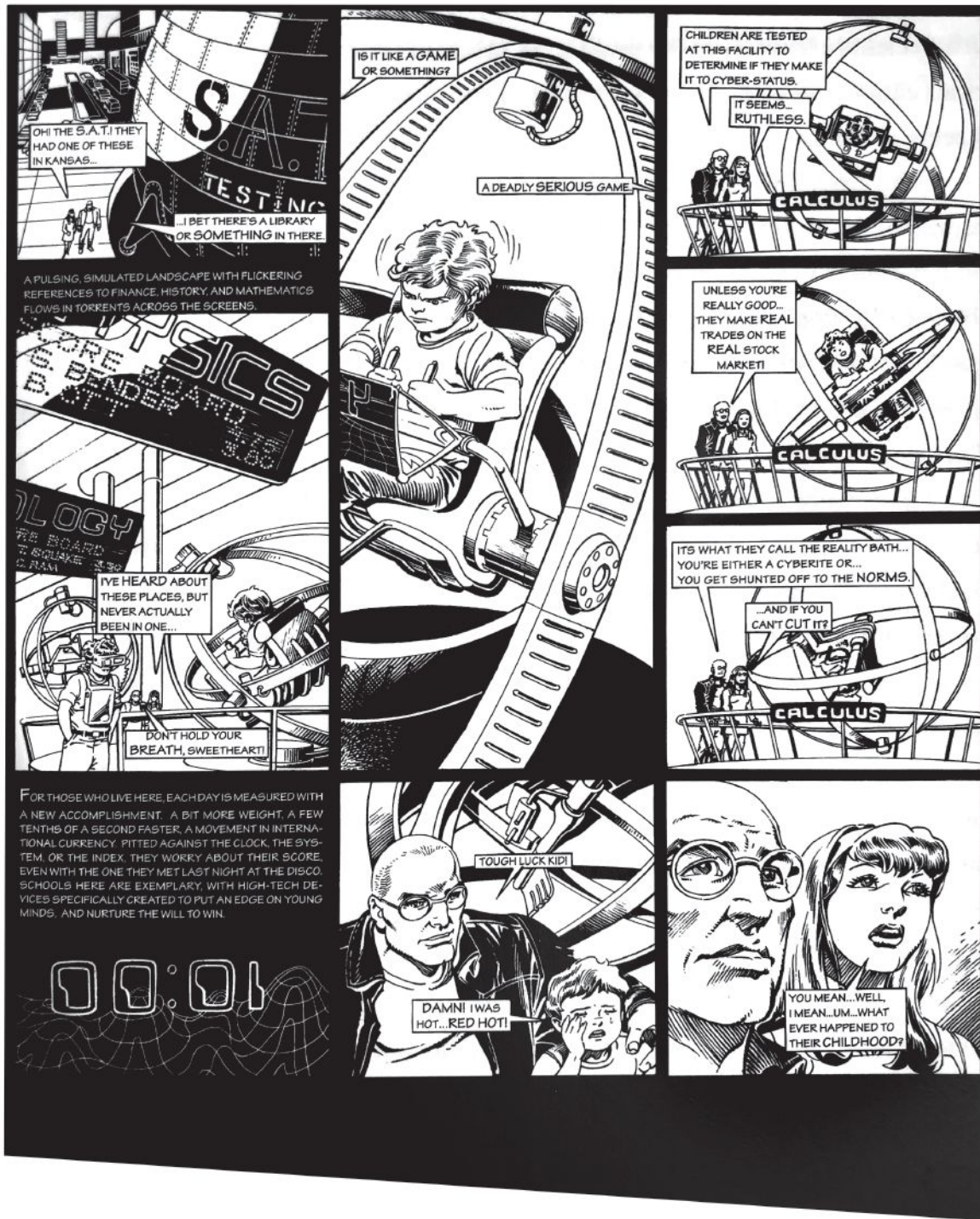

### The Pragmatic Outlaw

The architect Craig Hodgetts, FAIA—writing way back in 1970—pretty accurately predicted the reality we inhabit today. He might not have foreseen the messiness and ephemerality that the digital turn and emergence of a hyper-object world has created, but he did understand that we would indeed, as the title of one of his essays of the period indicates, live in a “Synthetic Landscape.” The prescient text appears in an anthology of Hodgetts’ work (including a polemical comic, above) entitled *Swimming to Suburbia and Other Essays* (Oro Editions, 2018), edited by Todd Gannon, AIA, of Ohio State University’s Knowlton School. —AARON BETSKY





2020  
**IDEAS<sup>2</sup>**  
**AWARDS**

Innovative Design in Engineering and  
Architecture with Structural Steel

.....  
[www.aisc.org/ideas2](http://www.aisc.org/ideas2)

# CALLING ALL INNOVATORS!

If you recently worked on a project  
that featured structural steel, we  
want to hear from you. Submit it  
for a 2020 IDEAS<sup>2</sup> award!

.....  
entries close on SteelDay  
September 27, 2019  
.....

enter now at  
[www.aisc.org/ideas2](http://www.aisc.org/ideas2)

2019 IDEAS<sup>2</sup>  
National Award  
**Vespertine**  
Culver City,  
Calif.  
Photo: Tom  
Bonner



**AIA** Contract Documents

# Real projects start with the industry standard

Before construction began, CBT protected  
**Natixis Investment Managers' new  
headquarters** in Boston with AIA contracts.

**AIA Contract Documents used:** B152-Owner/Architect-Interior and FF&E Design.

Visit [aiacontracts.org/architectmag-natixis](http://aiacontracts.org/architectmag-natixis) to learn more about the Natixis project and to get free samples of the new Interiors documents.

 **AIA**® **Document B152**  
Standard Form of Agreement Between Owner and Architect  
Architectural Interior Design Services

AGREEMENT made as of the \_\_\_\_\_ day of \_\_\_\_\_  
in the year \_\_\_\_\_  
(In words, indicate day, month and year.)

BETWEEN the Owner:  
(Name, legal status, address and other information)



# Out of sight.



Bobrick's privacy partitions eliminate sight lines between doors and stiles, and above and below panels.



**Gap-Free interlocking design.**

Sight lines between doors and stiles are an emerging sensitivity in restrooms. Our Gap-Free design is an integrated solution.



**Max. Height doors and panels.**

4 5/16" floor clearance vs 12", and 72" panel height vs 58". Specify Gap-Free and Max. Height for double the privacy.



**BUILDING VALUE SINCE 1906**  
**BOBRICK.COM**

© 2018 BOBRICK WASHROOM EQUIPMENT, INC.



# Best Practices: Making a Name for Yourself

TEXT BY AILEEN KWUN

It's no secret that working at a large firm can be a demanding experience. Here, three emerging professionals share how they've also managed to prioritize self-initiated projects and strike out on their own beyond conventional design.

## Define and Promote Your Passion

For Pascale Sablan, AIA, her push to develop a personal brand separate from her work as a senior associate at Sg Architecture, in New York, coincided with a burgeoning passion for diversity and inclusion in architecture. The realization that she "was the 315th African American woman in the United States of all time, ever, to become licensed," led Sablan to establish Beyond the Built Environment (BBE), a platform for championing and amplifying the contributions of architects of color with public programs and exhibitions.

To amplify her message, Sablan depends on a range of digital tools, including Google Drive and the website platform Wix, for self-marketing. Her "Excited to Share" email blast, first started six years ago to keep her family and relatives apprised of her work, now goes out to well over 1,000 recipients. As she traveled to conferences, speaking engagements, and other networking events, amassing contacts, she began to extend her newsletter to professional acquaintances as an easy way to keep her contacts organized and informed with her latest calls to action, news developments, and projects that link back to her website.

## Dare to Provoke

In designer Dong-Ping Wong's case, the first step to establishing his personal brand came when he went outside the conventions of architecture. In 2011, Wong and fellow designers Archie Coates and Jeff Franklin captivated the industry with +POOL, an unsolicited proposal for a floating, self-filtering swimming pool in New York City's East River. Introduced purely as a visual concept and provocation—and rebellion against architecture's stringent culture centered on briefs and competitions—the project has become a calling card for Wong's fresh ideas and a refreshingly pop-driven approach to architecture.

"In the beginning, the intention wasn't even to try and build it," says

**"I've always just been interested in different ways to initiate projects."**

— Dong-Ping Wong, founder, Food New York

Wong, who dreamt up the idea while freelancing. "Nobody approached us to design a pool. I've always just been interested in different ways to initiate projects and ask, 'Are there different ways that architects can communicate? Are there different ways architects can have more agency?'"

Wong has since parlayed his reputation as an innovator who

embraces the alternative into working on commercial and community engagement projects with the likes of Kanye West and Virgil Abloh. Now with his firm, Food New York, Wong aims to self-start one out of every five projects, with an ongoing emphasis on thinking outside the box of conventional architecture. Recently, he started a radio station, run out of a local Chinatown storefront, that features workshops and a podcast for local entrepreneurs to connect with the community.

## Bring the Benefits Back to Your Firm

With her workload, Sablan will often sleep just three to four hours a night and regularly dedicate her evenings, weekends, and paid time off to running BBE. But she's convinced that her advocacy has tangibly brought value back to her employer. One client even hired Sg for a job expressly because of Sablan's work. "They were a mission-based organization, and they said it was important that their architect also be a mission-based professional," Sablan says.

She foresees a future in which an in-house director of advocacy will become commonplace at architecture firms, similar to the rise of directors of sustainability and of diversity and inclusion. "There's a real financial benefit to this kind of work," Sablan attests, who sees all of her work as part of the same spectrum of inclusion. "The visibility of what we do is very important, because representation matters."





## ACOUSTI-CLEAR®

INDUSTRY LEADING  
51 STC ACOUSTICAL GLASS

- Up to **51 STC** Acoustically Rated Movable Glass Wall System
- Single Panel, Paired Panel, Demountable Layout Configurations
- Minimal Contemporary Aluminum Frame for Uninterrupted Sight Lines
- Full Glass ADA Compliant Pass Door
- Custom RAL Powder Coating Options
- Protector Series Line of Sight Safety System

Contact your local Modernfold, Inc. Distributor today to learn more about Acousti-Clear® and the numerous other Modernfold space division products available by calling **800-869-9685** or visiting **[www.modernfold.com](http://www.modernfold.com)**



ENTER YOUR BEST PROJECTS IN THE 20TH ANNUAL RESIDENTIAL ARCHITECT DESIGN AWARDS  
and be recognized for your outstanding work in advancing residential design.

20<sup>th</sup> ANNUAL

# RESIDENTIAL ARCHITECT DESIGN AWARDS



## Call for entries

---

### STANDARD ENTRY CATEGORIES (\$125)

1. Custom / Less Than 3,000 Square Feet
2. Custom / More Than 3,000 Square Feet
3. Renovation / Adaptive Reuse (residential remodeling and additions)
4. Restoration / Preservation
5. Multifamily Housing
6. Affordable Housing
7. Architectural Interiors (build-outs, interior renovations)
8. Student Housing
9. Outbuilding
10. On the Boards (any unbuilt residential project not yet completed)

### SPECIALTY ENTRY CATEGORIES (\$95)

11. Kitchen
12. Bath
13. Architectural Design Detail

### RECOGNITION

Winners will be featured in the December 2019 issue of ARCHITECT with expanded coverage online.

### ELIGIBILITY

Entries should be submitted by an architect or designer. Other building industry professionals may submit projects on behalf of an architect or designer. Projects outside the U.S. are welcomed. Any home or project completed after Jan. 1, 2015 is eligible.

---

### HOW TO ENTER

#### SUBMIT YOUR WORK AT

> [radesignawards.com](http://radesignawards.com) (Submission period opens in June 2019)

### QUESTIONS?

EMAIL [rada@hanleywood.com](mailto:rada@hanleywood.com)

### DEADLINES

REGULAR September 6, 2019

LATE September 13, 2019 (Will include a late fee of \$50 / entry)

---

2018 AWARD WINNER EAST LAWRENCE SUSTAINABLE HOUSE BY STUDIO 804; PHOTO BY COREY GAFFER



# STYLISH POWER GROMMET

PCS85B/USB



Put Power and USB Charging Within Reach  
Mounts easily into all types of furniture  
Available in Four Finishes

**MOCKETT**  
DOUG MOCKETT & COMPANY, INC.

www.mockett.com  
800-523-1269

Fine Architectural Hardware for Your *fine* Furniture®

## Socialize

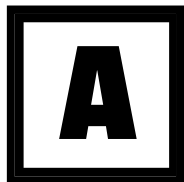

@architectmag



ArchitectMagazine

CREATING ENVIRONMENTS WHERE PEOPLE CAN SHINE™



# CONTROL NATURAL LIGHT & ILLUMINATE YOUR SPACE

LIGHTWEIGHT, LIGHT DIFFUSING & EASY-TO-INSTALL  
GUARDIAN 275® TRANSLUCENT PANEL SKYLIGHTS,  
WALL SYSTEMS & CANOPIES



**MAJOR  
INDUSTRIES**

SKYLIGHTS / CANOPIES / WALL SYSTEMS  
**MAJORSKYLIGHTS.COM**

888-759-2678



# Detail: Octave 9 Handcrafted Acoustical Ceiling

TEXT BY TIMOTHY A. SCHULER



Instead of having “all the guts hanging out on the ceiling” as is common in black box theaters, Octave 9 in Seattle features a sculptural ceiling composed of hundreds of irregularly shaped “cells” that absorb sound while concealing the audiovisual system, says Scott Crawford, ASSOC. AIA, a principal at LMN Architects. Felt-like in appearance and touch, the cells—PET plastic sourced from local company Snap-Text—join together like puzzle pieces, forming approximately 6-foot-square modules that hang from a Unistrut system.

The ceiling’s biomorphic form derived from the underlying grid of audiovisual equipment, such as lights and microphones, combined with the radial configuration of special projectors and a few designer tweaks. The final form “emerged out of the simulations that we were running,” Crawford says.

LMN, which fabricated the final acoustical product, created drawings of each individual cell in its “unfolded”

state, creating long geometric panels that could be CNC-milled from Snap-Text’s 4-foot-by-8-foot, 0.5-inch-thick sheets. The shortest panel was just 3.25 feet, while the longest, which ganged two sections, was 10.5 feet. The team could fit up to seven panels per sheet. Overall, fabricating the ceiling took about six weeks.

Local general contractor JTM Construction installed the ceiling system, in part for insurance reasons. Because some acoustical cells only attach to neighboring cells and not the Unistrut system, the architects created a color-coded sequencing diagram to guide the installation process. Adjacent cells were pinned together with clear plastic binding posts and hung using an aluminum angle that slips between the “walls” of the cell. Each module weighs at most 30 pounds, Crawford says. Altogether, the ceiling uses 4,000 square feet of acoustical panel and weighs less than 2,000 pounds.

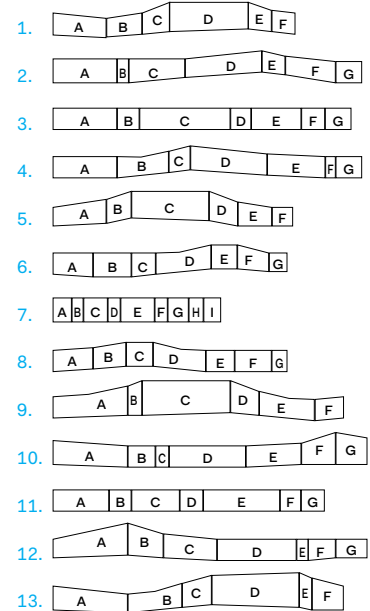
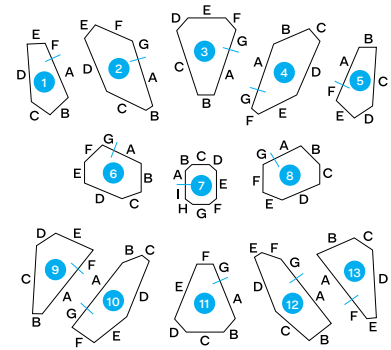

Acoustical PET panels, containing 60% recycled material; 3.25' to 10.5' long by 4" to 16" deep by 0.5" thick



NUVI Corporate Office  
Lehi, Utah  
Featuring Teak Finish

# ALPOLIC<sup>®</sup>

METAL COMPOSITE MATERIALS

Exceptional projects demand exceptional materials.

Your Design | **Perfected**

Walnut

Bamboo

Zebrawood

# TIMBER SERIES

 MITSUBISHI CHEMICAL COMPOSITES AMERICA, INC.

©2019. Mitsubishi Chemical Composites America, Inc. All Rights Reserved.

alpolic-americas.com | 1.800.422.7270 | 401 Volvo Parkway Chesapeake, VA 23320



67<sup>th</sup> ANNUAL CALL FOR ENTRIES

# Progressive Architecture Awards

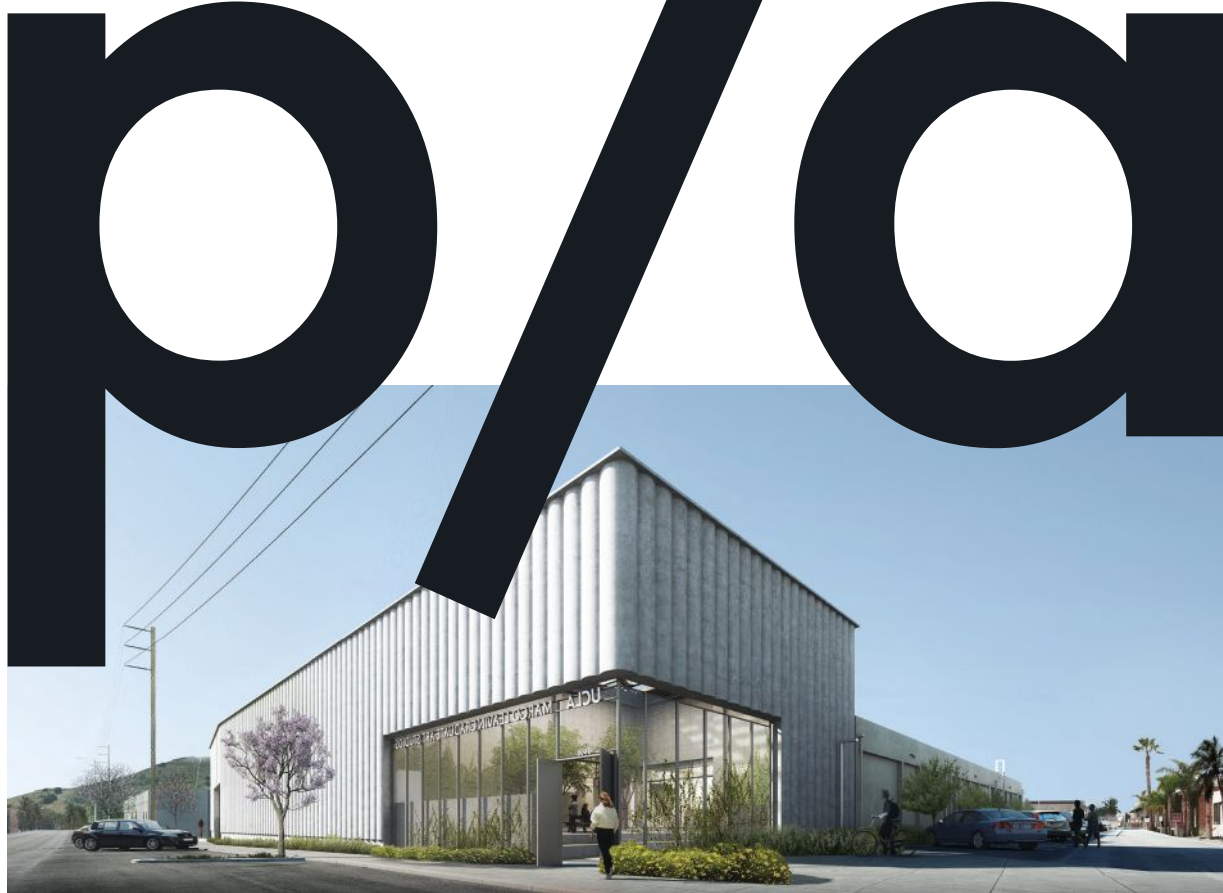

## ELIGIBILITY

Projects must have a client and a completion date after January 1, 2020. Judging will take place in November 2019. Winners will be notified in December 2019, published in the February 2020 issue of ARCHITECT, and honored at a ceremony in New York. For more information and rules and regulations, visit [paawards.com](http://paawards.com).

## RECOGNITION

Winners will be featured in the February 2020 print issue of ARCHITECT with expanded coverage online at [architectmagazine.com](http://architectmagazine.com).

## HOW TO ENTER

**SUBMIT YOUR WORK AT**  
> [paawards.com](http://paawards.com)  
(Submission period opens in June 2019)

## DEADLINES

**REGULAR** November 1, 2019  
**LATE** November 8, 2019

## FEES

**SINGLE ENTRY** \$195  
**ADDITIONAL ENTRIES** \$150  
**LATE FEE** \$50 (for entries submitted after Nov. 1)

2018 AWARD WINNER UCLA MARGO LEAVIN GRADUATE ART STUDIOS BY JOHNSTON MARKLEE





# Any shape. Any environment. Anywhere.

Technologically innovative, aesthetically sophisticated, and infinitely functional. From buildings, boats, and furniture to acoustic control, solar protection, and tensile or modular structures, our lightweight, durable and sustainable textile solutions meet the requirements of your project. There's no limit to your imagination.

**Performance textiles for everywhere you are.**

# Serge Ferrari

[sergeferrari.com](http://sergeferrari.com)





# Next Progressives: The Open Workshop

EDITED BY KATHARINE KEANE

**Location:**

San Francisco

**Year founded:**

2013

**Firm leadership:**

Neeraj Bhatia

**Education:**

B.Arch., University of Waterloo in Waterloo, Ontario; M.Arch., MIT

**Firm size:**

Four to six

**Mission:**

We aim to use architecture to address social, ecological, and economic issues that often sit outside a building's footprint. In essence, we engage architectural form in territorial issues.

**Origin of firm name:**

The name of the office emerged from late Italian novelist Umberto Eco's treatise *The Open Work* (Bompiani, 1962). For Eco, an "open work" is strategically designed to be incomplete, allowing an individual to incorporate some final missing piece. Although Eco's treatise did not address architectural practice, it offers a promising way to address political and environmental indeterminacy and instability in our field. Our studio uses the template of Eco's treatise to understand the subject as both the collection of distinct humans and the dynamic environment that they

inhabit. For us, "open work" suggests that designers maintain control and precision through the structuring of permanent frames that require individual meanings, interpretations, and/or transformative environmental qualities to complete the project.

**Favorite project:**

The "New Investigations in Collective Form" exhibition hosted at the Yerba Buena Center for the Arts, in San Francisco, allowed us to reflect on our practice and see patterns emerging across a variety of projects.

**Second favorite project:**

The Garden of Framed Scenes pavilion in Viseu, Portugal, was a smaller project, but it reminded us how collectivity can be formed and framed within a larger environment.

**Memorable learning experience:**

The start of my post-professional degree at MIT coincided with Hurricane Katrina. MIT responded with several classes devoted to efforts of rebuilding, examining water-based urbanism and highlighting the problematized relationship between architecture, infrastructure, and the natural environment. Embedded in that negotiation are deeper questions of class and race divides that architecture often attempts to normalize or control. These issues became the core of the Open Workshop's work. In particular, we ask how this negotiation might unfold

Neeraj Bhatia

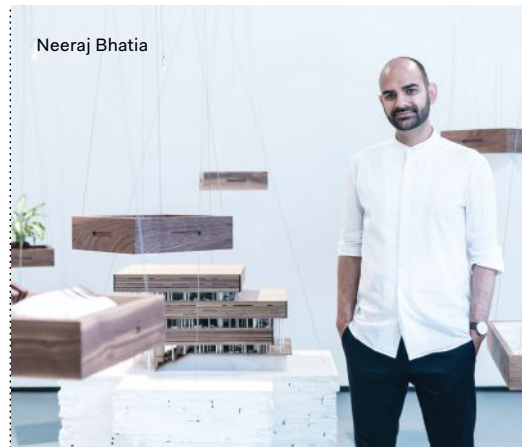

to empower local people as well as the environments they live in.

**Architecture hero:**

I am inspired by British architect Cedric Price's work—for its range, transcalar nature, and interest in questions of indeterminacy and adaptation. His time-based approach that spanned from systems to objects is highly relevant for our contemporary challenges.

**Greatest challenge to running a successful practice:**

Aligning the type of work tied to our deeper interests and research—on urbanism and the public realm—with the reality of opportunities for young offices.

**Design tool of choice:**

Foam wire cutter—its speed allows for a highly iterative process that can also be precise.

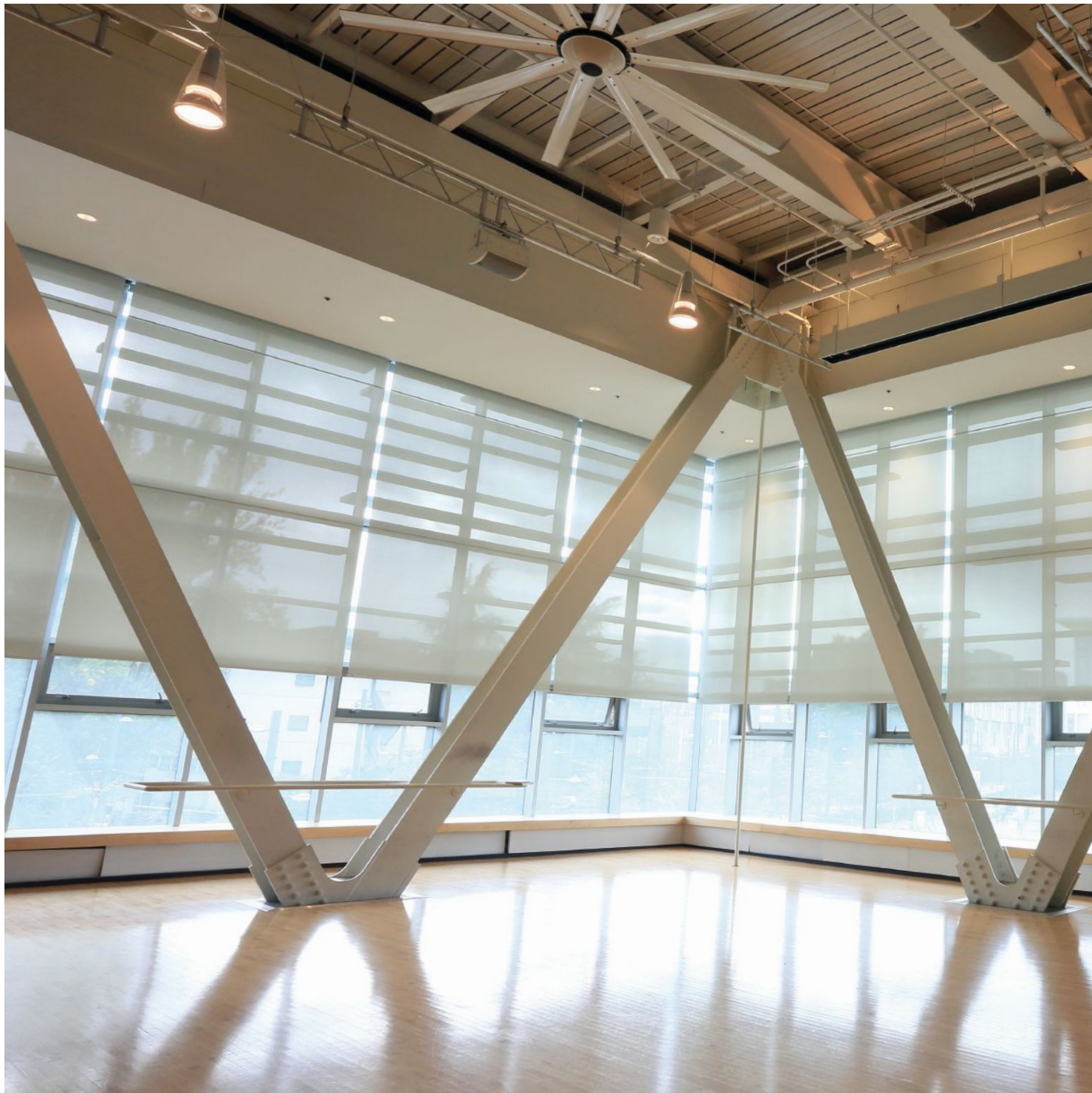

© PHIFER INCORPORATED 2019 | Photo courtesy of SOLARFECTIVE, Canada

Quality. Service. American Made.

Specify SheerWeave, the world's most trusted brand of solar screen fabrics.

**PHIFER**



phifer.com



**Next Progressives:  
The Open Workshop**



2  
LOCAL OPPORTUNITIES

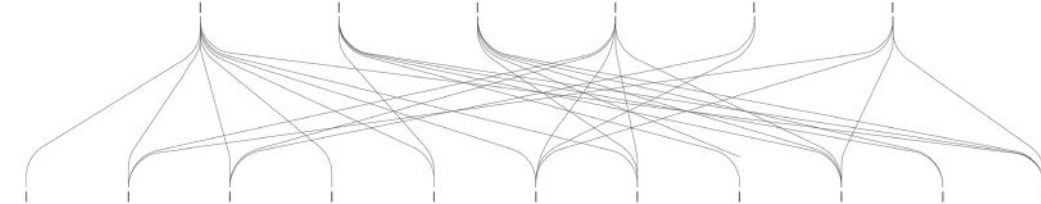
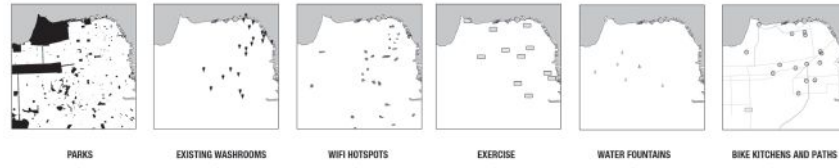

ROOM MODULES

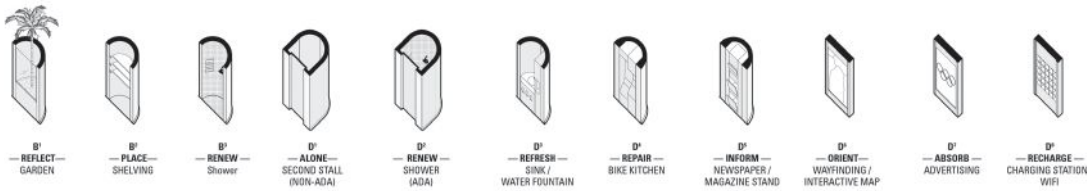

ROOM COMBINATIONS

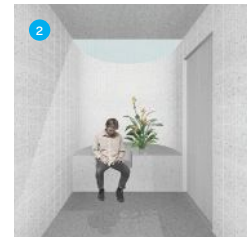
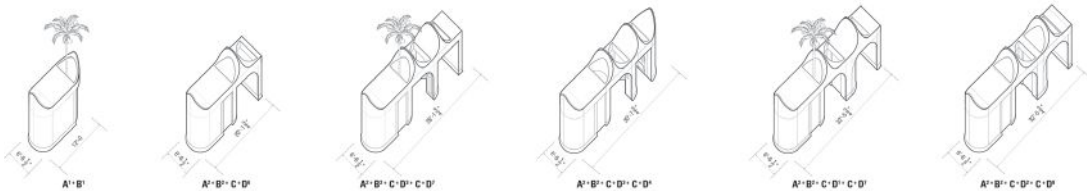

Reading Forest



Closed Archive

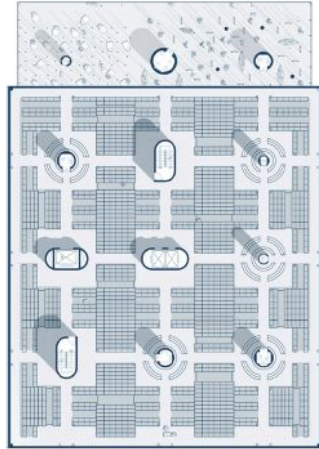

Open Archive

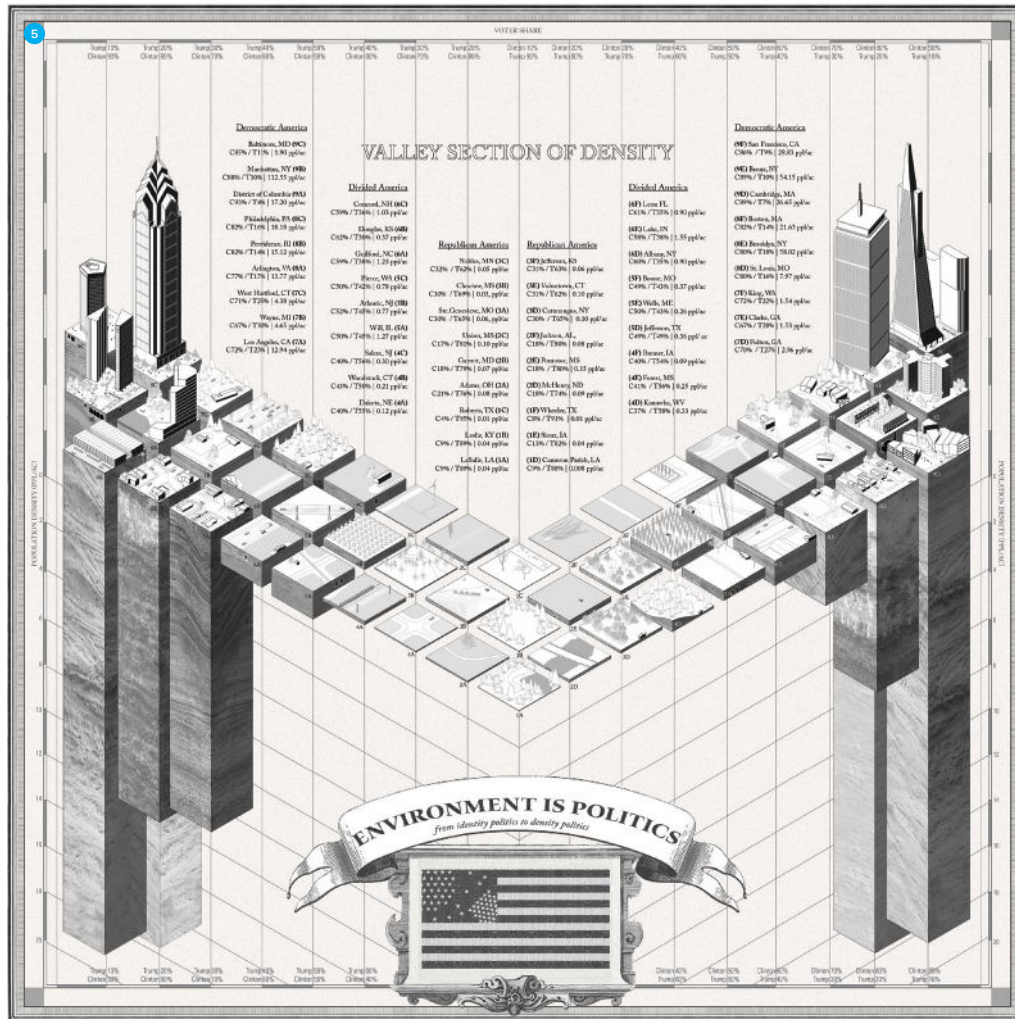
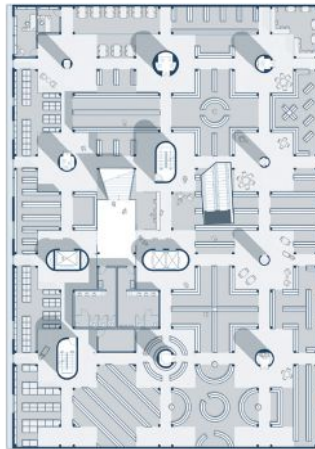

3, 4: COURTESY THE OPEN WORKSHOP; 5: COURTESY THE OPEN WORKSHOP FOR PLACES JOURNAL

1. Inspired by the techniques of Renaissance painter Grão Vasco, the three volumes of the Garden of Framed Scenes pavilion located in Viseu, Portugal, create “a theater for collective performance,” according to Bhatia. 2. In this proposal, Bhatia reconceptualizes San Francisco public restrooms as modular amenities that offer a private space for a variety of ephemeral uses, such as changing, praying, and breastfeeding, with features such as a small garden and skylight. 3. For the Varna Public Library and Archive in Bulgaria, the Open Workshop proposed a “forest” structure with “groves and clearings” for individual work and study. 4. Currently under construction in Germany, the Depth of Fields house uses three superimposed geometric forms—a circle, cruciform, and triangle—to create voids for circulation, interior gardens, and inhabitable space. 5. In his April 2017 “Environment as Politics” article in *Places Journal*, Bhatia offered drawings exploring the relationship between residential density and voting behavior. This image shows the breakdown of 51 counties in America based on voter activity from the 2016 presidential election.



# Products: Contract Furniture

TEXT BY KATHARINE KEANE



## **Alto, Humanscale**

Designed by Don Chadwick, Alto features a contoured flexible shell seat. Available in bar and counter heights, Alto can be specified with maple, walnut, or ebony legs. [humanscale.com](http://humanscale.com)



## **Alya, Andreu World**

This line of upholstered plywood and flexible foam lounge chairs is available with a low or high backrest. It offers various base configurations in multiple finishes. [andreuworld.com](http://andreuworld.com)



## **Navy Wood Chair, Emeco**

Emeco is celebrating the 75th anniversary of its iconic aluminum 1006 Navy Chair with the launch of a wood version. Available in walnut, white oak, and black-stained oak. [emeco.net](http://emeco.net)

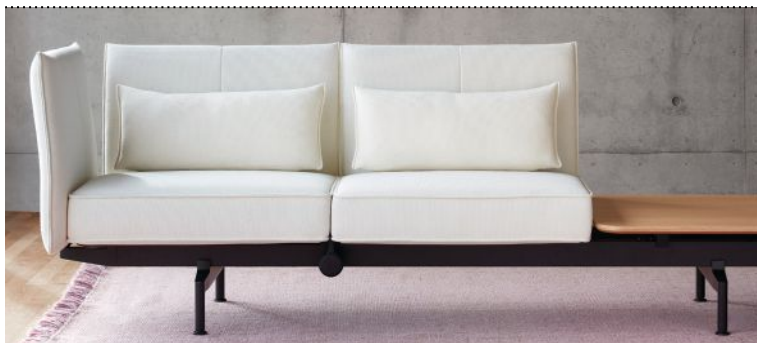

## **Soft Work, Vitra**

Designers Edward Barber and Jay Osgerby predict a future where individual workstations are no longer the standard. In their stead, the duo propose this modular couch system that aims to provide the comfort of residential furniture in office and open environments. Movable swivel table inserts, partition screens, outlets, and charging stations are optional. Available in 138 colorways. [vitra.com](http://vitra.com)

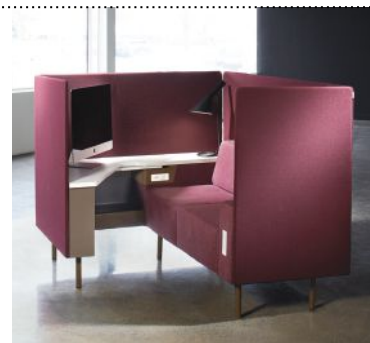

## **Exchange 3, Allseating**

Exchange 3 comprises seven recycled, injection-molded plastic components that can be configured more than 180,000 ways, for private (shown) or collaborative work. [allseating.com](http://allseating.com)

> For more on these products, visit [bit.ly/ARContract19](http://bit.ly/ARContract19).





# BRING YOUR BRILLIANT DESIGN TO THE LIGHT OF DAY

**Innovative, High Performance Daylighting Solutions Designed to Shine**

Kingspan Light + Air is the award-winning innovator of translucent daylighting technology for high-performance building envelopes – walls, skylights and canopies. Our custom solutions are engineered to enhance and optimize the role that natural light plays in the design of your buildings. We leverage our global resources, national reach, and local expertise to empower your vision with bold and innovative ideas, the broadest range of high performance daylighting products, and the knowledge you need to bring that vision to the light of day.

**Let's make brilliant things happen. Together.**

Contact us at [cpi.info@kingspan.com](mailto:cpi.info@kingspan.com)



Be inspired at [www.cpidaylighting.com/portfolio](http://www.cpidaylighting.com/portfolio)





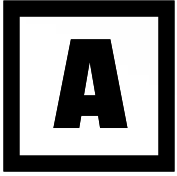

# The **ARCHITECT** Podcast Network

Where we talk with the innovators working  
at the cutting edge of design, technology,  
and practice in architecture.

Come join us.

> [bit.ly/ArchitectPodcasts](http://bit.ly/ArchitectPodcasts)

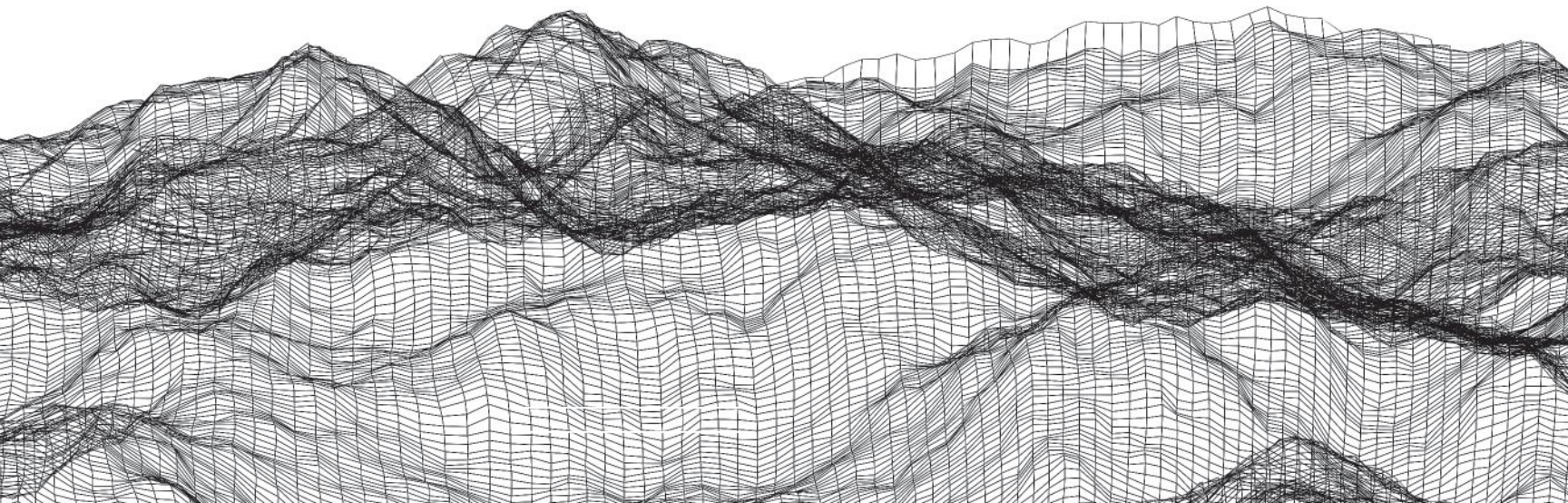

Sponsored by



Now available on







## LEED A LEGACY

Leaders across the globe have made LEED the most widely used green building program in the world. Leave your legacy today.

#LEEDlegacy





# Opinion: Every Community Is Our Client

TEXT BY SIBONEY DÍAZ-SÁNCHEZ, AIA



My mother, Beva Sánchez-Padilla, taught me a modified version of musical chairs: When the music stops, everyone works to create a space for the individual left standing. Someone not having a seat is a call to action for the collective.

My colleagues often tell me that I am “political.” Besides the fact that the buildings, land, and infrastructure I use and design are regulated by policy, being an apolitical architect is a luxury I cannot afford. My profession is less than 5 percent Latina. My being is politicized.

As a founding member and co-chair of AIA San Antonio’s Latinos in Architecture Committee (LiA), I work to make the design profession an accessible option for Latinx. Having a space—a community—in which you feel welcomed is powerful. It is important to take up space in a world that historically hasn’t considered the perspectives of people like you.

Though my formal education did not teach me about engaging with users, my upbringing did. Carving out a place and time for communities and earning their trust are simultaneously delicate and heavy skills necessary to cultural preservation and the design profession.

In City Council District 5 within San Antonio’s Westside, 94 percent of the population identifies as Hispanic or

Latino/a/x. Though their culture helps power the city’s tourism industry, Westside and similar communities struggle with generations of disinvestment. Creeks, railroad tracks, industrial lots, a freeway, and a jail separate Westside from downtown San Antonio. In 2016, the average per capita income was \$13,596, and one in three residents lived in poverty.

Last fall, the City of San Antonio asked LiA to help lead community meetings focused on reimagining capital improvements for Plaza Guadalupe, a public space in District 5. Alleging that the plaza had become a destination for drug activity and violent crime, the plaza’s managing organization had commissioned the design of a permanent fence that would limit access to users. Residents and local organizations saw the project as an attempt to privatize public space.

LiA’s efforts to engage the community came with a humbling learning curve—and we are better for it. When LiA co-hosted a free public event with the city’s Office of Innovation and DreamWeek San Antonio to understand how to better listen and implement feedback, attendees expressed frustration with the accountability, accessibility, and transparency of established engagement processes. When the feedback we received lacked generational diversity, we headed to the nearest middle school to talk to students about their plaza. We had to make the design process and architectural

terminology accessible. Understanding how and where residents want to be heard was, and remains, paramount.

Communities expressed concerns that a fence would do nothing to address the systemic and societal issues that some associate with the plaza due to generations of disinvestment: homelessness, drugs, poverty, and racism. They wanted to see investment in health and human services, affordable housing, public education, public transit, and public spaces.

In response, we created two conceptual plans for public voting, both including programmatic, physical, and operational improvements. A version of the more popular plan—a compromise between the plaza management and community groups—was approved by the city’s Historic and Design Review Commission in April. The plaza’s main entrances will remain open, but fencing will be installed around select locations, such as the playground. The city has designated programming funds to activate the space; LiA will hold a youth design justice event there this fall.

Success in community engagement comes in many forms. Because architects are ultimately accountable to communities, we must integrate formal community outreach strategies into our practices. We must also be ready for outcomes tempered by realities.

Architecture is always political.

*Siboney Díaz-Sánchez, AIA, is an architect based in San Antonio, Texas.*



## INTRODUCING THE PIPELINE MODULAR SYSTEM

Pipeline's round design seamlessly blends with the ducts and pipes that define exposed ceiling spaces.





# Architectural Adventures



# Expert-led travel for architecture enthusiasts

**Don't miss out on these Fall 2019 tours!**

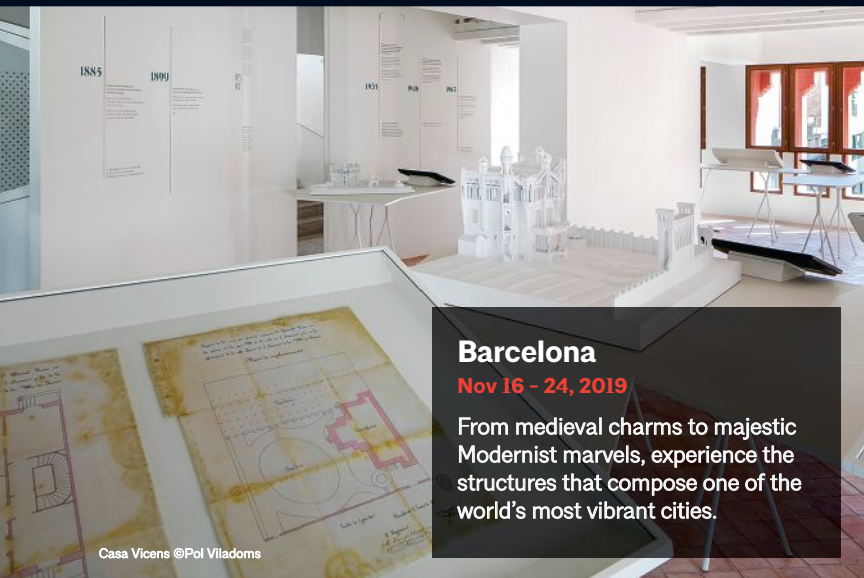

## Barcelona

Nov 16 - 24, 2019

From medieval charms to majestic Modernist marvels, experience the structures that compose one of the world's most vibrant cities.



## Greece

Oct 17 - 29, 2019

Witness the contrast of ancient and modern architecture from the Temple of Zeus to the Stavros Niarchos Foundation Cultural Center.



## Prague

Oct 11 - 19, 2019

Delve into the architecture of The City of a Hundred Spires from Romanesque to Art Nouveau.



## San Antonio

Nov 3 - 7, 2019

Discover the rich architecture of San Antonio from 18th Century Spanish Missions to the modernism of Sir David Adjaye's new museum.

See all of our tours, including newly announced 2020 tours, and sign up for email updates at [architecturaladventures.org/architectmag](https://architecturaladventures.org/architectmag).

Ready to book? Call 1.800.293.5725

Architectural Adventures is the official travel program of the American Institute of Architects.

---

# A 50

## THE 11<sup>th</sup> ANNUAL ARCHITECT 50

### Call for entries

---

#### CATEGORIES

The ARCHITECT 50 is different from most rankings, which simply list firms by size or revenue, and instead is based on performance in these three categories:

**BUSINESS**

**SUSTAINABILITY**

**DESIGN**

#### RECOGNITION

Winners will be featured in the November 2019 issue of ARCHITECT and online at [architectmagazine.com](http://architectmagazine.com). We list the Top 50 firms overall and in each of the three categories.

#### ELIGIBILITY

All firms are invited to participate, so long as they have a U.S.-based office. Sole proprietorships are not eligible.

---

#### HOW TO REGISTER

**VISIT AND SUBMIT YOUR INFORMATION**

> [architect50.com](http://architect50.com)

#### DEADLINES

Check the website for an updated schedule. Surveys are expected to be released in early June and will be due at the end of July.

---



# Architectural Lighting: The Merit or Myth of Circadian Lighting

TEXT BY MURRYE BERNARD, AIA

The potential of lighting to improve occupant health and well-being is increasingly attracting the attention of project owners and end users. In commercial environments, good design has become synonymous with talent hiring and retention. The benefits of well-lit spaces map across other regularly occupied building typologies, such as residences and schools, as well as patient rooms in healthcare and assisted-living facilities.

"If you don't get the lighting right, it's not going to be an environment anyone wants to spend time in," says Elizabeth O. Lowrey, principal and director of interior architecture at Elkus Manfredi Architects, in Boston. "It all goes back to making people feel good and look good."

"Clients are increasingly requesting and expecting lighting systems and applications that can support human health and well-being and make an impact on the circadian system," concurs Mariana Figueiro, director of the Lighting Research Center (LRC) at Rensselaer Polytechnic Institute, in Troy, N.Y., where she is also a professor at its School of Architecture.

In response to demand, lighting manufacturers are launching new products that they allege to be attuned to our circadian rhythms. Yet the skeptical architect and end user have to wonder: How much of this is marketing versus actual science? Is circadian-attuned lighting any better than conventional products?

## What You Can't See

Both daylight, courtesy of Earth's 24-hour light-dark cycle, and electric light can drive our circadian system, our internal clocks that regulate daily behaviors and the timing of biological processes, such as the release of the hormones melatonin and cortisol, which help control our blood sugar and affect our energy levels.

Several characteristics of lighting, including quantity, spectrum, timing, duration, and distribution, determine its nonvisual effects on our bodies and minds. The influence can be positive, but also negative if, for example, light is delivered at the wrong time. Think screen time on electronic devices before bed or in the middle of the night. The

Circadian rhythm repeats approximately every 24 hours

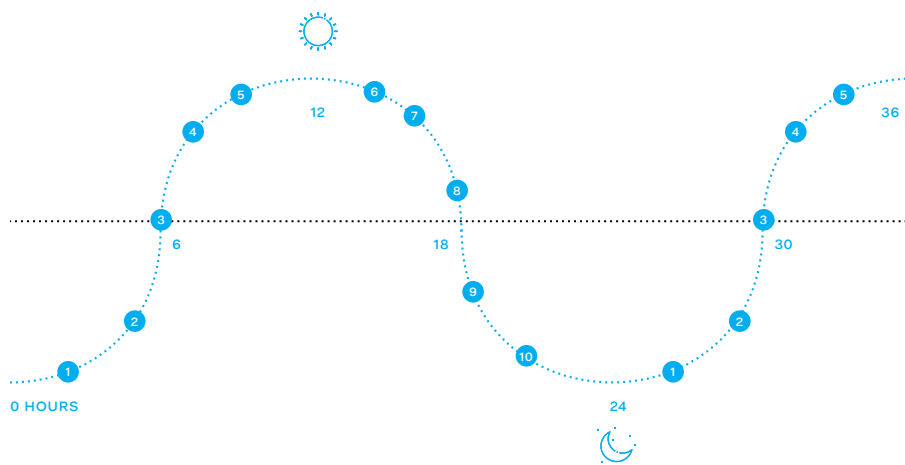

1. Deep sleep
2. Lowest body temperature
3. Cortisol release
4. Fastest increase in blood pressure
5. High alertness
6. Best coordination
7. Fastest reaction time
8. Highest body temperature
9. Highest blood pressure
10. Melatonin secretion

> For more stories on lighting technologies, projects, and products, visit [archlighting.com](http://archlighting.com).

A·L



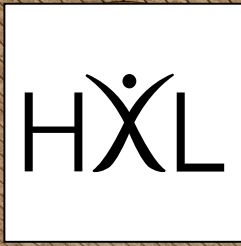

TM

## Illuminate the Human Experience

Empower people to work, be, and feel their best with lighting and shading solutions that promote comfort, enable enhanced well-being, and foster engagement.

**Lutron HXL** — a holistic approach to human centric lighting that employs four elements of lighting design:

Quality Light | Natural Light | Connection to the Outdoors | Adaptive & Personalized



[Lutron.com/HXL](https://www.lutron.com/HXL)

© 2019 Lutron Electronics Co., Inc.



### Architectural Lighting: The Merit or Myth of Circadian Lighting

disruption of circadian rhythms has been associated with health problems such as metabolic diseases, depression, and some types of cancer.

“We don’t fully understand everything there is to know about light’s nonvisual effects, but we know enough from the research over the past 30 years to be able to apply light to improve sleep, mood, and well-being in a variety of environments,” Figueiro says.

The LRC, for one, develops metrics and tools to help lighting designers understand and apply circadian light in the built environment. Circadian stimulus (CS) measures the effectiveness of the retinal light stimulus for the human circadian system from threshold to saturation; in other words, this metric allows designers to compare the ability of different light sources to stimulate the circadian system. With funding from the U.S. General Services Administration, the LRC has conducted several studies that found office workers receiving high CS throughout the workday felt more energetic and alert than workers receiving low CS. The former group also experienced better sleep and felt less depressed.

#### Daylight, Mimicked

Generally speaking, natural is best and lighting is no exception: Daylight is the ideal source for regulating the circadian system. However, people tend to spend most of their day in interior environments, the majority of which Figueiro believes are under-lit: “Due to

Light schedule  
example 1

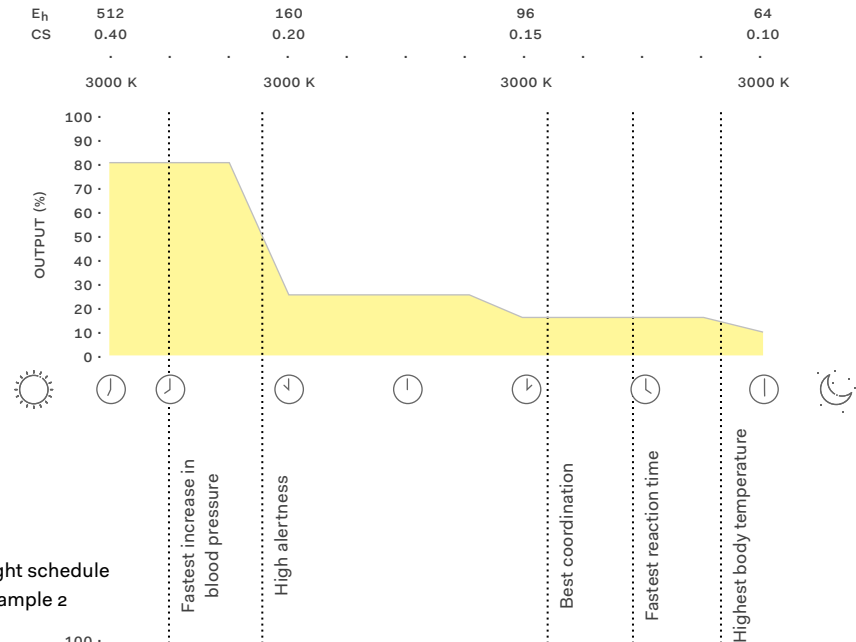

Light schedule  
example 2

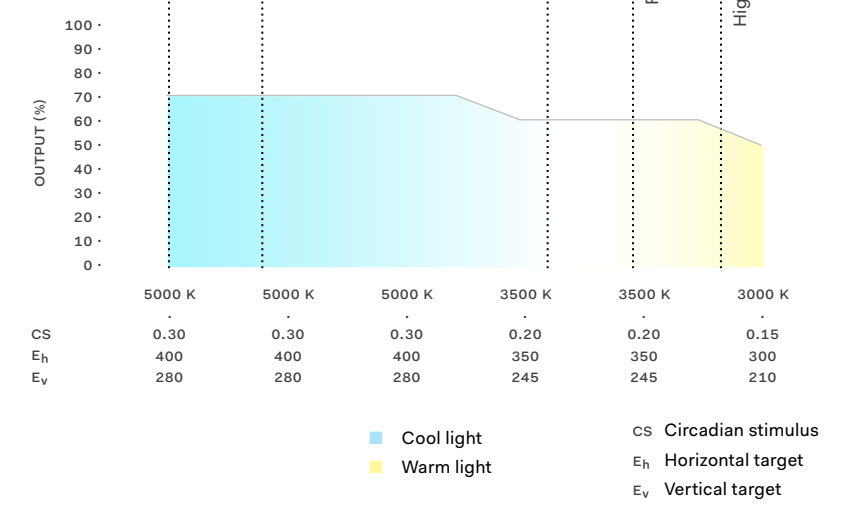

■ Cool light  
■ Warm light

CS Circadian stimulus  
 $E_h$  Horizontal target  
 $E_v$  Vertical target

Tunable luminaries can be programmed to change circadian stimulus. In these two hypothetical examples, the top schedule increases and decreases light output while fixing color temperature, while the bottom schedule alters both light levels and color temperature.

restrictive energy codes, daytime light levels in buildings are often too low or at threshold for activating the circadian system,” she says. “Even in open offices with many, large windows, workers do not receive enough daylight to stimulate their circadian system, due to factors such as season, cloud cover, desk orientation, and window shade position.” Supplemental electric lighting is thus a necessity, and recent technologies



YOU MIGHT CALL IT GOING THE EXTRA MILE.

**WE CALL IT TUESDAY.**



What's the made right here difference? At Williams, it's an unmatched level of service and American quality. It's lighting solutions we're proud to put our name on.

[hew.com/MadeRightHere](http://hew.com/MadeRightHere)





### Architectural Lighting: The Merit or Myth of Circadian Lighting

says Keith Yancey, AIA, principal at architectural lighting consultancy Lam Partners, in Cambridge, Mass. "While there is clearly a perceptible difference in CCT, which can make spaces feel warmer or cooler, actually stimulating the nonvisual cortex requires increased light levels in order to be effective."

Though tunable fixtures may be worthwhile, Yancey cautions that increased lighting levels and sources rich in the blue spectrum (CCT exceeding 5000K) can create eye fatigue and glare if not properly implemented.

brain. "Designers need to think about lighting beyond the ceiling and bring the source close to the eyes," she says. She advises that designers aim for a distribution of light with a horizontal to vertical illuminance ratio of at least 7:10.

Utilizing LED lighting panels as luminous vertical partitions is another economic way to change occupant energy levels. Saturated blue light can promote alertness in morning, and then transition after lunch to saturated red light, which still stimulates energy levels without raising CS to levels that may affect sleep later.



For Potamus Trading's headquarters in Boston, Elkus Manfredi Architects indirectly illuminated surfaces with concealed fixtures, blurring the lines between daylighted and electrically lit spaces. Pendants in the breakout spaces "add focus and sparkle."

have enabled and improved the ability of fixtures to work in tandem with daylight. For example, luminaires with integrated photosensors and automatic dimming can maintain consistent light levels regardless of fluctuations in available daylight. Advancements in LED technology have also fostered the creation of tunable white light systems, which mimic daylight patterns by adjusting correlated color temperature (CCT) and brightness levels throughout the day.

"Many manufacturers have made claims of tunable white light fixtures [that can change in CCT] as 'circadian,'"

For lighting to achieve CS and still feel normal and comfortable to our eyes, he recommends providing high light levels at cooler color temperatures.

To change CS values, Figueiro advises, simply increase or decrease light output while fixing CCT. If energy codes are restrictive, she suggests choosing a source that emits more short-wavelength light and picking a luminaire distribution that provides a higher horizontal-to-vertical ratio for visual tasks, such as surgery or reading paper documents. But that doesn't mean designers can neglect vertical illuminance, which is what stimulates the

### Painting with Light

More recent design approaches favor using layers of light from a variety of sources to mimic the effects of natural light, rather than simply delivering white light to surfaces via ceiling-mounted fixtures. Natural light is uneven—brighter areas are offset by shadows—and this contrast creates visual interest.

"We are thinking a lot about the changeability and diversity of light, particularly in open plan environments," Lowrey says. "Consistent lighting can be rigorous and creates fatigue." She advocates for "painting" surfaces with layers of light, such as task lighting for work surfaces, focused light to highlight artwork or significant architectural features, and a mixture of up- and downlighting throughout.

Currently, Lowrey is exploring the movement of light and shadows in common spaces to match the morning light outside. The lighting patterns will subtly evolve throughout the day, resulting in a dynamic space.

Though fixtures designed to influence the circadian system are more expensive than standard white lights, implementing circadian lighting strategies doesn't have to be expensive. One economical approach Figueiro suggests is designating a space as a "light oasis," a room within a commercial space that is bathed in color-tuned light and where occupants can visit in the morning for their daily circadian dose.



## **Trimless Reflectors for LED Recessed Downlights**

Trimless reflectors from ConTech Lighting are now offered with select 2", 4", and 6" LED recessed downlights. Each reflector has been optically engineered to reduce glare and maximize lumen output. The flange-less design and premium finish provide a truly "clean" ceiling appearance suitable for any space.

Visit [www.contechlighting.com](http://www.contechlighting.com) to explore our new trimless reflectors and complete offering of LED recessed downlights.





# Residential: MALL

TEXT BY EDWARD KEEGAN, AIA

Haus Gables began life as a conceptual design and research project called “Domestic Hats,” which Boston-based designer and MALL director Jennifer Bonner displayed at an Atlanta gallery in 2014. “I had a hunch that starting an architectural project from the roof—not the plan, elevation, or section—might be an interesting way to think about space and the domestic interior,” Bonner says. Five years later, the whimsy embodied in those initial explorations has been realized in built form with Haus Gables, a 2,200-square-foot residence for her family in Atlanta’s historic Old Fourth Ward neighborhood.

Hanif Kara, the London-based director of structural engineering firm AKT II and a mentor to Bonner, helped her realize Haus Gables. Bonner dismissed Kara’s initial suggestion to construct the forms with steel since “we don’t build houses in America out of steel,” she says. As an alternative, Kara proposed cross-laminated timber (CLT), which is still relatively new for residential construction in this country, but can be seen as a 21st-century variation on traditional wood-frame construction.

A CLT structural system allows the realization of what Peter Eisenman, FAIA, famously termed “cardboard architecture”—a piece of chipboard or cardboard in a model can be realized as a full-scale wall of durable construction. “If it can be made on the desk, it can be made real with the same technique,” Bonner says. “But instead of a strip of glue, it’s 14 10-inch screws; it slots



View from northwest, showing cementitious stucco finish with embedded glass beads.

## Project Credits

**Project:** Haus Gables, Atlanta  
**Client:** Jennifer Bonner and Volkan Alkanoglu  
**Developer:** Jennifer Bonner/MALL  
**Architecture/Interior Design:** MALL, Boston · Jennifer Bonner (director); Ben Halpern, Benzi Rodman, Justin Jiang, Dohyun Lee, Daniela Leon (project team)  
**Associate Architect:** Olinger Architects  
**General Contractor:** Principle Builders Group

**Structural Engineers:** AKT II; Bensonwood; PEC Structural Engineering; Fire Tower  
**CLT Manufacturer:** KLH Massivholz  
**CLT Installation Specialist:** Terry Ducatt  
**Wood Products Specialist:** 7 Seas Group USA  
**Civil Engineer:** Crescent View Engineering  
**Mechanical Systems:** Emily McGlohn, AIA  
**Façade Research:** Alex Timmer  
**Landscape Design:** Carley Rickles  
**Size:** 2,200 square feet  
**Cost:** Withheld

> For more materials and sources information, visit [bit.ly/HausGables](http://bit.ly/HausGables).

# Lighting Hospitality Around The World



## **FLXible Neon**

Ultra Slim Flexible LED  
with Spot-Free Output  
Great for Wet Locations

FLXible Neon 1

FLXible Neon 2

# FEELUX



## Residential: MALL

together that easily.” At times daunting, the process included the coordination of 87 different large-scale CLT panels from the manufacturer in Austria as they were shipped to Savannah, Ga., trucked to Atlanta, and eventually erected—over just days—on site. But the system allowed the many-peaked roof to be realized without the need for additional structural supports that would obscure the topography from inside.

At 18 feet wide, Haus Gables maximizes the available zoning envelope: The lower-level garage is accessed via a ramped drive; the main floor has a kitchen, a double-height dining room at the center, and a master bedroom at the front; and on the second floor, a second bedroom sits at the back, with a patio at the center and a living room at the front.

One problem with using the roof plan as the generator of form in a two-story

house is that it's the second-floor that enjoys the drama implied by the exterior, which explains why the living room is on the upper level where one might expect the master bedroom. On the main level, only the centrally located dining room is open to the acrobatic roof.

Befitting a multigabled house whose roofs will seem kerflooey to most, the interior projects a fun house vibe with bold applications of faux finishes and color combinations. “They’re amazing materials that are humorous and funny,” Bonner says. Most of the wallcoverings are low on the walls, like traditional wainscoting but in nontraditional materials, and they camouflage electrical runs routed into the otherwise exposed surfaces of the CLT panels.

The exterior is surfaced with a cementitious white stucco finish, in two patterns. The north and west façades display faux brick while the south and east elevations have just a few joints in the monolithic surface. Bonner added glass beads, typically used in road markings, to the stucco's finish coat to provide a subtle reflectivity.

Haus Gables is the perfect architect's house, in that Bonner explored formal interests outside the constraints of market forces. While CLT has a firm place in next-generation construction, it remains to be seen if the system's formal flexibility, as evident in Haus Gables, will take off in commercial applications.

### Roof Plan

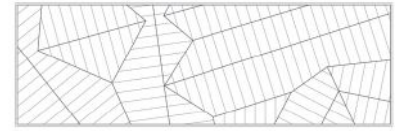

### Second-Floor Plan

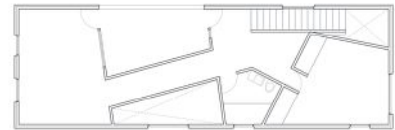

### Ground-Floor Plan

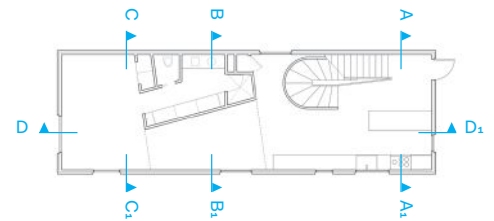

### Basement Plan

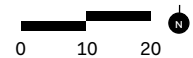
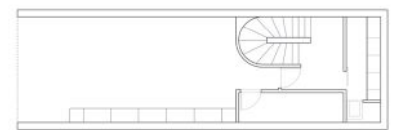

### Section A-A<sub>1</sub>

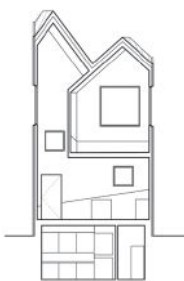

### Section B-B<sub>1</sub>

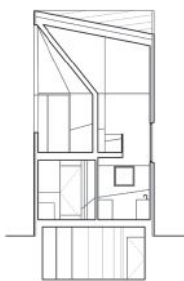

### Section C-C<sub>1</sub>

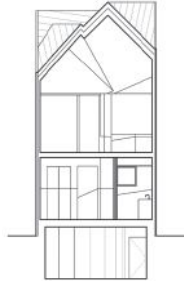

### Section D-D<sub>1</sub>



# GlowSTX™

**SURFACE AND SUSPENDED LIGHTING**



**ONE SYSTEM  
ENDLESS POSSIBILITIES**



Patent Pending

**GlowSTX™** includes a family of linear lighting elements and connectors that can be attached to form an endless array of shapes. Each linear section is only 3/4" wide by 2 1/4" tall in cross-section and up to 8' long in length. Connectors are adjustable to enable anything from a slight bend in angle up to a 60° return. GlowSTX offers both direct and indirect lighting options as well as an optional Adjustable LED Accent module that may be plugged in to any of the connectors for added design versatility.

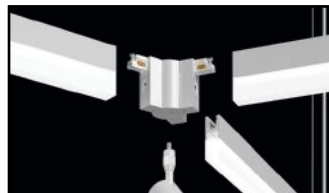

Flexible Connections



Direct / Indirect Lighting



Recessed Power Enclosures



Accent Lighting

**LF ILLUMINATION™**  
[ifillumination.com](http://ifillumination.com)

©2019 LF ILLUMINATION LLC



**Residential:  
MALL**



**1.** A ramp on the west side of the structure leads to parking on the lower level. **2.** The double-height dining area on the first floor features a bright yellow floor and walls that stand out from the exposed CLT-panel surface of the upper walls and ceilings above. The threshold of the master bedroom beyond is marked by a shift to gray accents.



EXQUISITE PERFORMANCE.  
BROUGHT TO LIFE.

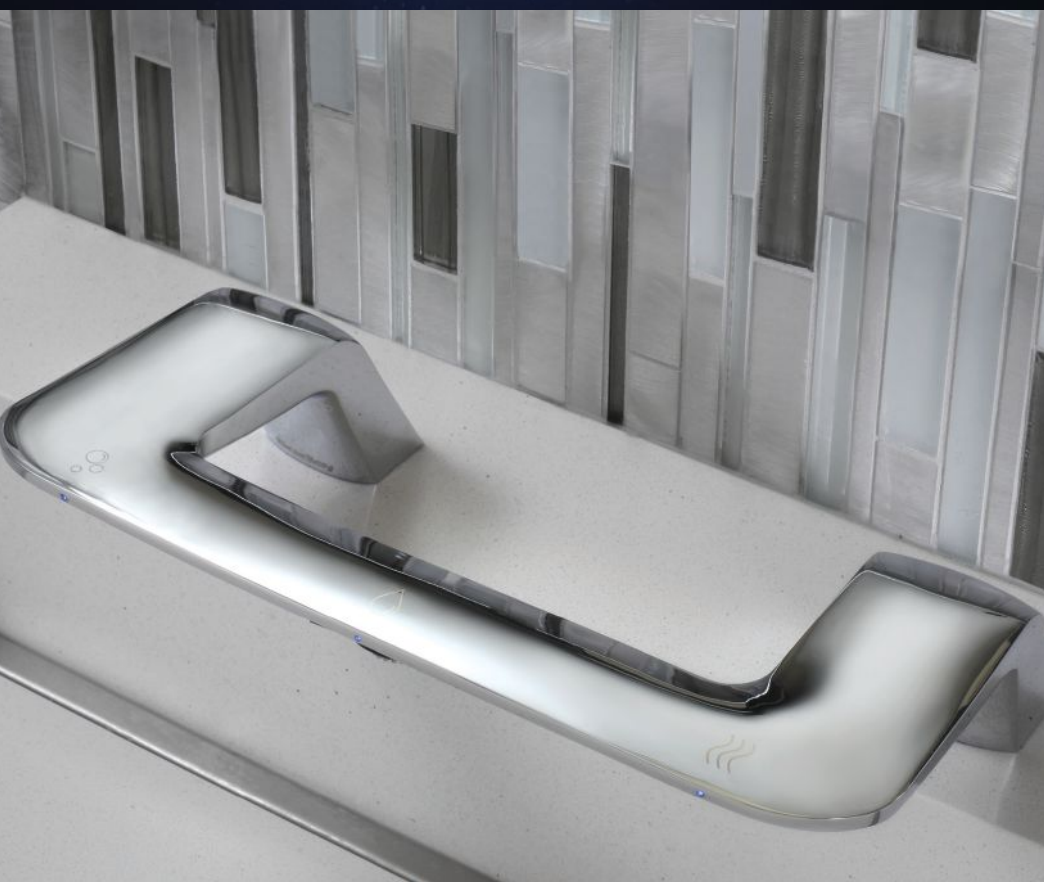

CLEAN. RINSE. DRY.



ALL-IN-ONE WASHBAR.

Bradley provides an unmatched range of commercial washroom products and solutions, like the award-winning WashBar,<sup>®</sup> available in custom basin options. With advanced design and cutting-edge performance, take your vision to the next level. **Commercial washrooms brought to life.**



HANDWASHING & DRYING | ACCESSORIES | PARTITIONS | LOCKERS

[BRADLEYCORP.COM/WASHBAR/ARCHITECT](http://BRADLEYCORP.COM/WASHBAR/ARCHITECT)



**Residential:  
MALL**



**1.** The ground-floor kitchen features EcoTerr tile floors.  
**2.** Looking southeast from the second-floor landing, one can see into the second bedroom at left, and the bathroom at right, which is lined with Ornamenta Artwork tile on the floor and walls.

# 167,000 SQUARE YARDS OF PREMIUM WORKING CONDITIONS

Thanks to a fast, safe and  
easy to install piping system

In the construction of a large-scale project like The Squire in Frankfurt, you not only count on the highest quality, but also the highest efficiency: a combination effortlessly delivered by Viega. Our high-grade piping systems, ProPress Stainless (according to U.S. standard) for drinking water and piping for heating installations, offer maximum reliability and can be installed with minimum effort. **Viega. Connected in quality.**



# DESIGNING RESTROOMS FOR SUSTAINABLE OPERATION

Presented by:



## SUSTAINABILITY: THINKING BEYOND LEED

In modern commercial architecture, LEED and green design are increasingly important and often expected by building owners. When striving for green design, using environmentally responsible materials on the building envelope or leveraging the Regional Materials credit by utilizing materials that require minimal transportation resources are usually top of mind for architects and designers.

Although strategies like these may include the richest sources of LEED credits and associated documentation, a greater focus on operational design strategies for the interior of the building can contribute toward overall sustainable intent. In fact, when striving for green design, being “authentically sustainable” will require a long-term approach to reducing impact on the environment and minimizing operational costs for the building owner.

### Benefits for Facilities

By designing restrooms to be authentically sustainable, facilities can make the most of their upfront investments in building products and reduce long-term operational costs, such as the following:

- Usage of consumables, like soap and paper towels
- Energy costs
- Water costs
- Waste and waste management costs
- Maintenance costs, as many sustainable products generally require less labor hours to maintain and improve worker productivity
- Potential tax incentives

A sustainable approach to restroom operation can optimize the life cycle of the building, thereby increasing the property value associated with the property. In addition to the many financial benefits, this approach can result in positive public relations, improved morale for employees or tenants in the building, and LEED certification for the building or other green building accolades or certifications.

## LEARNING OBJECTIVES

1. Explore the benefits and incentives applicable to building owners and occupants when specifying restroom projects that use sustainable design practices.
2. Explore common sources of costly, non-sustainable restroom operation and green building solutions that improve the financial impact, as well as the occupancy experience.
3. Analyze the relationship between sustainable operation and the preservation of the designer’s aesthetic vision.
4. Identify opportunities to educate clients on the benefits of sustainable restroom design options.

## CONTINUING EDUCATION

**AIA CREDIT:** 1 LU/HSW  
**AIA COURSE NUMBER:**  
 AR062019-1



**IDCEC CREDIT:** 0.1 CEU/HSW  
**IDCEC COURSE NUMBER:**  
 CEU-109275



Use the learning objectives to focus your study as you read this article. To earn credit and obtain a certificate of completion, visit <http://go.hw.net/AR062019-1> to view the entire CEU and complete the quiz. CEU courses are free of charge once you create a new learner account; returning users log in as usual. If you are new to Hanley Wood University, create a free learner account; returning users log in as usual.

### Tenant and Employee Satisfaction

For architects and designers, an “authentically green” approach can deliver a range of benefits beyond LEED certification including improved client relationships and a positive reputation in the market; endurance of the original design vision, as sustainable products are less likely to be replaced with less aesthetic products by the building owner; and satisfied tenants, leading to satisfied building owners.

Efficient restrooms make an environment more pleasant to work in thus contributing to increased satisfaction from tenants. For the building owner, this increased satisfaction translates to lower tenant turnover.

According to a 2015 study, there is a statistical link between tenant satisfaction and sustainability efforts involving cost savings from energy, water, and other forms of conservation. The study showed tenant satisfaction scores to be 7 points higher in buildings with at least one sustainability certification. Buildings that achieve LEED’s Existing Buildings (EB) certification for Operations and Maintenance scored 10 points higher than buildings that did not. ENERGY STAR buildings also scored 30 points higher in satisfaction compared to those without that certification.

Another study, conducted by the research firm Lightspeed in 2017, revealed that nearly one in 10 Millennials would quit their jobs if they found out their current employer was

not sustainable. Nine in 10 Millennials say it is important they work for a sustainable company, compared to 84 percent of Gen Xers and 77 percent of Baby Boomers. More than 80 percent of Millennials whose employer does not have a recycling system in place believe employers have a responsibility to encourage recycling in the workplace.

Similarly, the 2016 Deloitte Millennial Survey concluded that millennials actively seek employers whose environmental values align with theirs. These findings underscore the role that sustainable operation can play in helping buildings satisfy their tenants, improve retention, and support their overall business goals.

### COMMON SOURCES AND SOLUTIONS FOR COSTLY, NON-SUSTAINABLE RESTROOM OPERATION

When designing a green building, it is important to give thoughtful consideration to how the building will operate once it is occupied. When designing a prestige, Class A and/or LEED certified building in particular, being authentically sustainable requires a holistic approach to reducing waste throughout the entire lifecycle of the building.

To enable sustainable operation, it is critical to give thoughtful consideration to the products that are being specified. Products that should be considered are those that save money and resources, including products that reduce

waste, energy consumption, and usage of consumables and water, as well as products that do not use batteries. Products that are timesaving and easy to refill and maintain should be considered.

### Excess Waste

Specifying inappropriate solutions can result in excess waste, which can be a primary contributor to non-sustainable operation of restrooms. For example, specifying an inappropriate towel system is one cause of excess waste, as some paper towel systems can be more inefficient than others. Many roll paper towel systems leave what is known as a “stub roll” at the end of each roll. This is comprised of a portion of unused paper towels that must be discarded, resulting in excess waste.

As no-touch accessories gain in popularity, battery usage becomes an important

### GLOSSARY

**Authentically Green**—Deliver a range of benefits beyond LEED certification that includes improved client relationships and a positive reputation in the market; endurance of the original design vision, as sustainable products are less likely to be replaced with less aesthetic products by the building owner; and satisfied tenants, leading to satisfied building owners

**Authentically Sustainable**—Long-term approach to reducing impact on the environment and minimizing operational costs for the building owner

**Bottom Fill Soap Dispensers**—Cause additional labor, time, and strain to maintain

**Bulk Soap System**—Utilize foam soap, which is highly sustainable; patrons tend to use less soap than liquid soap

**Cartridge Soap Dispensing System**—Lead to excess plastic waste; cartridges are often proprietary, limiting owner’s purchasing options; requires extra labor from janitorial staff when refilling; generally empties faster than bulk systems

**Fiber Optic Sensors**—Generally more reliable than infrared sensors, leading to less waste

**Infrared Sensors**—Popular touch-free option in restrooms; however, can result in wasted water or consumables; beam does not always deactivate properly

**Regional Priority Credit**—Introduced in the LEED 2009 rating system; different regions designate existing LEED credits as important for their area

**Stub Roll**—Comprised of a portion of unused paper towels that must be discarded, resulting in excess waste

**Top-fill Soap Dispensers**—Staff only need to remove a cap or top to refill the soap; less time and labor intensive than bottom fill dispensers





consideration. Used batteries are waste that must be disposed of and/or recycled; however, alternative power sources are available.

Specifying an inappropriate soap dispensing system can lead to excess plastic waste. In particular, cartridge soap dispensing systems require the facility to use smaller, individual plastic soap cartridges that often are proprietary; restricting the owner's purchasing freedom. With each refill, janitorial staff must replace the previous plastic cartridge with a new one. Furthermore, cartridge soap generally empties faster than bulk systems. Over time, this excess packaging can lead to more waste, in addition to the costs and hours of labor associated with replacing the cartridges.

### Reducing Soap Usage

To address the excess plastic waste associated with proprietary soap dispensing systems, non-proprietary, bulk soap systems are available. These systems deliver a range of benefits, including enabling the usage of universal soap, which can be purchased on the open market, thereby reducing costs and offering greater choice.

These systems also eliminate the labor-intensive replacement and disposal of partially filled cartridges. Many bulk soap-dispensing systems utilize foam soap, which is a highly sustainable choice, as patrons will tend to use less foam than liquid to achieve an effective hand-wash. Foam soap dispensers diffuse air into a liquid foaming soap solution to create a lathery foam that today's patrons often prefer over liquid or lotion soap.

Foam soap offers numerous cost and sustainability benefits over liquid soap, including reduced number of hand washes for a given volume of soap and increased soap volume compared to liquid soap. The air in the foam bulks up the soap to ten times its original volume, providing greater hand coverage. This results in decreased soap and water usage by patrons. Finally, a rich lather promotes a complete, luxurious, and effective hand-wash, enhancing the patron experience.

### Reducing Maintenance

The filling mechanism of the soap dispenser can have a significant impact on maintenance costs of the restroom. Bottom-fill dispensers are a primary culprit of janitorial strain and labor hours, as they require staff to bend under the lavatory counter to replace a proprietary soap cartridge. This process often requires



At the Long Beach Convention and Entertainment Center in California, maintenance staff was having difficulty refilling the soap dispensers. Soap ran out frequently due to busy trade shows and conferences. Since the system was a proprietary, cartridge-based system, it was necessary for maintenance personnel to crawl underneath the sinks to refill the cartridges.

Often, while replacing the cartridges, paneling under the sink would become dislodged and fall on workers. In addition, due to the sheer number of dispensers and the size of the convention center, maintenance staff regularly would dispose of cartridges containing small amounts of soap to avoid making additional trips to and from the restrooms.

However, by switching to a manual bulk foam dispenser throughout the facility, staff was able to replace previous soap cartridges with jug foam soap. The dispenser's top-fill design also significantly reduced the strain on maintenance staff. Plus, the dispenser's 34-ounce bottle capacity meant that maintenance staff would be returning for refills less often.

Ultimately, more than 300 units were installed throughout the entire convention center. After installing the dispensers, the convention center reported they were spending 80 percent less on soap compared to their previous system.

maintenance staff to temporarily remove the ADA panel below the lavatory, which equates to additional time and strain.

Due to the cost of maintenance, it is common for bottom-fill dispensers to be replaced with owner-provided dispensers early in the restroom's lifecycle. Plastic, mirror-mounted dispensers typically are chosen to replace the specified, bottom-fill product.

Top-fill dispensers, on the other hand, save time and effort by eliminating this process. Janitorial staff simply need to remove or slide a cap off the top of the dispenser to refill it with bulk jug soap. Over the course of a restroom's lifetime, these labor savings can make a significant impact on operating costs.



### Optimizing Paper Towel Consumption

To promote sustainable, economical operation while meeting the needs of users, hand-drying solutions should be appropriate for the building type and occupancy of the given project.

While roll paper towel systems generally are considered more sustainable than folded paper towel systems, employing a few strategies can help further ensure sustainable operation.

Many units feature adjustable towel pull lengths and portion control features to limit the amount of towel dispensed per use, which reduces waste. Some units also feature shorter second pull lengths and delayed second activation to further discourage wasteful dispensing. However, in high-traffic environments, portion control features may have a diminished effect.

Some units are equipped with stub roll utilization functionality, ensuring that every roll goes furthest and providing complete consumable usage and less replacement time. In addition, many roll towel systems permit open market purchasing freedom and cost savings by allowing facilities to utilize non-proprietary paper towels at a lower cost than proprietary paper towels.

While roll towels are generally more sustainable, many facilities prefer folded paper towels for their versatility and to eliminate stub roll waste. For example, employees often use folded towels at their workstations, to remove makeup, grab restroom door handles and clean up minor spills. Folded towels are more absorbent than roll towels, and since all towels are the same size, portion control is built-in. However, it should be noted that patrons often are responsible for "handful" dispensing when using folded paper towel systems.

Fortunately, solutions are available to mitigate the impact on paper towel usage, as folded paper towel dispensers can be equipped with

accessories that enable portion control. Such accessories eliminate handful dispensing by separating individual C- or multifold towels as they are pulled to ensure that only one towel is dispensed at a time. These units have been shown to be as economical as roll towel systems, reducing paper towel usage by up to 20 percent.



This photo shows a restroom of a high-end hotel lobby. Direct your attention to the counter, where you can see stacks of loose paper towels and a non-commercial soap dispenser. Both of those solutions are highly unsustainable.

The soap dispenser is low capacity, which means the operator will have to refill it more often. The dispenser also does not match the overall aesthetic of the restroom. Instead of a paper towel dispenser or hand dryer, loose stacks of paper towels are employed, which leads to waste. Patrons may grab a handful of towels, whereas an appropriate dispenser could limit dispensing lengths (in the case of roll towels) or ensure that only one towel is dispensed at a time (in the case of folded).

For this project, either the architect failed to specify a soap or paper towel dispenser, or she or he specified a non-sustainable solution, that was later replaced by the owner with solutions that are simultaneously less sustainable and compromise the aesthetic of the restroom.

Finally, note that the lighting in this restroom is antiquated, utilizing incandescent light bulbs and no automatic sensors.

QUIZ

- Which of the following should be taken into consideration when designing for authentic sustainability?
  - Energy and Water Costs
  - Use of Consumables
  - Maintenance Costs and Potential Tax Incentives
  - All of the Above
- What percentage of Millennials believe their employer has the responsibility to encourage recycling in the workplace?
  - 50%
  - 60%
  - 80%
  - 90%
- Which of the following is generally the most sustainable soap option for commercial use?
  - Cartridge Soap Dispenser
  - Bulk Soap System
  - Bar Soap
  - All of the Above
- Switching to a non-proprietary, top-fill soap dispenser allowed the Long Beach Convention Center to spend \_\_\_\_\_ less on soap in comparison to their previous cartridge-based system.
  - 80%
  - 55%
  - 40%
  - 10%
- Folded paper towel dispensers with accessories that enable portion control have been shown to be as economical as roll towel systems and can reduce paper towel usage by up to \_\_\_\_\_.
  - 10%
  - 20%
  - 30%
  - 40%
- Before specifying a hand dryer, which of the following should be considered?
  - Energy Impact
  - Institutional Aesthetic
  - Noise Levels
  - All of the Above
- With incandescent bulbs, \_\_\_ percent of the energy used goes toward heat, while only \_\_\_ percent is used to produce actual light.
  - 90; 10
  - 10; 90
  - 80; 30
  - 30; 80
- LEDs can have up to \_\_\_\_\_ maintenance-free hours of useful life.
  - 500
  - 5,000
  - 50,000
  - 500,000
- Key stakeholders in restroom design might include which of the following?
  - Property Management Company
  - Building Service Contractors
  - Facility Managers and Operators
  - All of the Above
- Which materials for toilet partitions score exceptionally high for graffiti, impact, and scratch-resistance?
  - SCRC, CL, and HPL
  - CL only
  - HPL only
  - None of the Above

SPONSOR INFORMATION



BUILDING VALUE SINCE 1906

Bobrick is a 100+ year-old global washroom accessory and partition company headquartered in North Hollywood, CA, with six manufacturing divisions across the United States and Canada and business operations in 85 markets worldwide. A leader in product innovation and manufacturing, Bobrick delivers best-in-class products and service, while fostering an environment of collaboration and continuous learning.

 This article continues on <http://go.hw.net/AR062019-1>. Go online to read the rest of the CEU course, complete the corresponding quiz for credit, and receive your certificate of completion.



**EXPERIENCE DAYLIGHTING**

**DONE RIGHT**

GLARE FREE, MUSEUM-QUALITY DAYLIGHTING™  
OUTSTANDING SOLAR HEAT GAIN CONTROL  
EXCEPTIONAL THERMAL PERFORMANCE  
ENERGY UPGRADES + RETROFITS  
SUSTAINABLE + RESILIENT  
MADE IN THE USA

CONTACT US TODAY AT [KALWALL.COM](http://KALWALL.COM)

# VRF REJECTED

Before you build, learn the truth.

[VRFREJECTED.org](http://VRFREJECTED.org)





# AIA Architect

## AIA Voices



PHOTOGRAPHY: JESSICA MILLETTE

## Design for Communities, by Communities

**Architects need to advocate for a different approach to affordable housing.**

Omar Hakeem, AIA, was in college at SUNY Buffalo when Hurricane Katrina hit. Months later, he traveled south to assist in disaster recovery efforts and was stunned by the horrific living conditions he encountered. From that point on, he committed to using his design skills to support others. He now does so as design director at buildingcommunityWORKSHOP, a nonprofit community design center that focuses on the endemic challenges many resource-strapped communities face.

As told to Steve Cimino

As architects, we need to be engaged in social issues. Whitney Young said it in 1968: “You are not a profession that has distinguished itself by your social and civic contributions to the cause of civil rights.” That’s still true to a certain extent. We’re not accessing a holistic cross-section of the United States, from a racial standpoint and from an economic one. As creative problem-solvers, we need to be seeking out challenges, and we need to do so within the framework of creating spaces and places that support our natural environments and ecosystems.

Integrating public interest design into one’s practice or career is challenging, and many designers don’t know where to start. The work John Peterson and Public Architecture have done with their 1+ program is phenomenal; it’s helped establish a national pro bono model. On the other hand, working solely in a pro bono format assumes that addressing difficult challenges must be done for free, or at night and on weekends. At buildingcommunityWORKSHOP, our operational model is roughly 50 percent fee-

for-service and 50 percent contributions. This may not be feasible for some firms, but it can be done.

The system needs changing from the top-down. We do many projects through the low-income housing tax credit (LIHTC) program, which is how most affordable housing gets funded these days. The process is not conducive whatsoever to design. The period when designers can work is very short and there’s no money to work ahead of the funding award; there is no guarantee that the project will even happen. We are trying to design multifamily projects—ideally where communities will thrive—on such a short timeline and with limited financial resources. It’s very difficult to produce quality work.

Working this way results in a lot of shovel-ready projects, built for communities that had no voice in the design. When you drive down the street, you can pick them out: “That’s affordable housing.” We need to change how the LIHTC process is laid out; we need more architects to advocate for a different way of working. **AIA**



# A'20

Save the date / May 14-16 / LA

[conferenceonarchitecture.com](http://conferenceonarchitecture.com)



# AIANow



ILLUSTRATION: JILLIAN PAUL

## Thirty-Eight Percent of Architecture Firm Billings Are Billed Using a Fixed Fee

By Michele Russo

At larger firms with 100 or more employees, nearly half the billings in 2018 were from projects billed with a stipulated sum (fixed fee). The second largest share of firm billings (28 percent) were billed using a professional fee plus reimbursables. For smaller firms, the largest share of billings were from projects billed using an hourly rate. However, use of hourly billing has trended down over the last few years. Billing projects based on percentage of construction costs has trended upward during the same time period.

Source: AIA's 2019 Business of Architecture Report



# AIA Feature

# Finding a Way Home

America's housing crisis is intensifying. A community-based approach may hold the solution.

By Katherine Flynn



PHOTOGRAPHY: BRIAN TOMAINO/TORTI GALLAS + PARTNERS

Housing types at Milwaukee's Westlawn Gardens were conceptualized to meet the needs of a variety of individuals and families: seniors, disabled individuals, families with young children, and bigger families with children of different ages.

## Two affordable housing projects in Wisconsin—and their architects—are part of a new, community-based approach to public housing, one that aims to change the way most people view this type of development.

In 1923, Milwaukee became home to the country's first public housing project. Garden Homes, on the city's north side, was an unprecedented experiment: a fan-shaped subdivision featuring streets lined with two-story Colonial Revival houses, organized around a central green park. While the neighborhood's history is marred by the legacy of segregation—at the time, Garden Homes was designated as whites-only—the design is still lauded by architects and planners as forward-thinking. Beyond its basic intention of providing housing for low-income and working-class families, Garden Homes was meant to be something more: a community.

Milwaukee's Westlawn, the state's largest public housing development, followed in 1952. Spanning a sizable 75 acres, it housed 1,800 low-income residents in 726 barracks-style housing units. As the decades wore on, it became clear that the boxy brick structures weren't accommodating their residents' needs; they weren't large enough to comfortably house families, and the large blocks where the buildings sat isolated their residents, physically and socially, from their surroundings. By the mid-2000s, the neighborhood's stormwater drains and energy systems had become severely outdated, and Milwaukee's housing authority began eyeing the site for redevelopment.

Murphy Antoine, AIA, principal at Torti Gallas + Partners, was the project lead on the ground-up redesign of Westlawn, rechristened Westlawn Gardens. The project's \$82 million Phase 1 was completed in 2012, funded by the largest low-income housing tax credit award in the state's history.

“We were really trying to make a place that was going to—and is going to—serve the Housing Authority and the city of Milwaukee's residents, and make a more mixed-income community,” Antoine says.

Inclusive and collaborative design was a theme that carried through to Tree Lane Family Apartments in nearby Madison, Wis., a project of the Chicago-based nonprofit Heartland Housing. While Tree Lane, in contrast to the sprawling neighborhood of Westlawn Gardens, is only one building on a much smaller plot of land, its goal is also to provide a high standard of living through a community-based approach. The four-story, 45-unit building opened in June 2018, with an emphasis on in-house social services.

### Active Listening

Throughout the design processes, Torti Gallas + Partners, Kindness Architecture + Planning, and Entelechy for Westlawn Gardens, and Valerio Dewalt Train Associates for Tree Lane prioritized the voices of the communities that the developments would be serving.

One of the biggest challenges facing Antoine's team during the Westlawn Gardens redesign involved conceptualizing housing types that would meet the needs of a variety of individuals and families: seniors, disabled individuals, families with young children, and bigger families with children of different ages. Between 2008 and 2010, Torti Gallas + Partners held regular public meetings, workshops and charrettes in Westlawn Gardens' Silver Spring Community Center.

“We were able to draw during the conversations and then meet a couple of days later, instead of weeks or months later, to say, ‘Is this what you had in mind?’ to get reaction and real-time feedback. The process itself, being there and having really quick feedback loops, was a big part of it,” Torti Gallas' Antoine says.

In the case of Tree Lane, which was being built for brand-new residents, Heartland Housing partnered with Madison's YWCA to set up focus groups. Aside from on-site counseling and support services, communal gathering spaces and play areas for children were high priorities.

“In terms of those early meetings with [potential] residents, there was a social aspect with those folks that wanted places where they could meet as families and have a birthday party or potluck,” says David Jennerjahn, AIA, principal at Valerio Dewalt Train Associates in Chicago, the project architects for 7933 Tree Lane. He explains that many of the families in the building have multiple children, and one of their biggest concerns was where they could go when they weren't in school. Jennerjahn and his team addressed this by including a multipurpose room, a computer room, and outdoor play spaces for younger children who needed supervision.

“The times that I've been to the building post-occupancy, I've observed a number of residents who interact with each other—they help each other, they know each other, they kind of look out for each other and each other's kids,” Jennerjahn says. “It's clear that everyone tends to know everyone. ... I like to



# AIA Feature

CONTINUED

think the architecture is helping.”

Tree Lane is part of a larger Housing First initiative by the city of Madison, which prioritizes putting people who have experienced homelessness for a prolonged period of time into housing with few or no conditions. Voluntary support services are available to residents on-site. There’s mounting evidence that the Housing First model lowers overall costs for police, healthcare, and other support services. While Jennerjahn’s firm had worked on market-rate multifamily housing before, this was the first affordable housing project they had ever designed from scratch.

“You still pick high-quality materials, because you need them to be durable,” he says. “You don’t want to be replacing them in three years because you went with a low-quality or lesser-cost item. Where you’re trying to be efficient and where you’re trying to be smart about where you spend the money; that’s the difference.”

## Following the Money

Obtaining funding is a perennial problem for public housing projects throughout the United States. The awards and grants that are available, through the U.S. Department of Housing and Urban Development as well as state agencies, are highly competitive. Antoine says that Milwaukee’s Housing Authority has been particularly successful in securing grants from HUD, but in the case of Westlawn Gardens, the first phase of the project was facilitated almost entirely through state tax credits purchased through syndication by private equity. Tree Lane was financed through low-income housing tax credits, and subsidized rent from the city and county helps fund management and upkeep of the building.

“Sixty to 80 percent of your development costs are typically accounted for from the equity you raise from low-income housing tax credits,” says Michael Goldberg, executive director of Heartland Housing. “So, it’s a critical piece. Without it, this development wouldn’t have been built.”

In affordable housing, tenants typically pay 30 percent of their income. “You’re dealing with a very vulnerable population, that have experienced traumas, that may not have great work histories, that may not have strong educations, that may be dealing with mental illness,” Goldberg says. “The idea is, you’re never going to pay more than 30 percent of your income toward housing, and that amount will move as your income moves.”

In the case of Westlawn Gardens and Tree Lane, financial decisions also played a prominent role in the way sustainability and health elements were factored into each development. Jennerjahn and his team originally began designing Tree Lane to the WELL Building Standard, which, he says, focuses more on the health and wellness of the occupants than the building’s energy performance.

“We created a large feature stair that faces the outside and has light coming in,” Jennerjahn says. “[We] were trying to encourage residents to use that stair for circulating among the floors, rather than taking the elevator.” Although Tree Lane ultimately didn’t complete WELL certification due to operational requirements and the additional cost of receiving that accreditation, Jennerjahn says that what they did incorporate wasn’t for nothing. He and his team placed an emphasis on optimizing natural light and air quality, as well as keeping energy costs down by making sure the building envelope was up to the highest standards.

Westlawn Gardens’ Phase 1 achieved Silver status through the LEED for Neighborhood Development (LEED ND) criteria, which, Antoine says, was the highest at the time under those standards. “The bar was set pretty high, but all of those considerations are rolling into Phase 2,” he says. Phase 1 included updating the stormwater drains and the neighborhood’s energy grid. On an individual building level, Torti Gallas was able to build one of the homes to a LEED for Homes Platinum standard and get it accredited, subsequently building the rest of the housing to that same high standard.

“You could basically buy another house for what you were paying for the certification,” Antoine says. “It [was] the same project manual, the same specifications, the same standard for all the homes.”

Westlawn Gardens’ Phase 1 achieved Silver status in LEED for Neighborhood Development.



Westlawn Gardens residents enjoy the complex’s outdoor spaces.

PHOTOGRAPHY: BRIAN TOMAINO; TORTI GALLAS + PARTNERS

Phase 2 will have what Antoine calls a “higher standard for mixed-use,” with retail space and some market-rate housing. “Those aspects of a highly functioning and sustainable neighborhood come into play as well,” he says.

## Transitions

For the residents of Tree Lane, the transition out of homelessness has posed challenges. Since the building opened last summer, Madison police have responded to calls related to weapons possession, drug-related activity, domestic disputes, and overdoses. In February, the Madison Common Council approved \$275,250 for extra support programming throughout the rest of 2019 and will be seeking proposals from organizations offering support services beyond this year.

“Our role here in serving families is to try to be as holistic with case management as possible, with the underlying goal of supporting families to keep their housing as long as that is their own goal,” says Georgie Nazos, a housing specialist with the Road Home Dane County, which will be providing interim support services at Tree Lane until a longer-term provider is secured. She identifies racism, a lack of affordable housing in the community overall, and barriers to transportation as just a few of the challenges that the residents are facing. Homelessness continues to be one of Madison’s most pressing issues, with over 3500 people experiencing homelessness annually.

Goldberg sees these issues as an inevitable part of the path to providing this vulnerable population with long-term stable housing.

“We’re looking to create a home,” Goldberg says. “This isn’t transitional housing; it isn’t a shelter; it isn’t a program the way you sometimes think of group homes. This is an apartment building. It is their home.” **AIA**

# AIAContracts

## Interiors Projects are Contractually Different. Here's Why.

By Mike Koger

The seemingly minor details of furniture, furnishings, and equipment in an interiors project can have a big impact. In 2019, AIA updated its Interiors Family of contract documents, which account for the potentially complex legal issues inherent in interiors projects—be it a centuries-old renovation or a new shell building, devoid of interior walls and finishes.

Interiors projects are more likely to require predesign services, such as programming or test-fit analysis, as a necessary piece of the architect's scope. But from a legal perspective, furniture, furnishings, and equipment (or FF&E for brevity) make interiors projects unique.

The FF&E provider is another important part of the equation. Owners typically buy FF&E directly from vendors or manufacturers, bypassing the general contractor. This leaves an architect drafting two sets of drawings and specifications—one to form the basis of the construction contract, the other to form the basis of the FF&E contract. And with separate entities performing work under separate contracts comes the complexity of multiple bids, budgets, and schedules. There's also no industry standard for how an architect interacts with FF&E vendors. Some owners want to hire and manage vendors themselves, while others want to delegate this responsibility to the architect.

FF&E contracts are also governed by a different set of rules than construction contracts: those found in Article 2 of the Uniform Commercial Code (UCC). Article 2 governs the sale of movable goods such as furniture, and addresses irregularities that often occur in sales contracts. Unlike other contracts, the sale of goods are often not fully negotiated or committed to one writing. Often, buyers and sellers exchange their own proposed contracts and never formally agree to one set of terms. In other instances, they may agree on some terms while neglecting to address others. When disputes arise, the parties are left struggling to make sense of a muddy contracting scenario. The UCC addresses these contractual shortcomings and



The lobby of the Guest House at Graceland Resort in Memphis, Tenn., by HBG Design.

provides a set of rules that attempt to honor the parties' original intentions. If a term is missing, the UCC provides a default. If there are two proposed contracts with different terms, the UCC provides a method for reconciling the differences.

In essence, the architect's task on an interiors project is to finish the design of an existing building while dealing with both contractors and vendors and their various budgets, schedules, and contract documents, all while recognizing that these contracts will be managed, interpreted, and affected by two distinct sets of law.

### It's a Daunting Task, but Using the Right Contracts Can Help

AIA's 2019 update to the Interiors Family of documents includes the impact of the UCC on FF&E. The lead owner/architect agreement in this family, B152-2019, was reworked to draw clearer distinctions between interior architectural design and FF&E design. If an architect is only performing one set of services, the other can be easily redacted. This separation also allows architectural interior design and FF&E design to progress on their

Clearer distinctions now exist between interior architectural design and furniture, furnishings, and equipment design.

own independent schedules with separate budgets and estimates. B152 also establishes a baseline for interactions between the architect and vendors. For example, while the architect is expected to inspect FF&E upon delivery and when installation is complete, the architect is not required to purchase FF&E on the owner's behalf. But should that need arise, AIA has created a new scope of services document, B254-2019, that allows the architect to get paid extra for acting as the owner's purchasing agent.

AIA also modernized its vendor agreements to make them easier to use. The 2007 owner/vendor agreement was comprised of two parts: A151 and A251. Those documents have now been merged into one, A151-2019, which is intended for situations where the vendor will provide a large amount, or perhaps even all, of the FF&E for a project. In A151, the vendor not only sells and delivers FF&E, it performs on-site work such as placement, assembly, and installation. In 2019, AIA also added a second option for hiring vendors: the A152-2019, Purchase Order. A152 is a short document that was designed to allow sales contracts to be negotiated quickly. It is suitable for engagements that are limited to the sale and delivery of goods not requiring on-site work.

Interiors projects come with complex contracting issues. But recognizing these issues and using the right contracts for your situation is the right place to start addressing them. Visit [aiacontracts.org](http://aiacontracts.org) to learn more about the AIA's Interiors Family of documents. **AIA**

*This article is not meant in any way to provide legal advice. If professional advice or other expert assistance is required, the services of a licensed professional should be sought.*





# SHARE YOUR IMPACT.

**You could win \$10,000 and a screening in Chicago.**

Rebuilding coastal communities, creating cost-effective housing, designing secure schools—architects partner with civic leaders to address today's most pressing issues. The AIA Film Challenge invites design professionals to share how they've improved communities. Winners get \$10,000 and a screening at Chicago Ideas. Each finalist receives \$500.

#AIAFilmChallenge

**Register now: [AIAFilmChallenge.org](https://www.aiafilmchallenge.org)**

Submit films by August 12.



**AIA Film  
Challenge**



# AIA Collaboration



Rachel Jefferson, executive director of the Historic Northeast Midtown Association, stands outside the future Northeast Grocer Co-Op.

PHOTOGRAPHY: MATT KLEINMANN

## In Kansas, Healthy Food for Healthier Communities

By Kathleen M. O'Donnell

In 2012, Wyandotte County was ranked the unhealthiest in the state of Kansas. A lack of fresh, healthy food had contributed to a public health crisis, and as of today, one census tract in the area has the highest estimated rate of Type 2 diabetes in all of the state. Instead of waiting for a corporate grocery store to take notice of food insecurity here, local organizations—with help from designers—have put matters into the community's hands by developing a plan for the Northeast Grocer Co-Op.

Matt Kleinmann, a University of Kansas doctoral student who has dedicated his academic and professional life to activism around health and the built environment, says that health disparities in a corner of Wyandotte County—northeast Kansas City, Kan. (KCK)—are exacerbated by systemic inequities. Today, there isn't a single full-service grocery store for the entire community of 20,000 residents. "This lack of investment puts all of our residents at a public health disadvantage, especially seniors and those that live below the poverty line, where

finding the nearest grocery store represents a major inconvenience," Kleinmann says.

Spearheaded by the Historic Northeast-Midtown Association (HNMA), the Northeast Grocer Co-Op is set to be housed along a historic corridor in a vacant storefront, which has already been cleaned out by community volunteers and prepped for upgrades. A series of engagement events and participatory design exercises are taking place throughout 2019, allowing community members to plan the co-op's future together.

Kleinmann's long-term involvement with the Northeast Grocer Co-Op includes coordinating design services. He is also developing "Holding Space," an interactive exhibit that invites residents to take part in the design process and documents the co-op project as it progresses. A participant in last fall's AIA Design Justice Summit, Kleinmann believes that giving community members decision-making power is imperative for infusing social justice into design.

"With 'Holding Space,' we're inviting the community to participate in developing their own visual narrative, which will be an interim installation on display as we seek to return a grocery store to the space. This gives our community the tools and capacity needed to hold space for reflection on where we've been and where we're going," he says.

KU School of Architecture's Dotte Agency, the design collaborative Kleinmann co-founded with professors Shannon Criss, AIA, and Nils Gore, AIA, will partner with YouthBuild KCK, an AmeriCorps Vista/United Way program that supports construction training for young people pursuing GEDs, to design and build the exhibit. "Holding Space," like many other initiatives spearheaded by Design Justice Summit participants across the country, will receive grant funding from AIA.

But the installation is just one important piece of the bigger project. The Northeast Grocer Co-Op is a massive undertaking with high hopes of transforming the social and physical health of northeast KCK.

Below, we asked Rachel Jefferson, executive director of the Historic Northeast Midtown Association, about the collaborative nature of the project and the promise it holds:

**Why is collaboration among community members, organizations, and designers critical to the success of the project?**

The Northeast Grocer Co-op is about a lot more than providing safe and affordable food in a food desert. Although that is an outcome of the project, the principles that guide the project are rooted in community self-direction and co-creation. Under-resourced



# AIA Perspective



PHOTOGRAPHY: GREG POWERS

Jefferson says that the grocer co-op will improve the economic and physical conditions of Northeast KCK.

communities like Northeast KCK are successful in furthering those principles when they have equitable access to cross-sectoral collaborations among community members, community organizations, institutions, designers that provide technical expertise, in-kind donations, and material resources to support the community's vision of itself.

**How does Holding Space factor in to the overall mission of the co-op project?**

Holding Space will capture the rich history of Northeast KCK by highlighting the area's previous economic and social vibrancy, with the intended outcome of garnering community support for future economic revitalization activities in the area. It provides an avenue for sharing the rich history of the community and the evolution of the Northeast Grocer project, while also functionally providing seating and storage space for the co-op.

**What is one hope you have for the future of your community? How does the co-op fit into that vision?**

HNMA's goal is to improve the quality of life for Northeast KCK residents while creating a more desirable, healthy, safe, and economically vibrant community. This project is providing Northeast KCK with an invaluable jump-start in managing their own food supply and improving the economic and physical conditions of a key part of Quindaro Boulevard, a major artery in Northeast KCK. In the long-term, this project will catalyze redevelopment along Quindaro and the Northeast by creating opportunities for ownership, economic self-direction, and cultural healing within the community. **AIA**

## Social Justice by Design

**Our legacy depends on our ability to help close divides through the power of design.**

Architecture is more than the product of the technological tools we use or the sum of our imagination and expertise. At its best, architecture is a lasting physical manifestation of our highest ideals and most cherished values.

While the world we live in today is the most socially aware and connected in human history, too many people still experience the daily indignities created by social injustice in all its variations. Our legacy and long-term relevance depend on our ability to help close the divides of class, gender, and race through the power of design. To that end, I believe that architecture and architects have an essential role in advancing social justice by focusing on design justice.

It is my opinion that the only way we will achieve those ends is by including the voices, experiences, and cultural perspectives of a diverse cross section of people.

As Henry David Thoreau observed, "It's not what you look at that matters, it's what you see." What we "see," to a considerable degree, is shaped by our experiences and how society sees us and relates to us throughout our lives. Therefore, in my view, advancing social justice through design justice and increasing the diversity and inclusion of the profession are inextricably linked. Diversity helps a team, a community, and even a nation "see" problems more holistically and find lasting solutions that satisfy the needs and encourage the achievements of everyone.

For architecture and architects to thrive in an ever-more-complex and diverse world, the creativity, contribution, and leadership of

everyone will be essential, without regard to gender, race, or socioeconomic background.

Why? As the trend toward greater urbanization continues, the expertise of architects could and should be central to finding equitable and just solutions. Today, more than 50 percent of people worldwide live in cities. By the end of the century, some estimates put that number at close to 90 percent.

As the urbanization trend continues, humanity will be even more dependent on the built environment. That could fundamentally change the role of the architect in society.

Architects could be at the forefront of creating a more equitable and more just built world—and by extension society—no matter the nation, but only if we have the innovation, ingenuity, and leadership of everyone who shares our vision.

The choices we make today will determine if architects can be trusted partners who will deliver solutions that help solve society's most urgent challenges and promote social justice, or if the profession is an artifact of a bygone era, relegated to the sidelines of social advancement and achievement.

Ultimately, we are more than designers and builders—we are facilitators. We are at our most effective when we remember that everyone deserves to be heard. As we are called on to lead efforts to meet the challenges of fighting climate change and increasing sustainability, economic equity, and opportunity for all, the profession of architecture must reflect the demographic diversity of society.

To achieve our fundamental goal of driving positive change through the power of design, we have to empower those who have been too long ignored. We have to create spaces that allow everyone to become their best selves through the power of design. **AIA**

William Bates, FAIA, 2019 AIA President

SEE THE BEAUTY IN OUR  
**REFLECTION**

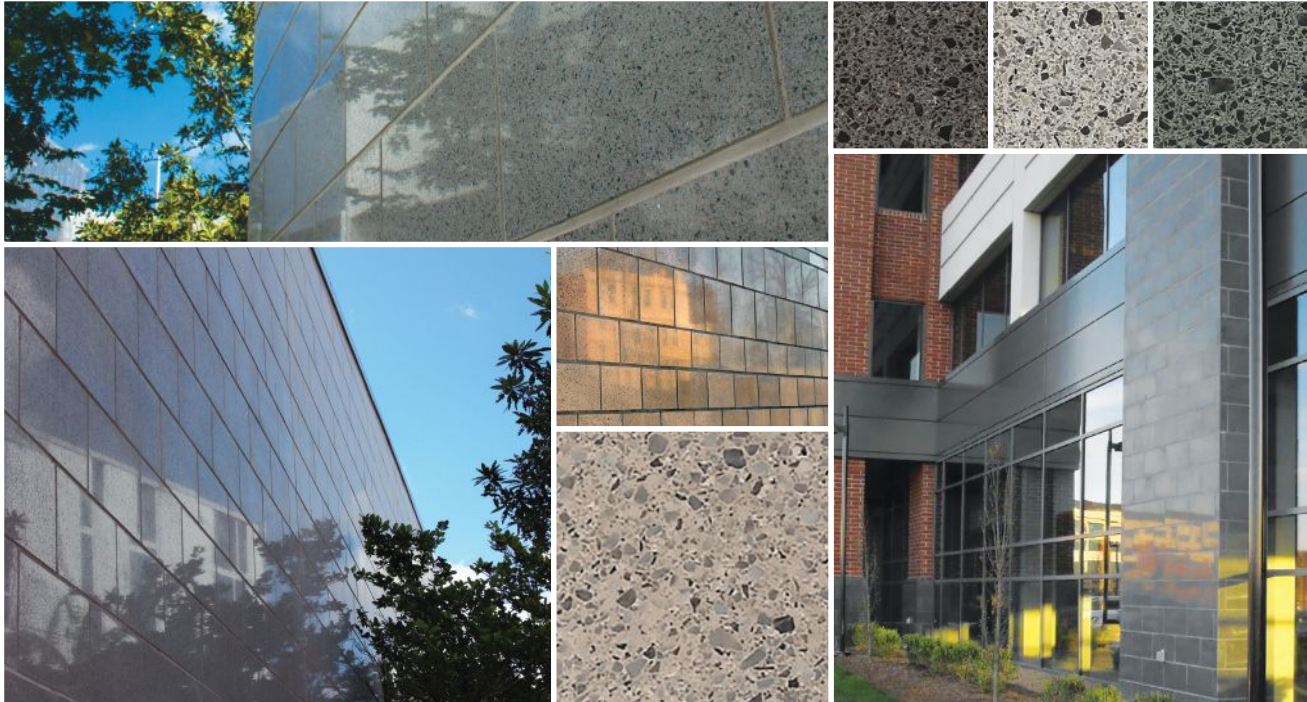

IT 'S A NEW DAY FOR CONCRETE MASONRY

With a highly polished finish that's unsurpassed in the industry, Reflective Series concrete masonry units create an impressive and resilient application for both interior and exterior use.

It might look like granite or marble—but at half the cost and a monolithic appearance without restrictive tile cladding, they offer exceptional value.

**Visit [edillon.com](http://edillon.com) or call (800) 234-8970 to learn more and request a sample.**



AN AMERICAN OWNED COMPANY SINCE 1868





Unique bulb shapes. Original fixtures.  
Custom colors. Your own plug & play  
system. Control color and brightness.  
Eliminate shadows and glare.

Make the switch to TCP for custom lighting systems  
made exclusively to showcase your space.

### Why TCP?

*\*Start-to-finish solutions from your own dedicated engineering, mechanical  
design and manufacturing team - **from prototype to installation.**\**

Our suite of expert services and custom solutions include expertise in design  
installation, energy saving solutions, rebates and more.



\*TCP reserves the right to change modify or cancel these programs at any time with or without notice.  
All pricing is valid in the US only through December 31, 2019 at a TCP certified electrical distributor.  
Please contact TCP for full details.

“The rebirth of Saarinen’s landmark can be seen an exercise in mid-20th-century nostalgia informed by 21st-century Instagram-driven placemaking.”



In a light-filled, one-room architecture studio in Brooklyn's **DUMBO** neighborhood, Anne Marie Lubrano, AIA, is talking Camelot. When the small firm she founded with Lea Ciavarrá, AIA, began working on the project that would transform Eero Saarinen's beloved but long-vacant 1962 TWA Flight Center into a hotel and conference center, it was 2014. The Obama family was in the White House and there was a sense of optimism that Lubrano thought must have been akin to the way the country felt when the Kennedys were in residence.

The revival of the TWA terminal, constructed at Idlewild (now John F. Kennedy) Airport in Queens when air travel was still stylish and commercial jets were much smaller—a hundred passengers on average—is clearly an attempt to monetize the *joie de vivre* of the early jet age. As hotelier Tyler Morse, the CEO and managing partner of MCR Development, the company behind the project, told *The New York Times*: “Sixty-two was a special year: John Kennedy was president, John Glenn circled the Earth, the space race was on.” To Lubrano, born when Nixon was president, 2014 felt just as special. “I can remember meeting Tyler and just feeling like the city was still booming and there was this hope and aspiration.”



The terminal's sunken lounge circa 1962

All that hope and aspiration culminated in mid-May with the reopening of the Flight Center, which had been mothballed after TWA went bankrupt for the final time in 2001. The historic terminal, restored by Beyer Blinder Belle (BBB), now serves as the entryway and lounge for a 512-room hotel designed by Lubrano Ciavarrá Architects; a newly dug basement includes an additional 50,000-square-foot of event space.

The rebirth of Saarinen's landmark, with its restored sunken lounge smothered in TWA red, its walls lined with vintage travel posters designed for the airline by artist David Klein, and its pay phones preserved and conspicuously positioned, can be seen an exercise in mid-20th-century nostalgia informed by 21st-century Instagram-driven placemaking. The opening day festivities featured a performance by a less-than-convincing group of Beatles impersonators singing on the mezzanine-level footbridge as young performers dressed as pilots and flight attendants shimmied. Meanwhile, dozens of actual TWA veterans once again circled the terminal, many wearing their old uniforms.

I spoke with two sisters, Marcia Bytnar-Rouse and Karen Bytnar, who had both worked as flight attendants in the 1960s and '70s. They talked about how miraculous it seemed to come to work every day in this building (and then fly off to Paris or Rome). “It felt like we were in the future,” says Bytnar-Rouse. “Honestly, it still looks futuristic to me.”

#### A Starchitecture Trial Run

Except that future has moved on and gone places that neither Saarinen nor TWA anticipated. The Flight Center's architecture is less visionary than quaint. It doesn't speak of technological advancement but of craft; every oddly shaped opening and soft curve was handmade by contractors who were maestros of poured concrete. At night, when the whole curvaceous volume turns into a giant cocktail lounge, the shadows cast by all the convexities and concavities make it look like the set of a German expressionist film circa 1920.

The building represents an appealingly exotic vision of the past, one in which Idlewild decided that each major airline should have a symbolic stand-alone building, essentially giving the concept of starchitecture a trial run. Eero Saarinen, who escaped from the architectural shadow of his father, Eliel, when he won the 1948 competition for the St. Louis Gateway Arch, a great stainless steel wishbone that still looks structurally implausible, emerged in the 1950s as a progenitor of an unusually expressive architectural language. While some of his buildings were rectilinear to a fault—Bell Labs in Holmdel, N.J., comes to mind—many of them, like the Ingalls Rink at Yale University, with its curving concrete spine or Dulles International Airport outside Washington, D.C., with its ski jump roof, appeared to be equal parts liquid and solid.

Every fluid new Saarinen design was an invention, untested and full of engineering and aesthetic challenges. None more so than TWA, which was completed a year after Saarinen died of a brain tumor. The building's

# A 4-in-1 insulated sheathing that's second to none.

**Strong-R is a commercial all-in-one sheathing** that combines best-in-class insulation, structural reinforcement, a moisture barrier, and an air resistive barrier in one easy to install product. Meet the codes of today and tomorrow with Strong-R.

**Learn more at [oxep.com](http://oxep.com)**

## strong-R<sup>®</sup>

structural insulation

STRUCTURAL SHEATHING | WATER BARRIER | AIR BARRIER | INSULATION





Saarinen's historic terminal, now flanked by two new hotel wings

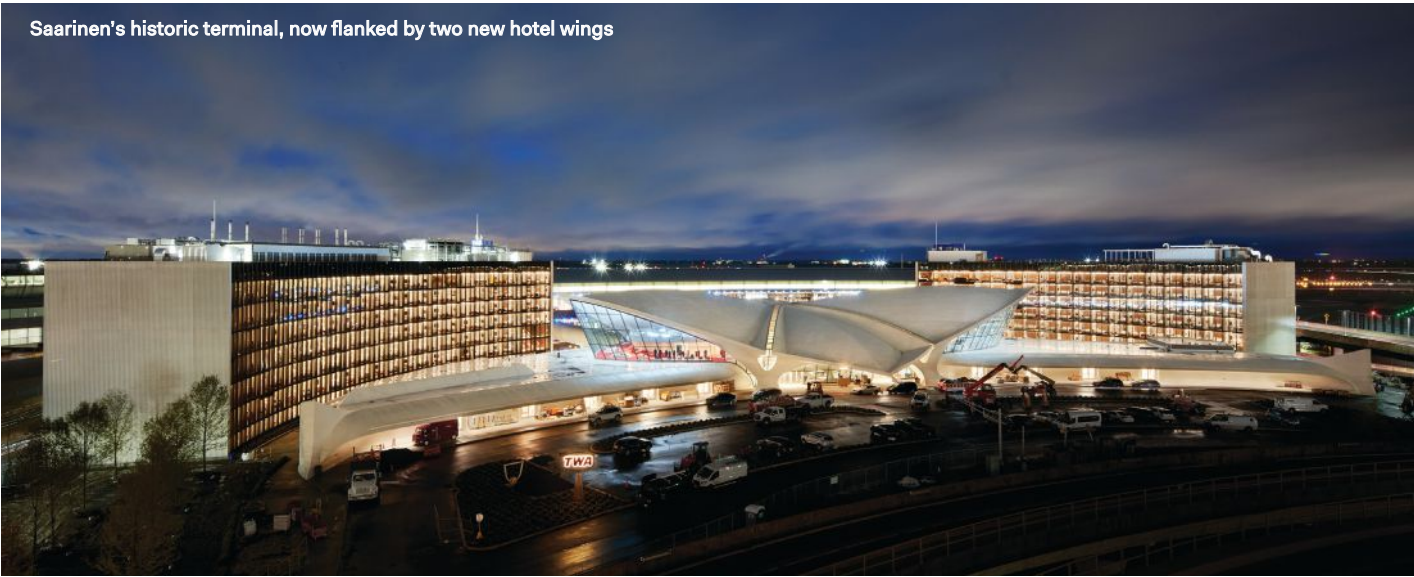

avian form, unlike, say Santiago Calatrava, FAIA's bird-inspired World Trade Center Oculus in Manhattan, didn't benefit from computer software that could calculate stresses or guide fabrication of components. The process of building the swooping concrete structure had to be improvised, Saarinen working in close collaboration with engineer Abba Tor of the firm Ammann & Whitney, and Grave Shepherd Wilson & Kruge, the contractor. To develop his unconventional concepts, Saarinen tried them on, fashioning huge models that he endlessly manipulated. A photo on the wall in one of the TWA Hotel's exhibition areas shows Saarinen face-down inside a Flight Center model, only his legs sticking out the back.

Most astonishing was the terminal's construction method. The August 1960 issue of *Architectural Forum* detailed how Saarinen's firm went from its "rough working models" to something like construction documents. What the architects gave to the contractors were, in essence, topographic maps. "From these 'contour maps' the contractor had to develop still more elaborate drawings to show every rib and connection for the actual form work needed to hold up the concrete on the site," the magazine reported.

Photos that ran with the story captured the intricacy and the improvised nature of the formwork—an impossibly dense construct of plywood and scaffolding that resembled those early Zaha Hadid paintings, in which unlikely architectural objects are alluded to by blizzards of polygons flying in all directions. When the last of the formwork was stripped away in late 1960, the fact that the 5,500-ton structure remained standing, balanced atop four concrete buttresses, was a near miracle. And the fact that it still stands, balanced like a bird on "spindly little legs," as Richard Southwick, FAIA, BBB's director of historic preservation, puts it, is no less remarkable.

The TWA Site Plan Over the Years



#### A Monument to Blissful Ignorance

You can view the Flight Center as a symbol of a time when air travel was exhilarating and stylish. Or a harbinger of the sort of architectural gymnastics we now take for granted. But you can also look at it as a symbol of confidence, a monument to the idea that we could will the world to behave in unprecedented new ways by relying on skilled know-how and audacious improvisation.

Yet the building can also be read as a monument to blissful ignorance or, perhaps, denial. One thing that Saarinen didn't know was that airplanes were about to get much bigger. The Boeing 747, which could be configured to carry as many as 480 passengers, was under development in the 1960s and began commercial service in 1970. As the airplanes grew, Saarinen's terminal began to feel smaller. According to Lubrano, it was designed for a capacity of just 600; later, "bat wings" were added on to the original bird to increase baggage storage capacity. Saarinen's other 1960s airport, Dulles, was enlarged in 1996 by extruding his great swoop of a terminal to double its original size. But that solution wasn't possible at TWA, a work of sculpture that simply couldn't accommodate the rising

# THE BEAUTY OF WOOD MEETS ADVANCED COMPOSITE TECHNOLOGY

G7A, Architect of Record; David Baker Architects, Design Architect

Fiberon<sup>®</sup> Composite Cladding for Rainscreen Applications features rich, nature-inspired embossing and multi-chromatic colors for superior wood emulation. Available in both open- and closed-joint profiles and a variety of lengths, giving you the ability to create a wide assortment of looks – from subtle and rustic to bold and modern.



*“Fiberon is aesthetically pleasing, has much better long-term performance, and offers a real advantage relative to maintenance cost.”*

*- Jeff Sheppard, AIA, Principal/Founder, Roth Sheppard Architects*

Learn more at [fiberoncladding.com](http://fiberoncladding.com).

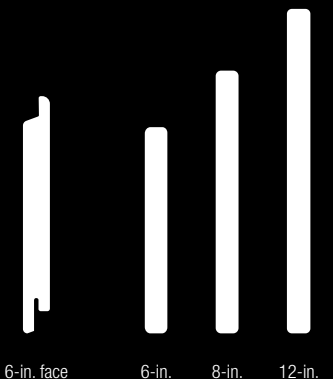

Closed-joint  
Board Profile

Open-joint  
Board Profiles



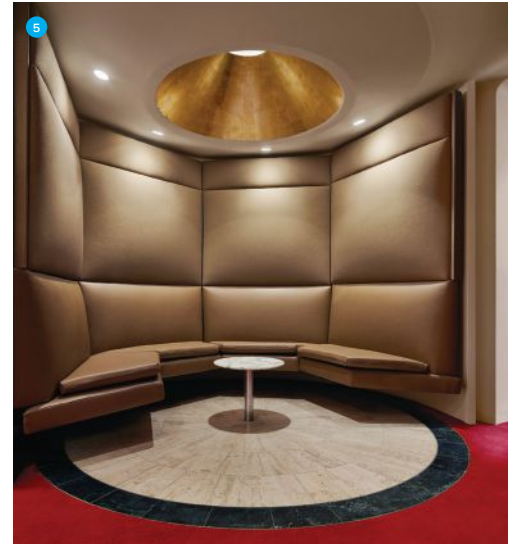
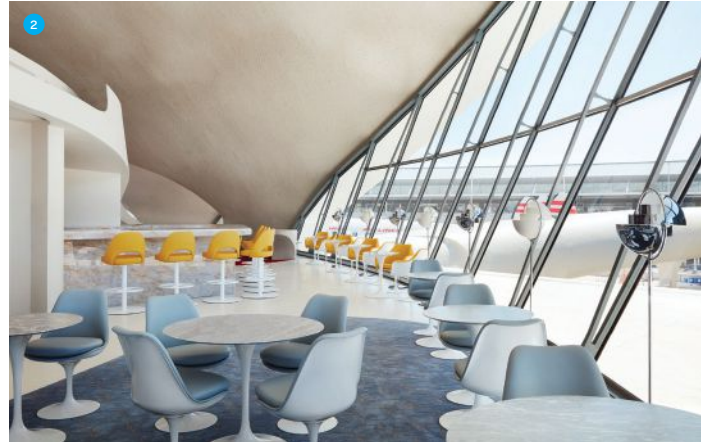
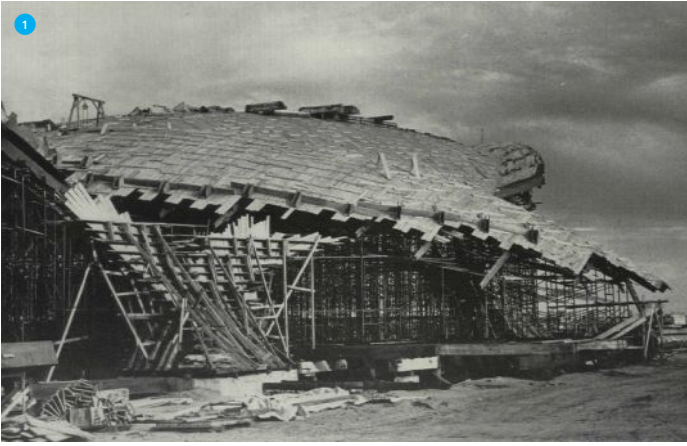

1. A photo in *Architectural Forum* showing the pouring of the terminal's roof 2. The renovated Paris Cafe 3. Guests check in at the rebuilt terminal counters (left) and then take a procession of steps up to the main level. 4. The 1962 Room, an events space that was previously a baggage claim area 5. The restored Pope's Room in the Ambassador Lounge





UN  
CONSTRAINED.

© 2018 NANA WALL SYSTEMS, INC.

NanaWall® HSW systems' single track sliding glass walls offer an unlimited number of panels up to 12 feet tall, creating wider, more sweeping views. Built to withstand weather and commercial use, our durable systems store remotely in bays or hidden closets, utilizing unused space efficiently.

Take your walls and ideas further at [nanawall.com/hsw](http://nanawall.com/hsw).

NanaWall®

Boundaries **Unbound.™**





Chisley™ Panel ©2018 modularArts, Inc.



Photo by Steve Hall, Hall + Merrick Photography. Designer: Eastlake Studio. Crush™ Panel ©2011 modularArts, Inc.



Doppler™ Panel ©2018 modularArts, Inc.

**modulararts®**  
**InterlockingRock™**

NFPA 286  
 PASS CLASS A

modulararts.com

206.788.4210

made in the USA

passenger numbers or the security infrastructure required after September 11.

Southwick of BBB, a New York firm renowned for its restoration work on landmarks such as Grand Central Terminal and the Empire State Building, began his long engagement with the Flight Center in 1994, just after the building was designated a landmark by New York City. The Port Authority of New York and New Jersey, which owns and operates the metropolitan area's airports, including JFK, has what's called "superior jurisdiction," meaning it could have ignored the landmark designation. "They wanted to know if they could tear it down," Southwick recalls. "I said yes, but I wouldn't want to be in your shoes."

According to Southwick, there were a variety of plans for the site in the 1990s and 2000s, including a combined United Airlines/JetBlue terminal that could



A restored flight tube, which connects to one of the hotel wings

have incorporated Saarinen's TWA. "Actually, a few days before September 11, there was a tour with Neil Levin," Southwick told me. "There was going to be a big article the Sunday after, stating that the TWA terminal was being saved, and this would be the keystone of all the new structures around it." Levin, the executive director of the Port Authority, was killed in the World Trade Center attack, and those plans never materialized.

In 2008, when I last saw Saarinen's TWA, JetBlue was putting the finishing touches on a terminal that it was constructing directly behind the historic building. At some point I heard that the Flight Center might serve as a dedicated gateway to JetBlue: Cabs would drop passengers at TWA, they'd walk through an architectural wonderland, and then into JetBlue's highly optimized environment. Southwick called it "a very romantic notion," one that "made no sense at all."

All along, the Port Authority had been searching for a development partner that could transform the





**acolyte**<sup>®</sup>  
Architectural Lighting Solutions



# ARMOR SERIES

WITH GEL-FLUSH TECHNOLOGY



### MINI LINEAR FIXTURE

- Lumen Output:  
750-900 lm/ft (2460-2952 lm/m)
- Available Lengths  
For US Version:  
8.46" (215 mm), 16.1" (410 mm),  
23.8" (605 mm), 46.9" (1190 mm)
- Available Lengths  
For International Version:  
7.28" (185 mm), 19.7" (500 mm),  
39.4" (1000 mm)



### NANO LINEAR FIXTURE

- Lumen Output:  
350-410 lm/ft (1148-1344.8 lm/m)
- Available Lengths:  
7.2" (182 mm),  
19.7" (500 mm),  
39.4" (1000 mm)



### RGBW MINI LINEAR FIXTURE

- Lumen Output:  
1250 lm/ft (4100 lm/m)
- Available Lengths:  
12.3" (313 mm), 19.7" (500 mm),  
23.8" (605 mm), 39.4" (1000 mm),  
47.2" (1190 mm)



# Fire Resistant. Design Consistent.

## Fire-Rated Aluminum Window And Door Systems

Alufam has a complete offering of true extruded aluminum fire-rated vision doors, windows and glazed wall systems, fire-rated for up to 120 minutes. Available in all architectural finishes, our products are almost indistinguishable from non-fire-rated doors and windows. You won't have to compromise aesthetics to satisfy safety regulations.

alufam



Alufam North America  
562-926-9520  
alufam-usa.com



A hotel room, complete with martini bar and Womb Chair

Flight Center into a hotel. André Balazs, known for the Standard Hotels and Chateau Marmont, originally won the bid, but his business plan turned out to be impractically modest, and he pulled out. In 2014, Morse and MCR made their successful pitch, which hinged on having enough hotel rooms to make the project financially viable.

Lubrano's design team was able to make space for the two new hotel wings by demolishing the various additions that had been made to the Flight Center over the years. The new wings curve subtly and act as a backdrop for the historic building, concealing what couldn't be removed, including the JetBlue terminal. Inside the Flight Center, BBB attempted to re-create the experience of TWA circa 1962. "So we ended up doing all the glass. We did that sunken lounge. That was all plywood-ed over at one point," Southwick told me. As for the passenger check-in area (now the hotel check-in), "we ended up reconstructing it entirely using old shop drawings." A Queens-based upholsterer re-created the banquette seating, and a factory in China replaced millions of aspirin-sized Italian tiles. The Ambassador Lounge, the one dining area that was seamlessly designed by Saarinen (the other restaurants were farmed out to Raymond Loewy's firm), with seating by Eames and a Noguchi fountain, was meticulously restored. The old terminal now looks conspicuously new.

Some things are different, of course. An old baggage carousel space is now a ballroom. There's a simulated tarmac outside the sunken lounge with a 1959 Lockheed Constellation airplane that's been converted into a cocktail lounge. The famous tube-shaped passageways that used to lead from the central





## DRYER VENTS



Model: **SB-P**  
4" & 6" Aluminum



Model: **SFB-P**  
4" & 6" Aluminum

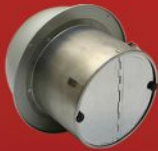

Model **SFZC**  
4" & 6" Aluminum



Model **RCC-S**  
4" & 6" Stainless Steel

## VENT CAPS



Model **SX**  
3"-8" Aluminum



Model **KX**  
3"-6" Aluminum



Model **SFX-S**  
4" & 6" Stainless Steel



Model **SXL**  
10"-16" Aluminum

## FRESH AIR GRILLES



Model **JRC**  
4" & 6" Aluminum



Model **JRA**  
4" & 6" ABS Resin



Model **DK-M8**  
3", 4", 6" ABS Resin



Model **JSP**  
4" & 6" ABS Resin

► If you are interested in becoming an authorized international distributor, please contact us. (Except the United States/Canada/Mexico/Japan)



**SEIHO** | [seiho.com](http://seiho.com)

 We Ship Worldwide



Seiho International, Inc. 120 W. Colorado Blvd. Pasadena, CA 91105 Tel: (626) 395-7299 Fax: (626) 395-7290 info@seiho.com



# BANKER

YOUR WIRE MESH AUTHORITY



**PRACTICAL IDEAS  
IN YOUR HANDS**

Contact us now to receive a  
sample box customized for you!

WWW.BANKERWIRE.COM | 1-800-523-6772

part of the terminal to the gates now take guests to the hotel wings. And there's a heated pool and cocktail lounge on one hotel rooftop, overlooking a very busy runway and a natural gas-fueled power plant atop the other wing.

The rooms themselves are 1960s-inspired and feature Saarinen-designed Tulip Tables and TWA-red Womb Chairs, and the kind of pole lamp that was so ubiquitous in the mid-20th century that even my unstylish parents owned one. Mike Suomi, Assoc. AIA, a principal and vice president of interior design at Stonehill Taylor in New York, the firm behind the design, said that the rooms are mostly intended for short-term guests who might be incapacitated by jet lag. "We wanted to create an oasis so that it took the traveler away from the hectic nature of air travel today, gave them a place to relax and unwind."

#### **A Bittersweet Fantasy**

I'm thrilled the Flight Center was preserved and restored, and is once again full of life. I especially loved the view of Saarinen's building that I got from my hotel room during my stay on opening night. My bed faced the window, which is 5 inches thick and blocks the airport noise. I peered out into the former Ambassador's Club; the Noguchi fountain was about even with the foot of my bed. I saw the swoop of the great roof and everything around it. An elevated AirTrain track, a parking garage, and an awkwardly asymmetrical control tower—all were visible in the near distance, but the contrast of their dull brownish concrete helped make Saarinen's freshly painted white terminal appear to gleam.

Yet I remain wary of the nostalgia the project conjures; I'm not entirely comfortable with our bottomless fascination with midcentury Modernism. And I find it disconcerting that Morse has transformed the logo and trade dress of a dead airline into a 21st-century style brand, applying it to everything, including the employees, who are costumed in updated flight uniforms.

**The flight center connects directly to Terminal 5, via an elevator (the buttons are labeled "1960s TWA HOTEL" and "PRESENT DAY JETBLUE"). When you step into the present day, the effect is jarring. Saarinen's TWA has long been a totemic object for the design crowd, but part of its appeal might be that the vision it embodied was devastatingly wrong. It was built for a past that only barely existed and for a future that didn't want it. Lubrano had it exactly right. The flight-center-turned-hotel is a bittersweet fantasy, a congenial spot for happily ever after: Saarinen's very own Camelot.**





**THE MARK**  
YOU CAN TRUST

As North America's leading third-party certification body for plumbing products, with the most experience in the industry, the cUPC® mark is the certification mark you can trust — the mark of conformity that gives you peace of mind.

Contact us today for more details.



[WWW.IAPMORT.ORG](http://WWW.IAPMORT.ORG) 1.877.4.UPC MARK (+1.909.472.4100)

 **GREENBUILD**  
INTERNATIONAL CONFERENCE AND EXPO



**Get notified when registration opens this summer**  
[www.greenbuildexpo.com/notify](http://www.greenbuildexpo.com/notify)

**SAVE THE DATE**

EXPO: NOVEMBER 20-21  
CONFERENCE: NOVEMBER 20-22  
Georgia World Congress Center | Atlanta, Georgia



**151 North Franklin  
Chicago  
John Ronan Architects**

A new high-rise office tower joins its public spaces to the city around it.

TEXT BY KATIE GERFEN

PHOTOS BY STEVE HALL/HALL + MERRICK PHOTOGRAPHERS



L1

L2

L3

L4

L6

L7

L8





Green Space Diagram

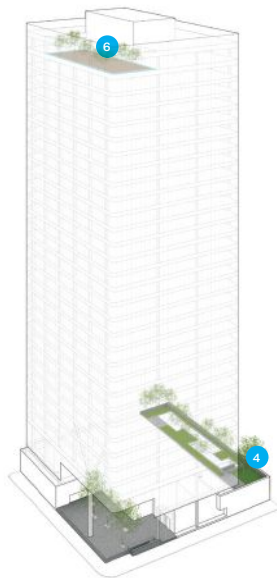

Ground-Floor Plan

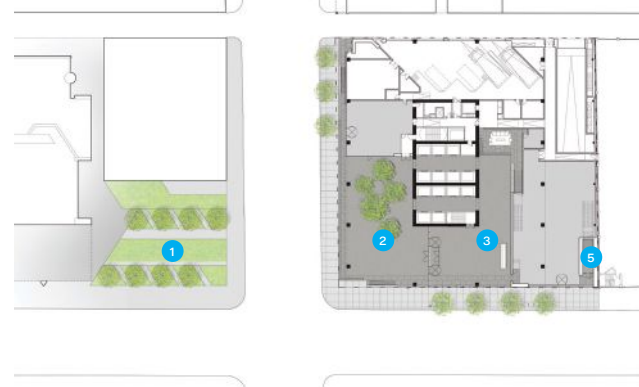

- |                         |                    |
|-------------------------|--------------------|
| 1. Existing pocket park | 4. Terrace         |
| 2. Plaza                | 5. Stair to street |
| 3. Lobby                | 6. Roof terrace    |



“Most architects who get a high-rise building immediately think about shape,” says architect John Ronan, FAIA. But that results in “a city full of self-referential object buildings with no dialogue.” For the design of 151 North Franklin, a spec office tower in his home base of Chicago, Ronan took the opposite approach: Instead of focusing on the building’s form, he asked, “How do you pull the city into the building? And conversely, how does the building make the city better?”

Ronan and the project team from his eponymous firm, John Ronan Architects, approached the commission with urban design in mind: Building upon an existing pocket park across the street, they extended the green space—or at least the idea of it—right through the structure, with a plaza and visually open lobby at the base, a terrace on the second level, and a glassed-in deck on the top floor. Ronan conceived of the exterior spaces as distinct environments—each suited to different activities, from lunch meetings, to quiet work, to unwinding at the end of the day—but also very much as a part of the whole. “I think of them as outdoor rooms,” he says. “What if we rethink public space in terms of collaboration lounges, so that people can leave the office without leaving the building?”

The plaza is carved out of the base of the tower, behind a colonnade, and features a scattering of birch trees and seating for a ground-floor café. The branches and leaves are hazily reflected in the linen-finished stainless steel ceiling panels two stories above, so that “the effect of the trees is amplified,” Ronan says.

The second-floor terrace feels more private, though it is open to the public via an exterior stair leading

directly to the street. “It gets direct sunlight from 11:00 to 1:00,” Ronan says, “and at other times it’s shady and contemplative.”

The tenants-only roof terrace is lined with glass walls that serve as a windbreak. It can accommodate large gatherings, but hawthorn trees in gabion planters define smaller seating areas. Placing a deck at the top of the tower was a pointed choice: At 36 stories, the tower is shorter than the buildings around it, so, Ronan says, “How much sense does it make to spend the money on a form at the top of the tower?” Instead, the terrace draws the street plaza into the skyline.

Ronan’s approach to creating flexible urban space isn’t limited to the outdoors, it extends to the lobby as well. Security at the elevator cores limits upper-floor access to tenants, but the majority of the space remains publicly accessible. “It feels like a grand lobby,” Ronan says, “but at the same time there are spaces within the lobby that feel smaller and more intimate—like a sunken lounge.”

Ronan specified Jet Mist granite as a nod to the conventional trappings of Class A lobby space, but eschewing what he calls the “mausoleum-like” feel of many tower lobbies, he chose three finishes—sandblasted, flamed, and honed—to make it less formal. The core is clad in sandblasted mirror-finish glass to reflect the birch trees and the daylight from full-height windows at the end of each elevator bank.

“Object buildings exclude you because you have to be outside of them to appreciate them,” Ronan says. “I wanted people to feel welcome, and to have it be a real place in the city.”

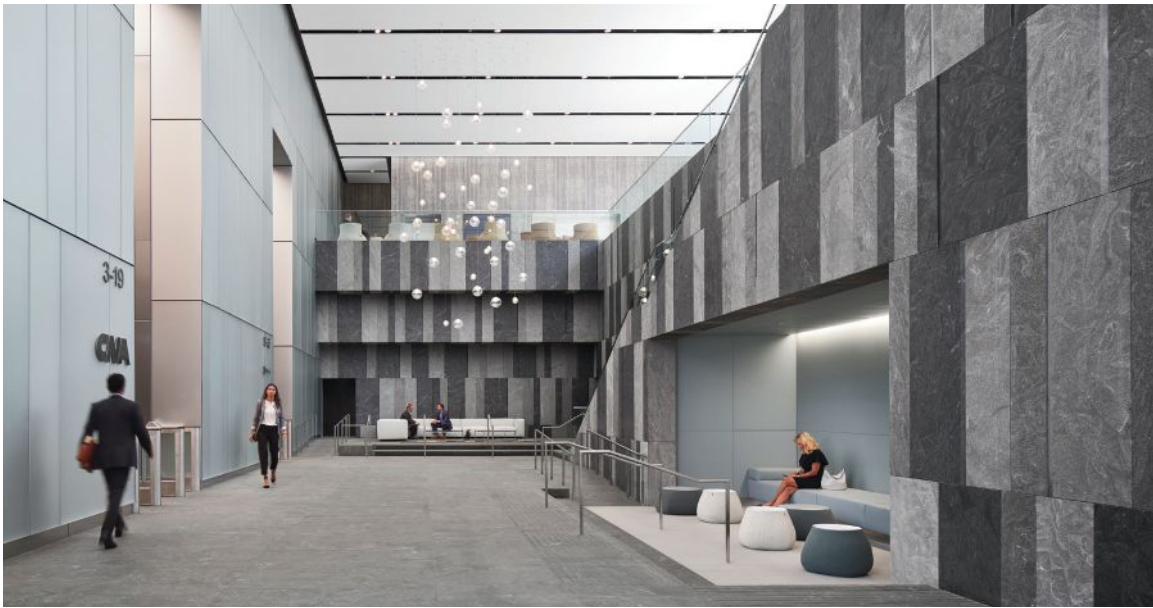

*Previous Spread:* Elevator core with view out to birch trees in ground-floor plaza

*Opposite:* Dusk view of tower from northwest, showing plaza at base

*Top:* Lobby, with elevator core at left and sunken conversation area at right

*Above:* Plaza with building entrance at right





Above: Second-floor terrace

Opposite: Roof terrace, showing  
gabion tree planters

#### **Project Credits**

*Project:* 151 North Franklin, Chicago

*Client/Owner:* The John Buck Co.

*Design Architect/Interior Designer:* John Ronan Architects, Chicago · John Ronan, FAIA (principal and lead designer); Marcin Szefer, ASSOC. AIA, Sam Park, Eric Cheng, Laura Gomez Hernandez (project team)

*Architect of Record:* AAI Associates

*M/E/P Engineer:* Environmental Systems Design

*Structural Engineer:* Magnusson Klemencic Associates

*Civil Engineer:* Mackie Consultants

*Geotechnical Engineer:* GEI Consultants

*Construction Manager/General Contractor:* Lendlease

*Landscape Architect:* Wolff Landscape Architecture

*Lighting Designer:* Aurora Lighting Design

*Vertical Transportation:* Jenkins & Huntington

*Code/ADA Consultant:* Jensen Hughes

*Acoustic Engineering:* Shiner+Associates

*Size:* 880,000 square feet

*Cost:* \$184 million (core and shell)







**The Children's Library at Concourse House  
Bronx, N.Y.  
Michael K Chen Architecture**

A choir loft turned library gives children creative space in a larger transitional housing environment.





Concourse House has provided transitional housing and services for women and their children from a stout four-story masonry structure on Grand Concourse in the Bronx, N.Y., since 1991. The facility includes a barrel-vaulted, double-height former chapel, with a choir loft above, that dates to the building's construction in the 1930s. Recently, New York-based Michael K Chen Architecture (MKCA) transformed the 250-square-foot loft into a library for Concourse House's young residents.

Principal Michael K. Chen, AIA, was introduced to the nonprofit by donors Kate and Julie Yamin. He explains that a lifelong love of reading—influenced by his librarian-trained mother—determined the design approach: “All of my greatest escapes were in books,” he says. The children who live at Concourse House are transitioning out of homelessness and “don't have their own books,” he says. “A library is a special part of childhood—to have access to the exploration and learning and imagination that books afford.”

MKCA placed a capsule-shaped shelving unit—a form also delightfully known as a discorectangle—in front of the choir's existing railing to provide a more substantial safeguard against the drop-off. The rift-sawn white oak shelving is about 5 feet tall, and is designed to maximize book storage while ensuring the space isn't intimidating for the children. A series of spaced wood dowels form the back of the unit and allow both light and air to circulate into the library. “We calibrated the scale so the elements are big, but kind of cuddly,” Chen says. “Even though it's a single space, we were trying to create little pockets of intimacy.” For example, a small table acts as the librarian's “office” for meetings, counseling, and poetry writing workshops.

The design provides a number of different settings for reading—a solid-surfaced reading table, playfully upholstered poufs stored in low shelving, and a comfortable, colorful carpet which provides unlimited seating options. Designed by MKCA, the custom carpet features bold abstract forms that “map” how the space can be used. “It signals that you could sit in a circle around a person who's telling a story,” Chen says. The height of pile varies, and it's more plush in the center where children are more likely to sit. For illumination, Chen suspended four globe-shaped pendant fixtures from the vaulted ceiling, supplementing them with a pair of sconces on the wall.

When the library opened, “we cut the ribbon, and the children ran in and grabbed books,” Chen says. “They used it exactly the way it was meant to be used; they didn't need to be prompted.” Which seems like an object lesson in good design.



Floor Plan

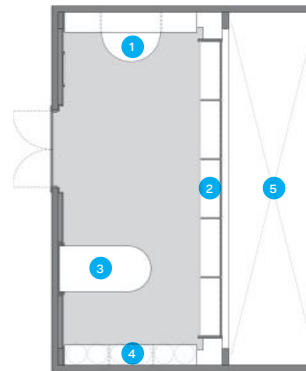

1. Librarian's table
2. Shelving
3. Reading table
4. Pouf seating storage
5. Open to below



*Previous Spread:* Library looking south to pouf seating storage and reading table

*Opposite:* Double-height space with library visible in former choir loft above

*Right:* Librarian's table next to main shelving unit with embedded LED lighting



#### **Project Credits**

*Project:* The Children's Library at Concourse House, Bronx, N.Y.

*Client:* Concourse House

*Architect:* Michael K Chen Architecture, New York · Braden Caldwell, Michael K. Chen, AIA (project team)

*General Contractor/Millwork:* Structure NYC

*Major Donors:* Julie Yamin and Kate Yamin

*Donations:* Studio Proba; Asher Israelow; Bec

Brittain; Birnam Wood Studio; Christopher

Kurtz; Chronicle Books; David Weeks Studio;

Egg Collective; Ezra Tessler, Courtesy of

315 Gallery; Fernando Mastrangelo Studio;

Haley Josephs, Courtesy of 315 Gallery; Kin &

Co.; Kinder Modern; Ladies and Gentlemen

Studio; Maharam; Manzanara Furniture;

Mary Wallis for Lindsey Adelman Studio;

Pelle; Phaedo, Courtesy of Colony; Ramos

Trucking; Schoolhouse; Structure NYC;

Visibility; Vonnegut/Kraft and Mary Ping

*Size:* 250 square feet

*Cost:* Withheld



**Boxen**  
**Swedish Centre for**  
**Architecture and Design**  
**Stockholm**  
**Dehlin Brattgård Arkitekter**

A steel-and-wood pavilion forms an intimate gallery space within a larger exhibition hall.

TEXT BY CLAY RISEN  
PHOTOS BY JOHAN DELIN









The Swedish Centre for Architecture and Design, commonly known as ArkDes, is located in a 19th century structure built for the Swedish military on an island in the center of Stockholm. Its two cavernous halls offer a wondrous space for large-scale architecture and design installations, but they are less than ideal for smaller exhibits showcasing emerging designers. So in the fall of 2017, the center launched a competition in search of a solution.

Local firm Dehlin Brattgård Arkitekter's winning design is called Boxen, and, as its name implies, it is a cuboid structure set inside one of the main galleries, within which ArkDes can mount more-intimate exhibits. Built with a tight schedule and budget, Boxen is made of steel, painted birch plywood, and wire mesh, with a gently sloping ramp that rises around the outside. A circular window allows views into the space from the larger exhibition hall around it.

Central to the design is a desire to build connections between Boxen, its contents, and the rest of the gallery, says principal Johan Dehlin. As visitors ascend the ramp, they get a different perspective on the exhibits in the larger hall; the ramp and windows also put them on display. "We thought it would be interesting if the visitors themselves could become part of the exhibition space somehow," says Johannes Brattgård, the firm's other principal.

Boxen only looks simple: In fact, Dehlin and Brattgård say that the design and construction process was constrained by a long list of regulations and surprises. For starters, the main ArkDes halls are protected historic structures, and so whatever was built had to be minimally invasive and leave no permanent mark. This pushed them toward using lightweight materials to build an unassuming structure—aside from a few lights, there are no mechanical or electrical elements. "It became an opportunity to make a building without all the complexities of the utilities," Dehlin says. "It's just the structure and the function."

From the start, the architects knew they wanted to include an elevated viewing area, but accessibility requirements prevented them from relying solely on a staircase—hence the ramp (a pair of staircases, required by fire code, offer an alternative route). But as Boxen took shape within the hall, they found yet another challenge: The floors could not support the structure's point loads. Dehlin and Brattgård worked closely with a steel fabricator to build what amounts to a bridgelike structure that focuses the loads atop concrete foundations under the existing floor.

"It was technically quite challenging, but for that reason it was quite fun for us," Dehlin says. "And it got much better as we worked through those challenges."

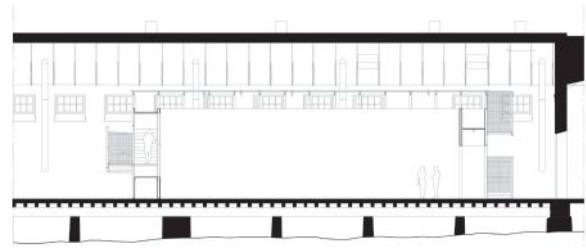
Section A–A<sub>1</sub>

Detail Floor Plan

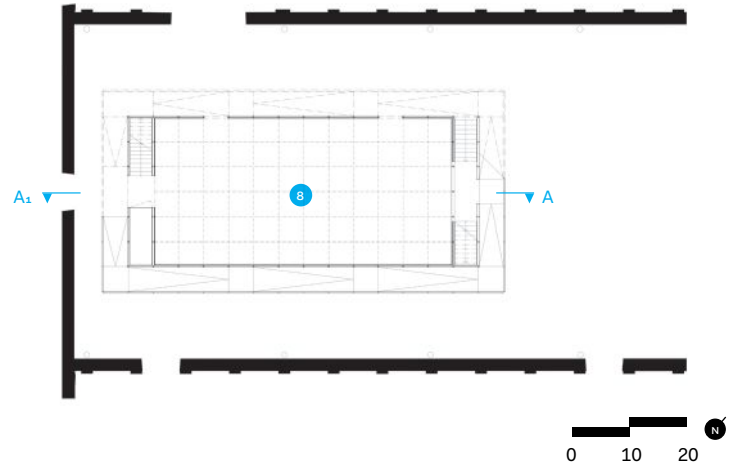

Ground-Floor Plan



- |                    |              |
|--------------------|--------------|
| 1. Entrance        | 5. Classroom |
| 2. Boxen           | 6. Café      |
| 3. Exhibition hall | 7. Library   |
| 4. Gift shop       | 8. Gallery   |



*Previous Spread:* Boxen in the larger exhibition hall, with other exhibits in foreground

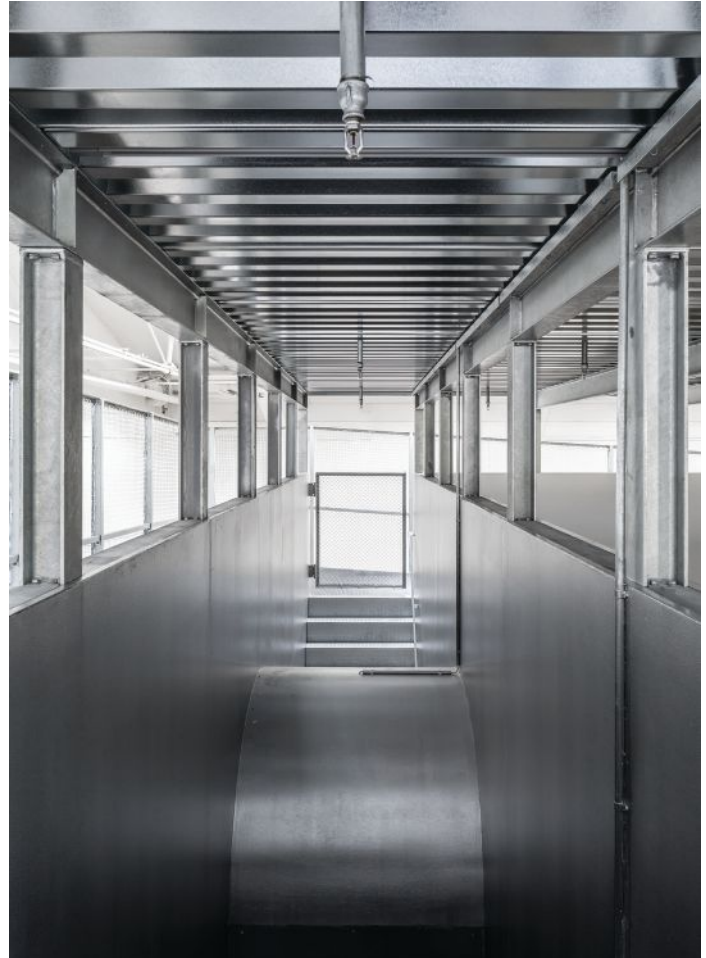

*Above, Left:* Entrance to northernmost fire stair leading to Boxen's upper viewing platform

*Above, Right:* Top of stair, with circular window surround in foreground





*Above:* Ramp, showing wire mesh guardrail, with view into gallery interior at right

*Right:* Gallery interior



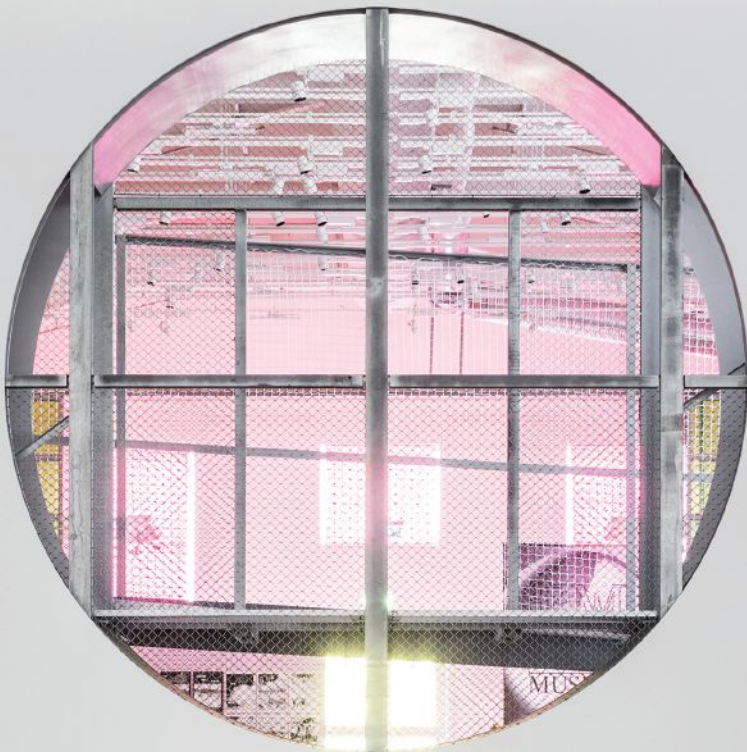

**Project Credits**

*Project:* Boxen, Stockholm  
*Client:* ArkDes (Swedish Centre for Architecture and Design)  
*Architect:* Dehlin Brattgård Arkitekter, Stockholm · Johan Dehlin, Johannes Brattgård (lead architects)  
*Structural Engineer:* DIFK  
*Project Manager:* Erik Törnqvist  
*Steel Construction:* Promostal  
*Contractor:* Eckerud EQT  
*Size:* 156 square meters (1,679 square feet)  
*Cost:* 2.1 million Swedish Krona (\$217,906)



**Geffen Academy at UCLA  
Los Angeles  
Koning Eizenberg Architecture**





A secondary school on a college campus uses indoor and outdoor space to form a smart, informal learning environment.

TEXT BY KATIE GERFEN  
PHOTOS BY ERIC STAUDENMAIER





Second-Floor Plan



Third-Floor Plan



Ground-Floor Plan



- |                            |                          |
|----------------------------|--------------------------|
| 1. Main entrance           | 8. Art studio, with yard |
| 2. Living room             | 9. Food service          |
| 3. Faculty                 | 10. Multipurpose/dining  |
| 4. Athletics               | 11. Patio                |
| 5. Classroom               | 12. Open library         |
| 6. Maker studio, with yard | 13. Media lab            |
| 7. Dance studio, with yard | 14. Science lab          |



Some of the newest students at the University of California, Los Angeles (UCLA) campus haven't taken their SATs—they are the middle and high schoolers at the new Geffen Academy at UCLA. The university decided to start a secondary school for students from the greater Los Angeles area—including those of UCLA faculty—back in 2015. It selected a campus building designed by Culver City, Calif.-based Ehrlich Architects (now Ehrlich Yanai Rhee Chaney Architects) as a facility to temporarily house various departments during renovations, and hired Santa Monica, Calif.-based Koning Eizenberg Architecture (KEA) to transform it into Geffen Academy. The school opened in 2017, and moved into its new facility last fall.

KEA principal Julie Eizenberg, FAIA, says that the client was not interested in a traditional school: "They told us that they expected a third of their students to not be in class at any given time, that they wanted to begin to break down the barrier between faculty and students, and that they believed in wellness programs," especially the importance of daylight.

To address this brief, KEA reoriented the entry from one of the short sides of the building to the long side to create a better area for drop-off, and to reclaim some of the parking lot surrounding the building to create an outdoor patio for students. Existing roll-up

garage doors now open ground-floor studios for dance, art, and maker space to light and air, and connect the patio to a cafeteria. Inside, KEA cut a stair into the floor plates to connect the three levels and admit daylight via a skylight above. Glass interior partitions allow light to penetrate deep into the floor plates.

An important design concept was "the idea of empowerment," Eizenberg says. "To make the students feel empowered, you need to give them choice." A central, open library offers a variety of study and collaborative environments for students and teachers alike to choose how and where they want to work. The library starts on the ground floor with a space known as the living room, and occupies the center of floors two and three, where it is surrounded by classrooms. While the sequence of spaces is called a library—and does indeed hold books—the school has taken to it just as the architects intended. "We used indirect lighting on Unistrut that the students can also use for display," says project manager Mandi Roberts, ASSOC. AIA. The last time she visited, "the living room was a theater."

"To make teachers and students comfortable, you need a fairly sophisticated environment," Eizenberg says—high-tech offices were a source of inspiration. But the school was "keen that the kids create the narrative. It's got to be a place where you can make a mess."



*Previous Spread:* Ground-floor maker studio, with access to courtyard via roll-up door

*Top, Left:* Main entrance

*Top, Right:* Food service area, with reclaimed light fixtures from renovated space

*Above:* Outdoor seating on patio, with indoor multipurpose and dining area at right, beyond open roll-up door





Above: Second-floor faculty office, with visual connections to main stair and open library through glass wall

Opposite: Main stair at third floor, showing topographic map wall graphics by KEA

#### **Project Credits**

*Project:* Geffen Academy at UCLA, Los Angeles

*Client:* UCLA Capital Programs

*Architect/Interior Designer:* Koning Eizenberg Architecture, Santa Monica, Calif. · Julie Eizenberg, FAIA (principal-in-charge); Mandi Roberts, Assoc. AIA (project manager/designer); Greg Cheng, AIA (project architect); Sam Ludwig, Nathan Bishop, Troy Fosler, AIA, Julian Menne (project team)

*General Contractor:* BNBuilders

*Civil Engineer:* KPFF Consulting Engineers

*Landscape Architect:* Pamela Burton & Co.

*Structural Engineer:* John Labib + Associates

*Mechanical/Plumbing Engineer:* Southland Industries

*Electrical Engineer:* Helix Electric

*Lighting Designer/Sustainability:*

BuroHappold Engineering

*Signage:* Newsom Gonzalez

*Audio/Video:* Vantage Technology

Consulting Group

*Code Consultant:* TK1SC

*Acoustics:* Veneklasen Associates

*Cost Estimating:* C.P. O'Halloran Associates

*Laboratory Planner:* Strategic Facilities Planning

*Specifications:* AWC

*Ffe Specifications:* Dotrio

*Hardware:* Finish Hardware Technology

*Food Service:* Laschober + Sovich

*Size:* 75,000 square feet

*Cost:* Withheld







**SCHWEISS**

# DOORS

**YOU THINK IT, WE BUILD IT!**

**HYDRAULIC** -OR- **BIFOLD**  
ONE-PIECE DOORS STRAP LIFT DOORS

507-426-8273

"BUILDING BETTER DOORS"

**SCHWEISSDOORS.COM**

WHAT ITALY DID FOR DESIGNER FASHION,  
**B&D BUILDERS DO FOR COMMERCIAL SPACES.**

*B&D*  
 BUILDERS

custombarnbuilding.com • 717.687.0292

**New 20+ Linear Family**  
[inter-lux.com/20L](http://inter-lux.com/20L)

**inter•lux**

**WhiteWalls.com**  
 Whiteboard Steel Wall Panels

WhiteWalls.com 800 624 4154

**BOLDER. BRIGHTER.**

**GEN LED** **ACOLYTE**  
 Architectural Lighting Solutions

[www.GENLEDBrands.com/Home/Acolyte](http://www.GENLEDBrands.com/Home/Acolyte)

**HANOVER**  
 ARCHITECTURAL PRODUCTS

Hanover®  
 Porcelain Pavers

[WWW.HANOVERPAVERS.COM](http://WWW.HANOVERPAVERS.COM)

**ARCHITECT**

The Journal of the American Institute of Architects

**You Deserve More.**

The premiere website for practicing architects—featuring news, project galleries, continuing education, blogs, videos and more is [architectmagazine.com](http://architectmagazine.com).

- > More projects
- > More news
- > More tech
- > More critiques
- > More products
- > More business

**Get more today at**  
[architectmagazine.com](http://architectmagazine.com)

**hanleywood**

**FOR INFORMATION**  
 on how to be a part of the next  
**ARCHITECT MAGAZINE**  
 special advertising section,  
 contact Jaeda Mohr at  
 202-736-3453.

**hw**

## Kitchen Power Grommet



PCS77  
GFI, Water Tight

**MOCKETT**  
DOUG MOCKETT & COMPANY, INC.

www.mockett.com • (800) 523-1269



The EF400 System enables designers and specifiers to drastically clean up the ceiling plane by incorporating multiple types of architectural LED lighting into one recessed system. The system can be used for linear slots, cove lighting, accent lighting, perimeter lighting and more.

[ifillumination.com/products/ef400.php](http://ifillumination.com/products/ef400.php)

## NAKAMOTO FORESTRY



### Yakisugi (Shou Sugi Ban)

Highest quality heat treated cypress siding and panelling

Sustainable and natural • Affordable • Short lead time

[nakamotoforestry.com](http://nakamotoforestry.com)

## ARCHITECT



### Content Licensing for Every Marketing Strategy

#### Marketing solutions fit for:

Outdoor | Direct Mail | Print Advertising  
Tradeshow/POP Displays  
Social Media | Radio & TV

Leverage branded content from Architect to create a more powerful and sophisticated statement about your product, service, or company in your next marketing campaign. Contact Wright's Media to find out more about how we can customize your acknowledgements and recognitions to enhance your marketing strategies.

Call Wright's Media at 877.652.5295,  
visit our website at  
[wrightsmedia.com/sites/hanleywood](http://wrightsmedia.com/sites/hanleywood)  
or email us at [hanleywood@wrightsmedia.com](mailto:hanleywood@wrightsmedia.com)

## BANKER WIRE

[WWW.BANKERWIRE.COM](http://WWW.BANKERWIRE.COM)

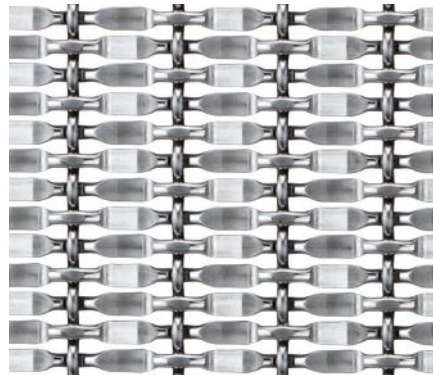

Discover the widest variety of woven wire mesh available for indoor and outdoor applications.

SAME MODERN.

MORE POSSIBILITIES.

Introducing Modern Casement and Awning, the first operable windows in our Modern line. Designed as part of the same modular system, these windows let you build and configure with ease—and do even more with Modern.

**MARVIN** 

**FLXible Neon**  
Ultra Slim Flexible LED  
with Spot-Free Output  
Great for Wet Locations

**FEELUX**  
[feeluxlighting.com](http://feeluxlighting.com)  
[info@feeluxlighting.com](mailto:info@feeluxlighting.com)



**PAC-CLAD**  
PETERSEN  
A CARLISLE COMPANY

[PAC-CLAD.COM/RIDLEY](http://PAC-CLAD.COM/RIDLEY)



#### IS YOUR STUDIO FIRST CLASS?

The Studio Prize is an annual design awards program that recognizes innovative, thoughtful, and ethical studio courses at accredited architecture schools. The prize is designed to celebrate the creativity of studio course curricula as well as the sophistication of the work students produce in response. The exclusive sponsor, Sloan, has generously made \$20,000 available for student prizes. The jury will also confer the \$5,000 Sloan Award to students in a winning studio or studios that address sustainability, specifically water conservation.

4<sup>th</sup> ANNUAL



## Call for entries

#### ELIGIBILITY

All full-time, part-time, and visiting faculty and administrators may submit studio course curricula, and the resulting student work, for consideration. All studio courses must have occurred in the context of an accredited Bachelor of Architecture or Master of Architecture program, or their equivalents, and all must have been concluded within the 2018–2019 academic year. Summer 2018 studios are also eligible. For full eligibility requirements, visit [studioprize.com](http://studioprize.com).

#### RECOGNITION

Winners will be featured in the September issue of ARCHITECT with expanded coverage online at [architectmagazine.com](http://architectmagazine.com).

#### HOW TO ENTER

SUBMIT YOUR WORK AT  
> [studioprize.com](http://studioprize.com)

#### DEADLINES

REGULAR June 14, 2019  
LATE June 21, 2019

#### FEEES

ADMINISTRATIVE FEE \$45  
LATE FEE \$25 (for entries submitted after June 14)

Advertiser	Page	Website	Phone
Acolyte	81	www.GENLEDBrands.com/Acolyte	
ALPOLIC Mitsubishi Plastics Composites America, Inc.	27	www.alpolic-americas.com	800.422.7270
Aluflam North America	82	www.aluflam-usa.com	562.926.9520
American Institute of Architects	20	www.aiacontracts.org/architectmag-natixis	
American Institute of Architects	40	www.architecturaladventures.org/architectmag	800.293.5725
American Institute of Architects	62	www.conferenceonarchitecture.com	
American Institute of Architects	68	www.AIAFilmChallenge.org	
American Institute of Steel Construction	19	www.aisc.org/ideas2	
ARCAT	C3	www.arcat.com/charrette	
ARCHITECT 50	41 *	www.architect50.com	
Architect Podcast Network Sponsored	36	www.bit.ly/ArchitectPodcasts	
Armstrong World Industries - Ceilings	11	www.armstrongceilings.com/acgiwood	
ASI Group	15	www.americanspecialties.com	914.476.9000
B&D Builders	2	www.custombarnbuilding.com	717.687.0292
Banker Wire	84	www.bankerwire.com	800.523.6772
Bobrick Washroom	21, 56-59	www.bobrick.com	
Bradley Corporation	53	www.bradleycorp.com/washbar/architect	
Con-Tech Lighting	47	www.contechlighting.com	
Doug Mockett & Co., Inc.	25	www.mockett.com	800.523.1269
E. Dillon and Company	71	www.edillon.com	800.234.8970
Feelux Lighting	49	www.feeluxlighting.com	678.668.7005
Feeney, Inc.	17	www.feeneyinc.com/conceal	800.888.2418
Fiberon	77	www.fiberoncladding.com	
Greenbuild	85	www.greenbuildexpo.com/notify	
H.E. Williams, Inc.	45	www.hew.com/MadeRightHere	
Hydronics Industry Alliance - Commercial	60	www.HIA-C.org	877.427.6601
IAPMO	85	www.IAPMORT.org	877.4.UPCMARK
Inter-Lux	12	www.inter-lux.com/20L	
Kalwall	60	www.kalwall.com	
Kawneer	5	www.kawneer.com	
Kingspan Light + Air   CPI Daylighting	35	www.cpidaylighting.com/portfolio	
Latch	9	www.latch.com	
LF Illumination	51	www.lfillumination.com	
Lutron	43	www.lutron.com/HXL	
Lutron	C4	www.Lutron.com/NaturalLight	
LuxeHome	41 *	www.luxehome.com	312.527.7939
Major Industries	25	www.majorskylights.com	888.759.2678
Mitsubishi Electric Cooling & Heating	13	www.NextGenVRF.com	
Modernfold	23	www.modernfold.com	800.869.9685
ModularArts	80	www.modulararts.com	206.788.4210
NanaWall Systems	79	www.nanawall.com/hsw	
Ornamental Metal Institute of New York	8	www.OMINY.org	
Ox Engineered Products	75	www.oxep.com	
Petersen Aluminum	3	www.PAC-CLAD.com	800.PAC.CLAD
Phifer	31	www.phifer.com	
Progressive Architecture Awards	28	www.paawards.com	
PureEdge Lighting	39	www.PureEdgeLighting.com	
Residential Architect Design Awards	24	www.radesignawards.com	
Seiho International	83	www.seiho.com	626.395.7299
Serge Ferrari	29	www.sergeferrari.com	
Sierra Pacific Windows	6-7	www.SierraPacificWindows.com	800.824.7744
Steel Institute of New York	10	www.SINY.org	
Studio Prize	110	www.studioprize.com	
TCP Lighting	72	www.TCPi.com/Pro	
US Green Building Council	37	www.usgbc.org/LEED	
Viega	55	www.viega.us/About-us	
VT Industries	C2-1	www.vtindustries.com	



# Editorial:

## Don't Ban Glass, Cap Emissions

Wait a minute. Did the mayor of New York threaten to ban glass skyscrapers? Bill de Blasio certainly gave that impression during a press conference on Earth Day: “We are going to introduce legislation to ban the glass and steel skyscrapers that have contributed so much to global warming,” he proclaimed. “They have no place in our city or on our Earth anymore.”

De Blasio’s stated motivation is certainly correct: The planet faces an environmental disaster due to excess greenhouse gas emissions, and buildings are major producers. An inventory of 2015 emissions in New York found that buildings accounted for 67 percent of the year’s total. But many building technologies contribute to the problem, not just one envelope type. A ban on the glass curtainwall seems like an ill-advised solution that could, among other things, actually limit the development of sustainable design techniques.

As it turns out, de Blasio was trolling—sort of. After dropping the ban bomb, he offered a clarification: “If a company wants to build a big skyscraper, they can use all the glass [they want], if they do all the things needed to reduce the emissions. But putting up monuments to themselves that harm our Earth and threaten our future—that will no longer be allowed in New York City.” Fair enough.

At the press conference, the director of the Mayor’s Office of Sustainability, Mark Chambers, reiterated that there would be, in fact, no ban on glass. Instead, the goal is to increase large and tall buildings’ energy efficiency and reduce their carbon footprints.

Curiously, just a few days before, the City Council had passed legislation to reduce greenhouse gas emissions from large buildings by 40 percent by 2030, as part of a larger Climate Mobilization Act.

So why did de Blasio bother? I suspect he was performing a bit of political theater, wrapping a rational regulatory goal to reduce emissions in extreme rhetoric, and piggybacking on the notoriety of the

proposed Green New Deal in Congress. By that standard, the ploy worked: Here I am, writing about it.

Unfortunately, de Blasio pushed questionable policy, and that calls for a response. Outright bans of specific materials or technologies often make clumsy, counterproductive tools. Where climate is concerned, government should establish where we need to go, but shouldn’t dictate how to get there. Hopefully New York—and any other entity pursuing reductions in emissions and embodied carbon—will instead pursue goals-based strategies that set targets and promote best practices. I say this not because of some ideological opposition to government intervention, but because we need all the good ideas we can get.

Over the past decade or so, the sustainability movement has helped kindle an amazing resurgence of technology in architectural practice and education, and it would be criminal to limit the possibilities. After decades of spectacular form-making, the pendulum is swinging in the opposite direction. Passion for modeling complex curves is giving way to the necessity of modeling building performance. While both can be profoundly creative acts, at this fragile moment in ecological history, we should encourage the latter, pragmatic sort of innovation—and vehemently oppose obstacles to it.



Looking for a free way  
to promote your firm?



CHARRETTE

...can do that.

Another free tool from ARCAT, Charrette isn't just for organizing your projects - it can promote them too! Create your firm's portfolio, upload the photos you want, and control the project information you wish to share. Create links back to your firm's website and share contact details so clients can reach out to you. Just another way ARCAT is helping you be more productive.

learn more at  
[www.arcat.com/charrette](http://www.arcat.com/charrette)

ARCAT®



# Shades by Lutron

Elegant design. Unparalleled performance.  
Extraordinary human experience.

System: Hyperion Solar-Adaptive Shading  
Fabric: E Screen in Charcoal/Cocoa

**Simplot Corporate Headquarters, Boise, Idaho**  
Architects: Adamson Associates, Inc. & Lauck Group Interiors

Photo © Casey Dunn Photography



[Lutron.com/NaturalLight](https://www.lutron.com/NaturalLight)

© 2019 Lutron Electronics Co., Inc.