

AIA YOUNG ARCHITECT RECIPIENT **ANN SOBIECH MUNSON** CRÈME DE LA CRÈME: **AIA IOWA AND CENTRAL STATES REGION WINNERS**  
**WILLIAM DIKIS**: IOWA'S FIRST AIA CITIZEN ARCHITECT RECIPIENT **TWO PROJECTS** ON THE BOARD  
WINTER 2016

# ia architect

THE OFFICIAL MAGAZINE OF AIA IOWA

## *Awards Issue*

2015 AIA Iowa, Central States  
Region Annual Design Awards







ALL IOWA ATTACK FIELDHOUSE | DESIGNED BY JCORP, INC. | BUILT BY DICKSON JENSEN | INSPIRED BY THE OLD STATE GYM, ISU CAMPUS

**LINDSAY ELLINGSON LOVED HIS FAMILY AND HIS JOB. HE LOVED COLLABORATING WITH THE ARCHITECTURAL COMMUNITY AND CONSIDERED ALL OF YOU FRIENDS. LINDSAY'S DEATH ON NOVEMBER 12, 2015 TOOK US ALL BY SURPRISE. WE WILL ALL MISS HIM.**

**SIoux CITY BRICK | 712.258.6571**

**UNITED BRICK | 515.254.0196**



**NEBRASKA BRICK | 402.408.5555**

**MINNESOTA BRICK | 952.888.9239**

# editor's letter



## Welcome!

Welcome to the annual awards issue, recognizing the most notable work in our state and across our region. Juhani Pallasmaa, the distinguished Finnish architect and author, wrote that “the essential task of architecture is to improve the world we live in, to make it a better place for ourselves to be in.” That is no simple task. To succeed, architecture must be something more than a synthesis of complex requirements or a solution addressing economic, technical, functional, and aesthetic factors. It must also aspire to enrich the experience of day-to-day life.

Certainly the projects in the following pages serve as fine examples. A chapel where the subtle form and material heighten one’s awareness of changing light, or a parking ramp that has spaces for people not just cars, the architecture celebrated here is exceptional because they are better places for us all to be in.

Congratulations to this year’s award winners, to the architects, clients, and collaborators whose work and vision made them happen. May they serve as inspiration for the work we have yet to do.

---

**Jessica Terrill, AIA**

*Editor, Iowa Architect*

**ia**architect

**Editor** Jessica Terrill, AIA

**Associate Editors** Danielle Hermann, AIA; Brent Hoffman, Assoc. AIA; Anna Schwennsen Jones, Assoc. AIA

**Editorial Board** Michael Bechtel, Assoc. AIA; Justin Burnham, Assoc. AIA; Renee Clarke, AIA; Jackson Den Herder, Assoc. AIA; Dan Drendel, AIA; Curtis Ehler, AIA; Khalid Khan, Assoc. AIA; A. Grant Nordby, Assoc. AIA; Katelyn Rutledge, Assoc. AIA; Andrew West, Assoc. AIA; Evan Shaw, AIA, Editor Ex-officio

**Copy Editor** Andrea Kline, Kline Copy Co.

**Designer** SaturdayMfg.

**American Institute of Architects, Iowa Chapter**

**Executive Director** Jessica Reinert, CAE, IOM, Hon. AIA Iowa

**President** Mindy Aust, AIA

**Vice President** Matt Ostanik, AIA

**2nd Vice President** Gary Van Dyke, AIA

**Secretary** Danielle Hermann, AIA

**Treasurer** Tonia Householder, AIA

**Past President** Joseph Tursi, AIA

**Directors** Doug Foreshoe, AIA; Toi Sullivan, AIA; Dan Drendel, AIA; Alan Wieskamp, AIA; Chris Wand, AIA

**Associate Director** Kayla Ohrt, Assoc. AIA

**Allied Director** Dale Mullikin

**Iowa State University Representatives**

Deborah Hauptmann, Assoc. AIA; Gregory Palermo, AIA

**AIAS President** Nicole Becker

**North East Iowa Architects Section**

**President** Doug Foreshoe, AIA

**Central Iowa Architects Section**

**President** Jamie Malloy, AIA

**South East Iowa Architects Section**

**President** Nate Otis, AIA

**North West Iowa Architects Section**

**President** Toi Sullivan, AIA

**South West Iowa Architects Section**

**President** Brian Nohr, AIA

**Central States Region Directors** Chris Ball, AIA; Jack Morgan, AIA

**Iowa Architect**, the official publication of the American Institute of Architects, Iowa Chapter  
Iowa Center for Architecture  
400 Locust Street, Suite 100  
Des Moines, IA 50309  
515-244-7502 / Fax 515-244-5347  
[www.AIAIowa.org](http://www.AIAIowa.org) / [www.IowaArchitecture.org](http://www.IowaArchitecture.org)

**Subscription Rates**

\$21.95/year

**Note to Subscribers:** When changing address, please send address label from recent issue with your new address. Allow six weeks for change to take effect.

**Advertising**

Tonya Vitsthum  
Associations Inc.  
515-669-3010  
[tvitsthum@associationsinc.us](mailto:tvitsthum@associationsinc.us)

**Publisher**

Tom Smull  
Associations Inc.  
515-201-3133  
[tsmull@associationsinc.us](mailto:tsmull@associationsinc.us)

**Managing Editor**

Abby Gilman  
Associations Inc.  
515-201-3133  
[abbygilman@mac.com](mailto:abbygilman@mac.com)





## Top 10 Reasons Why You Should Choose Masonry

- 1 Fire Resistant** / Non-combustible materials.
- 2 Weather Resistant** / Exterior walls that will hold up to heavy storms, U.V. degradation, blistering heat, and sub-zero temperatures.
- 3 Termite Resistant** / Exterior walls made of masonry means there's no wood to eat.
- 4 Protection from Rotting, Mold & Fungus** / With no exterior wood on the walls, there's nothing to rot and masonry plays a large role in significantly reducing or eliminating the build-up of fungus and mildew between interior and exterior walls. Such problems have been known to contribute to health ailments including chronic fatigue, asthma and throat infections. Clearly, masonry structures are healthier for its inhabitants. Masonry structures are also nearly air-tight, making them allergy resistant as well.
- 5 Superior Sound Proofing** / Masonry blocks out noise better than traditional building materials, resulting in a quieter environment.
- 6 Virtually Maintenance Free** / When used in its natural form, masonry provides lasting beauty that requires considerably less maintenance than other building materials.
- 7 Lower Utility Bills** / Concrete block, combined with 'thermal mass' insulation systems, stores more energy, meaning it stays warmer in winter and cooler in summer, reducing electric consumption, therefore lower utility bills.
- 8 Lower Insurance Premiums** / Because masonry provides higher levels of security, fire and termite protection, and does a better job of weathering the storm, many insurance companies may offer discounts on policies.
- 9 Environmentally-Friendly "Green" Products** / Masonry products play a large role in ecologically responsible building methods and is recognized by government programs as a contributor to green building status. Masonry products are earth-friendly because they do not deplete precious natural and limited resources like timber.
- 10 Increased Resale Appeal** / There's a widely-held opinion, supported by studies, that masonry constructed buildings and homes offer a greater resale value than other forms of construction. Key reasons are the fact that masonry structures are high quality and low maintenance.

*"Working to build a better Iowa — with brick, block and stone."*



# contents

IOWA ARCHITECT MAGAZINE WINTER 2016



^ Marvin Hall Forum, p. 36

## Features

- 15 **AIA Iowa Annual Design Awards**  
Iowa projects bestowed with design awards
- 33 **Central States Region Annual Design Awards**  
Iowa firms fare well in 2015 multi-state competition

## Departments

- 07 **Profiles**  
More winners: 2015 AIA Young Architect Award, AIA Citizen Architect Award, AIA Iowa Young Architect Award
- 10 **On the Boards**  
An expansion for a Story County hospital and Johnson County civic building
- 11 **Collected**  
Two Iowa projects win national AIA awards



**ON THE COVER**  
Corporate Campus Parking Facility,  
Excellence in Design winner, p. 22





IOWA CITY | DES MOINES

Market One, Des Moines



AIA IOWA

ANATOMY

OF AN ARCHITECT

There are 550 licensed AIA Iowa Architects in the state.  
What it takes to be one may surprise you.  
Learn more at [aiaiowa.org](http://aiaiowa.org)

 <p>5-7+ yrs of post-secondary school 3,740 internship hrs 7 required intensive skills tests 24 hrs/2 yr of continuing education</p>	 <p>Focuses on: client needs, quality, health safety, welfare, occupant use, resource management</p>	 <p>avg income: \$69k/year &gt;50 hours/week expert in: building codes, environmental sustainability, design, technology, historic renovation, &amp; more.</p>	 <p>works with a team builds relationships invests in design ...and really does love Legos.</p>
---	---	--	--





## Ann Sobiech Munson, AIA

Co-founder of Iowa Women in Architecture and spec writer at Substance wins AIA Young Architect Award.

### AIA YOUNG ARCHITECT AWARD

WORDS: SUSAN VANDE HAAR

Ann Sobiech Munson, AIA, exemplifies the new face of architects across the nation. She is the also the recipient of the American Institute of Architects 2015 Young Architects Award, an award bestowed upon individuals who have shown exceptional leadership and made significant contributions to the profession in an early stage of their architectural career.

Females make up 50.8 percent of the United States population, according to the 2010 US Census Bureau. According to the NAAB 2010 accreditation report, 41 percent of architecture students are female, yet only 18 percent of AIA members are female. Munson noticed the discrepancy and began to wonder where they went. What was the root cause of the gender gap in the profession?

"As I was teaching at Iowa State, I experienced a collection of moments where I learned that part of the issue with women in architecture is that there aren't role models for young women at mid- and upper-levels of the profession," says Munson, who received her master in architecture from the university. After teaching at Iowa State for seven years, Munson decided to transition back into practice so she could become a role model herself.

Munson, along with three of her colleagues, began a 10-year journey of turning a spotlight on diversity issues by founding Iowa Women in Architecture (iaWia), a non-profit that rallies and supports women working in the field using a research approach to identify and document key issues and potential

solutions. Its most significant contribution to this diversity issue was Best Practice Recommendations for Design Professions. "It's a tool that people can use to think about human resources and how they structure some of those policies for the way we live and work," says Munson. They brought in experts from outside the field of architecture – people from finance, insurance, government, and law – to discuss life and work balance issues within the workplace. These conversations at the local, midwest, and national level help firms reposition practices to better the working culture. The research found that creating a balance between work and life for professionals, as they face a cultural shift in the workplace, is not just a female issue.

Her passion for culture and architecture extends beyond the workplace. A native of Slater, Iowa – where she is currently serving a four-year term on the City Council – Munson utilizes her knowledge on the ongoing restoration and rehabilitation projects of existing infrastructure and education growth.

Her research and conversations benefit young women who are thinking of entering the field, as well as emerging professionals, both men and women. Her training in architecture has provided her with a calm, direct, and collaborative approach to resolving problems in her profession and adding her knowledgeable voice to her community. She truly has become the role model she knew was needed. As a multifaceted professional, architects both men and women will benefit from the conversations she has started.





## William Dikis, FAIA

Local architect becomes first-ever Iowa winner of AIA Citizen Architect Award.

### AIA CITIZEN ARCHITECT

WORDS: CLARE CARDINAL PETT

The annual Citizen Architect Award of the American Institute of Architects (AIA) recognizes exemplary public service by an AIA member and singles out individuals who have outstanding records of advocacy for architecture and the profession. William (Bill) Dikis, FAIA and an AIA Iowa Chapter member, is the first Iowan to receive this prestigious national honor. Over a career of more than 40 years, Dikis has set a very high standard for public and professional service, inspiring many others by his example.

The list of Dikis's accomplishments is long, but a few highlights bear witness to his many years of participation in activities that have advanced the cause of the profession in a variety of contexts. Within the AIA organization, he has been consistently and profoundly involved, from many state and national committee memberships to his tenure as Iowa Chapter President and editor of *Iowa Architect* magazine.

Dikis' influence stretches far beyond the last decade. Since the early 1970s, he has been involved with Government Affairs at the AIA starting out by serving as the AIA's Legislative Minuteman for twenty years and a member of the AIA's State Government Network since its inception. Dikis has also authored and contributed to multiple Iowa laws including revisions to the Architectural Practice Act in 1984, 1985, and 1987, energy conservation legislation in 1989, Interior Design Title Act in 1991, and legislation concerning the Americans with Disabilities Act in 1993. Most recently in 2014, he aided

in the passage of the Iowa Good Samaritan Law for architects in engineers.

He has invested years of service in the profession's legislative efforts and his work is essential both in the local and national arenas. Dikis's work in the more general public arena is legendary, especially in Iowa, where he has been a member of or chaired many important decision-making bodies, such as the Strategic Planning Commission, Urban Renewal Board, Architectural Advisory Committee, Mayor's Landscape Taskforce, City of Des Moines Vision Plan - Design Advisory Team, and the Vision 2005 Citizens' Committee for the Des Moines Schools.

In 1967, Dikis earned his license to practice architecture in Iowa after passing the four-day ARE on his first try. He was 26 years old. He has a distinguished portfolio of built work and is well known as the architect of record for the restoration of the Iowa State Capitol from 1981 to 2007. In 2007, Dikis retired from RDG Planning and Design, where he had been a principal since 1969, and founded Architectural Strategies, which provides concept design, programming, feasibility, master plans, and expert witness services.

In concert with the announcement of the 2015 AIA Citizen Architect Award, the AIA Iowa established the "William M. Dikis, FAIA Architecture Service Scholarship" at Iowa State University. Students at his alma mater will now be reminded annually of the challenge to become good citizens outside the immediate concerns of everyday practice.

Bill's work in the more general public arena is legendary, especially in Iowa, where he has been a member of or chaired many important decision-making bodies.



## Jessica Terrill, AIA

**AIA IOWA YOUNG ARCHITECT AWARD**

**WORDS:** HANNAH GILMAN

When Jessica Terrill, AIA, was a little girl, she wanted to be a geologist. “Or a comedian,” she says, laughing. It’s safe to say the Iowa Chapter of the American Institute of Architects is pleased neither of those paths panned out: In October, the chapter honored Terrill for her innovative mindset with the inaugural

Young Architect Award, which celebrates “exceptional leadership and significant contributions to the profession” from someone who is currently in an early stage of his or her career.

Terrill, an architect at Des Moines’ Substance Architecture, was heralded for her diversity of interests in architecture: practicing, teaching, and fostering a connection with the community.

The two-time University of Nebraska-Lincoln graduate — she earned a bachelor’s in design and architectural studies in 2001 and a master’s in architecture in 2003 — moved to Des Moines for an internship with OPN Architects in 2007, and she’s only deepened her relationship with the area since.

Take her work with the Greater Des Moines Public Art Foundation, for instance, which aims to place art in public spaces throughout the city. In 2013, Terrill worked to bring large-scale art pieces by Japanese-American artist Jun Kaneko to Des Moines, helping unify the Principal Riverwalk and Court Avenue. More recently, she’s been heavily involved in ProjectSPACES, which

carries out temporary installations in public spaces, like placing compelling art wraps around DART buses. “It’s a really innovative thing, and it’s fun to see,” says Terrill. “The thing I love most about it is it’s taking high-quality artwork, and making it very accessible.”

Now, she’s helping shape the next generation of young architects as a lecturer at Iowa State University, challenging her students and sharing her passion for the unexpected, whether it’s using a common material in an unpredicted way, or placing art in interesting spaces.

Through all her achievements, though — including serving as a member of Iowa Women in Architecture and a new appointment as editor of *Iowa Architect* magazine — she stresses one thing: the importance of teamwork. “I’m really humbled to receive the award,” says Terrill. “I don’t do any of this work by myself, and I think that’s important — architecture is a really collaborative thing. Anything that I’m doing, and anything that people see that’s worthwhile, is in part a result of the people I work with.”



## Tom Leslie, AIA

**AIA IOWA EDUCATOR AWARD**

**WORDS:** ROB WHITEHEAD

Tom Leslie, AIA, believes the job of a great educator is not to simply cover the topic you are assigned to teach, but to present what you are teaching as something that is interesting, relevant, and part of a larger field of important architectural knowledge. If done well, he argues, teachers can light fires in the imagination of motivated students, inspiring them to embrace learning as part of their identity as designers, and inspiring life-long learning and personal engagement in their work.

A great educator must be engaging, interesting, inspiring, and personally

representative of the ideals and information being presented. Simply put, great educators should strive to be like Leslie, the 2015 AIA Iowa Educator Award winner.

Leslie is the Pickard Chilton Professor in Architecture and director of graduate education in the Department of Architecture at Iowa State. Over the last 15 years, he’s taught hundreds of students and been recognized for the excellence of this work by the AIA, the U.S. Green Building Council, the National Council of Architectural Registration Boards, and the Association of Collegiate Schools of Architecture for creative achievement in teaching. But his influence as an educator expands beyond the classroom walls.

A world-renowned scholar with a relentless passion for writing and research, Leslie is the author of *Louis I. Kahn: Building Art, Building Science* (2005) and *Chicago Skyscrapers, 1871-1934* (2013), and co-author of *Design-Tech: Building Science for Architects* (2006, 2014). His latest project, a book about the Italian engineer and builder Pier Luigi Nervi, promises to

add to his impressive portfolio. This work was developed as part of Leslie’s recent appointment at the American Academy in Rome as the Booth Family Rome Prize in Historic Preservation from 2013-2014, the first such appointment from an Iowa State faculty member.

This scholarship is such a central part of Leslie’s success as an educator, as he is consistently articulating the connections between history, technology, and design. Rather than simply talking about buildings as a result of a singular architectural idea or individual effort, Tom shows the larger picture of the things that can influence design: building technologies, consultants, and economic and sociopolitical factors that have helped shape memorable built environments.

His studio pedagogy follows a similar path. His students are taught to layer technical fluency with civic representation and spatial experience. His students’ design work has been recognized with awards by competition juries as wide-ranging as the ACSA/AISC Steel Competition and *Hospitality* magazine.



# on the boards

Projects  
In Progress

## Story County Medical Center: Outpatient Expansion

Nevada / INVISION Architecture

INVISION was consulted to orchestrate a new conceptual campus plan for a critical access hospital in Central Iowa. After exceeding the facility's original capacity for patient care, the first phase of the refreshed masterplan was the design of a new one-story outpatient clinic addition. The design includes a specialty clinic featuring 18 new exam rooms and three procedure rooms. New therapy/wellness gyms are highlighted by large glass monitors oriented to capture soft morning sunlight, capitalizing on its healing qualities and activating the functional aspect of the spaces to outwardly promote wellness to the community.

The team worked to incorporate large graphics strategically placed at patient destinations and corresponding routes through the addition to assist with wayfinding.



## Johnson County Ambulance Service and Medical Examiner Facility Building

Iowa City / OPN Architects

OPN Architects was selected in May to design a much-needed ambulance services building for Johnson County. Once complete, the roughly \$6.8 million new build will house ambulance services and the Medical Examiner's Office, and provide storage for the Auditor's Office and Facilities Department. Sustainability, efficient building practices, and the possibility to expand at a later date are all crucial factors in the final design.

## BSAFE DISASTER RESPONSE TEAM & TRAINING RECOGNIZED WITH NATIONAL AWARDS

WORDS: ABBY GILMAN

The American Institute of Architects, Iowa Chapter was endowed with a 2015 ASAE Power of A Silver Award and an American Institute of Architects Council for Component Executives Collaboration Award for its BSAFE (Building Safety Assessment & Failure Evaluation) Disaster Response Team & Training, a program for Iowa's architects and engineers who will act as a first responder team during declared disaster situations.

The BSAFE training program equips team members to evaluate damaged buildings in order to keep the building inhabitants safe and healthy. "[The Iowa Chapter's] story exemplifies how associations make a difference every day – not just to the industry or profession they represent, but to society at large," said Hugh MacCannon, MPA, CAE, Executive Director of ACEC of Metropolitan Washington, and chair of the Power of A Awards Judging Committee.

More than 60 architects, engineers, and building officials are a part of the Iowa BSAFE Disaster Response Team, a program made possible through AIA Iowa's persistence in advocating for the Good Samaritan bill, which was signed into Iowa law in 2014. The team was formed and trained in 2015, and is now equipped to respond in a disaster situation to help keep Iowa's residents safe and healthy. Each volunteer must complete a yearly training session, presented by five collaborating organizations: Iowa State Fire Marshal, Iowa Department of Homeland Security, Iowa Association of Building Officials, Structural Engineers of Iowa, and American Council of Engineering Companies. The Power of A Awards reward outstanding accomplishments of associations and industry professionals for their efforts to enrich lives, create a competitive workforce, prepare society for the future, drive innovation, and make a better world.



## WHICH SHOW HAS YOUR NAME ON IT?

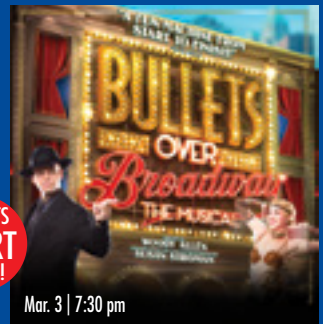
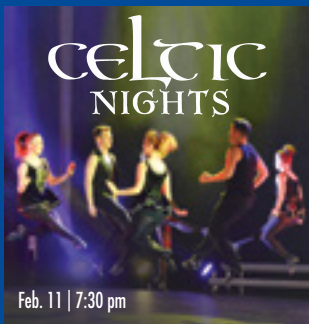

**Stephens Auditorium**  
2015-2016 Performing Arts Series  
IOWA STATE UNIVERSITY | [www.center.iastate.edu](http://www.center.iastate.edu) | 515.294.3347

**PURCHASE TICKETS TODAY!**  
Stephens Auditorium Ticket Office • [ticketmaster.com](http://ticketmaster.com)  
1-800-745-3000 • Ticketmaster Outlets

**VenuWorks**

**BUY  
EARLY  
FOR BEST  
SEATS!**



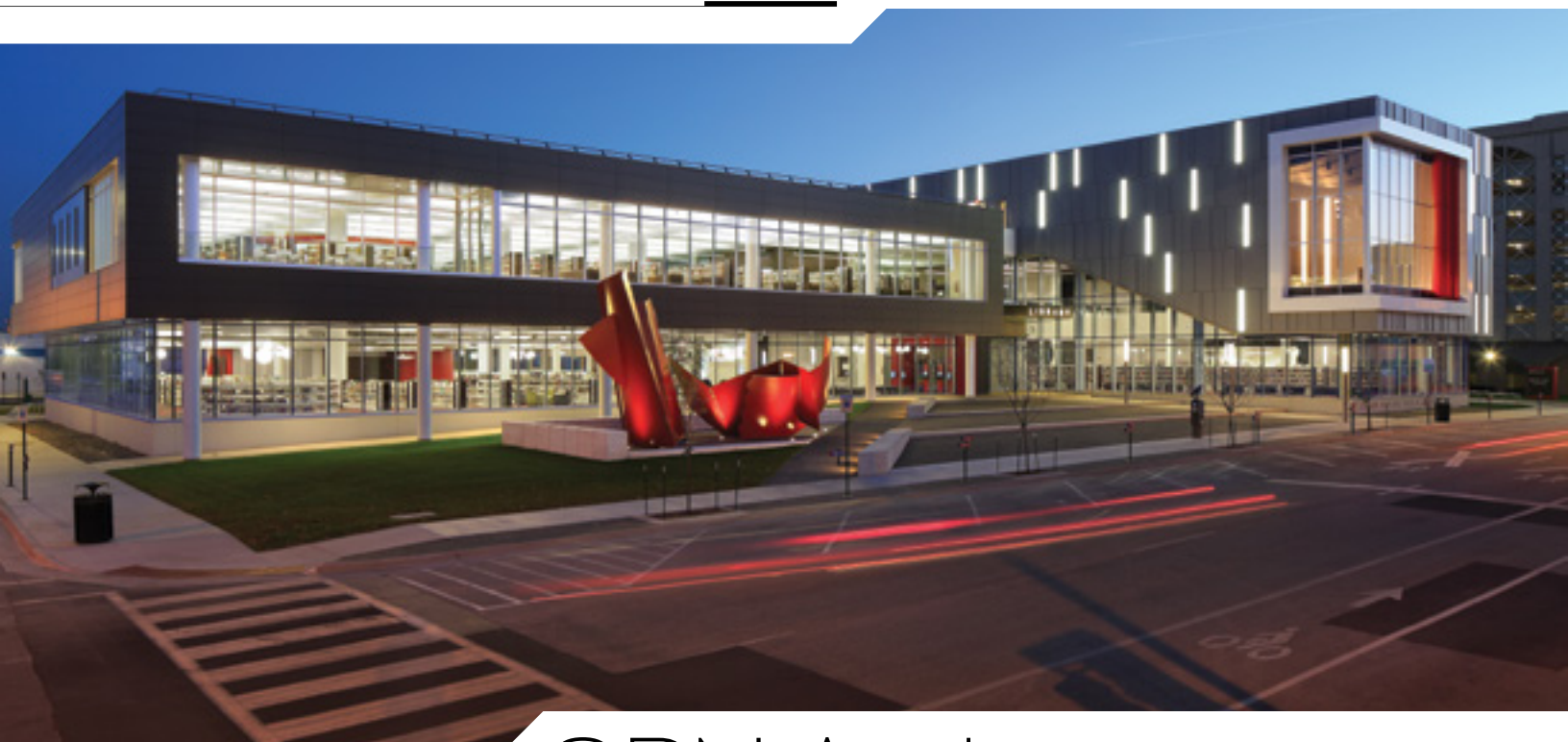

## OPN Architects

**AMERICAN INSTITUTE OF ARCHITECTS/AMERICAN LIBRARY ASSOCIATION  
LIBRARY BUILDING AWARD**

**WORDS:** ABBY GILMAN

Since opening in 2013, the OPN-designed Cedar Rapids Public Library has been recognized nationally and internationally for its thoughtful and welcoming design. The streak continues with the library winning the prestigious 2015 American Institute of Architects/American Library Association Library Building Award. The city of Cedar Rapids lost a valuable community space when the floods of 2008 destroyed the original downtown public library. In the wake of the disaster, the community rallied to build a new library, and with OPN Architects at the helm of design, the new downtown Cedar Rapids Public Library has given the community more than it expected.

The building pushes the boundaries of what a library can do for a community and has become a landmark for beautiful design in the city. “Working on the Cedar Rapids Public Library was the highlight of our professional careers,” commented Bradd Brown, principal at OPN Architects. “We’re flattered that our work has been recognized, but are thrilled that the people of Cedar Rapids can now share and view their library as a world-class facility.” The library welcomed 662,871 visitors and circulated more than 1,444,308 pieces of material in the first year alone. For a community of just 128,429 citizens, the community impact is incredible. Congratulations to OPN Architects on the receipt of this award.

# Substance Architecture

**AIA SMALL PROJECT AWARD**

**WORDS:** KATIE GERFEN

Part of the Principal Riverwalk, a redevelopment project of bridges, outposts, and plazas that connects 300 miles of trails along the Des Moines River, the Hub Spot contains a café, restrooms, and service spaces within a 2,200-square-foot zinc-and-glass pavilion. The pavilion's projecting roof shelters part of the Spot's paver-covered plaza, and undercanopy LED lighting illuminates the area after sunset. Geothermal heating and cooling contribute to the structure's

sustainable ethos. Juror Josh Shelton appreciated the fact that "the trail and the walk passed right through the building. The way that you could get from point A to point B was very lightly interrupted by this structure." And to juror Gregory Hoss, the pavilion proved to be "an incredibly welcoming and extraordinarily friendly public gesture, but it's done in a very sophisticated palette of materials, and very simply."





It's Just Water Without Us



#### Providing:

Concept Development & Budgeting Assistance  
Consultation  
Engineering & Construction Document Services  
Single Source- Design / Build Services

#### Specializing in The Complete Fountain

Structure  
Waterproofing  
Finishes  
Mechanical Systems  
Electrical & Control Systems

Contact [gstoks@cagua.com](mailto:gstoks@cagua.com) for a complimentary conceptual design & budgetary analysis.



**Commercial  
Aquatic  
Engineering**

Now a part of

*SLR*  
**landscape  
structures**

877.632.0503 | [www.fountaindesigns.com](http://www.fountaindesigns.com)

Announcing The Fastest Color Wide Format  
Printer In Iowa. Available Now From  
Rapids Reproductions!



Up To 30 D Size  
Pages Per Minute In  
Monochrome Or Color

**RAPIDS  
REPRODUCTIONS Inc.**

1-800-383-1223

[WWW.RAPIDSREPRO.COM](http://WWW.RAPIDSREPRO.COM)

**SHIVEHATTERY**  
ARCHITECTURE+ENGINEERING

800.798.0313 | [shive-hattery.com](http://shive-hattery.com)



Oaknoll Retirement Community | Iowa City, IA

## Meet the Jury



Roy Decker, AIA Duvall Decker Architects | Jackson, Mississippi

Roy Decker, AIA, principal at Duvall Decker, an expanded design practice, believes the character of the built environment matters to our health and well-being. His firm develops, designs, constructs, and maintains built environments to leverage the best of human endeavors and foster education and cultural growth. Throughout his career, Decker, who holds a master of architecture from Kent State University, has been a teacher, community leader, and practitioner. He has been on

the faculty of Temple University School of Architecture and Mississippi State University's School of Architecture, and is recognized as a contributor to the advancement of the profession. He is often invited to share his firm's work as a lecturer, teacher, design jury chair, and published author. He is a member of the American Planning Association, American National Council of Architectural Registration Boards, American Institute of Architects, and the Construction Specifications Institute.



Cody Farris, Assoc. AIA Duvall Decker Architects | Jackson, Mississippi

Cody Farris, Assoc. AIA, is a senior project designer and manager for Duvall Decker. Since earning his bachelor of architecture at Louisiana State University in 2006, he has collaborated on and led a diverse range of the firm's projects, many of which have received local, regional, and national awards, including the 2014 Brick Institute Awards for the Dumas

Hall Renovations and Mississippi Department of Information Technology. As a senior project designer, Farris brings his design skill to the firm's most challenging projects, conducts research and development of building systems, and provides support to younger project architects and intern architects in the office.



Matthew Kreilich, AIA Snow Kreilich Architects | Minneapolis, Minnesota

As a principal at Snow Kreilich Architects, Matthew Kreilich, AIA, provides his design insight into every project's design, and has acted as the project designer on the studio's most significant recent projects, including the Land Ports of Entry in Warroad Minnesota and Van Buren Maine. Kreilich's committed to providing clients with high-performance design, meeting functional requirements without forfeiting sustainable and pragmatic, yet elegant and refined design. His design leadership and

experience continue to be recognized both locally and nationally. He was honored with the 2009 AIA National Young Architect Award for outstanding design leadership. Locally, his work has received several AIA Minnesota Honor Awards. Kreilich is also the recipient of the prestigious Ralph Rapson Traveling Study Fellowship. He has led studios at the University of Minnesota and participated in reviews at Harvard University's Graduate School of Design and Washington University St Louis.



Andrew Wells, FAIA Dake Wells Architecture | Springfield, Missouri

Andrew Wells, FAIA, is co-founder of Dake Wells Architecture, a critical practice located in Springfield, Missouri, that has achieved national acclaim with engaging design solutions for projects that many might consider without opportunity. Often working with public clients, his work focuses on the experiential nature of architecture, making the most of limited budgets and overlooked possibilities. His practice explores the potential in ordinary things, seeking to elevate materials, sites, and

programs beyond conventional expectations. His work has been published widely, including features in *Architectural Record*, *Architect*, *Contract*, and *Interior Design*, and has received numerous awards from the American Institute of Architects, including a National Honor Award for Interiors for the Exeter Multipurpose Space. Wells received his bachelor of architecture from the Hammons School of Architecture at Drury University, where he serves as adjunct faculty teaching upper-level design studios.





EXCELLENCE IN DESIGN | HONOR

## Career Academy of Pella

A result of collaborative relationships between the Pella Community School District, local private schools, area industry, and a regional community college, the Career Academy houses vocational shops and classrooms that enhance STEM education within the district, and will train students of all ages in skills that are sought in the local workforce. The building is tucked into the hillside and is aligned to the existing topography; the design features natural light and views across the adjacent grassy field. All classroom and shop spaces are constructed of simple, durable materials that will stand up to heavy use.

**ARCHITECT**

Neumann Monson Architects

**SIZE**

23,000 SF

**LOCATION**

Pella, Iowa

**BUDGET**

\$4,800,000









EXCELLENCE IN DESIGN | **HONOR**

## Cascade High School Expansion Center

A deliberate use of clear and translucent exterior materials creates a visual dialogue between this high school's activities and the surrounding town. The new program elements are located adjacent to similar existing functions to support the school's existing organization, unifying the school's primary façade, and updating a building that has seen many additions over the past four decades. Glazing is combined with translucent polycarbonate panels to create a pleasant naturally lit learning environment. At night, as musical and sporting activities begin, the glazing becomes a beacon to the town – and those passing on the highway – as the building emits a soft glow announcing the activities within.

**ARCHITECT**

Neumann Monson Architects

**SIZE**

43,090 SF

**LOCATION**

Cascade, Iowa

**BUDGET**

\$6,500,000









EXCELLENCE IN DESIGN | HONOR

# Lutheran Church of Hope

Lutheran Church of Hope is the suburban satellite campus of a large Evangelical Lutheran Church in the heart of Iowa. The simple, white precast concrete form sits in stark contrast to the earth-tone sided and shingled environment of the surrounding suburb. The 20-acre site is developed with low-maintenance native vegetation and a pond to manage storm water for the larger series of residential and commercial lots surrounding it. The project represents phase one of development for a fast-growing congregation. As such, the programmatic requirements were to provide a series of multi-purpose spaces to establish a core that could be expanded over time.

**ARCHITECT**

BNIM

**SIZE**

34,445 SF

**LOCATION**

Ankeny, Iowa







EXCELLENCE IN DESIGN | **HONOR**

## Corporate Campus Parking Facility

The 1,400-vehicle parking structure is sized and designed to meet the parking demand of an adjacent new office building. Designed with a cast-in-place post-tensioned concrete frame and deck, the structure is built into the natural grade of the site to minimize the impediment of the view of the central campus design, and provide accessible egress paths to grade from all levels. An expanded metal screen at the east loggia provides a visual and physical separation between the campus pedestrians and the vehicles hidden beyond.

**ARCHITECT**

Substance Architecture

**SIZE**

420,000 SF

**LOCATION**

West Des Moines, Iowa





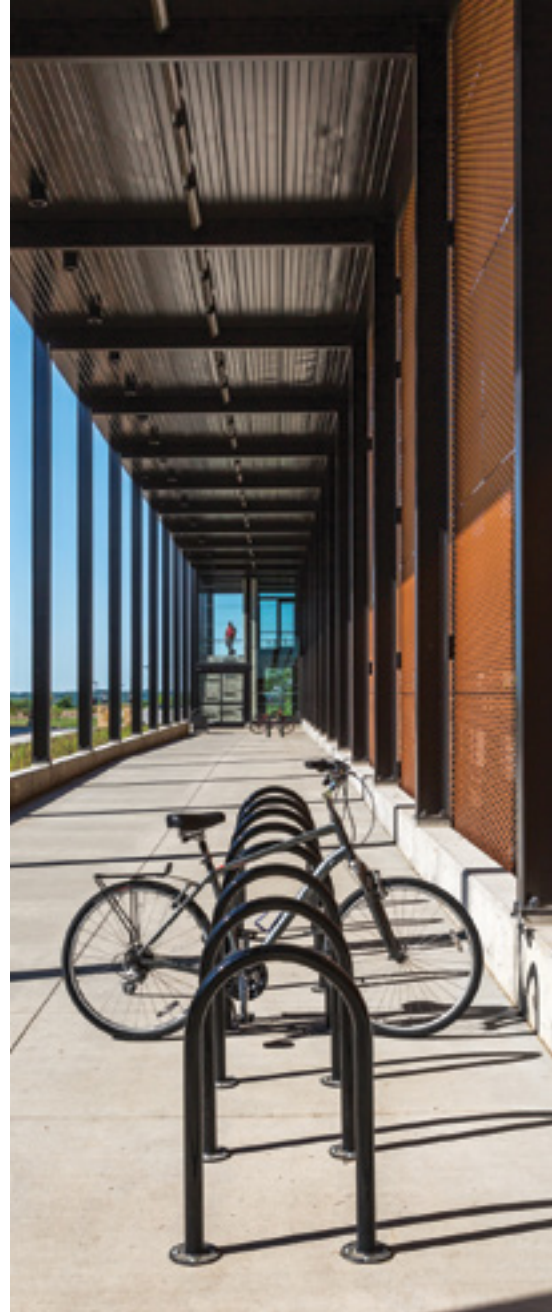



EXCELLENCE IN DESIGN | MERIT

# 350 East Locust

Located in a historical district, this five-story, mixed-use project interweaves city life from street to skyline. The 45,000-square-foot program offers ground-level retail spaces, 20 residential units on levels 2-4, and a private office on level 5; in addition, level 4 provides an outdoor commons space with westward views of the downtown skyline. At the street level, expansive storefront windows visually connect 6,000 square feet of commercial shops with pedestrians. The building is carefully proportioned to blend with its historical context, while offering departures from the traditional. Brick meets the district's material requirement, while the shifted window placement along the south façade reinterprets tradition, then terminates to the west with an expected alignment.

**ARCHITECT**

Neumann Monson Architects

**SIZE**

45,000 SF

**LOCATION**

Des Moines, Iowa





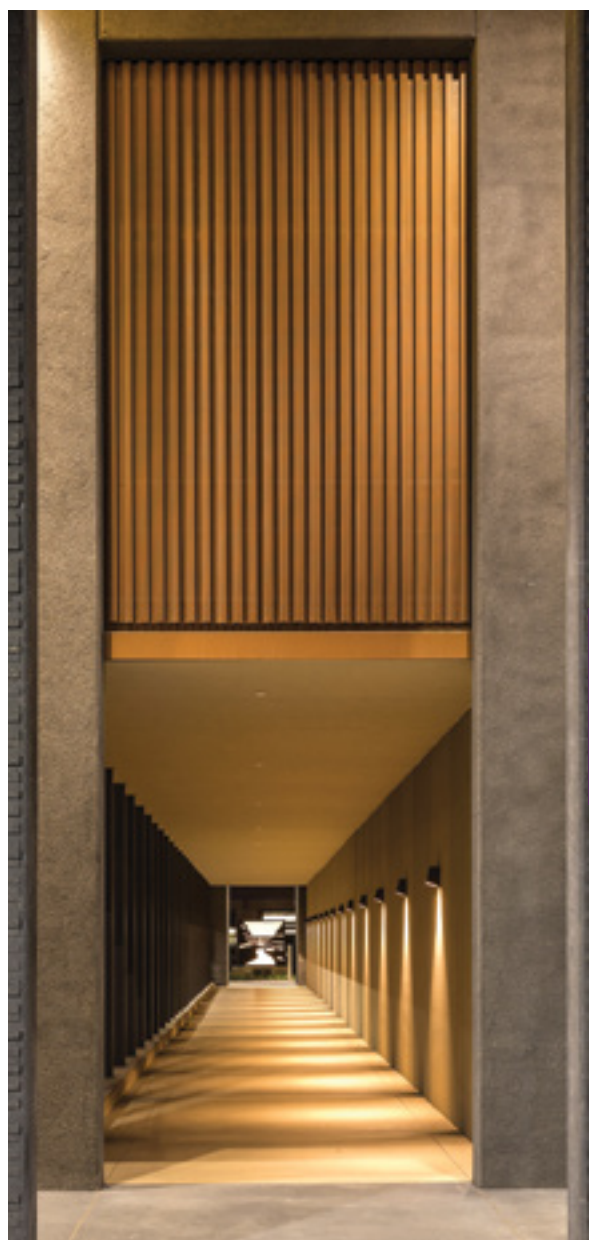

EXCELLENCE IN DESIGN | MERIT

## Corporate Campus Cafeteria and Training Center

This large corporate office was in need of a new cafeteria and training center to serve its growing employee population. The design team generated a simple figurative strategy to integrate the addition, interpreting the building as a series of layers that progress from the lightest, most public, and open facing the inner campus, to the densest, most private, and closed along the perimeter service road.

**ARCHITECT**

Substance Architecture

**LOCATION**

West Des Moines, Iowa

**SIZE**

50,000 SF





EXCELLENCE IN DESIGN | MERIT

# Crystal Cove Wildlife Observatory

This year-round wildlife observation concept was constantly refined during the design process, but ultimately resulted in two closely spaced pavilions, one housing video observation within an opaque structure offering a glimpse into otherwise concealed wildlife habitats, the second an outdoor observation behind a wood slat screen. In an effort to develop a tectonic that supports observation activities while minimizing impact on local ecologies, the design team examined how the park vernacular had evolved. Implementing some of this park wisdom, along with a constant effort to reduce the physical and budgetary footprint of the pavilions, resulted in a facility that is very much of the place.

**ARCHITECT**

PLaN Architecture

**LOCATION**

South Sioux City, Nebraska

**SIZE**

640 SF

**BUDGET**

\$200,000







EXCELLENCE IN DESIGN | **MERIT**

## Des Moines Community Playhouse Addition

Due to the continual success of its programs and a growing need to service more of the community, the Playhouse sought to renovate and expand its historical structure. An addition, sited along a highly visible city thoroughfare, holds a lobby and new entryway that now serves as a marquee for the Playhouse and a prominent gateway to the Roosevelt Cultural District. This thoughtful intervention is only the first part of a comprehensive master plan and multi-phased design approach for the Playhouse.

**ARCHITECT**

BNIM

**SIZE**

4,313 SF

**LOCATION**

Des Moines, Iowa







EXCELLENCE IN DESIGN | MERIT

# Modus Engineering Office

Located on the third floor of the recently overhauled Market One building in Des Moines, the engineering studio provides nearly 10,000 square feet of vibrant work environment for 60 employees. The studio is outfitted with height-adjustable workstations and algorithmically based color-changing LED lighting that alters the color and intensity to mimic natural daylight, though perimeter windows are operable. Green acrylic panels and laminated glass provide a bold and immediate delivery of the company brand.

**ARCHITECT**

Neumann Monson Architects

**SIZE**

11,500 SF

**LOCATION**

Des Moines, Iowa

**BUDGET**

\$1,200,000



# COMMERCIAL NEW CONSTRUCTION PROGRAM

It pays to make energy efficiency part of the plan.

Make energy efficiency part of your design with the Commercial New Construction program and receive free energy design assistance. Energy-efficient measures also qualify for cash incentives and will help owners realize energy cost savings for years to come.

For more information, contact the program administrator:

/// The Weidt Group® at 877.939.1874

## 2015

### Congratulations Excellence in Energy Efficient Design Award Recipients!

**Substance Architecture and KJWW Engineering Consultants**

University of Iowa Stew and Lenore Hansen Football  
Performance Center

**Wells + associates, PC and KCL Engineering**

Des Moines Public Schools, Jesse Franklin Taylor  
Education Center

**FEH DESIGN and Farris Engineering**

Bondurant-Farrar Community School District, Morris Elementary

**StruXture Architects and KCL Engineering**

Ankeny Community School District, Rock Creek Elementary

**OPN Architects and Design Engineers**

Kirkwood Community College, Linn Hall Renovation

**StruXture Architects and KJWW Engineering Consultants**

Decorah Community School District, Decorah High School  
Addition/Renovation

**Shive-Hattery, Inc.**

University of Iowa, Tennis & Recreation Complex Indoor Turf Addition

**Neumann Monson Architects and Design Engineers**

Western Dubuque Community School District, Western Dubuque  
High School at Epworth Addition

**Snyder & Associates Engineers, Inc., Solum Lang Architects,  
LLC and Design Engineers**

City of West Burlington, Public Works Facility

**IIW, P.C. and DLR Group**

Dubuque Community School District, Kennedy Elementary School  
Addition/Renovation



[AlliantEnergy.com/NewConstruction](http://AlliantEnergy.com/NewConstruction)



[bheSaveMoney.com](http://bheSaveMoney.com)



[MidAmericanEnergy.com/Iowa\\_CNC](http://MidAmericanEnergy.com/Iowa_CNC)



# Get away to the big screen.



## IOWA **FILM FESTIVALS**

**Discover unforgettable movies.** From the Siouxland to Snake Alley, Iowa film festivals stay with you long after the credits have rolled. Engage in lively discussions with the directors and meet the filmmakers of tomorrow. Start planning your getaway and view our statewide listing of festivals at **[produceiowa.com](http://produceiowa.com)**.



Decorah	Tipton
Sioux City	Iowa City
Dubuque	Mason City
Cedar Rapids	Muscatine
Burlington	Marshalltown
Des Moines	Sioux Center



**PRODUCE IOWA**  
STATE OFFICE OF MEDIA PRODUCTION  
IOWA DEPARTMENT OF CULTURAL AFFAIRS



## THE WEIDT GROUP®

Building Lifelong Energy Performance™

Energy Design Assistance  
including analysis,  
benchmarking, verification  
and software development

Commercial  
New Construction  
Utility Programs



Apply Online



twgi.com 2815 Beaver Ave #106 Des Moines 515.271.9906

## CREATIVE COLLABORATIVE CONSISTENT



Bennett Ruffes Memorial Chapel, Integrated Studio, Cameron Campbell

### STRUCTURAL ENGINEERING

CHARLES SAUL  
ENGINEERING INC

4308 UNIVERSITY AVENUE DES MOINES IOWA 50311  
phone 515.279.3900 fax 515.279.5233 [csengr.com](http://csengr.com)



**STETSON**  
BUILDING PRODUCTS, INC.

THANK YOU FOR YOUR SUPPORT

SINCE  
1955

60  
YEARS



60  
YEARS



Iowa Architect Magazine &  
Stetson Building Products, Inc.  
Celebrate 60 years!

Since 1955,

Stetson Building Products, Inc.  
has been a part of the community.

We are proud to be celebrating  
60 years with you & providing  
quality construction products and service!

*"Your Partner in Quality Construction"*

9 Midwest Locations throughout  
Iowa, Illinois, Nebraska & Wisconsin  
Corporate Office:

Des Moines, IA (800) 383-2181

[www.StetsonBuildingProducts.com](http://www.StetsonBuildingProducts.com)

ideas +



WALKER COEN LORENTZEN ARCHITECTS  
[www.realizeyourvision.net](http://www.realizeyourvision.net) | 515 279 8818





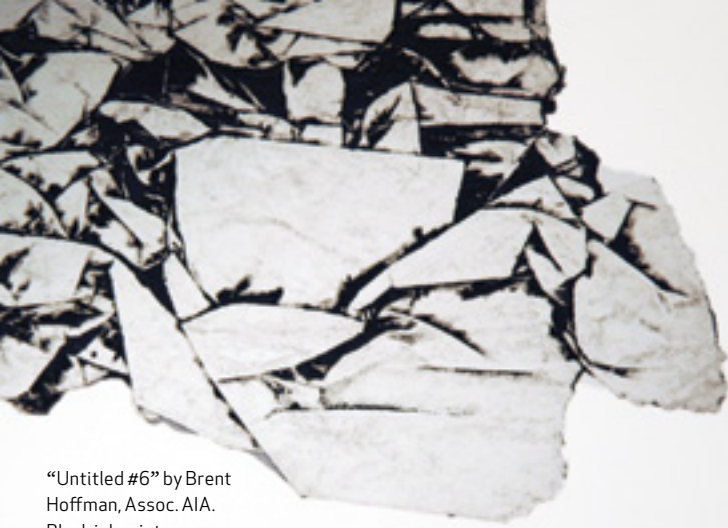

"Untitled #6" by Brent Hoffman, Assoc. AIA.  
Black ink print.

## A Glimpse Into The **FUTURE**

Annual AIA Iowa Emerging Professionals Competition honors work of young designers.

WORDS: COLE NORUM

For a couple days in October, you could see the future. The AIA Emerging Professionals Competition displayed architectural work, art, and designs of students, intern architects, and those licensed within the last 10 years at the AIA Iowa | Central States Region Convention held in Des Moines October 15 through 16, 2015. More than 1,000 convention attendees and exhibitors saw works selected from more than 40 submissions. Beyond promoting the efforts of a rising generation of architects and designers, the Emerging Professionals Competition offered a platform for feedback and input. "Sharing my artwork outside of my immediate group of friends was beneficial," says Brent Hoffman, Assoc. AIA.

Hoffman's black ink print "Untitled #6" won the \$300 Grand Prize. "It's one in a series of six that begins to explore

the beauty of the discarded," Hoffman says. The piece is the result of a years-long foray into working with packaging materials, a seemingly innocuous instrument of our daily routines that begins to take on new purposes when viewed at in different contexts. That very approach of seeking new perspectives is what drove Hoffman to submit his work to the competition. "I feel fortunate for the opportunity," he says. "The feedback I received during and after the convention has inspired me to spend more time exploring the medium and seeing where it will take me next."

Hoang Tran, Assoc. AIA, and Monica Bailey, Assoc. AIA, were also recognized for their efforts in the Emerging Professionals Competition for their projects "Proposal for Renovation: Rockwell Collins" and "Chicago Architecture Biennial Lakefront Kiosk Competition," respectively.

### Want E&O coverage that includes

- Up to a 10% premium credit for taking free risk management courses
- An additional premium credit of up to 15% for using Limitation of Liability clauses in your contracts
- A 75% deductible credit for using recommended practices
- 24/7 access to the XL Group's Contract eGuide with copy/paste contract language
- Free PDHs



**We got it.**



Paula Dixon  
PDixon@holmesmurphy.com

Nick Maletta  
NMaletta@holmesmurphy.com

800 247 7756  
www.holmesmurphy.com

Learn more.  
[xlcatlin.com/dp](http://xlcatlin.com/dp)

XL Catlin is the global brand used by XL Group plc's insurance subsidiaries. In the U.S., the insurance companies of XL Group plc are: Catlin Indemnity Company, Catlin Insurance Company, Inc., Catlin Specialty Insurance Company, Greenwich Insurance Company, Indian Harbor Insurance Company, XL Insurance America, Inc., XL Insurance Company of New York, Inc., and XL Specialty Insurance Company. Not all of the insurers do business in all jurisdictions nor is coverage available in all jurisdictions.

# AIA CENTRAL STATES REGIONAL DESIGN AWARDS

## Meet the Jury



Jennifer Yoos, FAIA VJAA | Minneapolis, Minnesota

Jennifer Yoos, FAIA, a design principal and president of VJAA, is known for its innovative approach to architectural practice, environmental design, and highly crafted buildings. Yoos received her graduate diploma in design from the Architectural Association in London; her professional degree in architecture from the University of Minnesota; and was awarded a Loeb Fellowship at the Harvard Graduate School of Design. She practiced architecture both independently and with firms in Minneapolis and London prior to

joining VJAA in 1997. VJAA is the recipient of the 2012 National American Institute of Architects Firm Award. Since its founding in 1995, the firm has received 19 national design awards, including six National American Institute of Architects Honor Awards, six Progressive Architecture Awards, and two American Institute of Architects Committee on the Environment Top Ten Green Building Awards. In 2010, *Architect* magazine ranked VJAA first in the United States for design recognition.



Bill Baxly, AIA Leo A. Daley | Minneapolis, Minnesota

For more than 25 years, through an approach that emphasizes dialogue, transparency, and accessibility with his clients, Bill Baxly, AIA, has imparted exceptional design within the public realm and created meaningful places where communities can thrive. His work has been awarded locally and nationally. Baxly understands successful public design extends beyond the building's walls and into the broader context of community. He emphasizes a message of sustainability

not only through the selection of materials and methods, but also by creating meaningful work that will meet the evolving needs of clients and community, giving governments and organizations the opportunity to reach the people they serve. Baxly has a passion for design innovation explored through national and international design competitions most recently for Metropolis Magazine Workplace of the Future and as a finalist for the SABIC Headquarters in Jubail, KSA.



Marc Swackhamer, Assoc. AIA HouMinnPractice | Minneapolis, Minnesota

Marc Swackhamer, Assoc. AIA, received his bachelor's of architecture from the University of Cincinnati and a master's of architecture from Rice University. His research explores the relationship between performance and ornament through the lens of digital representation and fabrication. He is a partner at HouMinn Practice, which challenges in-place techniques of construction and material

production. HouMinn was bestowed a 2014 Architect Magazine R+D Award and a 2014 Core77 Design Award for this work. In addition to core design courses, Swackhamer teaches on the topic of hypernatural design. With Professor Blaine Brownell, he co-authored the book *Hypernatural: Architecture's New Relationship with Nature* in 2015.



ARCHITECTURE  
HONOR

## Kansas City Police Department

**ARCHITECT**

Helix Architecture + Design

**LOCATION**

Kansas City, Missouri



ARCHITECTURE  
HONOR

## Corporate Campus Parking Facility

**ARCHITECT**

Substance Architecture

**LOCATION**

West Des Moines, Iowa







ARCHITECTURE  
HONOR

## Pump Station

**ARCHITECT**

Substance Architecture

**LOCATION**

Des Moines, Iowa



ARCHITECTURE  
HONOR

## Speculative Office Building

**ARCHITECT**

El Dorado Inc.

**LOCATION**

Leawood, Kansas





ARCHITECTURE  
HONOR

## The Marvin Hall Forum

**ARCHITECT**

Studio 804

**LOCATION**

Lawrence, Kansas



ARCHITECTURE  
MERIT

## College of Pharmacy

**ARCHITECT**

CannonDesign

**LOCATION**

St. Louis, Missouri





ARCHITECTURE  
MERIT

## Corporate Campus Cafeteria and Training Center

**ARCHITECT**

Substance Architecture

**LOCATION**

West Des Moines, Iowa



ARCHITECTURE  
MERIT

## Des Moines Community Playhouse Addition

**ARCHITECT**

BNIM

**LOCATION**

Des Moines, Iowa





## Heartland Habitat For Humanity Prototype

**ARCHITECT**

El Dorado Inc.

**LOCATION**

Kansas City, Missouri



## Intermodal Facility

**ARCHITECT**

Neumann Monson Architects

**LOCATION**

Coralville, Iowa





ARCHITECTURE  
MERIT

## Iowa Prison Industries Outlet

**ARCHITECT**

ASK Studio

**LOCATION**

Des Moines, Iowa



ARCHITECTURE  
MERIT

## Liberty United Methodist Church

**ARCHITECT**

Dake Wells Architecture

**LOCATION**

Liberty, Missouri





ARCHITECTURE  
MERIT

## Marjorie K. Daugherty Conservatory

**ARCHITECT**

HDR Architecture

**LOCATION**

Omaha, Nebraska



HISTORICAL PRESERVATION  
OR ADAPTIVE REUSE  
**HONOR**

## American Enterprise Group Corporate Headquarters

**ARCHITECT**

BNIM

**LOCATION**

Des Moines, Iowa





HISTORICAL PRESERVATION  
OR ADAPTIVE REUSE  
**MERIT**

## Cultural Center

**ARCHITECT**  
INVISION Architecture

**LOCATION**  
Greenfield, Iowa



HISTORICAL PRESERVATION  
OR ADAPTIVE REUSE  
**MERIT**

## Market One

**ARCHITECT**  
Neumann Monson Architects

**LOCATION**  
Des Moines, Iowa







HISTORICAL PRESERVATION  
OR ADAPTIVE REUSE  
**MERIT**

## The LUX

**ARCHITECT**  
El Dorado Inc.

**LOCATION**  
Wichita, Kansas



INTERIOR ARCHITECTURE  
**HONOR**

## Bucktown House

**ARCHITECT**  
Min | Day

**LOCATION**  
Chicago, Illinois







INTERIOR ARCHITECTURE  
**HONOR**

## ImageNet Carrollton Remodel

**ARCHITECT**

Elliott + Associates Architects

**LOCATION**

Carrollton, Texas

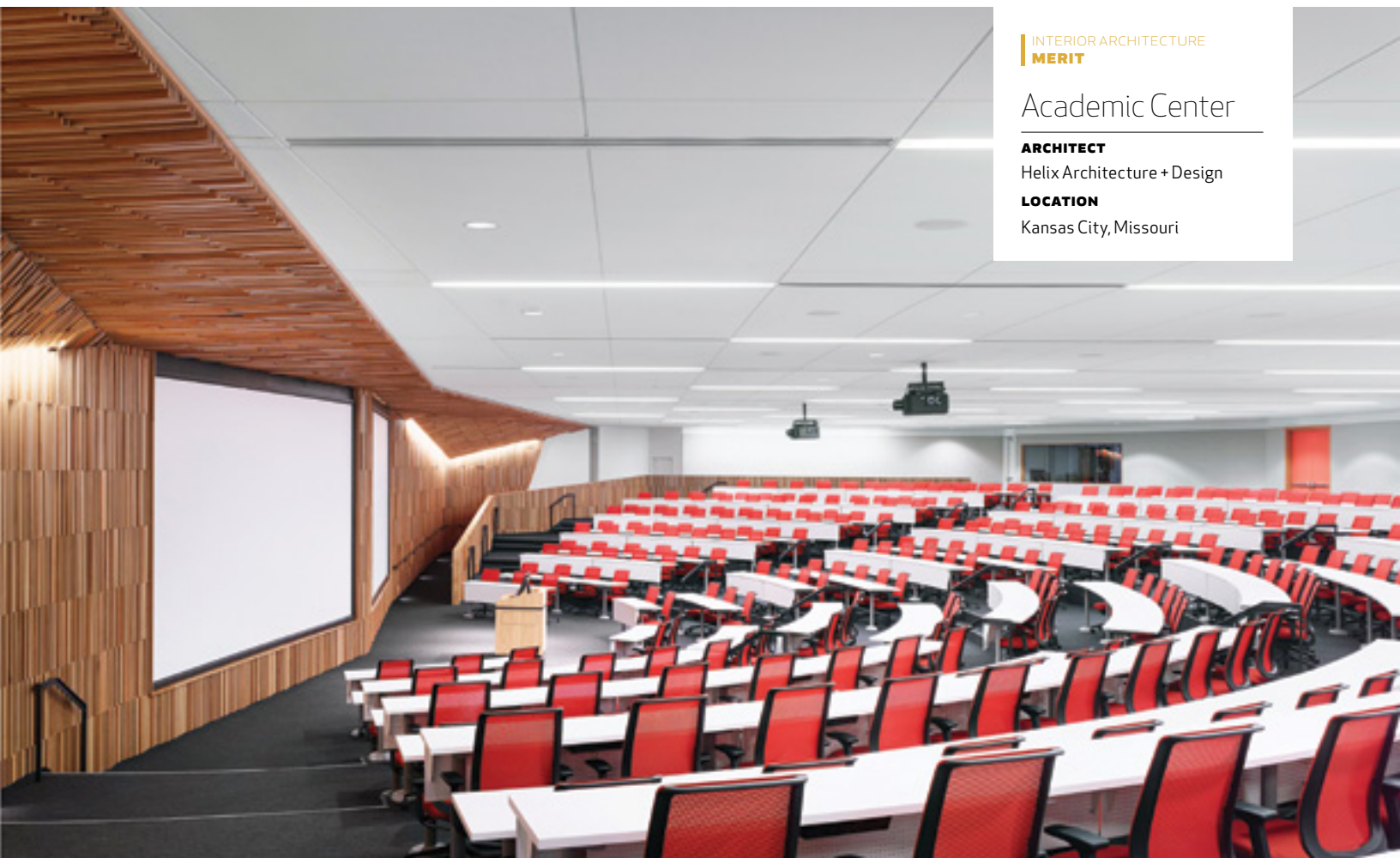

INTERIOR ARCHITECTURE  
**MERIT**

## Academic Center

**ARCHITECT**

Helix Architecture + Design

**LOCATION**

Kansas City, Missouri



## Ghost Gallery

**ARCHITECT**

Elliott + Associates Architects

**LOCATION**

Oklahoma City, Oklahoma

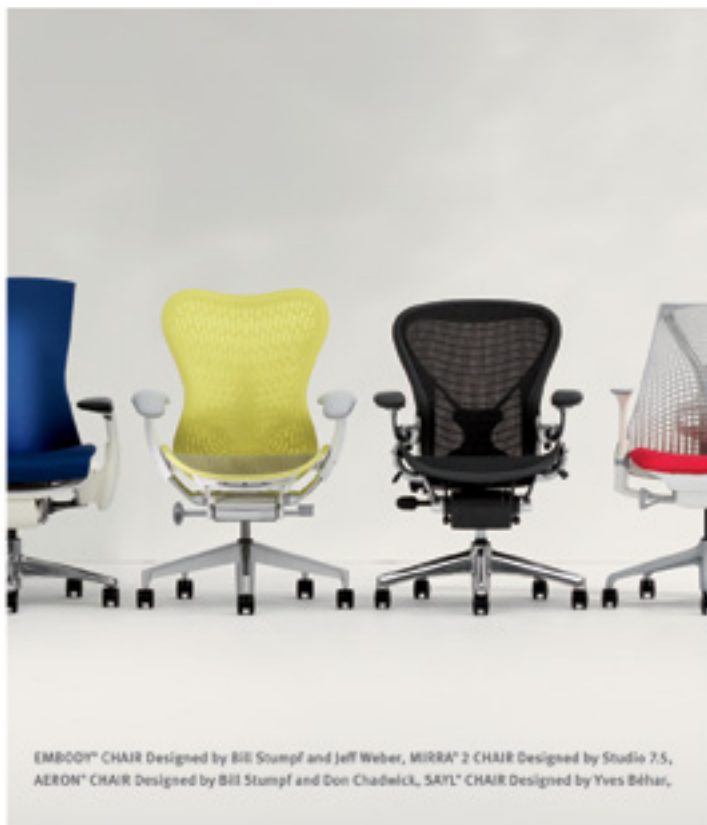
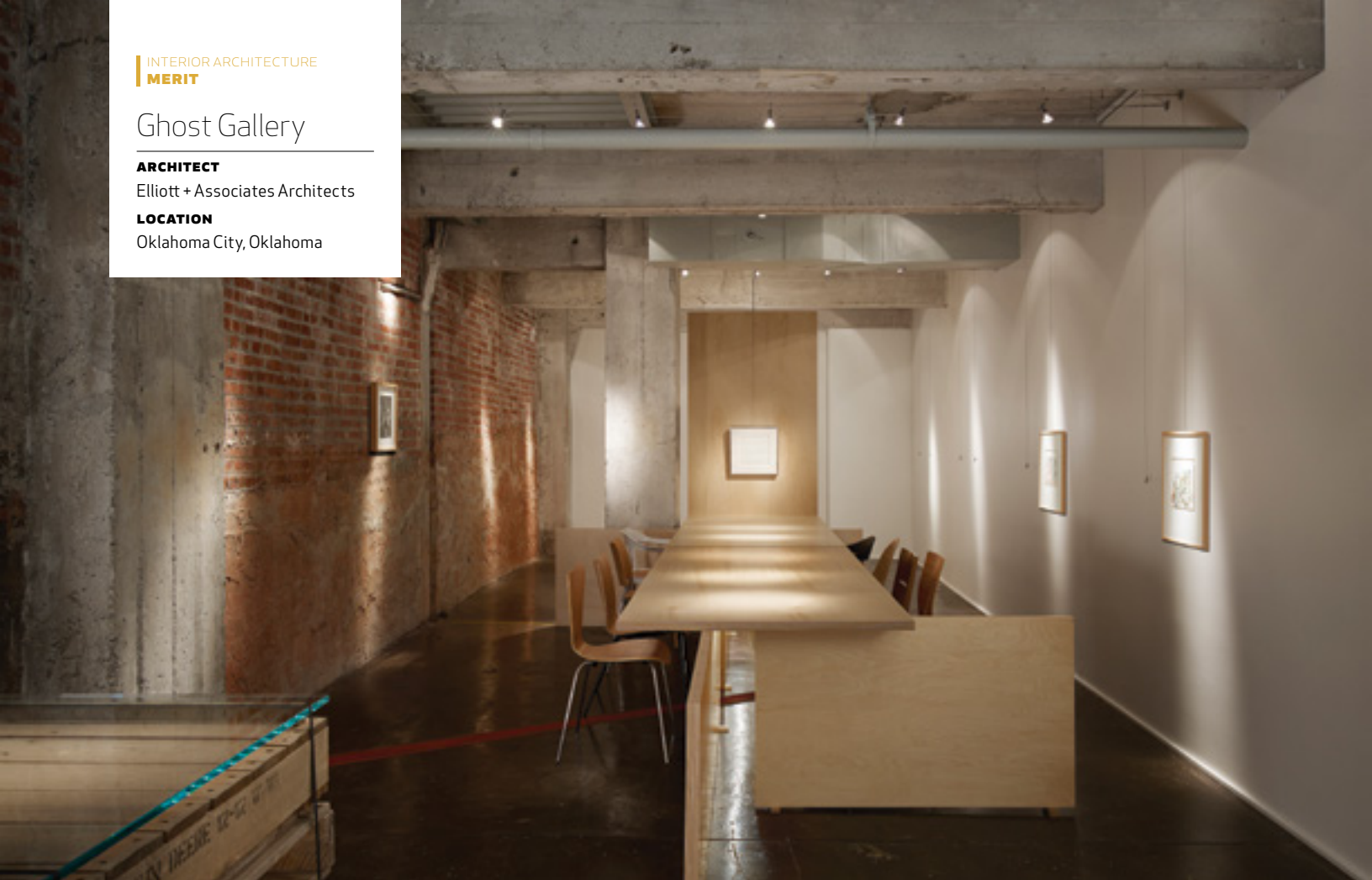

EMBOOH® CHAIR Designed by Bill Stumpf and Jeff Weber, MIRRA® 2 CHAIR Designed by Studio 7.5, AERON® CHAIR Designed by Bill Stumpf and Don Chadwick, SAYL® CHAIR Designed by Yves Béhar,

**A Herman Miller  
performance chair  
to support your  
every move.**

**PIGOTT**

For more information visit  
[pigottnett.com/campaign/performance-seating](http://pigottnett.com/campaign/performance-seating)

**HermanMiller** Authorized Dealer



***Ann Sobiech Munson*** *AIA CSI CCS*  
AIA National Young Architect Award



***Jessica Terrill*** *AIA LEED® AP*  
AIA IA Young Architect Award  
Editor of *Iowa Architect*

***We are proud of you!***

**substancearchitecture**

learn more about us [substancearchitecture.com](http://substancearchitecture.com)



## Krause Gateway Center

Des Moines, Iowa

Designed by Renzo Piano Building Workshop,  
architects, in collaboration with OPN Architects.



Introducing Molin's state-of-the-art

## ARCHITECTURAL PRECAST AUTOMATED WALL PANEL PLANT



Our product offerings  
have expanded. Call us today  
to learn more.

**MOLIN**

Quality Concrete Solutions  
since 1997

DESIGNERS | MANUFACTURERS | INSTALLERS  
STRUCTURAL & ARCHITECTURAL PRECAST/PRESTRESSED CONCRETE

415 Lilac Street, Line Lakes, MN 55014  
651.786.7722 | 800.336.6546 | www.MOLIN.com



**DLR Group**

Architecture Engineering Planning Interiors

offices nationwide

dlrgroup.com

515/276-8097



## Historic Park Inn

Last remaining Frank Lloyd Wright  
designed & built hotel in the world.

1910  
LOUNGE

FINE DINING  
& LOUNGE

1910  
LOUNGE

8,000 SQ. FT. OF MEETING SPACE

27 UNIQUE SUITES

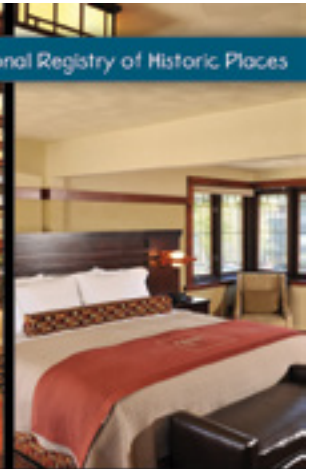

Listed in the National Registry of Historic Places

7 West State Street | Mason City, IA | [historicparkinn.com](http://historicparkinn.com) | 800.659.2220

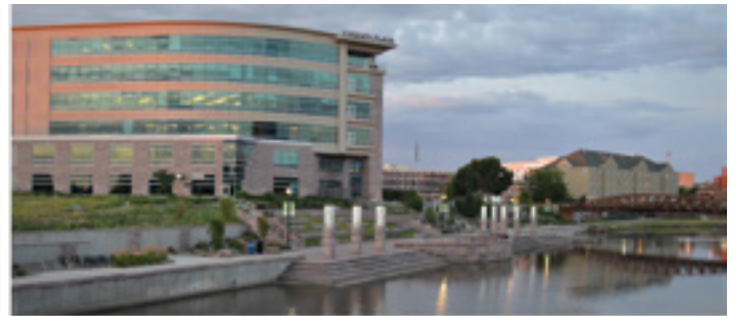

Confluence brings landscape architecture, planning and urban design together as a creative but practical means of merging our client's needs with the environment. As stewards of the land and the built environment, we aspire to create a human connection with each project and its surrounding context while respecting nature.

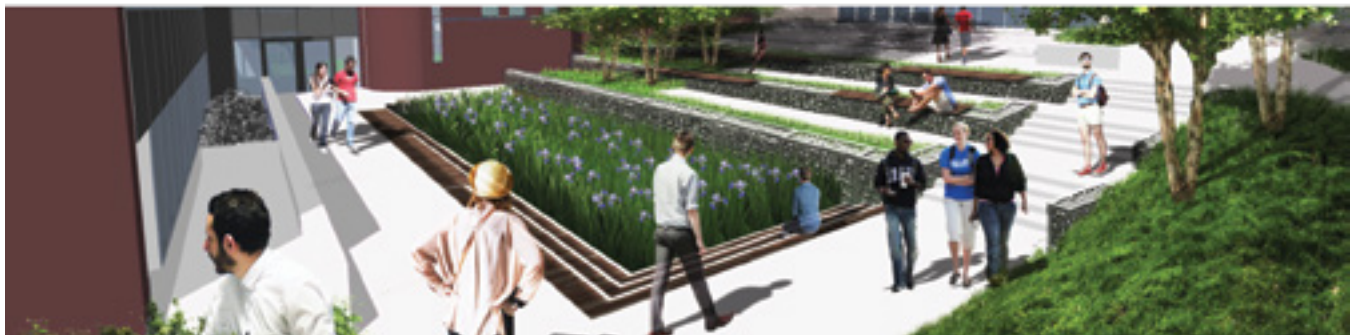

CONFLUENCE

Des Moines / Kansas City / Sioux Falls / Cedar Rapids / Minneapolis

[WWW.THINKCONFLUENCE.COM](http://WWW.THINKCONFLUENCE.COM)





**Presenting the**

**Iowa Center for  
ARCHITECTURE**

a partnership of



**AIA**  
Iowa



IOWA  
ARCHITECTURAL  
FOUNDATION

We are dedicated to providing resources and programming to engage the public in architecture and design.

Visit us at [AIAIowa.org](http://AIAIowa.org), [IowaArchitecture.org](http://IowaArchitecture.org) and [IowaArchFoundation.org](http://IowaArchFoundation.org)

## Exceeding Expectations...



 **WELLS CONCRETE**  
BRINGING CONCRETE TO LIFE

Des Moines **515.981.4624**  
[www.wellsconcrete.com](http://www.wellsconcrete.com)

III E I E E  
studiomelee.com



city square lofts  
staybridge suites  
des moines, ia

**Engineered Excellence**



**Tometch Engineering, Inc.**  
consulting structural engineers

515.280.8022 • tometchengineering.com

## Discover Iowa Architecture



**www.iowaarchitecture.org**



**AIA  
Iowa**

A free public resource.  
Learn about award-winning Iowa architecture,  
create tours, and explore your surroundings.



# project credits

## Collected

### Cedar Rapids Public Library .....12

**LOCATION:** Cedar Rapids, Iowa  
**ARCHITECT:** OPN Architects  
**CONTRACTOR:** Ryan Companies  
**ENGINEER:** M2B Structural Engineers; Design Engineers  
**PHOTOGRAPHER:** Main Street Studio

### The Hub Spot .....13

**LOCATION:** Des Moines, Iowa  
**ARCHITECT:** Substance Architecture  
**LANDSCAPE ARCHITECT:** Wallace Roberts & Todd, LLC  
**CONTRACTOR:** Covenant Construction Services  
**CIVIL ENGINEER:** Stanley Consultants  
**STRUCTURAL ENGINEER:** Charles Saul Engineering  
**MECH/ELEC ENGINEER:** KJWW Engineering  
**PHOTOGRAPHER:** Paul Crosby

## AIA Iowa Excellence in Design

### Career Academy of Pella .....16

**LOCATION:** Pella, Iowa  
**ARCHITECT:** Neumann Monson Architects  
**CONTRACTOR:** Larson and Larson  
**STRUCTURAL ENGINEER:** Raker Rhodes  
**PHOTOGRAPHER:** Cameron Campbell Integrated Studio  
**M/E/P ENGINEER:** Modus  
**CIVIL ENGINEER:** Raker Rhodes  
**LANDSCAPE ARCHITECT:** Dennis Reynolds Urban Design

### Cascade High School Expansion .....18

**LOCATION:** Cascade, Iowa  
**ARCHITECT:** Neumann Monson Architects  
**CONTRACTOR:** Conlon Construction  
**STRUCTURAL:** M2B  
**PHOTOGRAPHER:** Cameron Campbell, AIA, Integrated Studio  
**M/E/P Engineer:** Design Engineers  
**Civil Engineer:** WHKS  
**ACOUSTICAL CONSULTANT:** C & C Consultants

### Lutheran Church of Hope... 20

**LOCATION:** Ankeny, Iowa  
**ARCHITECT:** BNIM  
**CONTRACTOR:** Ball Team LLC  
**ENGINEER:** Charles Saul Engineering Inc  
**PHOTOGRAPHER:** Nick Merrick Hedrich Blessing  
**MEP ENGINEER:** KCL Engineering LLC  
**CIVIL ENGINEER:** Civil Design Advantage  
**LANDSCAPE ARCHITECT:** BNIM

### Corporate Campus Parking Facility ..... 22, 34

**LOCATION:** West Des Moines, Iowa  
**ARCHITECT:** Substance Architecture  
**CONTRACTOR:** The Weitz Company  
**PHOTOGRAPHER:** Paul Crosby  
**PARKING CONSULTANT:** Walker Parking Consultants  
**MECHANICAL:** Baker Group  
**ELECTRICAL:** Baker Electric  
**STRUCTURAL ENGINEER:** Charles Saul Engineering  
**CIVIL ENGINEER:** Cooper Crawford Associates  
**LANDSCAPE ARCHITECTURE:** Confluence  
**LEED CONSULTANT:** C-Wise

### 350 East Locust ..... 24

**LOCATION:** Des Moines, Iowa  
**ARCHITECT:** Neumann Monson Architects  
**CONTRACTOR:** Graham Construction  
**Structural:** Raker Rhodes  
**PHOTOGRAPHER:** Farshid Assassi  
**M/E/P ENGINEER:** Brewer Engineering  
**CIVIL ENGINEER:** CEC:Urbandale  
**INITIAL CONCEPTUAL DOCUMENTS FOR THE CITY OF DES MOINES**  
**BLOCK GRANT APPLICATION:** Goche Inclusions, LLC  
**INITIAL CONCEPTUAL DOCUMENTS FOR THE CITY OF DES MOINES**  
**BLOCK GRANT APPLICATION:** Charles Saul Engineering

### Corporate Campus Cafeteria and Training Center ..... 25, 37

**LOCATION:** West Des Moines, Iowa  
**ARCHITECT:** Substance Architecture  
**CONTRACTOR:** Weitz, Inc.

**PHOTOGRAPHER:** Paul Crosby  
**MECHANICAL:** Baker Group  
**ELECTRICAL:** Baker Electric  
**STRUCTURAL ENGINEER:** Charles Saul Engineering  
**CIVIL ENGINEER:** Cooper Crawford Associates  
**LANDSCAPE ARCHITECTURE:** Confluence

### Crystal Cove Wildlife Observatory ..... 26

**LOCATION:** South Sioux City, Nebraska  
**ARCHITECT:** PLaN Architecture  
**CONTRACTOR:** DA Davis Construction  
**ENGINEER:** Olsson Associates  
**PHOTOGRAPHER:** Chadd Goosmann, Aurora Photography

### Des Moines Community Playhouse Addition ..... 27, 37

**LOCATION:** Des Moines, Iowa  
**ARCHITECT:** BNIM  
**CONTRACTOR:** Neumann Brothers Inc  
**ENGINEER:** Raker Rhodes Engineering LLC  
**PHOTOGRAPHER:** BNIM  
**CIVIL ENGINEER:** Snyder & Associates  
**THEATER PLANNER/LIGHTING DESIGNER:** Schuler Shook  
**ACOUSTICS CONSULTANT:** Jaffee Holden Acoustics Inc  
**ELECTRICAL ENGINEER:** Baker Electric Inc  
**MECHANICAL ENGINEER:** The Waldinger Coporation  
**GEOTECHNICAL/ENVIRONMENTAL CONSULTANT:** Allender Butzke Engineers, Inc

### Modus Engineering Office ..... 28

**LOCATION:** Des Moines, Iowa  
**ARCHITECT:** Neumann Monson Architects  
**CONTRACTOR:** Beal Derkenne Construction  
**M/E/P ENGINEER:** Modus  
**PHOTOGRAPHER:** Cameron Campbell, AIA, Integrated Studio  
**STRUCTURAL ENGINEER:** Raker Rhodes  
**LANDSCAPE ARCHITECT:** Genus Landscape Architects  
**LEED CONSULTING:** C-Wise

## AIA Central States Design Award Winners

### Kansas City Police Department ..... 34

**LOCATION:** Kansas City, Missouri  
**ARCHITECT:** Helix Architecture + Design  
**PHOTOGRAPHER:** Michael Robinson

### Pump Station ..... 35

**LOCATION:** Des Moines, Iowa  
**ARCHITECT:** Substance Architecture  
**PHOTOGRAPHER:** Paul Crosby

### Speculative Office Building ..... 35

**LOCATION:** Leawood, Kansas  
**ARCHITECT:** El Dorado Inc.  
**PHOTOGRAPHER:** Mike Sinclair

### The Marvin Hall Forum ..... 36

**LOCATION:** Lawrence, Kansas  
**ARCHITECT:** Studio 804  
**PHOTOGRAPHER:** James Ewing

### College of Pharmacy ..... 36

**LOCATION:** St. Louis, Missouri  
**ARCHITECT:** CannonDesign  
**PHOTOGRAPHER:** Timothy Hursley

### Heartland Habitat For Humanity Prototype ..... 38

**LOCATION:** Kansas City, Kansas  
**ARCHITECT:** El Dorado Inc.  
**PHOTOGRAPHER:** Mike Sinclair

### Intermodal Facility ..... 38

**LOCATION:** Coralville, Iowa  
**ARCHITECT:** Neumann Monson Architects  
**PHOTOGRAPHER:** Cameron Campbell, AIA, Integrated Studio

### Iowa Prison Industries Outlet ..... 39

**LOCATION:** Des Moines, Iowa  
**ARCHITECT:** ASK Studio  
**PHOTOGRAPHER:** Cameron Campbell, AIA, Integrated Studio

### Liberty United Methodist Church ..... 39

**LOCATION:** Liberty, Missouri  
**ARCHITECT:** Duke Wells Architecture  
**PHOTOGRAPHER:** Architectural Imageworks, LLC

**Marjorie K. Daugherty  
Conservatory** ..... 40

LOCATION: Omaha, Nebraska  
ARCHITECT: HDR Architecture  
PHOTOGRAPHER: Dan Schwalm

**American Enterprise  
Group** ..... 40

LOCATION: Des Moines, Iowa  
ARCHITECT: BNIM  
PHOTOGRAPHER: Nick Merrick  
Hedrich Blessing

**Cultural Center** ..... 41

LOCATION: Greenfield, Iowa  
ARCHITECT: INVISION Architecture  
PHOTOGRAPHER: Cameron  
Campbell, AIA, Integrated Studio

**Market One** ..... 41

LOCATION: Des Moines, Iowa  
ARCHITECT: Neumann Monson  
Architects  
PHOTOGRAPHER: Cameron  
Campbell, AIA, Integrated Studio

**The LUX** ..... 42

LOCATION: Wichita, Kansas  
ARCHITECT: El Dorado Inc.  
PHOTOGRAPHER: Mike Sinclair

**Bucktown House** ..... 42

LOCATION: Chicago, Illinois  
ARCHITECT: Min | Day  
PHOTOGRAPHER: Paul Crosby

**ImageNet Carrollton  
Remodel** ..... 43

LOCATION: Carrollton, Texas  
ARCHITECT: Elliott + Associates  
Architects  
PHOTOGRAPHER: Scott McDonald,  
Gray City Studios

**Academic Center** ..... 43

LOCATION: Kansas City, Missouri  
ARCHITECT: Helix Architecture +  
Design  
PHOTOGRAPHER: Michael Robinson

**Ghost Gallery** ..... 44

LOCATION: Oklahoma City,  
Oklahoma  
ARCHITECT: Elliott + Associates  
Architects  
PHOTOGRAPHER: Scott McDonald,  
Hedrich Blessing

## advertising index

AIA Iowa	6, 48, 49	Pigott, Inc.	44
Charles Saul		PLaN Architecture	BC
Engineering Inc.	31	Produce Iowa	30
Confluence	47	Rapid Reproductions	14
Commercial Aquatic		Rohrbach Associates, P.C.	48
Engineering	14	Shive-Hattery	
Commercial New		Architecture-Engineering	14
Construction Program	29	Stetson Building Products	31
DLR Group	46	Studio Melee	49
Genus	51	Substance Architecture	45
Holmes Murphy & XL Group	32	The Weidt Group	31
HPI Partners	47	Tometich Engineering, Inc.	49
Iowa State Center	11	United Brick and Tile	IFC
Masonry Institute of Iowa	4	Walker Coen Lorentzen	31
Molin Concrete	46	Wells Concrete	48
Neumann Monson Architects	6		
OPN Architects, Inc.	46		

## advertising information

Questions about advertising in *Iowa Architect*? Interested in placing an ad in an upcoming issue? Please contact:

Tonya Vitzthum, [tvitzthum@associationsinc.us](mailto:tvitzthum@associationsinc.us)







**AIA**  
Iowa

Iowa Center for Architecture  
400 Locust Street, Suite 100  
Des Moines, IA 50309

Change Service Requested

# PLAN

## architecture

check us out on facebook or at  
[www.plan-arch.com](http://www.plan-arch.com)

255 5th Street, Downtown Sioux City, Iowa 712.224.3700



a modern furniture store

**mod**  
HOUSE INTERIORS

check us out on facebook or at  
[www.modhouseinteriors.com](http://www.modhouseinteriors.com)

255 5th Street, Downtown Sioux City, Iowa 712.224.2555