

SKYLINES

MIDWEST ARCHITECT / APRIL MAY 1967

AMERICAN INSTITUTE
OF ARCHITECTS

JUN 12 1967

LIBRARY

THE JACKSON COUNTY SPORTS COMPLEX

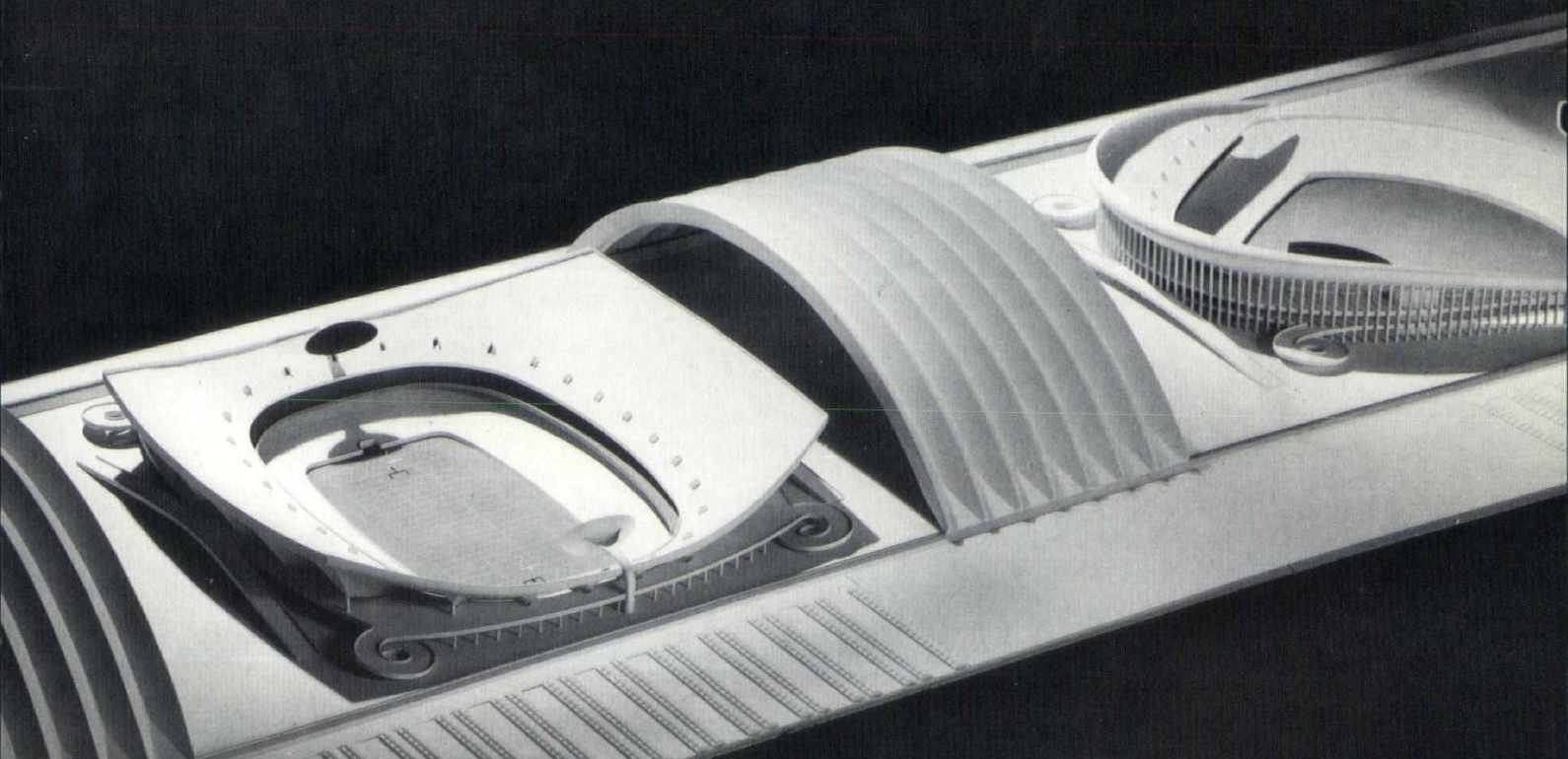

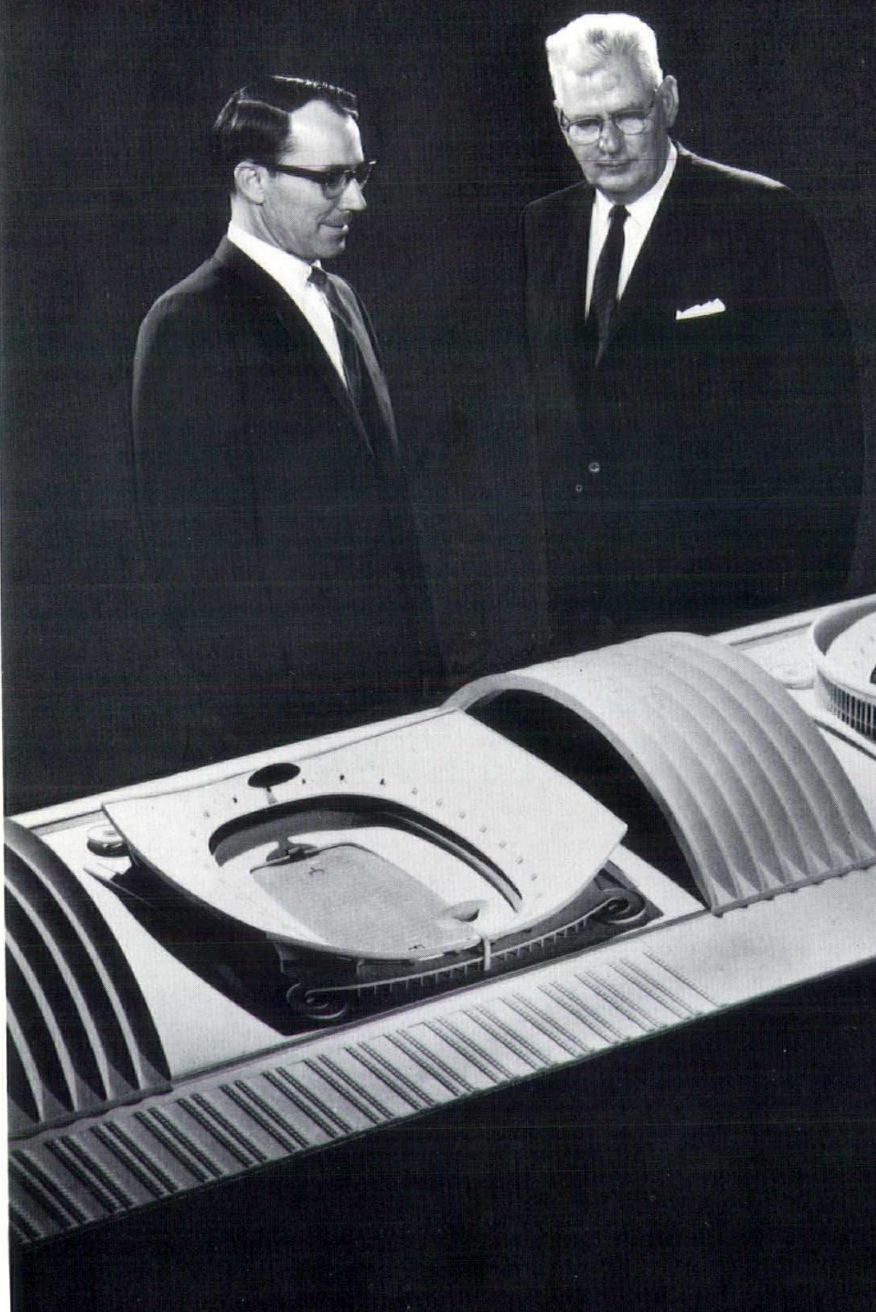

"Kansas City's proposed Sports Complex has won national acclaim for its originality of concept providing a most practical answer in forward-looking community planning. We urge your considered support of this proposal at the polls June 27th."

*Glen O'Brien
David H. LaDue*

Again, Kansas City's renowned Architectural and Engineering Professions have demonstrated to the nation their unique ability to design projects establishing new approaches to long recognized problems. We at Glen O'Brien Movable Partition Company join the community in extending our congratulations.

MOVABLE PARTITIONS ARE
OUR ONLY BUSINESS

YOUR ASSURANCE OF
SPECIALIZED SERVICE

GLEN

**"QUICK-CHANGE"
PARTITIONS**

BRIEN

4905 LISTER
KANSAS CITY, MISSOURI 64130

TELEPHONE
(816) WABASH 3-9705

APRIL MAY 1967 CONTENTS

WHAT'S AHEAD IN 1967:

June July Issue:

TRANSPORTATION IN THE MIDWEST

Elizabeth Brooker, Feature Editor

August September Issue:

A LOOK AT CITY PLANNING

Kenneth G. Wilson, Feature Editor

October November Issue:

HISTORIC PRESERVATIONS

John A. Huffman, Feature Editor

December January Issue:

1968 DIRECTORY

George W. Lund, Feature Editor

THE SPORTS COMPLEX

Bobby L. Tatman, Feature Editor

The Jackson County Sports Complex.....	7
Vicinity map	8
Minutes away (site plan).....	9
No rain checks required.....	10
Roof statistics	11
The football stadium (statistics).....	12
Wolfpack—75,000 strong	13
A family recreation center.....	14
The cost	15
45,000 armchair umpires.....	16
The baseball stadium (statistics).....	17
Come on inside.....	18
A close-up view.....	19
Statement from Jackson County Court.....	20
Statement from Sports Complex Authority.....	20
Notes from the President.....	21
The design team.....	22

**PUBLISHED BY THE
KANSAS CITY CHAPTER
AMERICAN INSTITUTE OF ARCHITECTS**



VOLUME 17 / NUMBER 3 / APRIL MAY 1967

EXECUTIVE OFFICERS:

J. David Miller, President
William M. Conrad, Vice President
Joseph J. Oshiver, Secretary
Joseph B. Shaughnessy, Jr., Treasurer

EDITORIAL BOARD:

George W. Lund, Chairman
Jack L. Bloom
Elizabeth Brooker
Bobby L. Tatman
Kenneth G. Wilson
John A. Huffman
Billy Dean Wunsch
Richard E. Gyllenborg, Advertising

EXECUTIVE OFFICE STAFF:

John Lee Smith, Executive Secretary
Barbara Vaught, Assistant Executive Secretary

DIRECTORS:

Herbert E. Duncan, Jr., Ex Officio
Clarence F. Watson, 1967-1970
C. James Balderson, 1966-1969
Roger F. Blessing, Jr., 1967-1968

SKYLINES is the official publication of, and is published bi-monthly by the Kansas City Chapter of the American Institute of Architects at 800 West 47th Street, Kansas City, Missouri 64112. Telephone (816) Plaza 3-8567. Subscriptions for A.I.A. members are included with A.I.A. memberships. Subscriptions for non-members, \$3.00 per year; \$8.00 for three years. Single copies 50c, special roster directory issue \$1.50.

Opinions expressed herein are those of the editor or contributors and the appearance of products or services, names or pictures in either advertising or editorial copy does not necessarily constitute endorsement of the product by the Kansas City Chapter of the American Institute of Architects. Advertising in SKYLINES is subject to the approval of the Executive Committee. Copyright 1967, Kansas City Chapter of the American Institute of Architects.

Keep Kansas City moving forward!

vote
yes
June 27



MODERN CENTER INC.

4149 Pennsylvania
Kansas City, Missouri
Telephone WE 1-9429

Gill Miller
Charles F. White
Ed Frantz
James Rightmire
John B. Miller
Margaret M. Brown



AIA ALWAYS INSTANTLY AVAILABLE

Whenever you need anything in paints or colors, call Hal Surface, Jr. or Chuck Stuart. They're always ready to help. SHELTER TONES by MARTIN SENOUR represent the ultimate in color efficiency and product performance in a range of pastels never before available in exterior finishes. See the new collection of 250 "most durable colors under the sun" in MARTIN SENOUR Gloss House Paint, Acrylic Latex and Exterior Flat Oil.

MARTIN
SENOUR
PAINTS

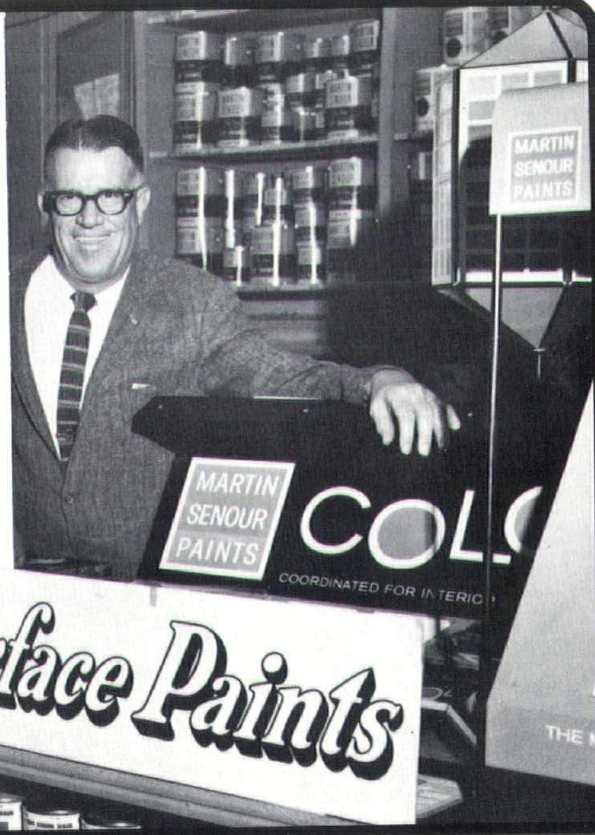

Surface Paints

Surface Paints

- DOWNTOWN: 1737 Oak Street / Harrison 1-0455
- MEADOW LAKE: 7712 State Line / Andrew 9-4222
- OVERLAND PARK: 7217 W. 80th Street / Dupont 1-4910
- INDEPENDENCE: 11716 E. 23rd Street / Clifton 4-4911

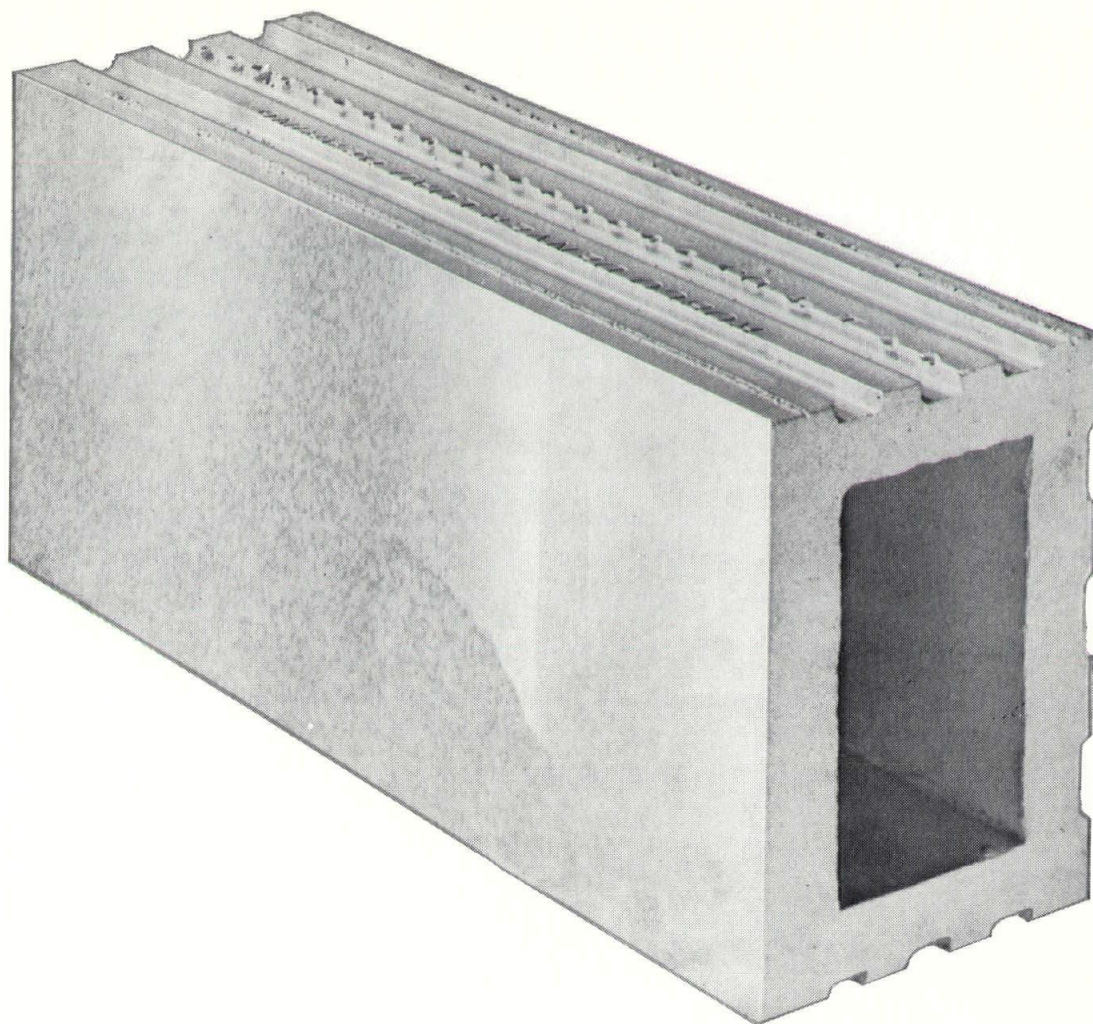

Robco, Elgin-Butler and Metropolitan glazed tile surpasses ASTM and FTI dimensional tolerances.

Representing three manufacturers allows us to offer you a wide selection of colors and the newest of trim shades. Careful attention to delivery schedules that help prevent costly jobsite delays as well as eliminate unnecessary jobsite storage and possible damage, is another part of Carter-Waters' complete tile service. Samples, literature, technical data, specification information, lump sum quotations, shop drawings and jobsite assistance . . . all await your call.

diversified materials service

CONSTRUCTION THE MATERIALS
CARTER-WATERS
KANSAS CITY CORP. MO. 64108
 2440 Penway GRand 1-2570



CITY BLOCK pre-shrunk masonry units were specified in the Broadway Motors Service Center, Kansas City, Missouri.
 Architect: Curtis Associates; General Contractor: Bishop Construction Co.; Masonry Contractor: Alpha Masonry.

CITY BLOCK'S PRE-SHRUNK MASONRY UNITS ELIMINATE "AFTER BUILDING" SHRINKAGE!

High pressure steam cured for eight hours, CITY BLOCK'S pre-shrunk masonry units have a maximum moisture content of 30% with maximum linear shrinkage .030. These are specifications you can count on... and the blocks can be delivered in one day's time! CITY BLOCK'S remarkable new 80 foot long dual high pressure steam curing vessels cure blocks at a temperature of 360° F under pressure of 150 lbs. P. S. I. for consistent product uniformity and building reliability.

For more information contact
**CITY BLOCK
 AND PRODUCTS
 COMPANY**
 1212 West 24 Highway
 Independence
 Missouri 64050
 Telephone (816) Clifton 2-8760

**CITY
 BLOCK
 AND
 PRODUCTS
 COMPANY**

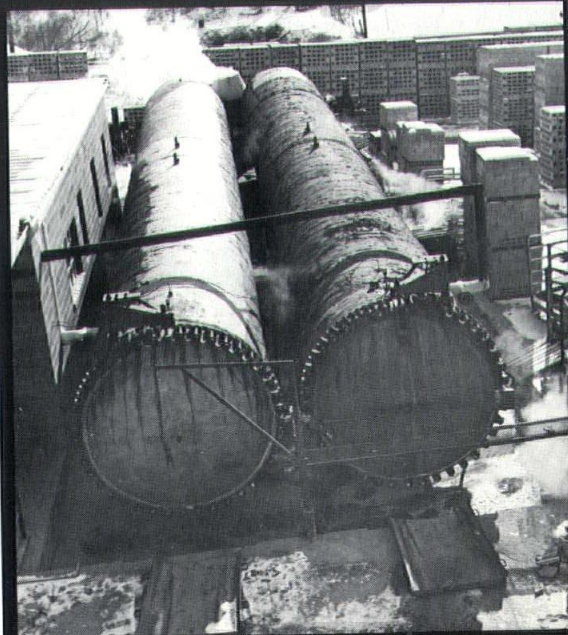



George W. Lund
Chairman
SKYLINES Editorial Board

AN EDITORIAL COMMENT:

**THE
JACKSON
COUNTY
SPORTS
COMPLEX**

This month SKYLINES is departing from its normal pattern to devote the entire issue to one architectural project. The following pages explain in detail the proposed Jackson County Sports Complex.

The citizens of this area have directed their efforts toward a sports facility for many years starting back in 1931. Our present Municipal Stadium was constructed in 1923, and it was extensively remodeled when the Kansas City Athletics moved here. Again some modifications took place when the Kansas City Chiefs came to town. This stadium is presently inadequate for professional football or baseball. It is, as you know, the smallest ball park in the major leagues with a fixed seating capacity of only 32,560.

During the past few years several studies were made for the Jackson County Court and a number of sites were evaluated. The creation of the Sports Complex Authority in 1965 gave direction to a definite plan of action. The Authority selected a site and established the revolutionary twin stadia concept. This was suggested because of the incompatibility of the seating arrangement and playing field for the two major sporting events; and it is generally recognized as the best solution.

Each section of the country has its own climatic problems. For instance, an "Astro-Dome" was necessary for Houston. The proposed stadium design for our Community offers a maximum of comfort and utilization without undue cost.

George W. Lund

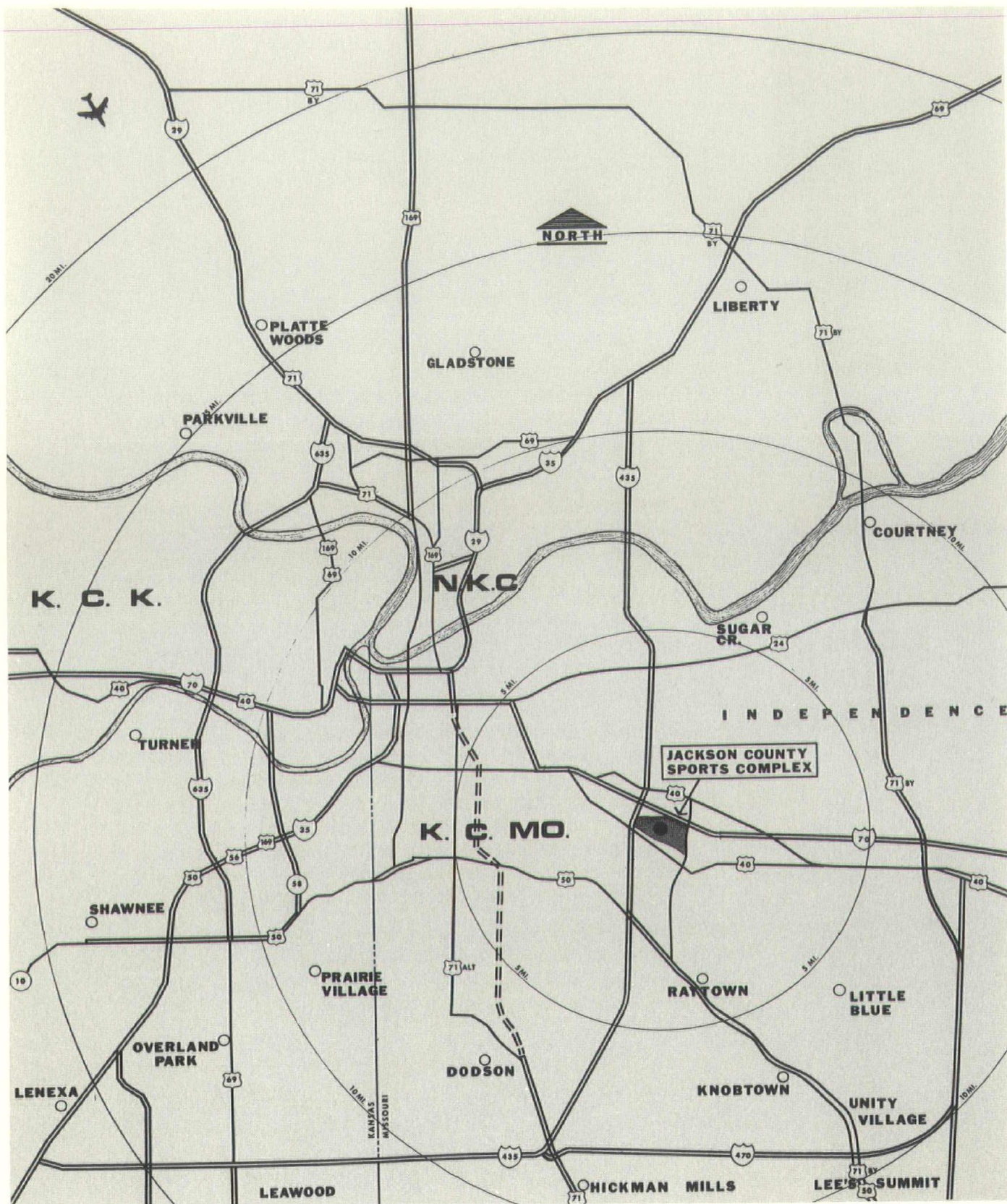

MINUTES AWAY

The 370 acre site is located at the intersection of I-70 and I-435 in Central Jackson County.

That this area is conveniently located in relation to all portions of the Community may be readily seen from the map on the facing page. Freeways will provide rapid means of access to the site. The time required to travel from the Central Business District, for example, is less than 10 minutes; from the most remote locations, a maximum of 20 to 30 minutes.

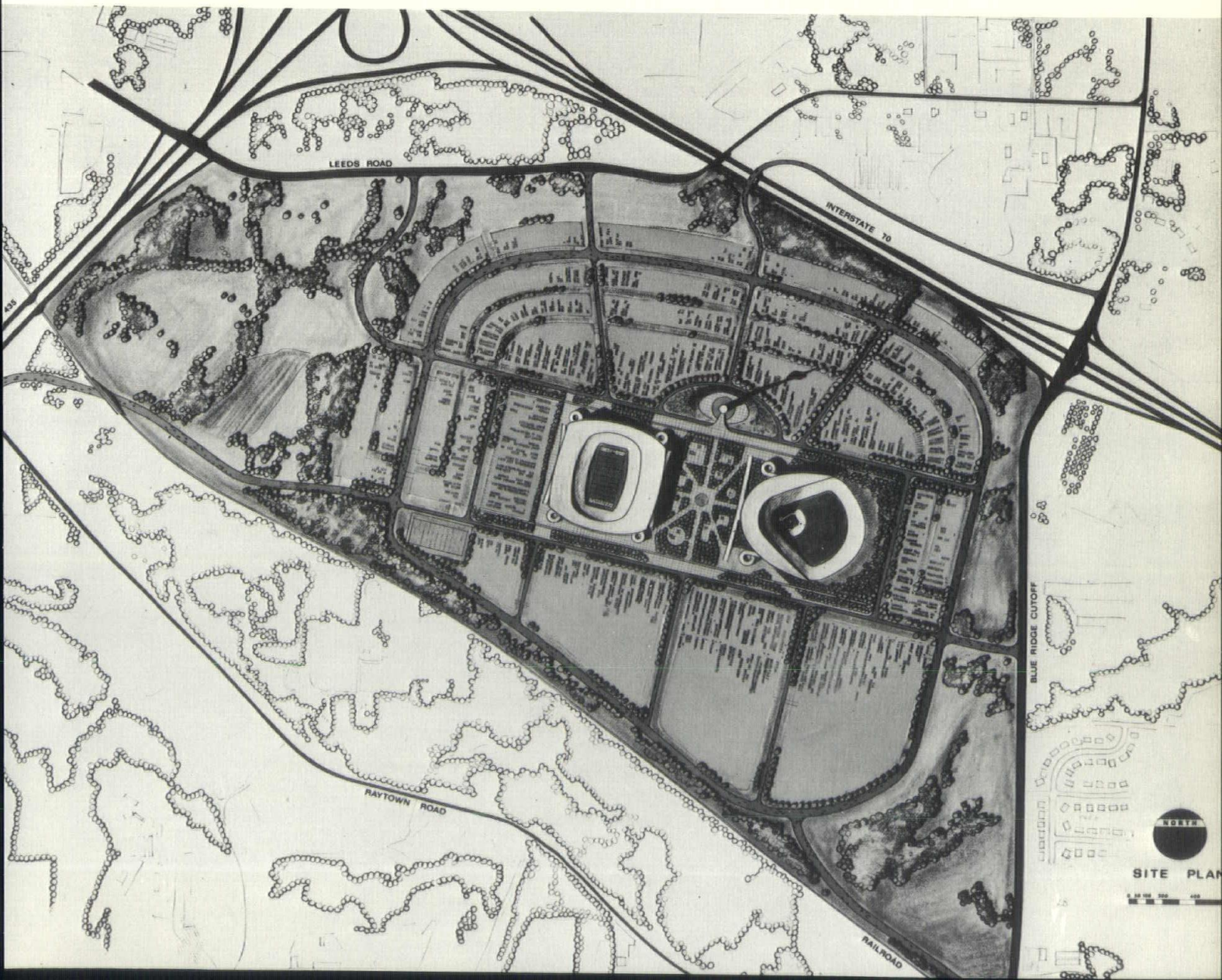

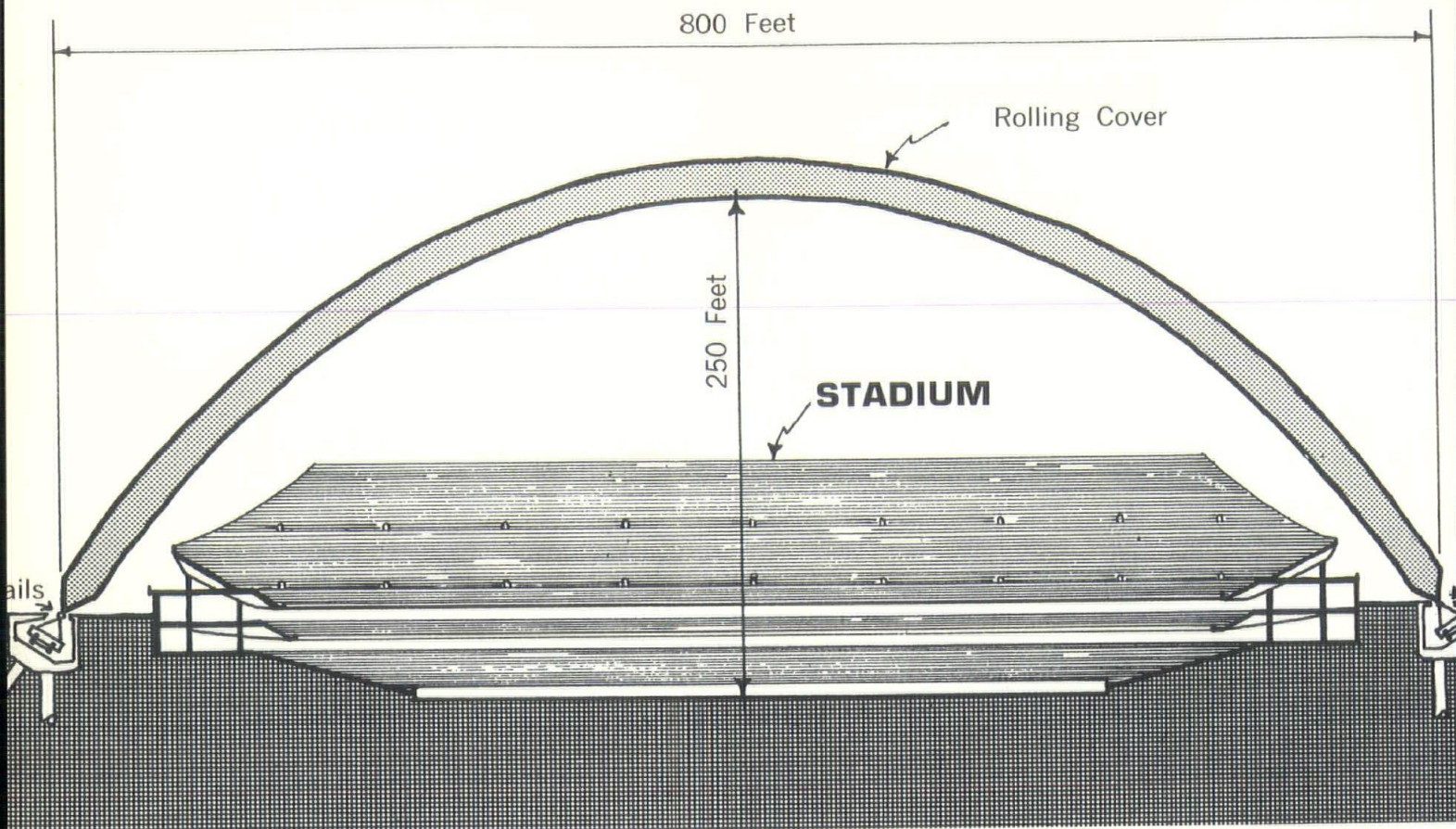

SECTION-ROLLING STADIUM COVER

NO RAIN CHECKS REQUIRED

It is the day of a major event at the Jackson County Sports Complex — the weather is "changeable", and it appears precipitation will occur. Is the event cancelled, or will the attendance be affected? With the proposed stadium it is "business as usual" for the adverse affect of the elements will be controlled by a unique and exciting moving roof which will assure patrons of constant viewing conditions. The roof, when closed, will cover nearly 14 acres of ground area, more than sufficient to shelter each stadium including all spectator seating and the playing field. Thus the "rain-out" will now be a memory of the past as well as the fear of snow-filled football stadiums for late season games.

The concept drawings call for the cover to be constructed in two sections traveling the entire length of the complex — some one-half mile. With this flexibility of movement, the units will provide a covering for the Exhibition Plaza, yet be in position to afford immediate protection for both spectators and the players on the field.

Shadow areas will now be controllable through programmed cover movement. The thrill of being in the stands while the covers move will be unlike any experience known to fans the world over.

ROOF STATISTICS

Construction: Steel and fiberglass

Span: 800 feet

Width: 750 feet (total both sections)

Length of tracks: 2,500 feet

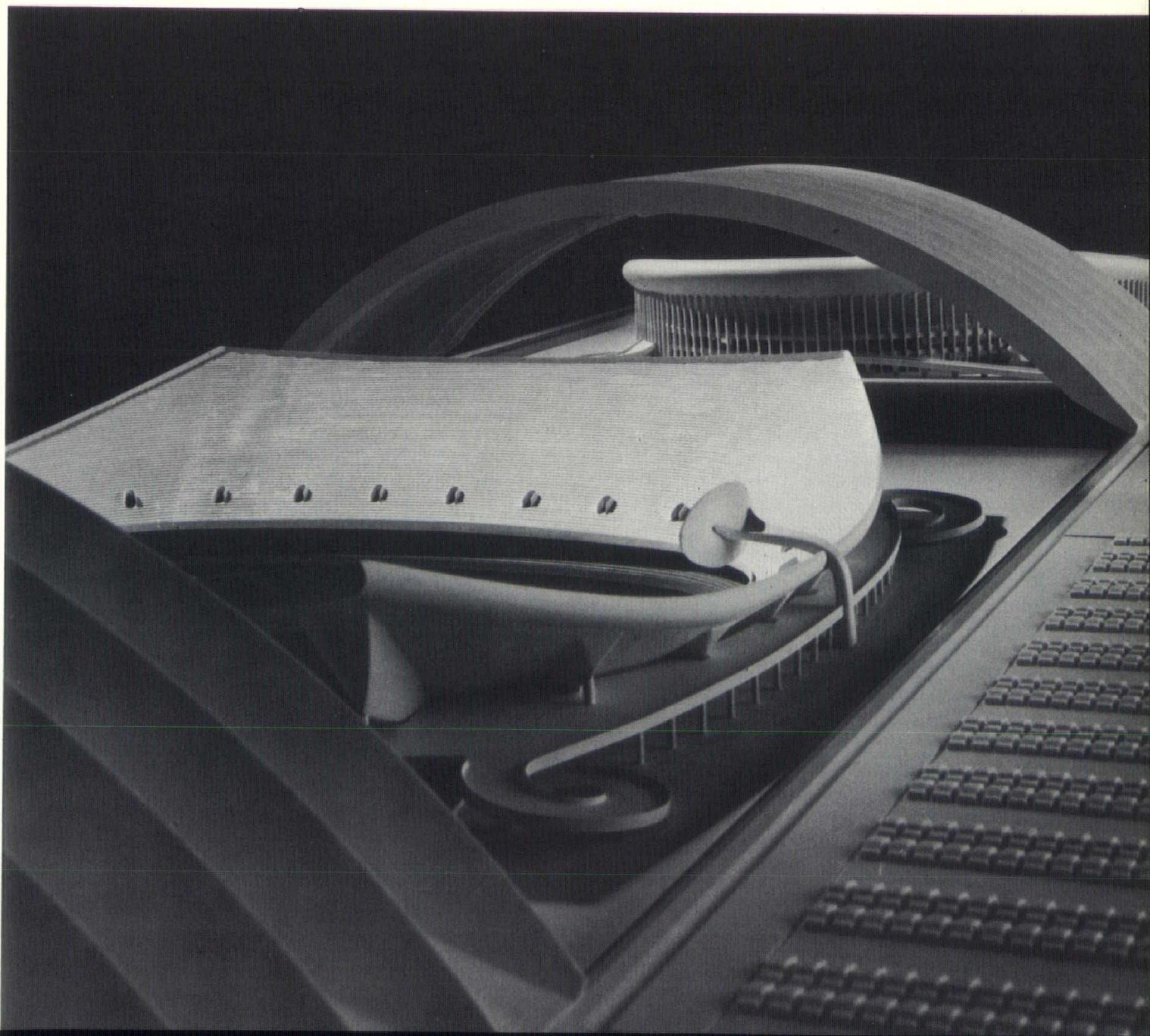

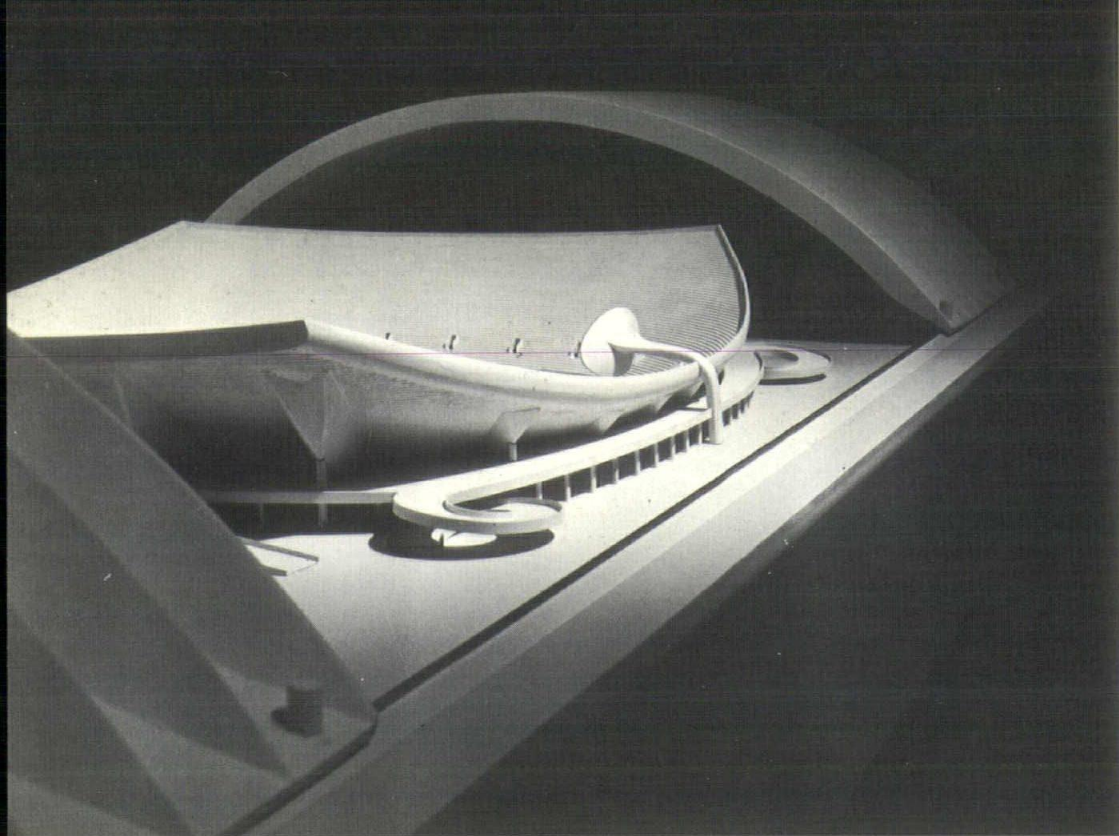

THE FOOTBALL STADIUM

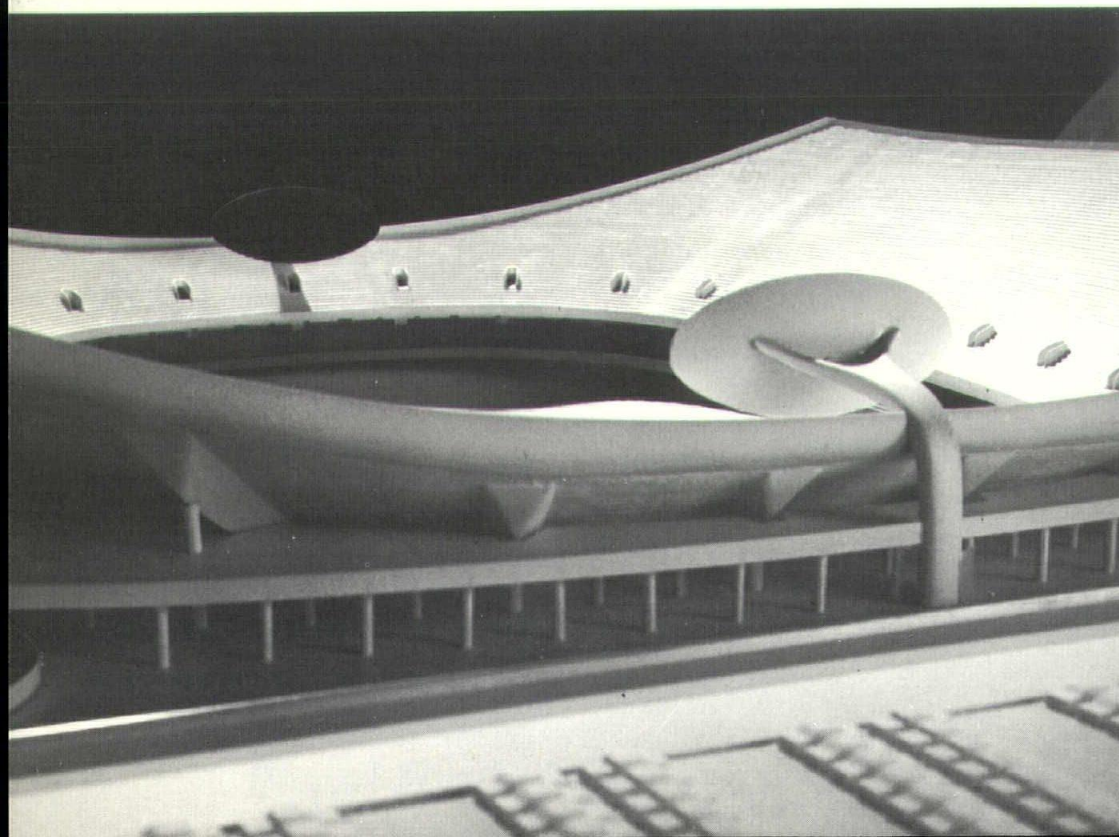
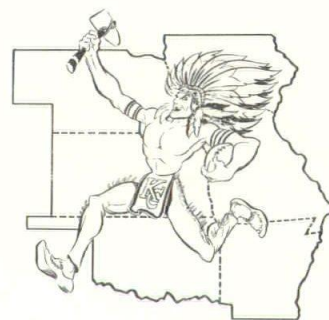

STATISTICS

Number of seats:

75,000 in three levels

☐ Field level—27,600 seats

☐ Intermediate level—
5,900 seats

☐ Upper level—41,500 seats

Overall length: 700 feet

Overall width: 680 feet

Height of stands
above grade: 90 feet

Depth of field
below grade: 50 feet

Construction:
Reinforced concrete

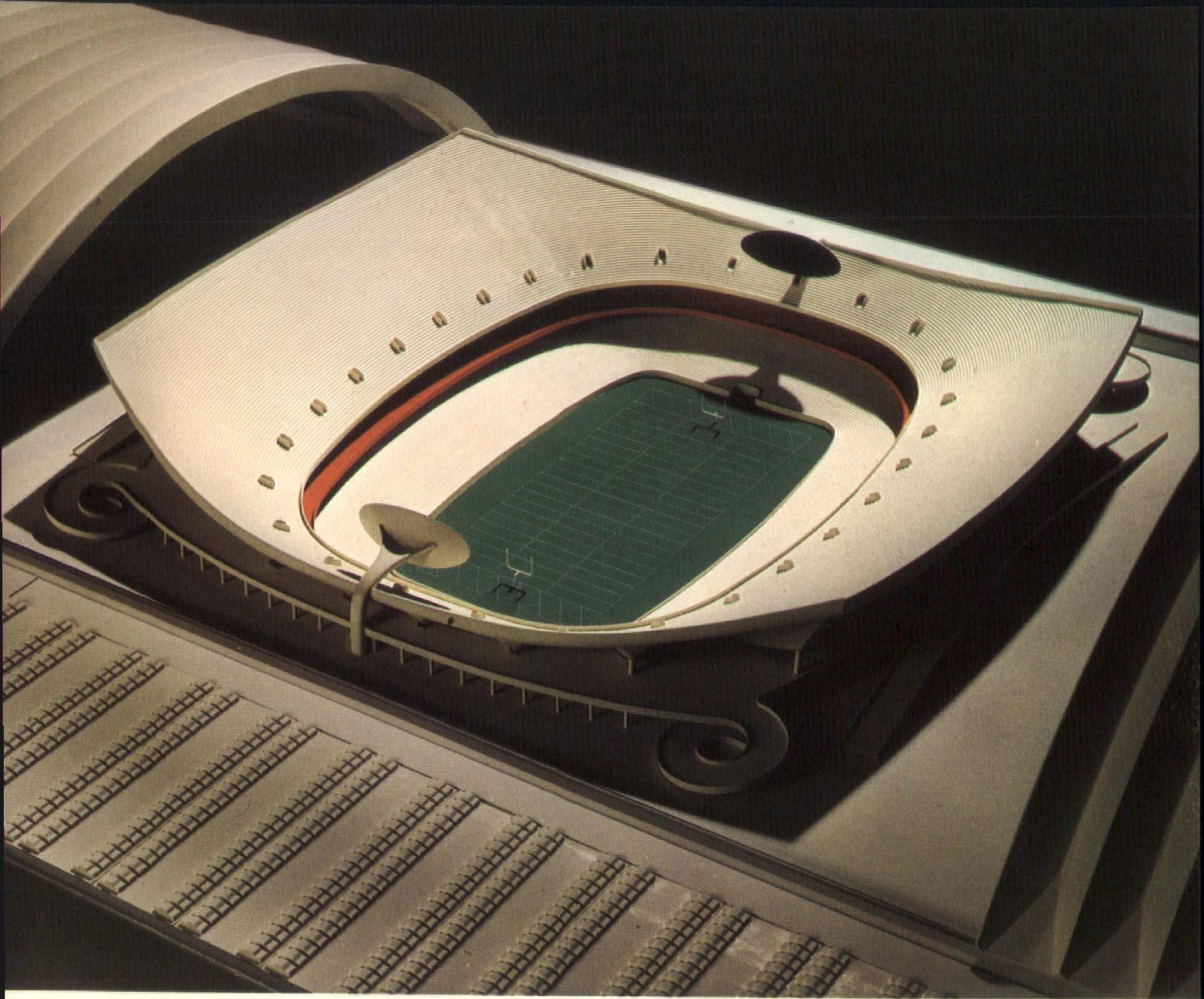

WOLFPACK — 75,000 STRONG

In addition to being visually pleasing, the football stadium brings the ultimate in convenience and comfort to the spectators. Gently sloping ramps will be available to reach the upper level. The seats are close to the action. The most distant seat is but 300 feet from the playing field.

On the entrance concourse level administrative offices, press facilities and preferred seating will be located. Home and visiting team lockers, general storage areas, and mechanical equipment will be located on the lowest level. A system of tunnels for players and emergency vehicles leads from the service level to the playing field and to the access road adjacent to the stadium. Concession and toilet areas are located on each level.

Although designed to primarily serve football, the stadium can easily become a facility for the rapidly expanding sport of soccer.



A FAMILY RECREATION CENTER

Conveniently placed between the two stadia is a delightful nine acre landscaped Exhibition Plaza which will serve as a major entryway to each stadium and covered space for shows or exhibitions. Close-in parking serves 18,000 cars and 200 buses.

Studies are being made for other use potentials of the remaining 160 acres of open land. The possibility exists here for auxiliary sports, nature centers, parks and other recreational uses. It is felt that twin structures will form the nucleus of the most comprehensive family recreational center in the nation.



THE COST

A total of \$9,567,000 will be required for site acquisition and off and on site work.

Construction of the football stadium would require \$13,115,000 and the baseball stadium is budgeted at \$10,888,000.

The complete movable roof would require \$7,000,000 including the two parallel tracks.

These costs together with compensation for professional services would bring the total cost of the sports complex to \$43,000,000.

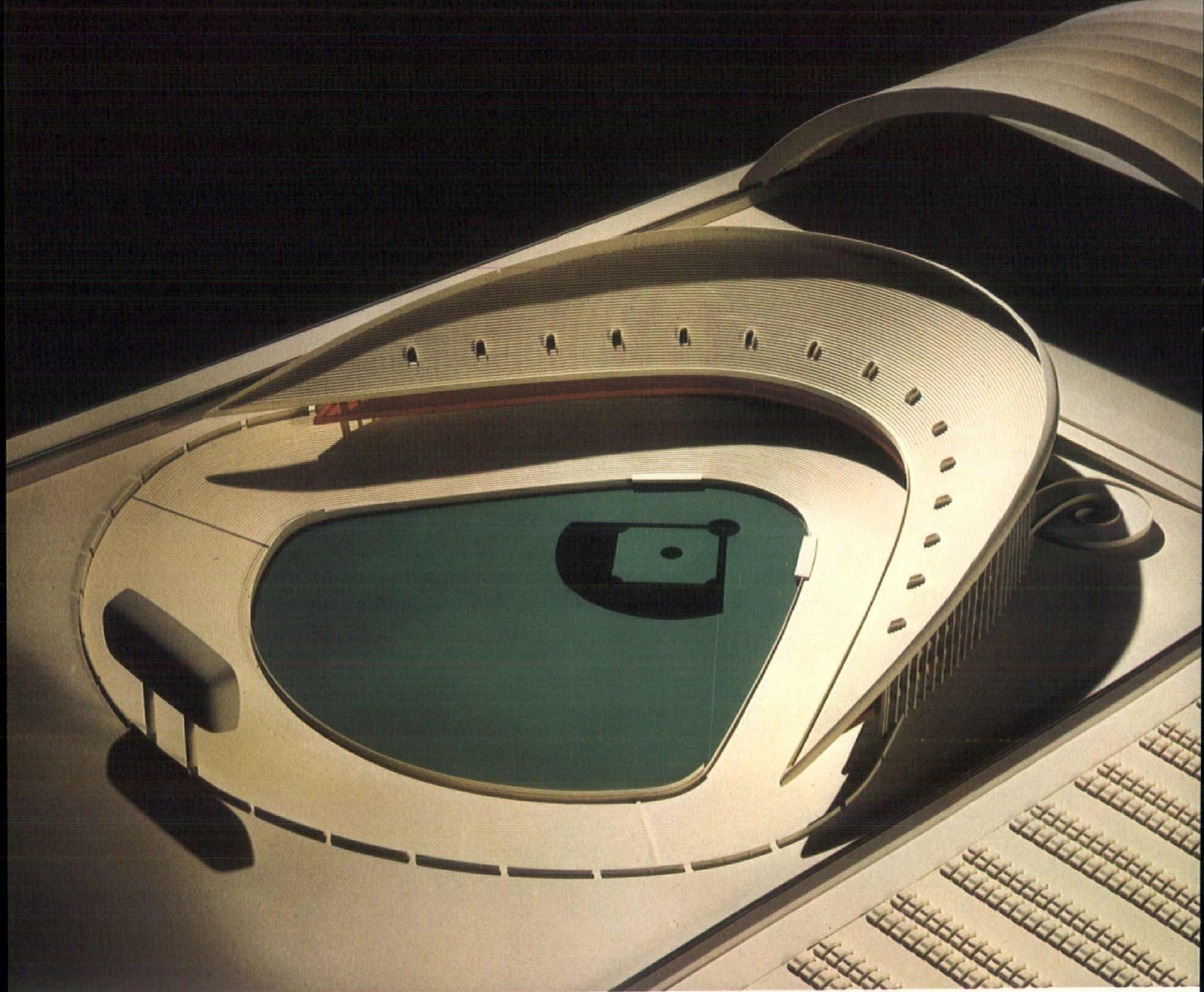

45,000 ARMCHAIR "UMPIRES"

The baseball stadium is designed in a crescent shape that virtually wraps itself around the primary playing field. In doing so, nearly all the seating is between first and third base. This not only allows the maximum of choice seating but provides an intimate relationship between the fan and playing field.

Plans call for the stadium to seat 45,000 spectators without outfield seats. Capacity may be increased to 57,500 with bleacher seating in this area. Located in the center field area is a large scoreboard which allows easy viewing for all fans. The actual playing field will be depressed 33 feet below grade utilizing the natural valleys of the site. Located on the intermediate (entrance) level along with administration areas and preferred seating will be two-story press box quarters. These press facilities will include space for representatives of newspapers, magazines, radio and television. Auxiliary facilities such as concessions, business offices, equipment storage and mechanical equipment have been incorporated within the various levels.

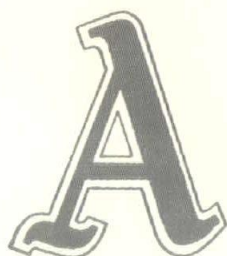
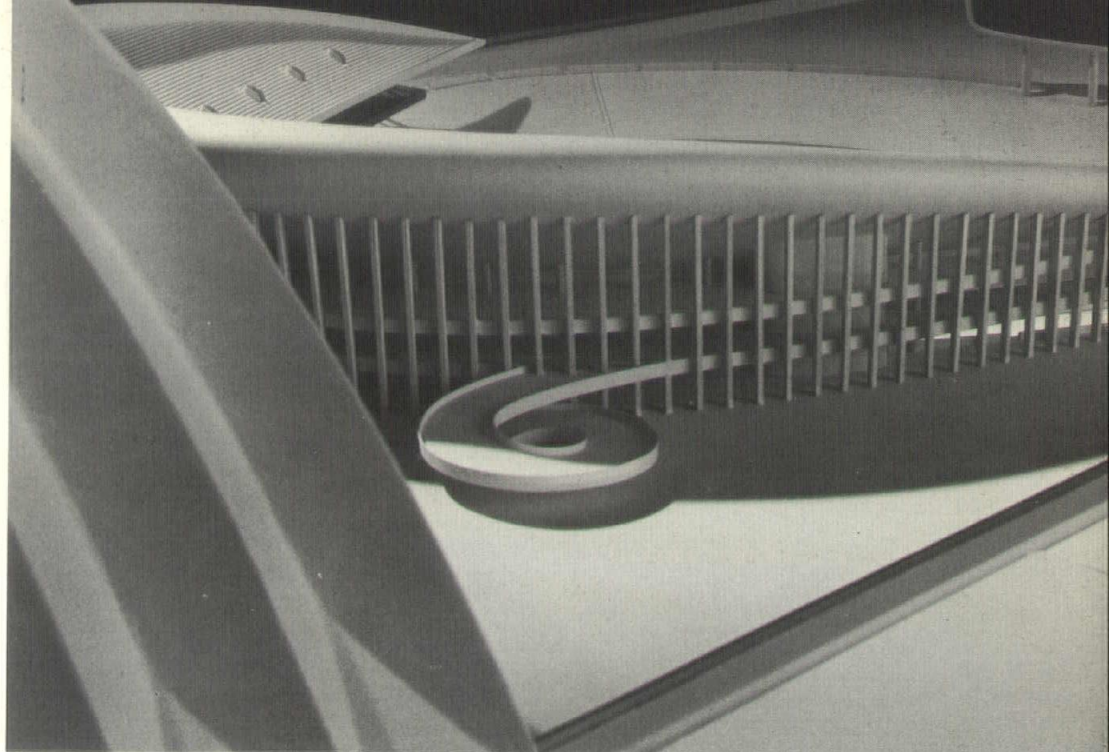

THE BASEBALL STADIUM

STATISTICS

Number of seats: 45,000 in three levels

- ☐ Field level—22,700 seats
- ☐ Intermediate level—3,700 seats
- ☐ Upper level—18,600 seats

Overall width: 675 feet

Length through stands to center field fence: 665 feet

Field layout:

- ☐ Left field—330 feet
- ☐ Left center—380 feet
- ☐ Center field—410 feet
- ☐ Right center—380 feet
- ☐ Right field—330 feet
- ☐ Plate to stands—60 feet

Height of stands above grade: 104 feet

Depth of field below grade: 33 feet

Construction:
Reinforced concrete

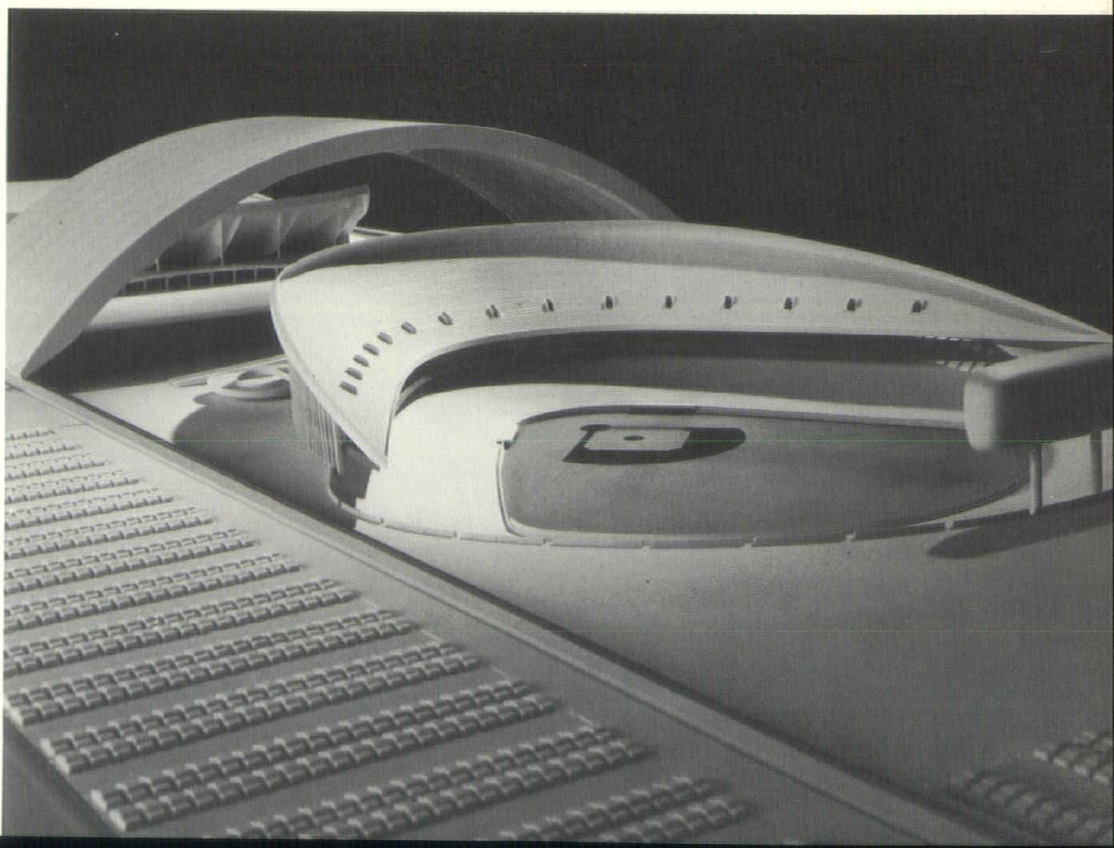

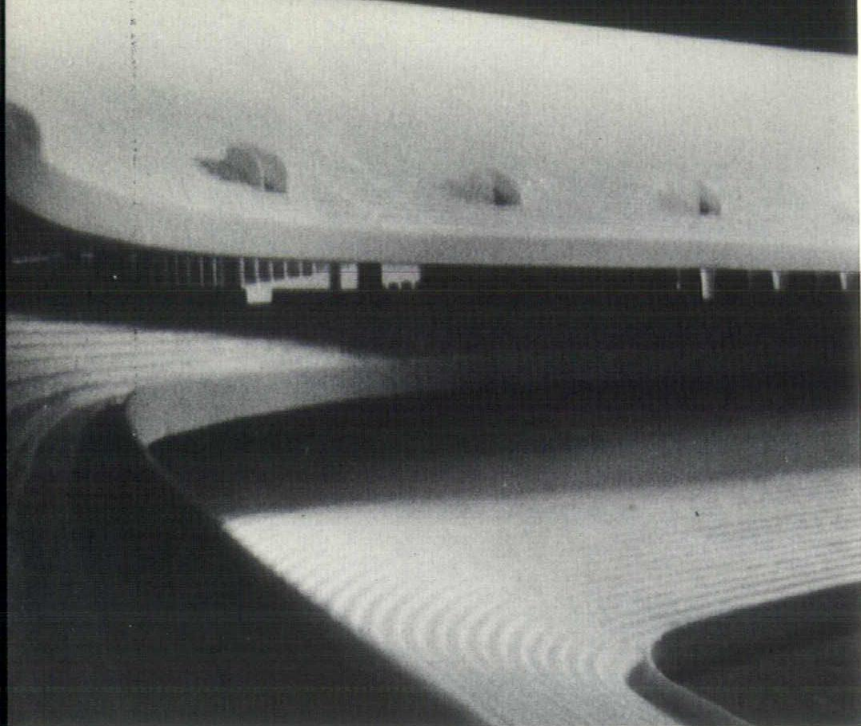

COME ON INSIDE

These microscopic views from inside the model (taken with a tiny periscope camera lens) virtually put you in your seat. You can imagine the electric sound of the crowd seated around the graceful curve. Imagine the peddlers yelling "peanuts", "popcorn", "hot dogs" . . . the cheers and groans.

Your view would never be blocked (except possibly during the excitement of touchdowns and home runs) because all aisles are to run up and down—never horizontally in front of seats.

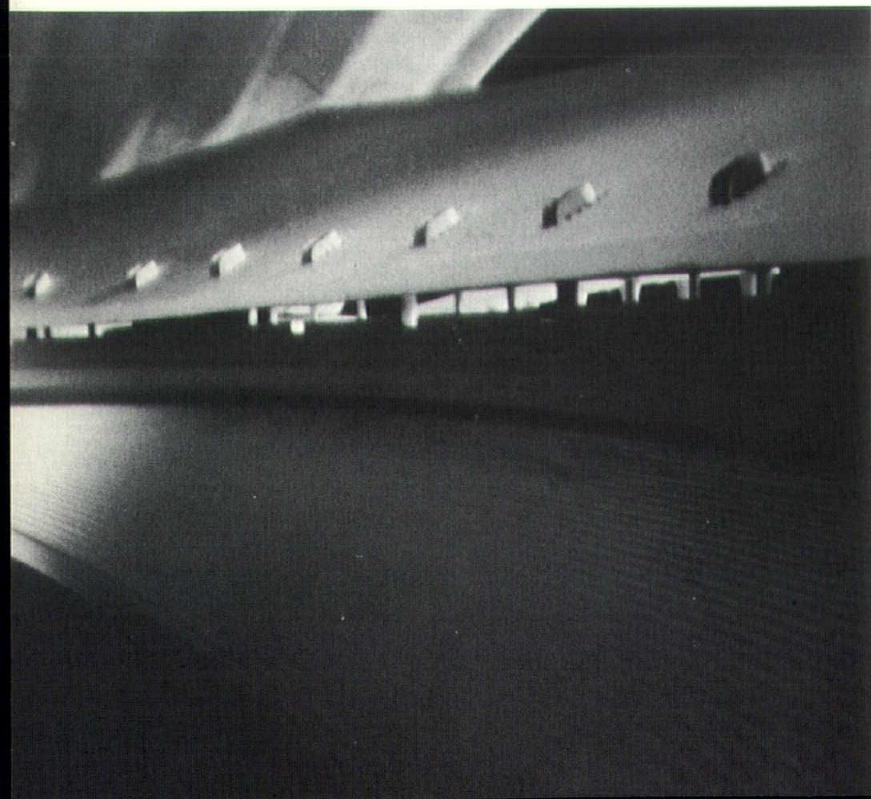

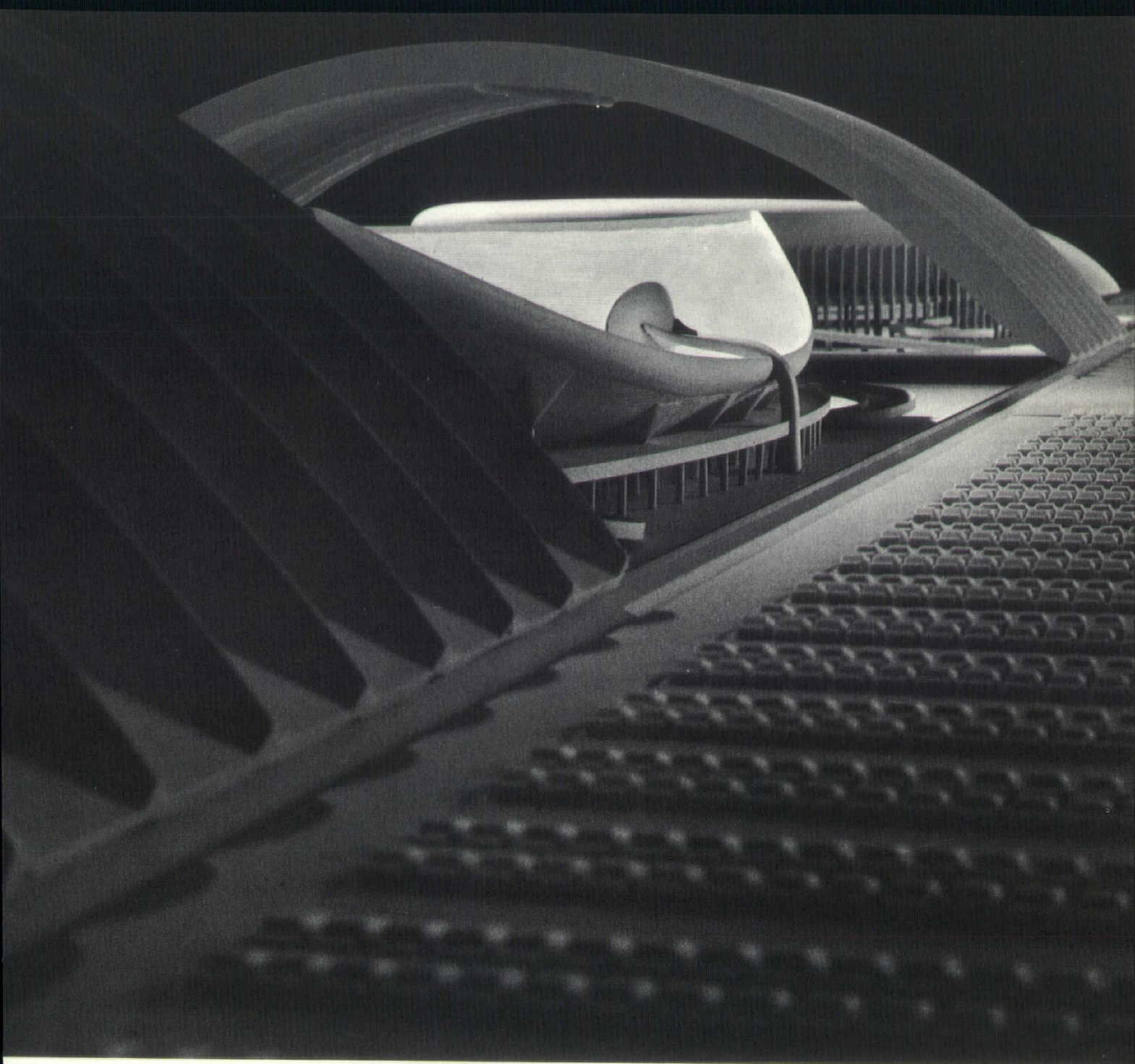

A CLOSEUP VIEW

Imagine the excitement of a Super Bowl or a World Series in this setting. The sports event here is much more than mere recreation.

The broad stadium approaches are scaled for easy identification of entrance gates, for uncrowded movement from car to seat. Entrance to the lower seating (sunken into the ground) is straight in from the Plaza level. Gently graded ramps lead to the upper stands. Picture the sweeping undersides of the upper stands against the night sky, or glittering white in the sunlight. The mammoth roof sections are poised overhead, ready to be moved into place if needed during a quick shower. If the kids get restless during a double-header, Mom and the kids can go out onto the spacious Plaza, while Dad watches the rest of the game.

What type of facility could muster more civic pride?

STATEMENT FROM THE JACKSON COUNTY COURT

We believe that the new stadium will be a positive symbol of the growth and prosperity of Jackson County and the ability of its citizens to plan for the future.

Those of us concerned with the human needs of the county are delighted to have the enthusiastic support of sports fans in this community. For sports fans are positive thinkers. We need the same boundless enthusiasm to get this bond program passed that sports fans have so generously given to the Athletics and Chiefs.

The stadium proposition is designed to make Jackson County a great place to visit. But it plus the other six propositions are designed to make Jackson County a great place to live.

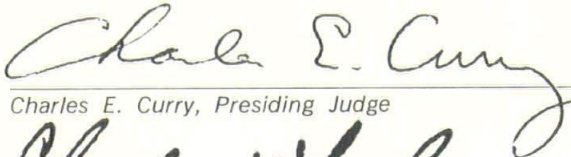

Charles E. Curry, Presiding Judge

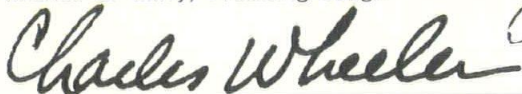

Charles B. Wheeler, Jr., M.D., Western Judge

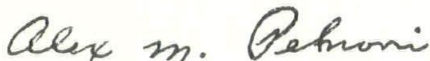

Alex M. Petrovic, Eastern Judge

STATEMENT FROM THE JACKSON COUNTY SPORTS AUTHORITY

The Jackson County Sports Complex Authority was appointed by Governor Warren E. Hearnes of Missouri early last year, and charged with the design, creation, construction and operation of a sports and entertainment complex in Jackson County.

Early in our deliberations, it became apparent that the great \$43,000,000 proposal for football and baseball facilities for our major league franchises would require the counsel, advice and services of qualified architects and engineers, from the beginning.

The many architectural firms who submitted proposals, either individually, or as joint ventures performed an invaluable service, not only to the Authority but to all Jackson Countians. The Authority was especially pleased to learn, after conferring with architectural firms throughout the nation, that the entire project could be most effectively and completely handled by architects and engineers from our own area.

We are eagerly anticipating voter approval on June 27th, and are sure that the dual stadium facilities, the finest anywhere in the world, will stand both as a tribute to the citizens who place their faith in a bond issue of this magnitude and to the professions such as yours, which had a part in its completion.



Dutton Brookfield, Chairman

William E. Clarkson, Vice Chairman

Bishop G. Leslie DeLapp, Treasurer

Harry E. Moreland, Secretary

Karl Rogers

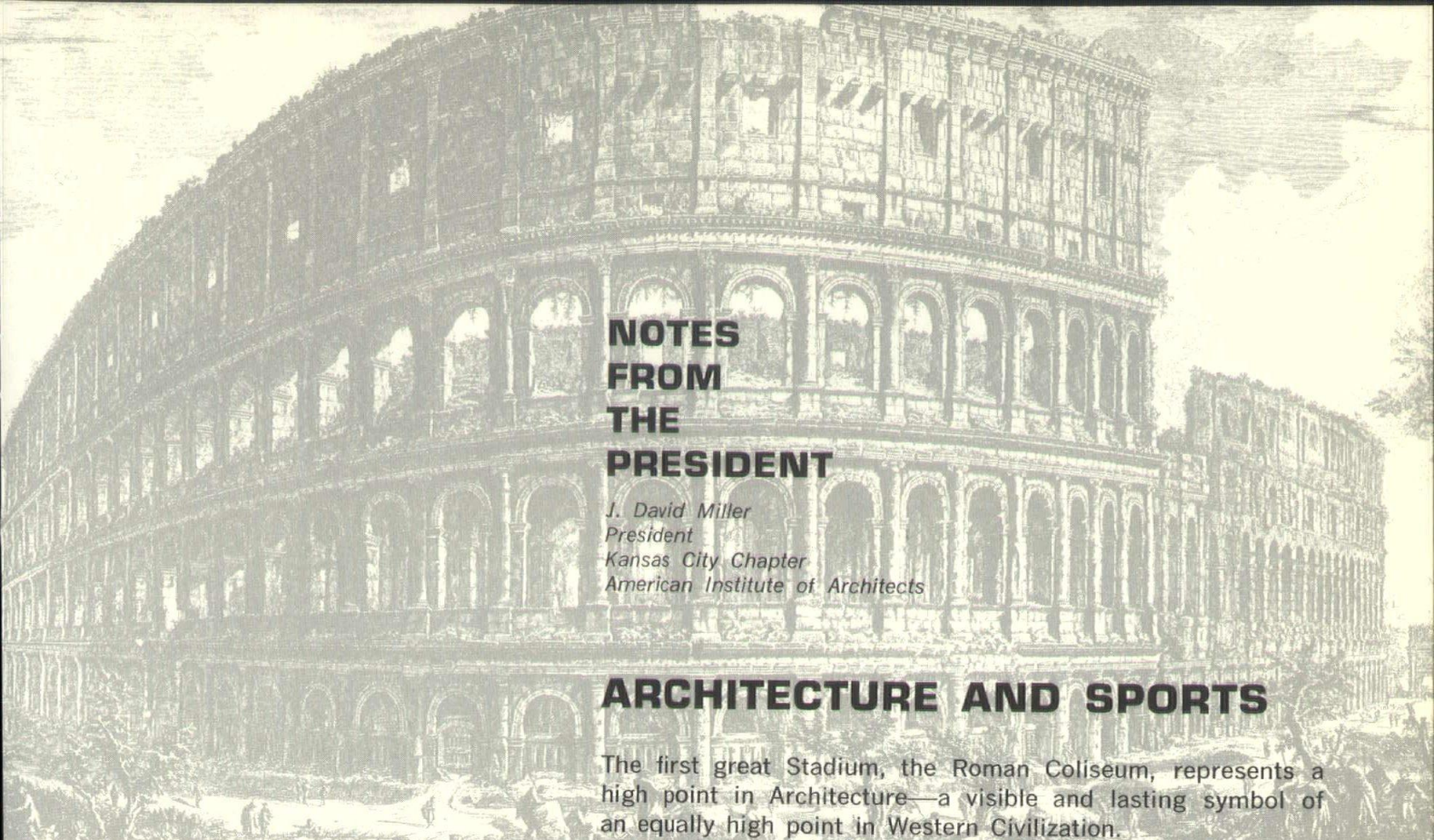

NOTES FROM THE PRESIDENT

*J. David Miller
President
Kansas City Chapter
American Institute of Architects*

ARCHITECTURE AND SPORTS

The first great Stadium, the Roman Coliseum, represents a high point in Architecture—a visible and lasting symbol of an equally high point in Western Civilization.

Each age has its own expression in the shape and performance of its structures. What could be more appropriate for Jackson County 1967—during a period of vital growth—than a Sports Complex born of imagination and vision for the 21st Century?

The nearly 300 members of the Kansas City Chapter of the American Institute of Architects are proud to endorse this project. The Chapter urged the use of an Architect-oriented design to fuse importance and thoughtfulness into the concept. After all, a stadium is designed for people to use, and the Architect spends his entire lifetime designing facilities for people. Therefore, he is the logical Prime Professional, equipped by training, to develop the initial concept; further to lead and coordinate the engineering, site development, traffic, acoustical, graphic and other professionals who contribute to the end result. The fact that Architects are serving our Community is evidenced by the amount of work currently in progress—half a billion dollars.

The design Architects for the Sports Complex were selected from a total of eight local firms who were interviewed. Our Chapter appreciates and publicly commends the professional manner in which the Court and the Authority conducted their search.

We believe this project will serve as a guide for other stadium projects in the years to come. We believe the Community can look with pride on this unique proposal, since, in a sense, it is a measure of its potential.

Your positive vote will make it a reality.



Dave Miller

THE DESIGN TEAM

Kivett and Myers—Project Architects

William Love—Vice-President in Charge

Charles Deaton—Design Associate

Bob D. Campbell & Co.—Structural Engineers

Kinney, Holloway & Perkins—

Mechanical-Electrical Engineers

Woodward-Clyde-Sherard & Associates—

Soils Engineers

Wilbur Smith & Associates—Traffic Engineers

What's so durable?

Sand-rubbed Carthage marble, protecting the exterior of the new Lincoln Building in Spokane, Washington, designed by Whitehouse, Price and DeNeff. Set with a solid grout fill between marble and metal lath, this light, pearl grey marble veneer looks good now, will remain in fine condition for generations to come!

Sand-rubbed Carthage marble is only one of three distinct exterior finishes for this famous and dependable American marble. If you haven't seen the new sand-blasted and sawed finishes with their rough surface textures, we'll be glad to show them to you.

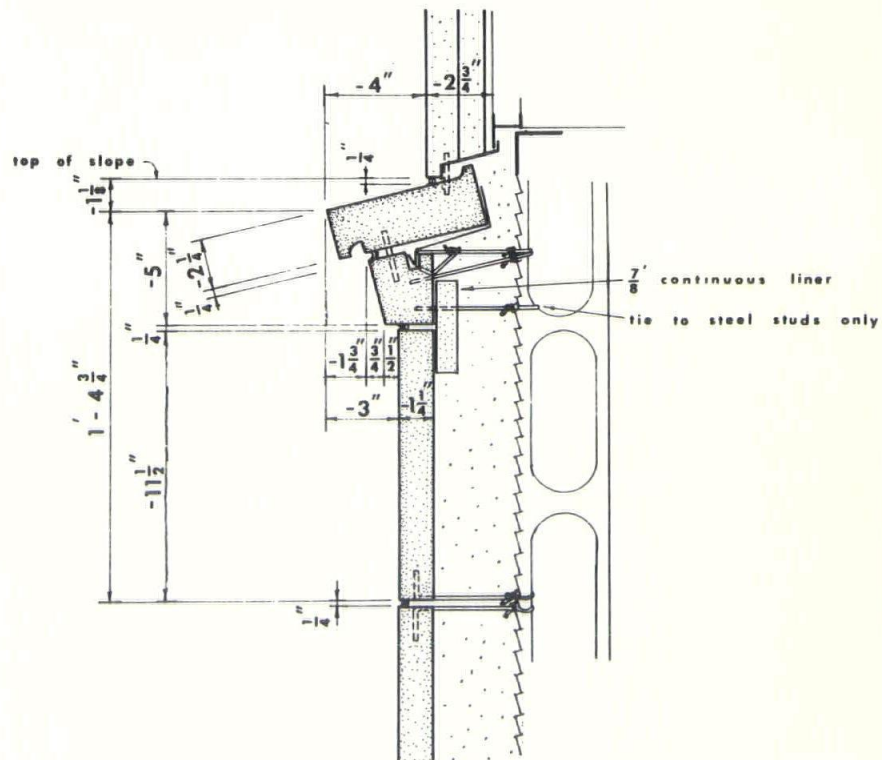

SILL SECTION



CARTHAGE
P. O. BOX 718 / CARTHAGE, MO.

MARBLE CORPORATION
3030 WYOMING / KANSAS CITY, MO.



Are you wasting the **WARMTH** of your lights?

Where there's light, there's warmth.

In their new all-electric office building in North Kansas City, General Electric is proving that it is practical, to use the warmth generated by lights to heat the building. This is called Electrical Space Conditioning.

Warm air from lamps is taken off and recirculated. G. E. reports that the new office building can be comfortably heated by heat of light with outside temperatures down to 20 degrees above zero.

When the temperature gets below 20, an auxiliary electric heating system is automatically switched on.

In other words, you get more value from every watt of electric power you use, because every watt works harder. If you are building new facilities or revising old ones, it will be well worth your while to find out more about Electrical Space Conditioning. Contact a KCPL representative at GR 1-0060. There's no obligation.



Infrared People Heating Lamps are used by General Electric to keep personnel warm, and melt ice and snow in this loading area. Infrared heat is widely used in drive-in banks, store marquees, grandstands, hotel entrances and in front of store display windows—anywhere that customer comfort is important.



Certain Kansas City architects appreciate good service and sound advice.



That's why we're here.

For the past 30 years we've provided sound technical advice and good service for a great many St. Louis architects and for a few Kansas City architects.

Now we're trying to change that situation. We've opened a permanent office here, and we've set out to make our mark in Kansas City. How will we do it? By our same steady methods.

We'll continue to concentrate on giving good service to all our customers. We want and need your business, and we'll always keep that in mind.

So we hope you'll always keep us in mind. If you appreciate good service and sound advice please give us a call. That's why we're here.

THE MAUNE COMPANY, distributors of Cupples Aluminum Curtain Wall and Hamilton laboratory furniture.

KANSAS CITY: 1009 Baltimore Ave., 64105 — Telephone (816) BA 1-7262

SAINT LOUIS: 8500 Eager Road, 63144 — Telephone (314) WO 2-8100

CONTROL TECHNIQUE

Lightweight

AGGREGATE FOR STRUCTURAL CONCRETE

A YARD OF CONCRETE

$$\frac{\text{Total wt. of all ingredients}}{\text{Actual wt. of concrete in lbs./cu. ft.}} = \text{Actual yield}$$

Regular yield determinations of fresh concrete should be made to:

1. Insure uniformity in cement content.
2. Make sure the customer is getting a yard of **BUILDEX** lightweight concrete.
3. Maintain the design strength for the job.



BUILDEX, INC.
BOX 15 OTTAWA, KANSAS

TELEPHONE
JE 1-8400

New Blue
PRINT INC.



LLOYD WARE
President



BOB BURTON
Vice President

Cast
your
vote
for
progress!
Vote yes
☒ June 27.



KANSAS CITY PRODUCERS' COUNCIL
3316 BROADWAY, KANSAS CITY, MISSOURI



makes products better for you



Developer: Von Frellick Associates, Denver.

Architects: James H. Johnson & Associates, Denver; Gene Shrewsbury, Denver.

General Contractor: W. R. Grimshaw Company, Tulsa and Denver.

Open web joists help build economy into unique shopping center

Unusual design often requires costly structural solutions. But not in the new Villa Italia Shopping Center, Denver, Colorado, where production-line structural components support the huge roof area.

Unique in design, the center captures the flavor and atmosphere of Southern Italy through Italian art and architecture. Villa Italia has 800,000 square feet of retail space for 80 tenants, plus a 150,000 square foot enclosed air conditioned mall called a Galleria. Although the center is old world in design, modern construction materials were used. For example: Sheffield Open Web Steel Joists were used, to support the built-up flat roofs. There were over 1,200 tons—34 different sizes of Sheffield H-Series and J-Series Joists used. All of the Sheffield Joists were standard sizes, selected right from the catalog. In this way all the economies of long

run factory production and the use of a repetitive building component were realized. Thus a shopping center with seemingly custom structural needs was designed and built with a standard material.

There are many reasons for the increasing acceptance for steel joists: High load carrying capacity per-pound of steel, flexibility during construction, easy passage of pipes and conduit through the open webs. Sheffield Open Web Steel Joists are completely standardized as to types, depths and load carrying capacities. They meet all the specifications of the Steel Joist Institute.

For additional information contact the Armco office in your city or write: Armco Steel Corporation, Dept. W-537A, 7000 Roberts Street, Kansas City, Missouri 64125

ARMCO STEEL





Let's enjoy the Chiefs in a new stadium!

VOTE YES

June 27 for the Sports Complex.

EST 1878 *B. C. Christopher & CO.*

4800 Main Street

Kansas City, Mo. 64112

Member New York Stock Exchange and other principal stock and commodity exchanges.

SKYLINES

Suite 206, John Hancock Building
800 West 47th Street
Kansas City, Missouri 64112

TO:

LIBRARIAN M
THE OCTAGON
1735 NEW YORK AVE NW
WASHINGTON DC 20001

**

BULK RATE
U. S. POSTAGE

PAID

KANSAS CITY, MO.
PERMIT NO. 375