

ARCHITECTURE M+M

SEP/OCT 14 \$3.95 architecturemn.com

INSIDE STORIES

The latest
in signature
workplace
interiors

STREET ARTIST

Seitu Jones
sets a half-
mile table
in St. Paul

INTERIORS DIRECTORY



Homes by Architects

The fall home tour
distinguished by design

BANG BREWING
AT SUNDOWN

LPM APARTMENTS
ON THE HORIZON



FRANÇOIS & CO.

SIGNATURE MATERIALS

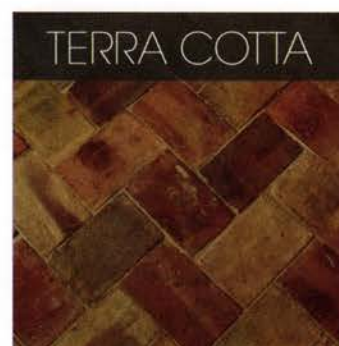
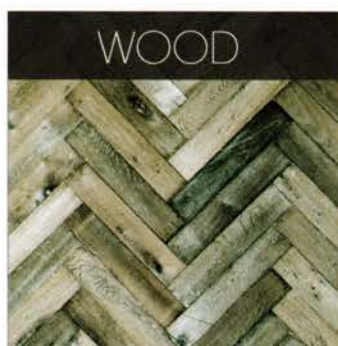
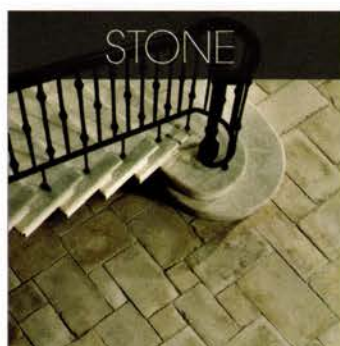

FRANCOISANDCO.COM | 612.375.9540

International Market Square | 275 Market Street | Suite 161 | Minneapolis | MN | 55405

ATLANTA | BEVERLY HILLS | SAN FRANCISCO | NORTH PALM BEACH | NASHVILLE | CHARLOTTE | DENVER

OUR COMMITMENT TO DESIGN PROFESSIONALS

TRUST

We will gain your trust by acting
with **integrity** and **reliability**.

| Respect |

| Collaboration |

| Communication |

| Flexibility |

| **Trust** |

ARCHITECTURE MN

Architecture MN is a publication of
The American Institute of Architects Minnesota
www.aia-mn.org

Architecture MN, the primary public outreach tool of the American Institute of Architects Minnesota, is published to inform the public about architecture designed by AIA Minnesota members and to communicate the spirit and value of quality architecture to both the public and the membership.

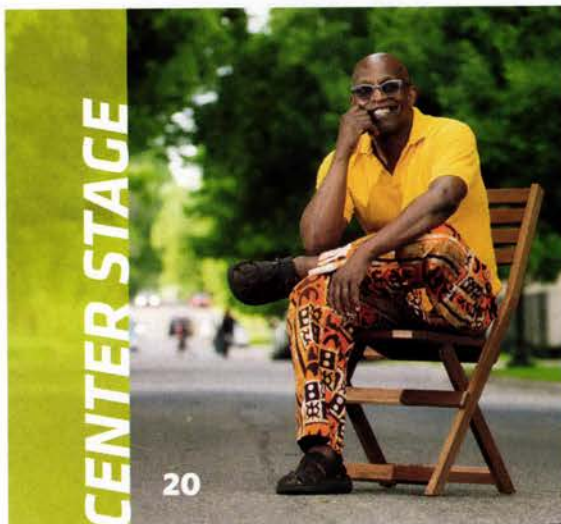

Features



ON THE COVER

Homes by Architects Tour Home 6
Edina, Minnesota

"Living in a white-on-white environment has its benefits," says photographer **Karen Melvin**. "You feel calm, clear, and cleansed after spending time at the Soranno-Bolter residence. With only minimal tones setting the mood, the designers have created a sanctuary where the inhabitants are the color in the room."

20 *Center Stage: Street Artist*

By Amy Goetzman

Public artist Seitú Jones designs the meal of a lifetime for St. Paul's Frogtown community: healthy, locally sourced foods for 2,000, served on a half-mile-long table on Victoria Street.

23 *Inside Stories*

Four unforgettable new workplace interiors enable greater creativity and collaboration.

Vertical Integration: Pohlad Companies

page 24

By Joel Hoekstra

Design Procedure: Bayer Interventional

page 29

By John Reinan

Mono Space: Mono

page 32

By Joel Hoekstra

The Writing on the Wall: Outsell

page 36

By Camille LeFevre

40 *Homes by Architects Tour Preview*

Everything you need to know about Minnesota's most distinctive fall home tour—plus an extended look inside one of the houses.

Home 6: Braemar Hills Modern

page 44

By Linda Mack

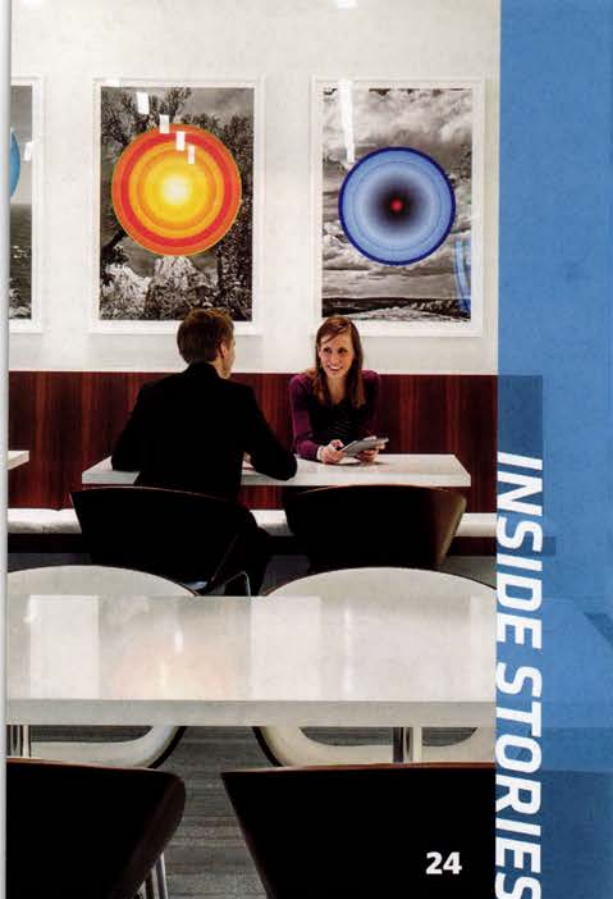

INSIDE STORIES

24

HOMES BY
ARCHITECTS

40

Departments & Directories

5 EDITOR'S NOTE

9 SCREEN CAPTURE

Architecturemn.com unveils a whole new look in September, and @archmnmag is your design destination on Instagram.

11 CULTURE CRAWL

BY ANGIE MCKINLEY

Get up close and personal with the latest in sustainable materials at the Minnesota State Fair Eco Experience.

13 STUDIO

The Partners 4, Design studio features some eye-popping visualization tools: seven state-of-the-art kitchens.

15 CONUNDRUM

BY FRANK EDGERTON MARTIN

Is LPM Apartments too tall for Minneapolis' Loring Park neighborhood? Or is it just a decade or so ahead of its time?

17 WAYFARER

BY DENES SAARI AND MARIA FORRAI SAARI

Two Twin Cities architectural photographers capture the Yucatán Peninsula's Chichén Itzá in dramatic black and white.

76 PLACE

BY COREY GAFFER

Bang Brewing owners Sandy and Jay Boss Febbo tip a pint with the architect of their popular grain-bin brewery.

60 DIRECTORIES OF INTERIOR ARCHITECTURE AND INTERIOR DESIGN FIRMS

74 CREDITS

75 ADVERTISING INDEX

When quality building products, right price, expert people and great service come together.
That's Synergy.

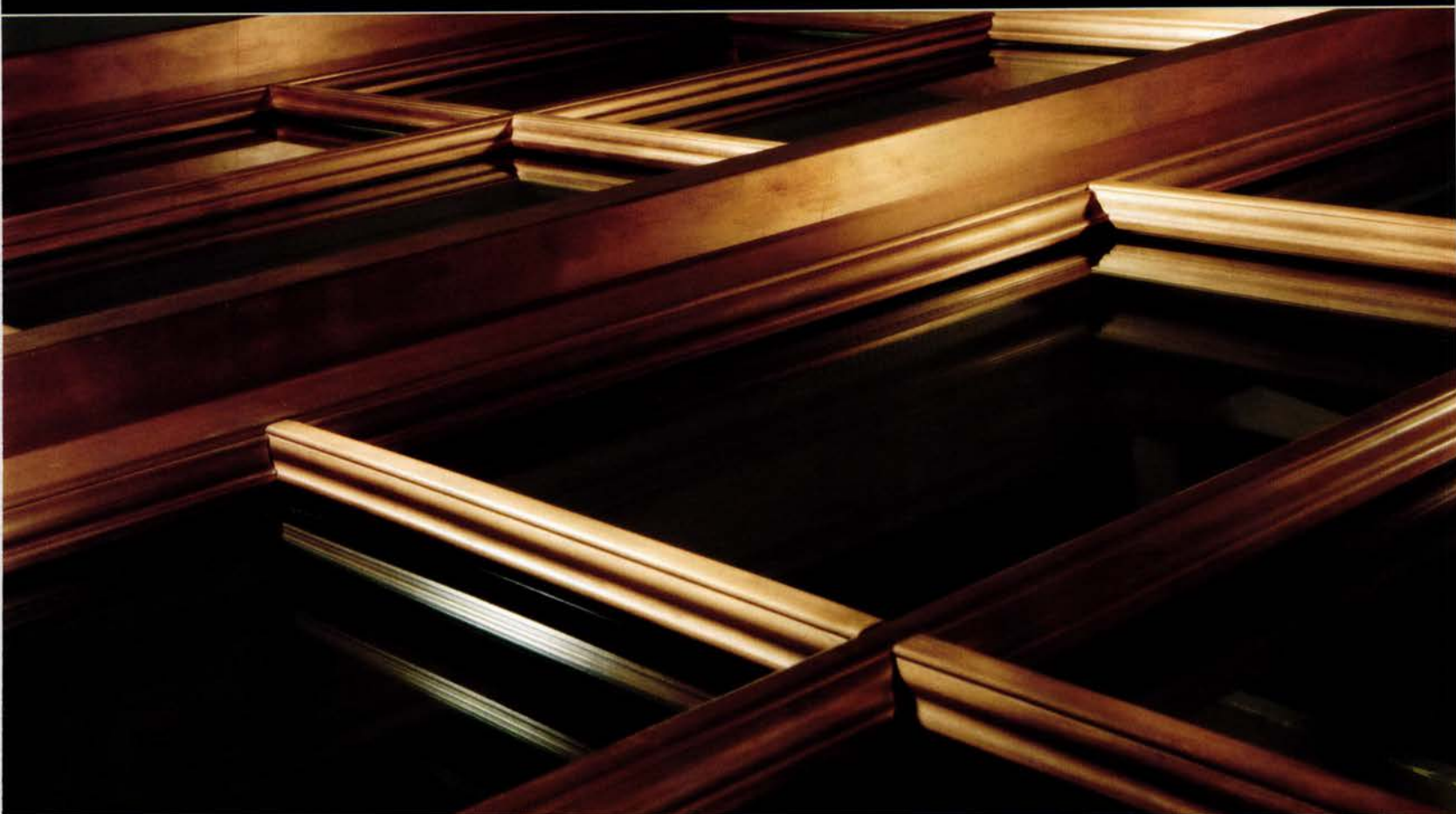

THE CYPRIUM COLLECTION

LIVING FINISHES IN COPPER AND BRONZE. Evocative of an element discovered in antiquity and used by artisans to create objects of lasting beauty. The Cyprium Collection features copper and bronze clad windows and doors that are unique in design and architectural elegance. These living surfaces develop distinctive patinas that both adopt and define the individual aesthetic character of the homes to which they belong. Available exclusively in the Twin Cities from Synergy Products.



VISION FROM WITHIN

Loewen

WINDOWS • DOORS • CABINETS



GAFFER PHOTOGRAPHY

Tip-Top Tap

We opened last year's September/October issue with "Brewhaha," a roundup of the robust public reaction to the design drawings of Surly Brewing Company's destination brewery. We close this year's with a visit to a brewery at the other end of the spectrum—Bang Brewing's 1,300-square-foot grain bin (page 76) in St. Paul's St. Anthony neighborhood. In 2015 we'll showcase these and other popular new facilities. In case you somehow missed it: We're living in the golden age of the craft-beer brewery and taproom in Minnesota.

Most of the Minneapolis taprooms are renovations of industrial spaces, have an appealingly scuffed-up design, and spill out onto an outdoor patio. Bauhaus Brew Labs' "new" Northeast facility—an old foundry and World War II-era airplane wing factory—opened in late July to large crowds. The modest Harriet Brewing patio near the intersection of Lake Street and Hiawatha Avenue is a great spot for live music and food-truck cuisine. We also love Indeed Brewing's Solar Arts Building taproom—and not just because of those solar panels on the roof.

Bang Brewing's building, designed by Alchemy Architects, is new construction, but it inventively reuses old materials. The deck, for example, is composed of heavy wood planks that used to surface Minneapolis' West River Parkway along the central riverfront, and owners Sandy and Jay Boss Febbo (pictured here, with Alchemy's Geoff Warner in the middle) clad the wall

We're living in the golden age of the craft-beer brewery and taproom in Minnesota.

behind the bar with wood fencing discarded by a neighbor. Jay laughs that the material cost them "zero dollars per linear foot."

"We were essentially home brewers building a commercial brewery, and we brought in a team that primarily does residential work, because we needed that kind of thinking for the scale we were building at," says Sandy. "In the larger world of architecture, this was a very low-cost facility, but for Jay and me the expense was substantial. Our scrappy approach to the project—creating a small space via design-build on a limited budget—took some really, really

resourceful and creative thinking, and we had a great team for that."

Minnesotans love good beer, and they love to be around the passionate and talented people who make it. But that alone doesn't account for the immense popularity of the taproom. Design matters too. Firms such as Alchemy, Shelter

Architecture (Bauhaus Brew Labs), DJR Architecture (Fulton Beer and 612 Brewery), LHB (Excelsior Brewing), and RoehrSchmitt Architecture (Urban Growler) are shaping authentic urban social spaces that perfectly resonate with the craft beer experience. And they're doing it with a deep respect for their clients' work ethic and ingenuity.

Chris Hudson

Christopher Hudson
hudson@aia-mn.org

THE AREA'S DEFINITIVE SOURCE FOR
EXCLUSIVE NATURAL PAVING STONE

ORIJIN STONE

OFFERING THE FINEST QUALITY
IN EXTERIOR SANDSTONE,
LIMESTONE, TRAVERTINE & MORE.

FEATURING A STONE GALLERY FOR
CLIENT MEETINGS AND SELECTION.
WAREHOUSE AND STONEYARD
CONVENIENTLY LOCATED ON SITE.

TRADE ONLY.

CENTRALLY LOCATED
IN ST LOUIS PARK

ARCHITECTURE MN

Architecture MN Staff

Editor:
Christopher Hudson
hudson@aia-mn.org

Advertising Sales:
Pam Nelson
nelson@aia-mn.org

Circulation:
Amber Allardyce
subscriptions@aia-mn.org

Production Designer:
Stephanie Pelzer
pelzer@aia-mn.org

Art Direction and Design:
Tilka Design
info@tilka.com

Publisher:
Beverly Hauschild-Baron, Hon. AIA
hauschild@aia-mn.org

Architecture MN Committee

Steven Dwyer, AIA
Chair

Amy Douma, AIA

Chuck Evens

Matthew Finn, AIA

Monica Hartberg, AIA

Paul Neuhaus, AIA

Tony Rauch, AIA

Brandon Stengel, Assoc. AIA

Tom Wasmoen, AIA

Heather West



AIA Minnesota

A Society of The American Institute of Architects

AIA Minnesota is the voice of the architecture profession, dedicated to serving its members, advancing their value, and improving the quality of the built environment.

AIA Minnesota
Board of Directors

Thomas Hysell, AIA
President

Timothy Dufault, AIA
President-Elect

Ann Voda, AIA
Past President

Phillip Koski, AIA
Secretary

Michael Meehan, AIA
Treasurer

Bryan Paulsen, AIA
AIA Minneapolis President

Pete Keely, AIA
AIA St. Paul President

Christopher Raimann, AIA
AIA Northern President

Matt Johnson, AIA
AIA Minneapolis Director

Robert Mack, FAIA
AIA Minneapolis Director

Meg Parsons, AIA
AIA Minneapolis Director

Paul Whitenack, AIA
AIA Minneapolis Director

Philip Briggs, AIA
AIA St. Paul Director

Sara Guyette, AIA
AIA St. Paul Director

Nathan Johnson, AIA
AIA St. Paul Director

Steven Wolf, AIA
AIA St. Paul Director

Thomas Fisher, Assoc. AIA
College of Design

Lois Langer Thompson
Public Member

Courtney Bragg, Assoc. AIA
Associate Director

Nate McKewon, AIAS
AIAS Representative

Henry Kosarzycki, AIA
Regional Director

Stephen Fiskum, FAIA
Regional Director

Beverly Hauschild-Baron, Hon. AIA
Executive VP



Architecture MN is published bimonthly by AIA Minnesota. The opinions expressed herein are not necessarily those of the Board of Directors or the Editor of *Architecture MN*. **Editorial office:** International Market Square, 275 Market Street, Suite 54, Minneapolis, MN 55405. (612) 338-6763. FAX: (612) 338-7981. **Web address:** architecturemn.com. **Note to subscribers:** When changing address, please send address label from recent issue and your new address. Allow six weeks for change of address. **Subscription rate:** \$21 for one year, \$3.95 for single issue. **Postmaster:** Send address change to *Architecture MN* at above address. Periodical postage paid at Minneapolis and additional mailing offices. **Advertising and circulation:** *Architecture MN*, above address and phone. **Printing:** St. Croix Press. **Color separations:** Southern Graphics Systems. Copyright 2014 by *Architecture MN* (ISSN 0149-9106).

CONTRIBUTORS

Get to know our writers and photographers. They're an interesting bunch.

COREY GAFFER

(www.gafferphotography.com) has worked and apprenticed with Hedrich Blessing, Esto, and Paul Crosby. He now runs Gaffer Photography, specializing in architectural stills and motion.



AMY GOETZMAN is a Minneapolis freelance writer. She writes about the arts and culture and other inspiring things that happen in inspiring spaces.



JOEL HOEKSTRA is the former editor of *Minnesota Monthly* and a longtime contributor to *Architecture MN*.

CAMILLE LEFEVRE is a freelance arts journalist and the editor of *The Line* (thelinemedia.com), an online publication about the creative economy of the Twin Cities.

Minneapolis-based **LINDA MACK**, author of *Madeline Island Summer Houses: An Intimate Journey* (2013), writes on architecture and design for local and national publications.



FRANK EDGERTON MARTIN

is a longtime contributor to *Architecture MN*, *Landscape Architecture*, and other design journals. He specializes in historic landscape preservation and teaches in the Publications Design program at the University of Baltimore.

ANGIE MCKINLEY is program director at AIA Minnesota and lead planner of the organization's annual Homes by Architects Tour.



JOHN REINAN, a former *Star Tribune* business reporter, is a senior director with the Minneapolis marketing agency Fast Horse.

Twin Cities architectural photographers **DENES SAARI** and **MARIA FORRAI SAARI** (www.saariphotography.com) recently traveled to the Yucatan Peninsula to photograph Chichén Itzá.



EST. 1923

... just better

MANUFACTURER OF PREMIUM CONCRETE
PAVING STONES & WALLS

THE POSSIBILITIES
ARE ENDLESS

Visit our showroom at IMS, Suite 12C | For more information call 800.622.4952 | www.borgerproducts.com



We offer designers, architects, engineers and developers multiple styles, sizes, colors and finishes of concrete pavers for a variety of applications. Our paving stones are the ideal solution for virtually any residential, commercial, municipal or industrial pavement application.



SBE



ARCHITECTUREMN.com

FOR GREAT ARCHITECTURE VIDEOS AND INFO ON OUR POPULAR VIDEOTECT COMPETITION, VISIT THE ARCHITECTURE MN WEBSITE TODAY

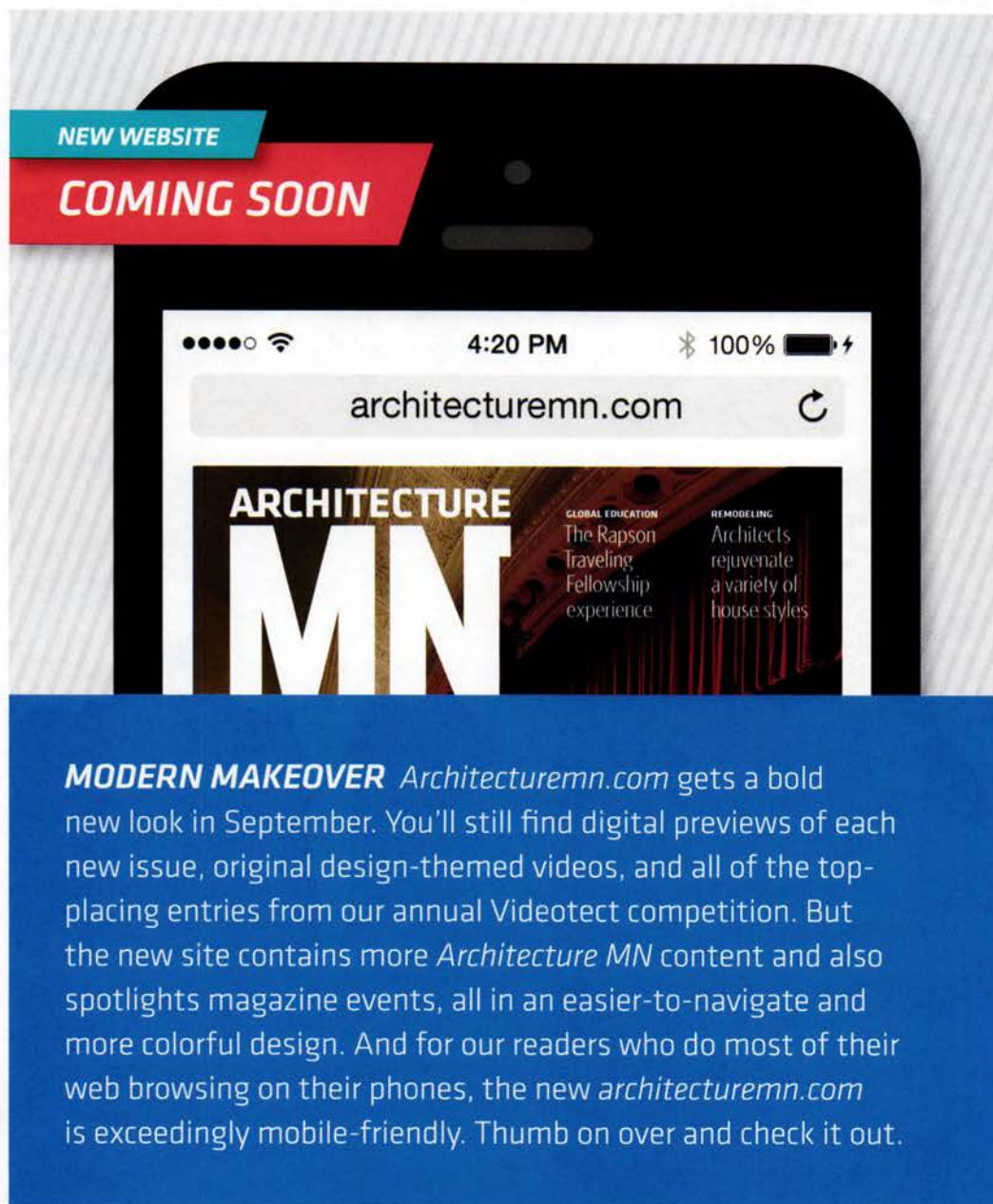

INSTAGRAM

If a picture is worth a thousand words, Instagram offers far more characters than Twitter.

Twin Cities architectural photographers Corey Gaffer, Morgan Sheff, and Peter VonDeLinde are making **@archmnmag** on Instagram our fastest-growing social media channel. Follow us for memorable architectural scenes, sneak peeks of highly anticipated projects, and coverage of cultural events such as artist Seitu Jones' half-mile-long CREATE: The Community Meal (page 20) and the 2014 Homes by Architects Tour (page 40).

INTERACT & CONNECT



DIGITAL EDITION

Sample *Architecture MN* with an exceedingly easy-to-navigate digital preview.



GUIDE TO WORKING WITH AN ARCHITECT

Haven't yet worked with an architect? Our introductory guide and resources are for you.



twitter.com/archmnmag
[instagram.com/archmnmag](https://www.instagram.com/archmnmag)
vimeo.com/architecturemn
pinterest.com/architecturemn



>> Above Project: Miami Conservancy District



creativity

Whitacre Greer 4 x 8 Permeable pavers are available in 2-1/4 and 2-3/4 thicknesses for pedestrian and vehicular applications. Available in traditional reds and contemporary buffs and grays, Whitacre Greer Permeable pavers can compliment any site. Whitacre Greer fired-clay pavers will not fade and offer superior durability against the stresses of freeze/thaw. Their close dimensional tolerances encourage creative installation patterns.

THE PAVER PLACE

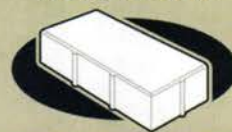

WHITACRE GREER
COMPANY

1400 S. Mahoning Avenue
Alliance, Ohio 44601
1-800-WG PAVER [947-2837]
wgpaver.com

>> Below Project: Youngstown State University :: Behnke Associates



We Make Great Brick.



Minnesota Brick & Tile

520 W. 86th Street, Bloomington, Minnesota 55420 tel 952.888.9239 fax 952.888.0077 www.mnbrick.com Click on **Related Sites and Products** to see all of our products.

FAIR'S FARE

The Minnesota State Fair's Eco Experience explores the latest in sustainability

Anyone who's been to the Great Minnesota Get-Together knows that farm animals and fried food on a stick aren't its only attractions. Consider the Eco Experience, a project of the Minnesota State Fair and the Minnesota Pollution Control Agency (MPCA) that offers hands-on exhibits and displays covering a vast range of topics related to sustainability and ecology. The annual Progress Center showcase always draws a crowd, in no small part because of the contributions of the University of Minnesota College of Design.

2013 GEN Y ECO HOUSE

For last year's Eco Experience, College of Design students designed and constructed the Gen Y Eco House (shown here) based on a survey of Millennials about their approach to home ownership. The students discovered that Gen Y-ers largely prefer a house with plenty of gathering spaces, a small ecological footprint, and sustainable features. The finished product incorporated movable walls, recycled building materials, and a "superwall" where controls for electricity, plumbing, and cooking were centralized.

2014 CHALLENGE

This year, associate professor and materials expert Blaine Brownell, AIA, and adjunct instructor and 4RM+ULA principal James Garrett Jr., AIA, challenged students in their ARCH 8565 course to think about how the built environment could make dramatic strides in energy efficiency. They pointed to data showing that buildings consume

more than 40 percent of global resources and asked students to propose a more sustainable use for an existing building element, or propose a new element with a sustainable application.

The architects reviewed the final proposals and selected a handful for display at the Eco Experience. The exhibit will also feature environmentally friendly products already in the marketplace, including Rosco LitePads (slim, edge-lit LED light sources), Panelite materials, and Radius Track offerings (January/February 2014 issue), among others.

—Angie McKinley

Last year, fairgoers interested in environmentally friendly design could settle right into the Eco Experience's Gen Y Eco House, designed by U College of Design students.

The Eco Experience

Minnesota State Fair

Progress Center

August 21–September 1

9 A.M. to 9 P.M. daily

www.mnstatefair.org





we believe in | american-made quality | natural materials | exceptional service | comfort | personalization
warmth | beauty and function | modern living | breaking the rules | mixing and matching | following your
heart | timeless style | collaboration | trusting your instincts | creating your ideal home

Walker table \$1469

Room&Board

PARTNERS 4, DESIGN

ESTABLISHED: 1972

CITY AND BUILDING: Minneapolis' International Market Square

NUMBER OF EMPLOYEES: 8 full and part time

partners4design.com

Kitchen and bath design specialists **John Idstrom, AIA**, and **David Ostreim, AIA**, are right at home in their Minneapolis showroom studio

AREA OF SPECIALTY: Kitchen, bath, and home remodeling. **DESCRIBE YOUR STUDIO SPACE IN 140 CHARACTERS OR LESS:** Open-to-the-public #kitchen #bath showroom with a wide range of displays for #design #inspiration. **GOOD PLACE TO THROW A PARTY?** Yes, and we do it regularly. Great kitchens are made for entertaining, and we have seven of them. **BIGGEST MISCONCEPTION ABOUT KITCHEN AND BATH RENOVATIONS:** That they're easy. **WHERE WOULD YOU FLY YOUR STAFF FOR INSPIRATION IF YOU HAD THE BUDGET FOR IT?** Product shows and vendor factories in North America and Europe—and it's something we already do. We've sent our staff to Milan, Italy, and Herford, Germany, among other destinations. **STAFF EXTRACURRICULARS:** Jim is a musician, Nicole is a rock climber, and John enjoys giving treats to his "lawn sculptures" (also known as horses). **FAVORITE APP:** Poggenpohl's Your Kitchen app for iPad. **LONGEST RECURRING CLIENTS:** John and David are now working with third-generation clients. They know the families and how they've lived in the houses and kitchens they grew up in. **HOW ARE KITCHENS CHANGING?** They're becoming more and more automated. The *Jetsons* kitchen isn't that far off.

Top, from left to right: General manager Andy Ostreim, designer James O'Neill, and designer Nicole Sirek. Bottom: Architects John Idstrom and David Ostreim review plans with a client.



Architecture is more than just pretty pictures...



It's about the movement of light and shadow,

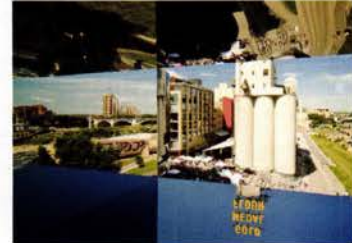

the interaction of people and space,



the relationship between architect and client,



and the impact it has on those around it.



Ryan Siemers

Assoc. AIA / LEED A.P. / ASMP
Filmmaker / Photographer / Designer

... but I do those too.

612-386-7457
www.RyanSiemers.com
YourStory@RyanSiemers.com

Is LPM Apartments,
Minneapolis' tallest
apartment tower in a
generation, ignoring its
context or creating
a new one?

MORGAN SHEFF



ON THE HORIZON

BY FRANK EDGERTON MARTIN

The newly opened LPM Apartments seems to sail westward over Minneapolis' Loring Park like a tall clipper ship. Sheathed in glass and set atop a rectangular base of parking and ground-level stores, the 36-story, lozenge-shaped building is a quintessential Chicago residential project—a tower with a platform pedestal built more to the Windy City's Gold Coast scale than anything Minneapolis has ever seen.

Developed by Chicago's Magellan Development Group and designed by Loewenberg Architects, LPM gleams above foreground masonry buildings including the old Eitel hospital—itsself now high-end apartments (May/June 2009 issue). Depending on how you look at it, LPM is either very out of place in its leafy neighborhood on the outskirts of downtown, or it's quite beautiful and bold. Like many beautiful people, it is also decidedly slim, with sleekly arcing balconies that accentuate its curving glass facades.

So which is it? Does the 354-unit LPM ignore the scale and texture of Loring Park, or is it setting a laudable new standard for high-rise design in Minneapolis—and for density that can invigorate both the neighborhood and downtown?

GAME-CHANGING TOWERS

When the IDS Center opened in the early 1970s, it also stood out like a lone soldier on the plains. Indeed, when a college roommate from New York City visited me one cold January, his comment about downtown Minneapolis was that "it's a very nice building." That hurt. But over time, other towers grew up around IDS, and now downtown is a chessboard with an impressive set of pieces, each boasting a distinctively lit top.

Developers like Magellan know that if you build at a big enough scale, you can change the neighborhood over time. With new tenants come new stores, higher property values, and a cycle of more investment.

LPM may be similarly ahead of its time. Chances are, in 10 years, it will share the horizon with new peers. The scale of the Loring Park neighborhood and Nicollet Avenue is destined to change, especially with the likelihood of a new streetcar line. LPM's five-story pedestal already nicely matches the scale and massing of Emerson

Spanish Immersion Learning Center across the street and older apartment buildings along Spruce Place. (If only its materials and detailing were more engaging; it resembles an opaque modern footstool.)

Of course, LPM's height and massing aren't the only design variables that shape its connection to its surroundings. Does the tower's street level, for example, have retail spaces for the public? Can you walk through the project as you can the nearby Eitel Building City Apartments? Do the lower levels have windows and balconies that face the street?

LPM features street-facing balconies and planned retail spaces, but it's not a building that invites nonresidents to pass through. (Compare the property to Brunson North Loop [January/February 2014 issue], a new Minneapolis apartment building whose central outdoor plaza is open to all.) Its 40,000 square feet of resident amenities—a lap pool, media rooms, a fitness facility, an indoor dog play area, and a large, well-appointed patio lead the list—sit high above the street, atop the pedestal.

Meanwhile, down on the ground, the sleek, self-contained LPM sits beside Jungle Red,

>> continued on page 50



Wadena Deer-Creek School



MnDot Maple Grove Vehicle Maintenance



Unity Church - Unitarian



Hmong College Prep Academy

2014 MERIT AWARDS WINNERS

The AIA Minneapolis Merit Awards recognize and celebrate projects that tell a story of excellence through the variety of innovations and collaborations that shape a building. The AIA Minneapolis member projects were selected based on the following criteria: client/team satisfaction, technical innovation, environmental responsibility, budget/business success, community impact, and architectural solution.

Wadena Deer-Creek Middle School + High School

Perkins+Will

MnDOT Maple Grove Vehicle Maintenance Facility

Kodet Architectural Group, Ltd.

Unity Church - Unitarian

Miller Dunwiddie Architecture, Inc.

Michael L. Schrock, AIA, Merit Award

Hmong College Prep Academy

Kodet Architectural Group, Ltd.

This award was created in 2008, in honor of Michael L. Schrock, whose passion helped develop the AIA Minneapolis Merit Awards.



AIA Minneapolis

A Chapter of The American Institute of Architects

The millennium-old ruins of Chichén Itzá draw more than a million sightseers annually

"Frozen in time" is the way Twin Cities architectural photographers Denes Saari and Maria Forrai Saari describe the stone temples and arcades of Chichén Itzá. The ruins scattered across this five-square-kilometer UNESCO World Heritage Site in Mexico's Yucatán Peninsula are all that remain of the religious and trade capital of the Maya Empire, but they're enough to stir awe in the throngs of visitors. "We chose to photograph in black and white to capture the timelessness of the place," says Maria Forrai Saari. "We also think it leaves more to the imagination of what life might have been like in this advanced civilization."

First excavated in the 1920s by the Carnegie Institution and the Mexican government, Chichén Itzá is anchored by, and perhaps best known for, El Castillo, a nearly 100-foot-high stepped pyramid topped by the Temple of Kukulcan. The 91 steps on all four sides and the temple platform total 365—the number of days in one part of the Maya calendric system. The Temple of the Warriors (in background below) and two intersecting rows of carved columns lie a short walk away. These and other compelling structures reveal much about the Maya culture, but the mystery of the great city's abandonment remains.

—Christopher Hudson

M
A
Y
A
M
A
R
V
E
L
S

SAARI & FORRAI PHOTOGRAPHY

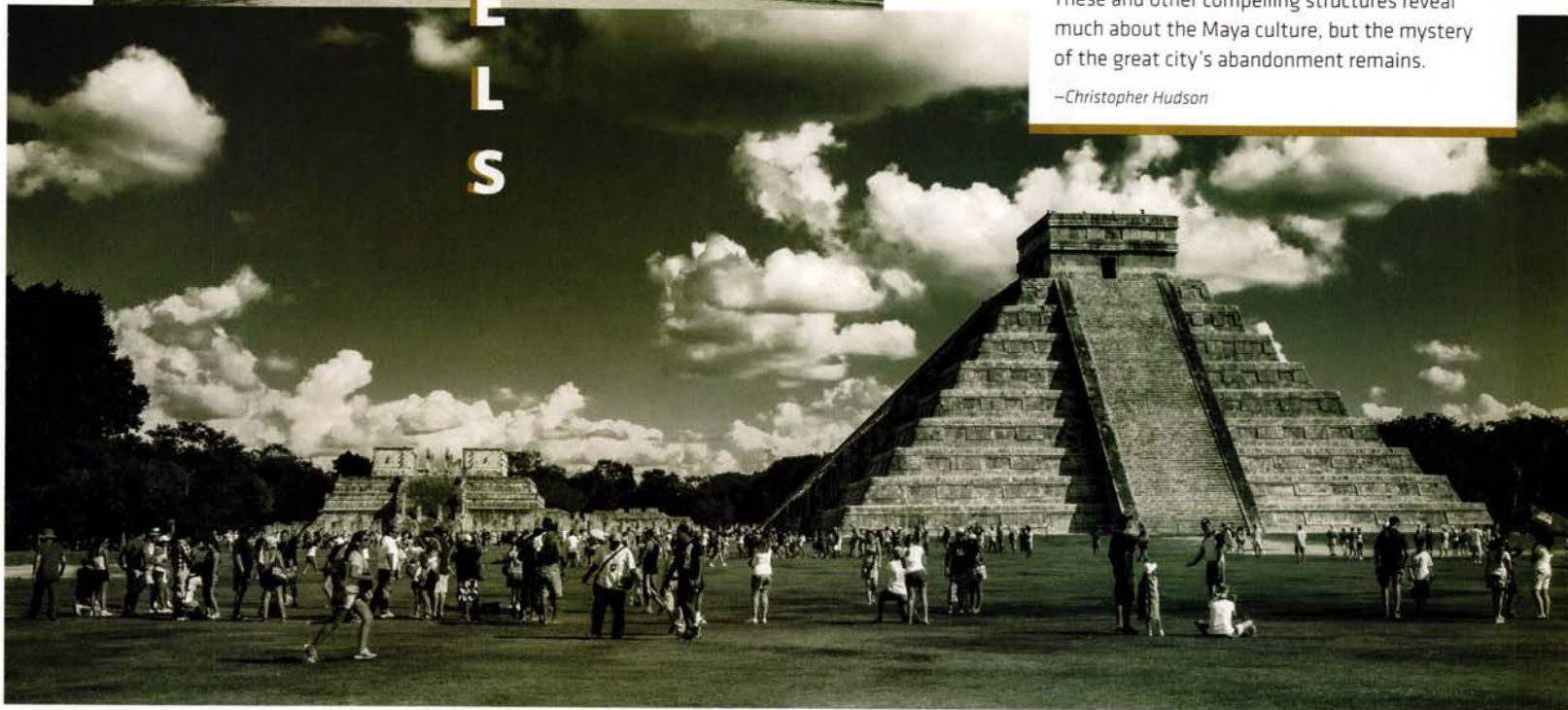

El Castillo, Chichén Itzá's most iconic structure, rises 91 steps on all four sides. The Temple of the Warriors can be seen in the background above.



AIA Architects

**AIA Minnesota architects are valued, collaborative leaders in shaping
the built environment for the public good**



AIA Minnesota

A Society of The American Institute of Architects

www.aia-mn.org

INSPIRATION

IS WHERE YOU FIND IT. FIND YOURS HERE.



Image courtesy of John Magatoski, SKD Architects

JOIN THE TOUR 2014 HOMES BY ARCHITECTS
SATURDAY & SUNDAY, SEPTEMBER 20-21
EXPERIENCE ARCHITECT-DESIGNED HOMES IN THIS ONE-OF-A-KIND HOME TOUR



MARVIN
Windows and Doors
Built around you.™

MIDWEST
Home
MARVIN
DESIGN GALLERY
a window and door showroom
"BHAM / STEWART"

STREET & ASSOCIATES
Architectural
Builders

BRADEN
KRAEMER
SONS
CUSTOM BUILDERS

CITYSCAPE
City Building Supply, LLC
Custom and Semi-Custom

DIGIACOMO
Barbieri & Associates LLC
Structural Engineers
Architectural Consultants

OTTO

FROST CABINETS
STELLIAN

facebook.com/HBATour

Learn how easy it is to work with an architect at homesbyarchitects.org

STREET ARTIST

BY AMY GOETZMAN

From the windows of his Frogtown art studio, Seitu Jones noticed his neighbors walking empty-handed in one direction and then back again, now carrying plastic bags. They were doing their grocery shopping at the convenience store. It bothered Jones. There were few other places to buy food in the St. Paul neighborhood, and he knew the processed, chemical-laden items the convenience store sold weren't going to nourish the community.

"Access is a problem. People in low-income areas have poor access to affordable, healthy food options," says Jones, a multimedia, multidimensional public artist with a dual background in landscape design and agricultural systems. "There are also abstract barriers that keep people from making healthy food choices, primarily having to do with the fact that we've forgotten how to grow and cook food—we've forgotten how easy it is to make a simple, nutritious, even *memorable* meal." This mindset gives Jones a nuanced understanding of the ways health and diet are linked to opportunity, and how they ultimately shape urban environments.

He decided to address the problem by hosting a memorable meal—for 2,000 people—that links residents to food producers to cooks to artists to people who are dreaming up ways to make city life better. CREATE: The Community Meal will be served on the afternoon of September 14, at a half-mile-long table right down the middle of St. Paul's Victoria Street.

With initial financial support from the Joyce Foundation and production and promotional support from Public Art Saint Paul, Jones has planned a simple menu of chicken and vegetables, locally and sustainably grown and prepared to highlight flavors from all of the cultures that call Frogtown home. The meal will be served on placemats designed by artist Mary Hark and young community members. Poet G.E. Patterson will offer a pre-meal blessing. Choreographer Ananya Chatterjea will lead 250 volunteers in a dance-like serving ritual. It will be a sight to behold.

"We want to show people that simple, healthy food is within reach," says Jones. "People will have a vivid memory of healthy, local foods, and learn how they can become more than a bottom feeder in the food system." They'll also have an opportunity to learn new food-preparation skills at two mobile "art kitchens" outfitted with a griddle or hot plate. These artist-designed kitchens-on-wheels will also pop up in parks and at other events throughout the city, in an ongoing effort to promote healthy cooking. And Frogtown Farm, a planned 12.7-acre park and community garden on Victoria Street, will soon bring fresh produce back to the area.

"This is not a one-day event. This is a long-term program in which the meal is part of a sea change," says Christine Podas-Larson, president of Public Art Saint Paul. "Getting people together at the table with their neighbors helps connect them

>> *continued on page 53*

CENTER STAGE

Casting a spotlight on compelling ideas from innovation-minded architects and artists

In September, **Seitu Jones** turns a St. Paul street into Eat Street for a day with his half-mile-long **CREATE: The Community Meal**

A man with a shaved head and a warm smile is seated on a wooden director's chair. He is wearing a crisp white long-sleeved button-down shirt and vibrant, patterned trousers featuring bold geometric and organic shapes in orange, black, and white. His hands are clasped in his lap, and he is wearing dark leather sandals. The setting is outdoors on a paved surface, with a lush green background of trees and a blurred street scene with cars in the distance. The lighting is bright and natural, suggesting a sunny day.

"I grew up in a big, loving family of artists who were also dining-room porters, clerks, letter carriers, teachers, steel workers. They taught us to love community, be involved in social clubs, better ourselves and our communities. I am fortunate to be able to engage my community through art."

IT'S TIME TO SHOW THE ARCHITECTURAL INDUSTRIES
THE BEST OF WHAT'S NEW.

EXHIBIT

at the

AIA MINNESOTA ANNUAL CONVENTION NOVEMBER 11-14, 2014 MINNEAPOLIS CONVENTION CENTER

Reach the largest architecture and design market in Minnesota! The AIA Minnesota Annual Convention & Product Exposition is known for consistently attracting 2,000+ attendees, offering exceptional programs, and opportunities to network with cutting-edge exhibiting companies.

Visit us online to see which industry leaders will join us this year with the latest in product innovation and services.

www.aia-mn.org

FOR QUESTIONS ABOUT BOOTH SPACE RESERVATIONS
CONTACT PAM NELSON AT 612-338-6763 OR NELSON@AIA-MN.ORG.



WHO ATTENDS?

OTHER CATEGORY INCLUDES:

Specifiers • Builders • Facility Managers •
Graphic Designers • Other related design &
building professionals

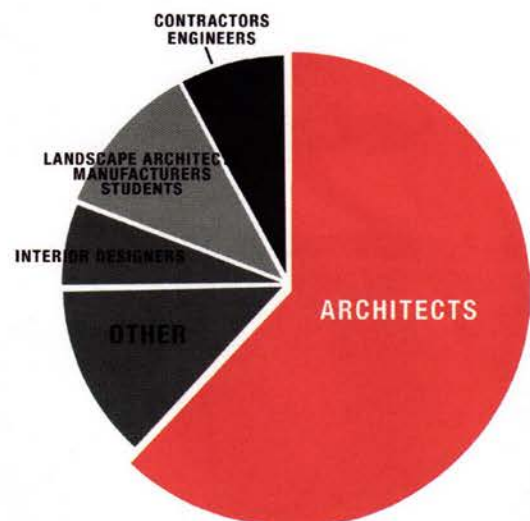

AIA Minnesota

A Society of The American Institute of Architects

“In the beginning, we wanted our own campus. But then we saw how this building could become so much more inviting.” [PAGE 29](#) “People are always bumping into each other going up and down. Meetings happen on the landings. . . . If a physical space can change human interactions, well . . . this one definitely has.” [PAGE 24](#) “You can understand how we work—our philosophy, our approach to work, and our cultural vibe—almost within seconds of walking into the space.” [PAGE 32](#) “The workspaces needed to attract and retain the best talent, all while integrating and reinforcing the company’s brand from the elevator all the way through to the individual workstations.” [PAGE 36](#)

FOUR INTERIOR RENOVATIONS TRANSFORM THE WORKSPACE EXPERIENCE

INSIDE STORIES



VERTICAL INTEGRATION

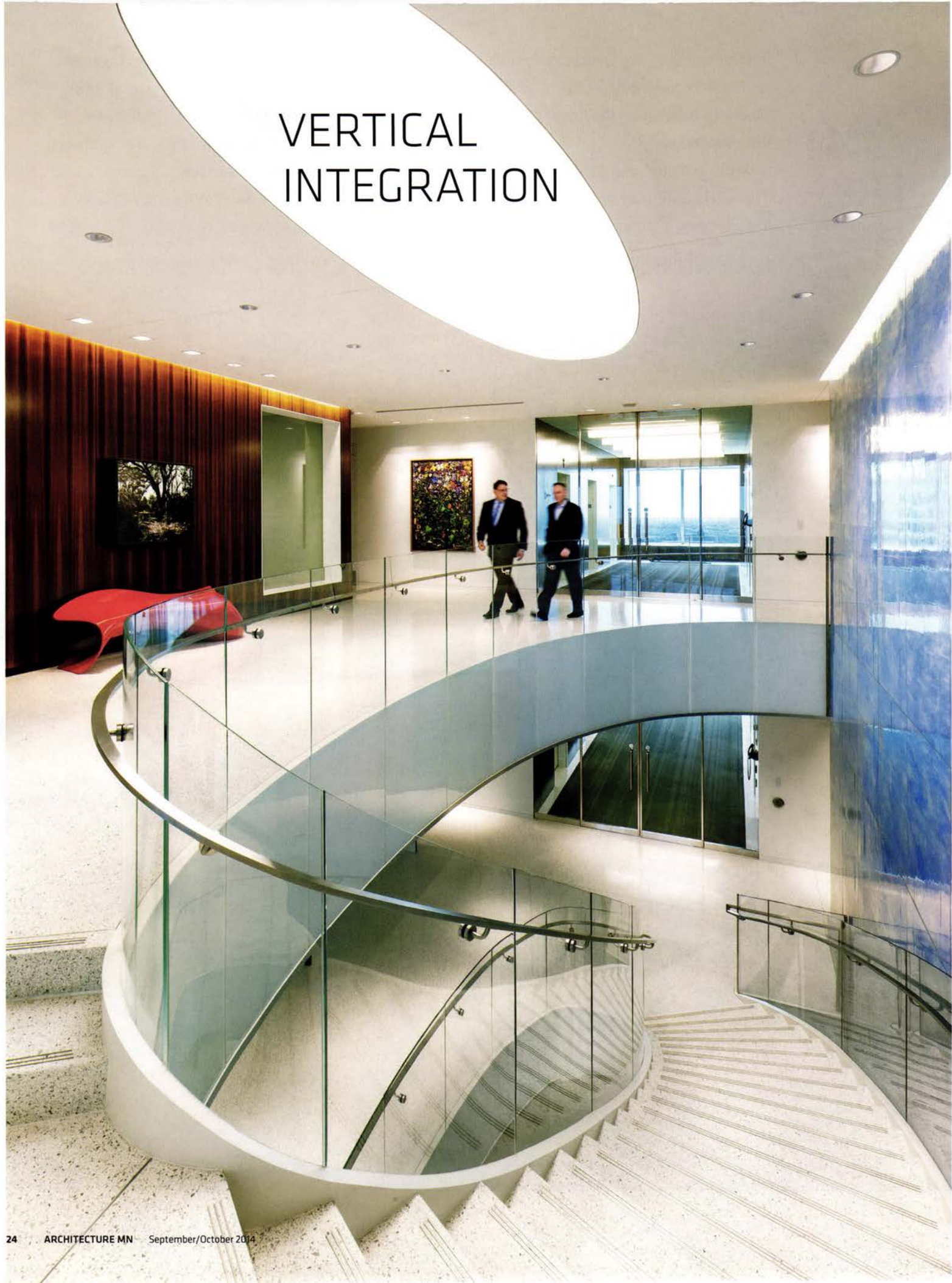



Pohlad Companies' elegant renovation of its three-floor headquarters promotes interaction and transparency in the office culture



Opposite: The elliptical center staircase is further dramatized with white terrazzo floors, a wall of powder-blue art glass, and punches of color in the artwork and contemporary furnishings. Top: The main lobby on the middle floor. Above: Interior glass walls open sightlines.

BY JOEL HOEKSTRA

Can a staircase bring people together? It's a theory being tested at the headquarters of the Minneapolis-based Pohlad Companies, where the centerpiece of a new office renovation is an elliptical, white-glass staircase that corkscrews elegantly through the top three floors of a downtown skyscraper.

"It's beautiful," says Bert Colianni, CEO of Marquette Companies, the operating group within the Pohlad Companies. "People are always bumping into each other going up and down. Meetings happen on the landings. Nobody uses the elevators anymore to get between floors."

A staircase might seem an odd feature to introduce into a suite of offices that occupy the top three floors of the 40-story RBC Plaza. (Indeed, it was expensive and challenging to cut through the reinforced floor plates and take out each chunk of concrete by freight elevator.) But such vertical integration was exactly what executives at the Pohlad Companies were looking for when they hired HGA Architects and Engineers to remodel their headquarters.

They wanted the nearly 100 employees—from a mix of businesses and groups including the Pohlad Family Foundation, the family office, an asset management business, shared services, and corporate development—to mingle more

frequently. (The Pohlads Companies is composed of more than 25 diverse businesses run by the three sons of Carl Pohlads, the late banker and Minnesota Twins owner.) They wanted to foster more collaboration and a sense of egalitarianism. They wanted transparency—quite literally—and a place that would fill employees with pride.

HGA's Joan Soranno, FAIA, John Cook, FAIA, and Doug Gerlach, AIA, were tasked with the job of infusing the offices with this new look and feel. The original space, completed when the tower opened in 1992, was decorated with honeyed oak and trimmed in rich burgundy and forest-green tones. Private offices occupied the perimeter, preventing light from reaching the core of the 13,000-square-foot floors. An update a decade later introduced some glass, but the interior of the building remained quite dark.

"The first thing we wanted was visual transparency," says Soranno. "We also wanted it to be brighter,

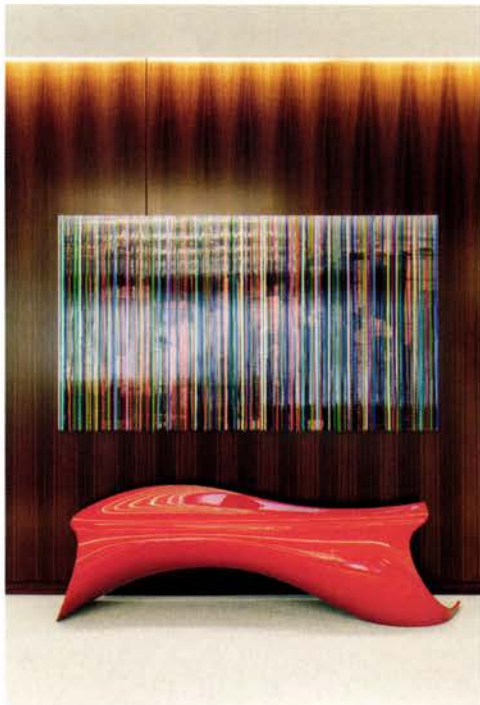

"It's beautiful. People are always bumping into each other going up and down. Meetings happen on the landings. Nobody uses the elevators anymore to get between floors."

MARQUETTE COMPANIES CEO BERT COLIANNI



ARCHITECT JOAN SORANNO, FAIA

"The first thing we wanted was visual transparency. We also wanted it to be brighter, easier to sense where there was activity and where people were gathering."

Left: Venetian plaster, Corian, and terrazzo offer a variety of visual textures in the mostly white environment. Above: The open coffee bar on the 39th floor, just off the staircase. Below: The boardroom on the 40th floor.

POHLAD COMPANIES

Location:
Minneapolis, Minnesota

Client:
Pohlad Companies

Architect:
HGA Architects and Engineers
hga.com

Principal-in-charge:
Dan Avchen, FAIA

Project lead designer:
Joan M. Soranno, FAIA

Project architect:
John Cook, FAIA

General contractor:
RJM Construction

Size:
40,000 square feet

Completion:
July 2013

Photographer:
Paul Crosby



“People have reacted very positively. If a physical space can change human interactions, well . . . this one definitely has.”

MARQUETTE COMPANIES CEO BERT COLIANNI

easier to sense where there was activity and where people were gathering.”

Starting from scratch on each floor, the architects created spaces that were white, bright, and heavy on glass. Visitors entering the main lobby on the middle floor not only encounter the notable staircase, which rises against a wall of powder-blue glass manufactured by a Kentucky artist; they also have views into the company cafe and several conference rooms. Exterior offices still line the perimeter of each floor, but glass partitions and walls allow daylight to filter through into the interior. White terrazzo floors and Corian surfaces reflect the illumination, while brushed chrome fixtures and the occasional use of larch as a finish add to the sumptuous feel of the place.

The brothers each occupy a corner office on the top floor of the tower, and “each space is reflective

>> continued on page 53



The main lobby on the 39th floor (above) offers easy access to the elevator lobby, center staircase, conference rooms, and coffee bar and cafe (below).



DESIGN PROCEDURE

A maker of
medical devices
transforms
the interior
of an ordinary
industrial
park building

By John Reinan

The centerpiece of the renovation
is an acoustical shell shaped to mimic
a cutaway view of an artery.

"The design introduced an intervention in this shell. We wanted to portray the vitality of the company to employees and clients."

ARCHITECT ROSS NAYLOR, AIA



A key focus of the renovation was increasing natural light. Offices lining the perimeter of the building were removed, while skylights and clerestory windows were added.

BAYER HEALTHCARE, PHASE 1

Location:
Coon Rapids,
Minnesota

Client:
Bayer AG

Architect:
Architectural
Alliance
archalliance.com

**Principal-
in-charge:**
Peter
Vesterholt, AIA

**Project lead
designer:**
Tom DeAngelo,
FAIA

**Project designer/
architect:**
Ross Naylor, AIA

Energy modeling:
Dunham
Associates (2011);
CRB (2012)

General contractor:
PCL Construction
(2011); McGough
(2012)

Size:
64,000
square feet

Cost:
\$8 million

Completion:
March 2012

Photographer:
Paul Crosby





Informal meeting rooms were positioned under skylights (above). Six-foot-high cubicle walls were replaced with four-foot units to open up the space (right).



The yellow indicates new clerestory windows.

- 1 Entry
- 2 Lobby/gallery
- 3 Open office (in acoustic shell)
- 4 Team areas
- 5 Cafe/dining



The facility had to accommodate multiple uses, including research, sales, manufacturing, and a clean room (left).

FROM THE OUTSIDE, THIS ONE-STORY WAREHOUSE BUILDING in a Coon Rapids industrial park is virtually identical to the thousands of precast concrete structures populating similar parks across America. But on the interior, this unimposing building has undergone a stunning transformation that's a metaphor for the client's business.

Bayer Interventional, the tenant, designs and manufactures thrombectomy and atherectomy devices that clear clogged blood vessels. In a similar fashion, Architectural Alliance oversaw a complete gutting of the dreary 1980s warehouse—and then inserted a fresh interior that has breathed new life into the place. “The design introduced an intervention in this shell,” says project architect Ross Naylor, AIA. “We wanted to portray the vitality of the company to employees and clients.”

“It was just old and tattered,” says Rod Dupree, facilities manager for this and several other Bayer properties in the Twin Cities. “In the beginning, we wanted our own campus. But then we saw how this building could become so much more inviting.”

The first step was to bring in natural light. Interior precast panels were removed to allow light from low perimeter windows to penetrate deeper into the building. Private offices that lined the outer walls were also removed. Skylights were cut into the 24-foot-high ceiling and additional clerestory windows were created

>> continued on page 55

monospace

BY JOEL HOEKSTRA



A 40-foot-long table formed from a single western hemlock and hand-finished by Lazor dominates the space. "Cooking is vital to the life of this place."

DESIGNER CHARLIE LAZOR, ASSOC. AIA



Lazor Office and AWH Architects design a sleek new studio for a fast-growing advertising agency

The most common element in mono's new space is the long table. Workstations (above) run along counters, while the 40-foot-long kitchen table (opposite) blurs the line between work and break time.

Transparency is the talk of business these days. But few executives have made their commitment to the idea as visual and concrete as the owners of mono, an advertising agency based in Minneapolis' Uptown neighborhood.

Last year, the fast-paced, fast-growing firm decided to make the move from the second floor of an old warehouse to the top floor of a new midrise a few blocks away. The new space—roughly 20,000 square feet, with 13-foot-high ceilings and 360-degree views of Minneapolis through wrap-around windows—would accommodate more employees, but it had to function the same way as the old mono space.

"We're very multidisciplinary and inclusive in how we work and attack problems," says Michael Hart, one of mono's three owners. At the center of the agency's old offices, for example, was a wall where creative concepts were posted, developed, and distilled. Comments from all workers were encouraged.

To build out the newly leased space, mono retained Charlie Lazor, Assoc. AIA, of Lazor Office and Alex Haecker, AIA, of AWH Architects. Lazor, who helped launch the modern-furnishings company Blu Dot and introduced the prefabricated FlatPak house to the market more than a decade ago, had previously worked with mono on its warehouse build-out.

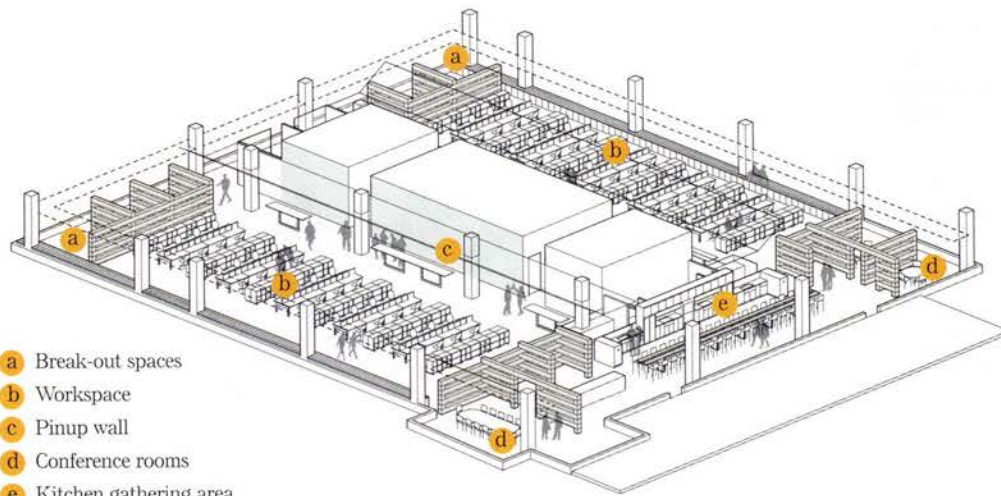

- a Break-out spaces
- b Workspace
- c Pinup wall
- d Conference rooms
- e Kitchen gathering area

Lazor and Haecker were charged with creating a design that promoted several of the key tenets of mono's business philosophy: transparency, flexibility, meritocracy, simplicity. Executives also wanted the physical space to reinforce the idea of organizational flatness—apart from a few key positions, everyone at mono changes desks every four months. Executives work alongside new hires and interns, rather than retreating to corner offices.

The resulting plan allows all staff to enjoy ample natural light from the windows. Partitions are few, so the views are wide. Employees sit at long counters rather than individual desks. Cables, wires,

and cords are bundled and hang from the ceiling. White finishes and metal trim give the space a clean, modern feel.

Lazor and Haecker reestablished the idea wall on either side of the floor's mechanical core, with a metal-mesh drop ceiling to help set those spaces apart. Several feet above the drop ceiling is a layer of soundproofing material made of recycled blue jeans, to keep the pinup conversations from echoing. "We love the idea that there are 5,000 pairs of old blue jeans above us, helping make the creativity happen," says Hart, with a laugh.

>> continued on page 57

The designers reestablished mono's idea wall on either side of the floor's mechanical core, with a metal-mesh drop ceiling to help set those spaces apart.

MONO

Location:

Minneapolis, Minnesota

Client:

mono

mono-1.com

Architect:

AWH Architects

with Lazor Office

www.awhllc.net

www.flatpakhouse.com

Principals-in-charge:

Charlie Lazor, Assoc. AIA;

Alex Haecker, AIA

Project lead designers:

Charlie Lazor, Assoc. AIA;

Alex Haecker, AIA

General contractor:

RJM Construction

Size: 20,200 square feet

Completion:

January 2013

Photographer:

Chad Holder



The timber-stacked conference rooms (left) and break-out spaces (opposite, bottom) add an agrarian touch to the modern studio environment. The metal-mesh drop ceiling along the pinup walls (opposite, top) is purely industrial.



"It's the simplest form of building. You just take rough-sawn timber, stack it, screw down through the corners, and repeat."

DESIGNER CHARLIE LAZOR, ASSOC. AIA



CREATIVE THINKING IS EVERYWHERE IN A DIGITAL
MARKETING SOFTWARE COMPANY'S NEW DOWNTOWN
MINNEAPOLIS HEADQUARTERS

The Writing on the Wall





Outsell has a creative message for employees and clients as soon as they step off the elevator: "TRANSFORM," spelled out in color blocks illustrating a wide range of communication symbols and devices.

BY CAMILLE LEFEVRE

"Which conference room is our confab in today? Watchtower? Hall of Justice? Batcave? Oh, right: Fortress of Solitude." For employees of Outsell, which develops and markets interactive, analytical customer-service software for car companies and their dealerships, naming their collaboration spaces after superhero lairs is one perk of their new offices on the 32nd floor of Capella Tower in downtown Minneapolis.

Others include the fully stocked kitchen/cafe just off the elevator, with panoramic views of downtown, and the office's clean modern design, fully integrated with digital technology. There's an iPad or iPod Touch in every meeting space—in case you forgot yours—where you can upload your work. But there are plenty of low-tech touches, too: Several erasable whiteboard-painted walls are ready for spontaneous brainstorming, and another wall is covered in Post-it Notes on which employees have scribbled their achievements and goals.

It's the kind of environment you might expect from one of the fastest-growing companies in the U.S. (according to *Inc.* magazine)—a firm that's increased its revenue more than 400 percent and tripled its staff over the past three years. "Our people are our most important asset by far," says CEO Mike Wethington. So Outsell's new offices, designed by Gensler, "give the best spaces to associates," he explains.

Adds Gensler Minneapolis managing director Bill Lyons, Assoc. AIA: "The workspaces for Outsell's highly skilled tech workers needed to attract and retain the best talent, all while integrating and reinforcing the company's brand from the elevator all the way through to the individual workstations."

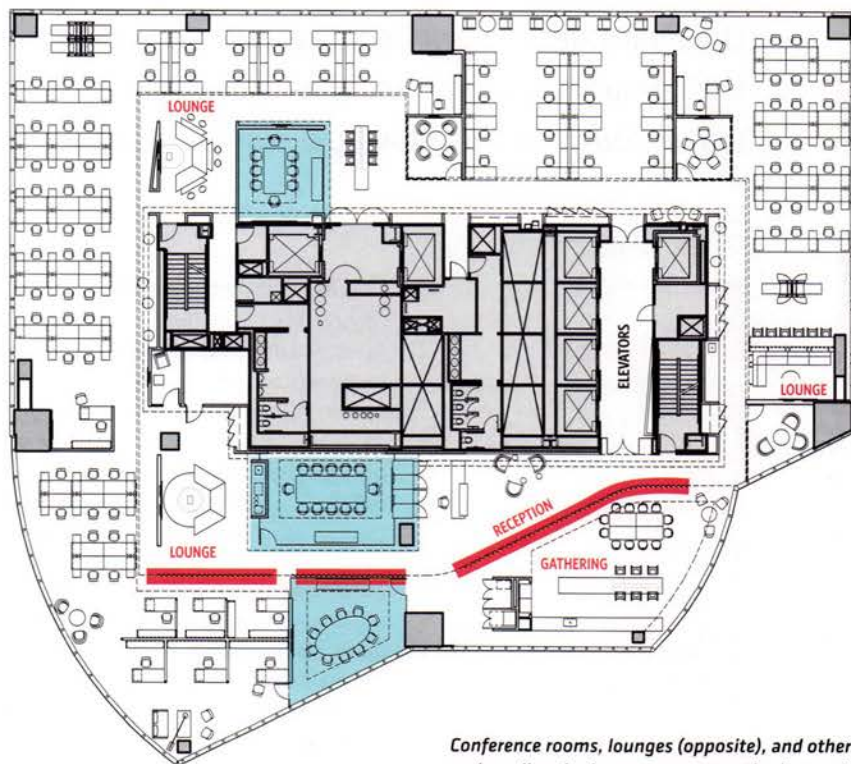

Conference rooms, lounges (opposite), and other large and small gathering spaces are mostly clustered around the building core, allowing the workstations to enjoy the light and views around the perimeter.



Creative aspirations find analog expression on the Post-it Note wall (above), where employees place their handwritten goals and accomplishments. The large cafe space (right) can be separated from the reception area with metal coil drapery.



DESIGNER BILL LYONS, ASSOC. AIA

"The workspaces needed to attract and retain the best talent, all while integrating and reinforcing the company's brand from the elevator all the way through to the individual workstations."

OUTSELL

Location:
Minneapolis, Minnesota

Client:
Outsell

Architect:
Gensler
www.gensler.com

Design team:
Bill Lyons, Assoc. AIA;
Betsy Vohs, Assoc. AIA;
Courtney Armstrong;
Jason Hall; Amy Barthel;
Kate Levine, AIA;
Mark Spencer, AIA

General contractor:
Gardner Builders

Size:
18,000 square feet

Completion:
September 2012

Photographer:
Jasper Sanidad

The first thing employees and clients encounter when they exit the elevator is a long wall on which red and gray communication symbols ranging from smoke signals, Morse code, and carrier pigeons to TVs, iPads, and emoticons spell out "TRANSFORM." "Because we're engaging consumers through digital marketing software," says Wethington, "we're transforming the way our clients engage with their consumers."

There's also a low-tech, 25-foot-long Brand Experience Wall in the reception area, with 2,200 black-and-white wood blocks that staff can arrange to create client logos, messages, or mission statements. "We're a tech company with a lot of tech in our space," says Wethington. "But I had to convince our management team not to fill the reception wall with TV screens" and go instead with the "analog" message board.

Gensler placed meeting areas, the cafe (which can be closed off with metal coil drapery), shared support spaces, and collaboration spaces—all nodes for interaction—along the main circulation path around the building's core.

>> continued on 57



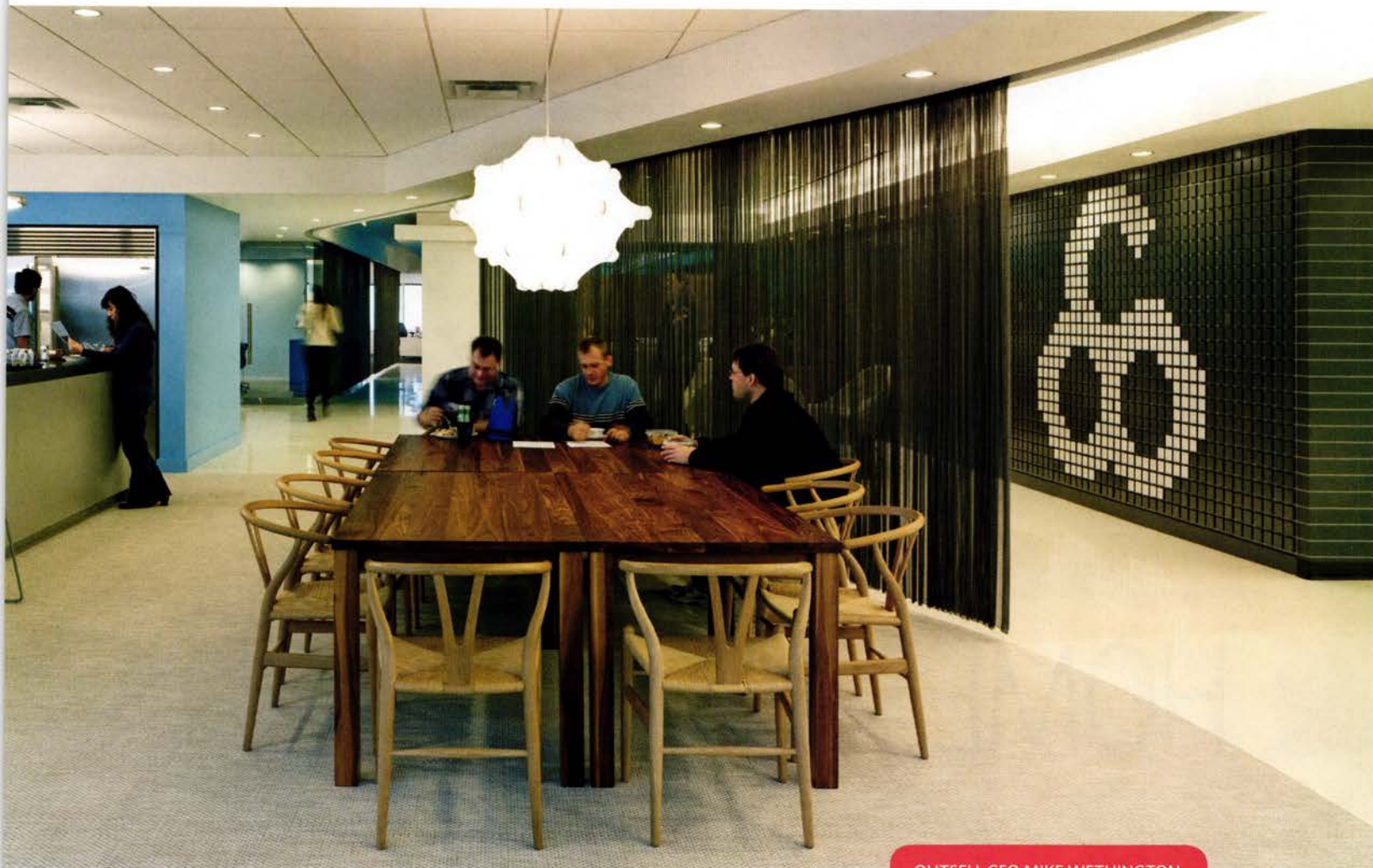

OUTSELL CEO MIKE WETHINGTON



A work environment for young creatives wouldn't be complete without a few treadmill workstations. At Outsell, they're in high demand.

"We're a tech company with a lot of tech in our space. But I had to convince our management team not to fill the reception wall with TV screens."

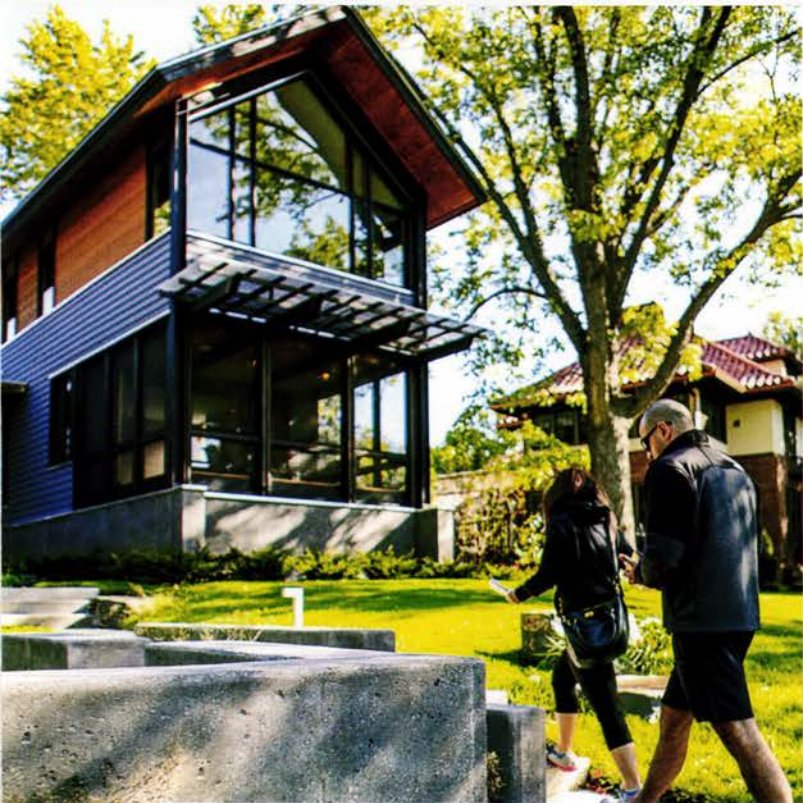

"As architects, we most often communicate design ideas with drawings and 3D models. This tour allows us to share design principles, concepts, and details in a finished space. It's an invaluable opportunity for architects and tour-goers alike."

—Architect Rosemary McMonigal, AIA

HOMES *by* ARCHITECTS

2014 TOUR



PHOTOS: BRANDON STENGEL, ASSOC. AIA/
FARMKIDSTUDIOS.COM, UNLESS NOTED

"Tour-goers have the chance to experience two days of private residences inside and out, talk to the people who made them happen, and be inspired by the amazing variety and creativity of Midwestern houses." —Architect Mark Larson, AIA



Rehkamp Larson Architects' Mark Larson, AIA (left), chats with a 2013 tour-goer. His firm participates in the tour nearly every year.



Architect Charles Stinson, AIA (above), says that, of the several home tours he's participated in, Homes by Architects offers the most design quality and variety.



Come for the design, stay for the conversation.

At AIA Minnesota's annual home tour on **September 20 and 21**, you can talk with the architects at every location.

Want to know how they created distinct living spaces in that open environment? Or how they balanced privacy and views? Or where they got the inspiration for that unexpected material choice? Just ask. You'll find that architects enjoy these questions—and that their ideas about home speak volumes.

"Having a house on the tour and getting to see people experience the design for the first time—and then hearing them talk about all the other great homes they've visited—is so enjoyable. It's a welcome reminder of why we do what we do."

—Architect Charles Stinson, AIA



Eco-minded architect Sarah Nettleton, AIA (above), had a popular stop on last year's tour.

2313 Essex Road, Minnetonka, MN

5



TEA, ARCHITECTS



TROY THIES PHOTOGRAPHY

14

5340 West Lake Nokomis Parkway, Minneapolis, MN

"The tour is a great way for people to see a variety of problem-solving techniques architects use. Restrictions are turned into opportunities and problems are solved in beautiful, seemingly effortless ways." —Architect Ashley Mitlyng, AIA



JOHN MAGNOSKI PHOTOGRAPHY

4

435 Carpenter's Point Road, Wayzata, MN



7

5616 Woodcrest Drive, Edina, MN



9

3407 West 28th Street, Minneapolis, MN

HOMES BY ARCHITECTS



AIA Minnesota

A Society of The American Institute of Architects

Saturday,
September 20

and

Sunday,
September 21

10 A.M. to 5 P.M.

Tickets for the entire tour can be purchased for \$15 online at homesbyarchitects.org until September 19 or at any home during the tour for \$20. Tickets for a single-home visit are \$10.

GREG PAGE PHOTOGRAPHY



10

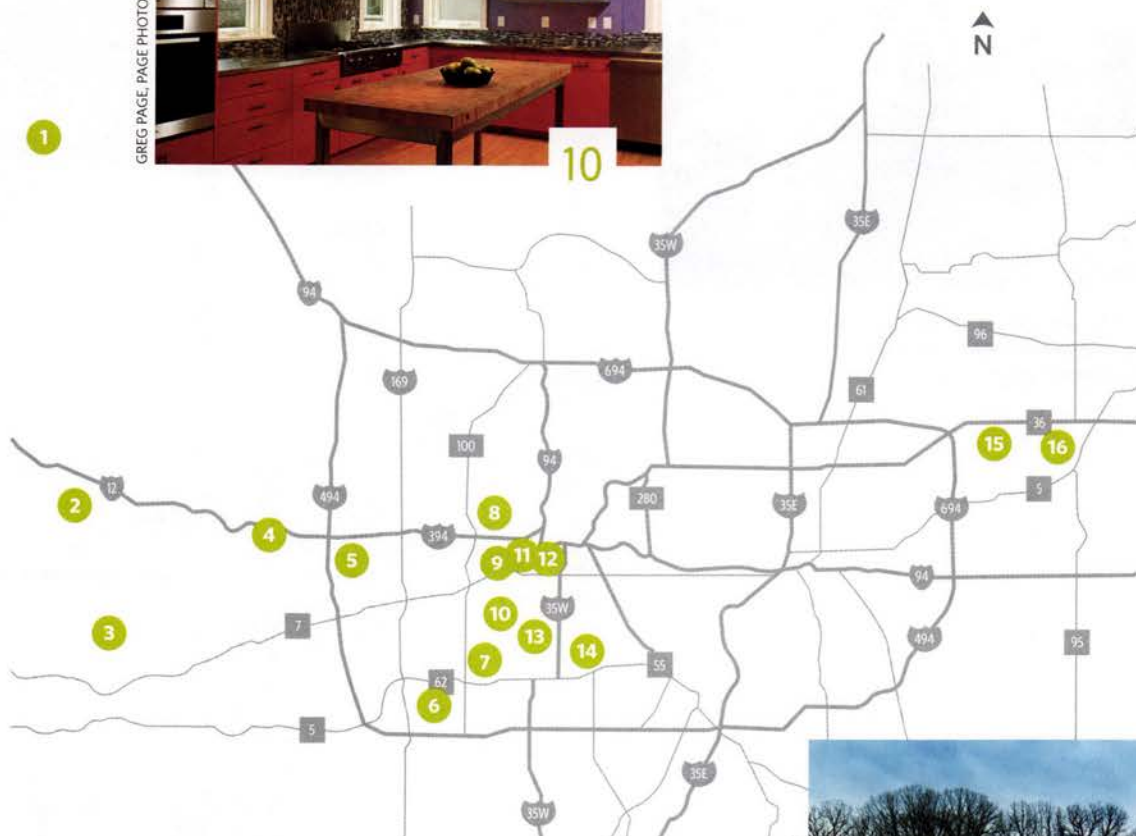

TROY THIES PHOTOGRAPHY



16

2014 HOMES BY ARCHITECTS TOUR LOCATIONS

- 1** 418 Halsey Avenue Southeast
Buffalo, MN 55313
Charles R. Stinson
Architecture + Design
Design team: Charles R. Stinson, AIA;
Kim Streeter; Douglas Fletcher
charlesrstinson.com

- 2** 5754 Watertown Road
Independence, MN 55359
CityDeskStudio, Inc.
Design team: Bob Ganser, AIA;
Ben Awes, AIA; Nate Dodge
citydeskstudio.com

- 3** 27780 Island View Road
Shorewood, MN 55331
Partners 4, Design
Design team: John B.A. Idstrom II,
AIA; David Ostreim, AIA; Nicole Sirek
partners4design.com

- 4** 435 Carpenter's Point Road
Wayzata, MN 55391
SKD Architects, Inc.
Architect: Steve Kleineman, AIA
skdarchitects.com

- 5** 2313 Essex Road
Minnetonka, MN 55305
TEA₂ Architects, Inc.
Design team: Dan Nepp, AIA; Steve
Nordgaard, AIA; Janet Lederle, Assoc.
AIA; Ruth Foster, Assoc. AIA
tea2architects.com

- 6** *Featured on page 44*
6990 Tupa Drive
Edina, MN 55439
Peterssen/Keller Architecture
Design team: Lars Peterssen, AIA;
Carl Olson, Assoc. AIA; Gabriel Keller,
Assoc. AIA; Brent Nelson, Assoc. AIA
pkarch.com

- 7** 5616 Woodcrest Drive
Edina, MN 55424
SALA Architects, Inc.
Design team: Eric Odor, AIA;
Chris Meyer, AIA
salaarc.com

- 8** 9 Meadow Lane
Golden Valley, MN 55422
Peterssen/Keller Architecture
Design team: Ryan Fish, AIA; Lars
Peterssen, AIA; Jason Briles, Assoc.
AIA; Gabriel Keller, Assoc. AIA;
Brent Nelson, Assoc. AIA
pkarch.com

- 9** 3407 West 28th Street
Minneapolis, MN 55416
Sicora Design/Build
Design team: Ashley Mitlyng, AIA;
Mark Mednikov; Allison Landers
sicora.com

- 10** 3821 Zenith Avenue South
Minneapolis, MN 55410
McMonigal Architects, LLC
Architect: Rosemary McMonigal, AIA
www.mcmonigal.com

- 11** 2565 Burnham Road
Minneapolis, MN 55416
RoehrSchmitt Architecture, LLC
Design team: Michael Roehr, AIA;
Chris Schmitt, AIA
roehrschmitt.com

- 12** 2721 East Lake of the Isles Parkway
Minneapolis, MN 55408
David Heide Design Studio
Design team: Mark Nelson, AIA;
David Heide, Assoc. AIA
dhdstudio.com

- 13** 4631 Humboldt Avenue South
Minneapolis, MN 55419
SALA Architects, Inc.
Architect: Paul Hannan, AIA
salaarc.com

- 14** 5340 West Lake Nokomis Parkway
Minneapolis, MN 55417
Building Arts Sustainable
Architecture + Construction, LLC
Architect: Harvey E. Sherman, AIA
building-arts.net

- 15** 5277 Jamaca Avenue
Lake Elmo, MN 55042
Ispiri Design-Build
Design team: Gregg Graton, AIA;
Joseph Robbins
ispiri.com

- 16** 11180 50th Street North
Lake Elmo, MN 55042
Rehkamp Larson Architects
Design team: Mark Larson, AIA;
Will Spencer
rehkamplarson.com

12



DAVID HEIDE DESIGN STUDIO



Howard Bolter and Linda Soranno enjoy their crisply renovated Edina home, where warm wood floors set the stage for classic furnishings.

HOME 6

Recent empty nesters convert the core of their flow-challenged 1970s home into open, comfortably modern living spaces

By Linda Mack

Before, floor-to-ceiling walls divided the main living area into four claustrophobic rooms. Peterssen/Keller Architecture unclogged the space by removing all of the walls except the one at the entryway. A new high window frames a custom chandelier. The sleek fireplace divides the living and dining rooms.



From the outside, the house with the asymmetrical gable roof on an Edina cul-de-sac could be the home of the Brady Bunch. Step inside and you'll find a setting worthy of a European design magazine. In their nine-month interior renovation of the Soranno-Bolter house, Peterssen/Keller Architecture's Lars Peterssen, AIA, and Carl Olson, Assoc. AIA, pursued a modern minimalism rare in the Midwest. Four separate rooms were opened to each other and rearranged to create a stunning, spacious living suite.

"They appreciate minimalist design and details—things architects love," Peterssen says of the clients. "We'd go there, and they'd be right there with us." The transformation is even more remarkable because it was achieved within the existing shell. The only change to the exterior was squaring off a bay window.



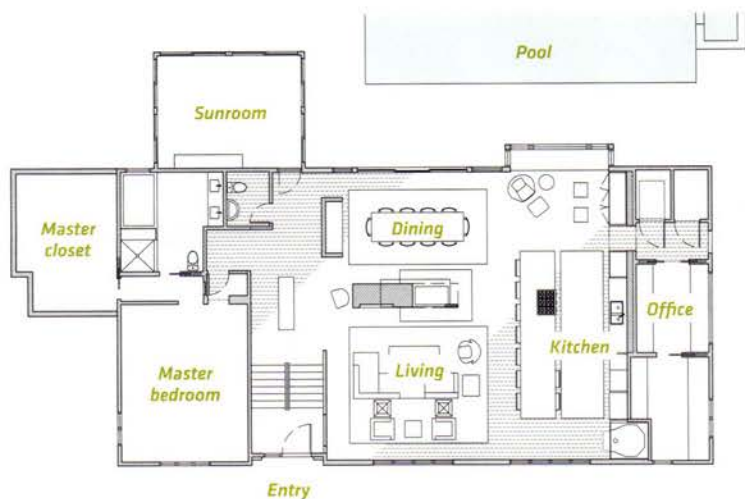

"They appreciate minimalist design and details—things architects love. We'd go there, and they'd be right there with us." —Architect Lars Peterssen, AIA



BRAEMAR HILLS MODERN

Location:

Edina, Minnesota

Clients:

Linda Soranno
and Howard Bolter

Architect:

Peterssen/Keller
Architecture
pkarch.com

Principal-in-charge:

Lars Peterssen, AIA

Project lead designer:

Carl Olson, Assoc. AIA

Interior designer:

Andrew Flesher Interiors
andrewflesher.com

General

contractor:

Streeter & Associates

Renovation size:

1,700 square feet

Completion:

April 2014

Photographer:

Karen Melvin
Photography

Feathery chandeliers soften the dining space (left), which now overlooks the backyard pool and patio. The 21-foot-long marble-topped island (right) is long enough to accommodate a buffet at one end and seating at the other. The squared-off window seat is the only addition to the house.



When they bought the house in 2004, Linda Soranno and Howard Bolter knew they would redo the main floor. The time came when their youngest went to college last September. They were clear about what they wanted: to maximize natural light. Peterssen and Olson worked with interior designer Andrew Flesher, lighting designer Michael Cohen, and contractor Streeter & Associates in an integrated process that produced a seamless design.

The existing space, which was divided into quarters with walls to the ceiling, "was very '60s and '70s," says Streeter & Associates senior project manager Bob Near. The kitchen and family room, which featured a lava-rock fireplace, were at the back of the house, facing north and east. The claustrophobic dining room and irrelevant living room were at the front. "We found ourselves living in the darkest part of the house," says Soranno.

>> continued on page 58



The pizza oven is quite an attraction for guests. It can be used for roasting and grilling as well as for pizza.





Architecture that
nourishes the
senses.

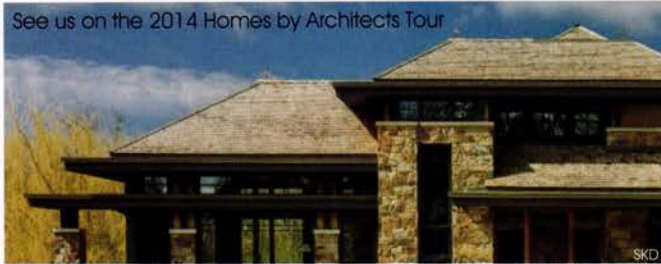

Architecture that is livable art.



Contact:
Steve Kleineman
763-591-6115
www.skdashitects.com



Why visit AIA Minnesota's re-designed website?

Contact Us

Contract Documents

Register for an event

View project images

News & Events

Firm Marketing Opportunities

Job postings

Committee information

Find an architect

Become an architect

Convention information

Board of Directors

www.aia-mn.org



AIA Minnesota

A Society of The American Institute of Architects





WWW.GAFFERPHOTOGRAPHY.COM



REHKAMP LARSON ARCHITECTS INC.
www.rehkamlarson.com 612.285.7275



TRUE CRAFTSMEN. TIMELESS QUALITY.



www.stonwerk.com

On the Horizon

<< continued from page 15

a hip hair salon and gallery in a former car wash, and a Super America with bulletproof glass at the registers. But perhaps that won't always be the case. Developers like Magellan know that if you build at a big enough scale, you can change the neighborhood over time. With new tenants come new stores, higher property values, and a cycle of more investment. The bright little buildings and strip malls often go away. That's been the story of the gentrification of Chicago for years, and now it's also unfolding in Minneapolis and other smaller cities.

SCALE AND BALANCE

Can residential high-rises such as LPM Apartments and the Nic on Fifth (a downtown Opus project also slated to open this year) help to build a 24-hour downtown? Can they add to the city skyline with a scale that makes sense? I suspect that LPM will contribute to our urban vitality, especially if downtown and its surroundings build at other scales too. No matter how many new luxury residential projects come out of this current development wave, we still need housing options for other income levels, better transit, and affordable rents for privately owned stores.

Now that downtown's population is growing again and nearing 40,000—the goal of the Downtown 2025 Plan is 70,000—we need to think of our city's center not just as a soaring, compact core but as a collection of small neighborhoods, possibly linked by streetcars, each with its own charm and housing choices. That's how it was a century ago when Elliot Park, Loring Park, and Nicollet Island each established its distinctive residential character.

Large-scale towers can work, but only if we also build with and preserve foreground human scale and street life. LPM is a striking new piece on the downtown chessboard, yet it's also part of a much larger game. Despite the hype, luxury towers alone do not attract the coveted creative class from the coasts. The ultimate draw is a rich world of walkable, diverse, and character-filled neighborhoods beyond the front door. **AMN**

Twin Cities Habitat for Humanity



CONGRATULATIONS GENSLER!
Winner Contract Magazine Inspiration Award for
"Social Responsibility in Commercial Interior Design
to improve Quality of Life for those in need".

www.gausman.com
Twitter@gausmanmoore

**Gausman
& Moore**
Mechanical and Electrical Engineers

Exceptional client service. Intelligent engineering.

MORGAN SHEFF PHOTOGRAPHY



WWW.MORGANSHEFFPHOTOGRAPHY.COM | 651.283.9801

BIGELOW CHAPEL AT THE UNITED THEOLOGICAL SEMINARY | NEW BRIGHTON, MN | HGA



SARAH NETTLETON ARCHITECTS
architecture & landscape design

www.sarahnettleton.com



ESG Architects & Doran Companies | The Knoll

Brandon Stengel | 612-750-1337 | www.farmkidstudios.com

Madison Central Library



MSR

Architecture
Interiors and
Urban Design

msrdesign.com

"Welcome to a new library. Not just a downtown institution that's been renovated, renewed, and expanded.... But a whole new concept in libraries. ...Gone is the cramped and dismal interior of the library's predecessor, replaced with a sense of spaciousness and natural light."

—*Wisconsin State Journal*

Street Artist

<< continued from page 20

to the larger community, and it increases cultural understanding. Teaching people how to grow or cook or source healthy food increases public health, which impacts every part of our city, from infrastructure to safety to quality of life."

St. Paul's charter mandates that artists be included in the planning and decision-making process for every element of infrastructure and development. "We believe that art is essential to the health of the city," says Podas-Larson. "When we invest in public spaces, we tend the very spirit of the city."

Community engagement also eases neighborhood concerns about outside forces imposing change. Jones says his grandparents lived in the nearby Rondo neighborhood, which was torn apart by the construction of I-94. "With the new Green Line, we've needed to have conversations with the community and include them in planning, so we don't leave scars," says Jones, whose work has been integrated into city structures, municipal spaces, transit, and even stormwater management systems. "I grew up in a big, loving family of artists who were also dining-room porters, clerks, letter carriers, teachers, steel workers. They taught us to love community, be involved in social clubs, better ourselves and our communities. I am fortunate to be able to engage my community through art." **AMN**

Vertical Integration

<< continued from page 28

of the brother who occupies it," says Soranno. Jim Pohlads office showcases his interest in art and modern furnishings. Bob Pohlads office is more traditional, with blue wall fabrics and more wood. In contrast, Bill Pohlads office runs River Road Productions and has produced films including *Brokeback Mountain* and *Twelve Years a Slave*, had the walls of his office painted with song lyrics and the floor covered with wooden blocks.

But it's the public spaces that have become the most talked-about areas. People meet on the stair. They wave through the glass when they pass a conference room or office. They forgo lunch at their desks for a sandwich in the cafe, which overlooks the diamond at Target Field, the home of the Twins.

"People have reacted very positively," says Colianni. "If a physical space can change human interactions, well . . . this one definitely has." **AMN**

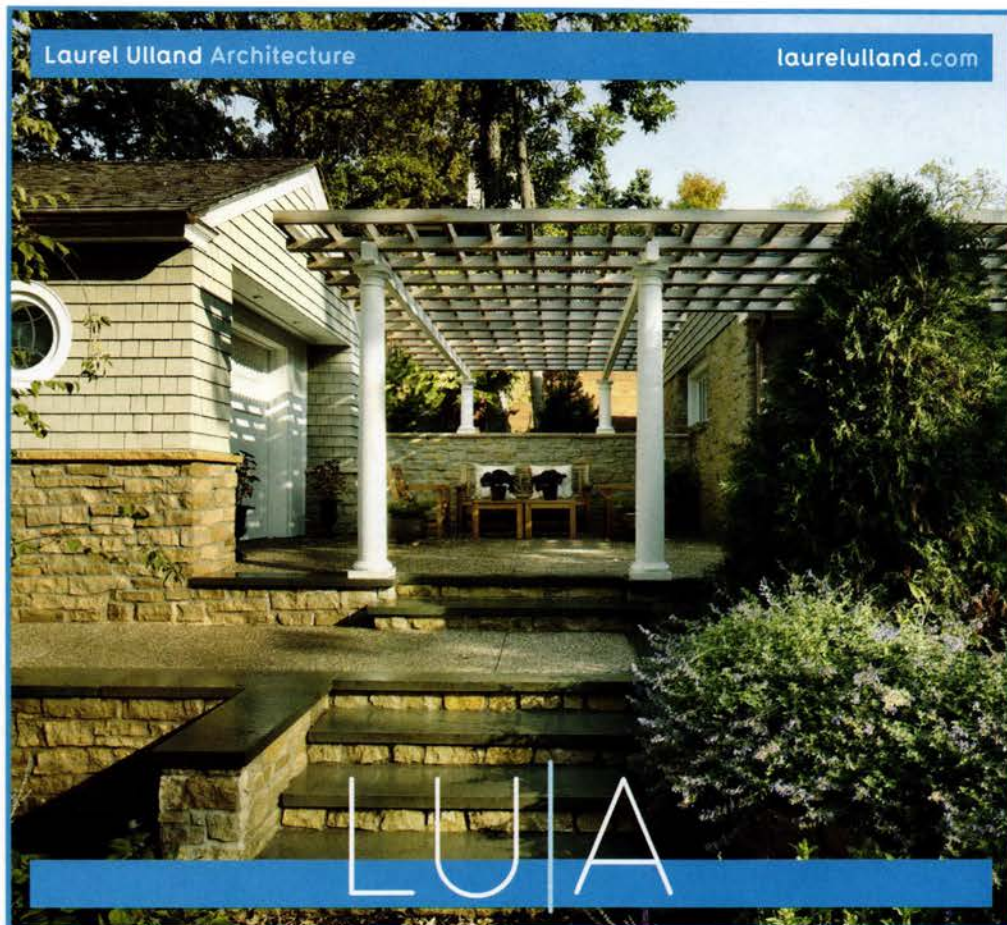

NOTE WORTHY

Orchestra Hall - Minneapolis

THEATRE PLANNERS
LIGHTING DESIGNERS
Schuler Shook

Chicago Minneapolis Dallas Melbourne
schulershook.com

Advertise here.

Reach your audience in our upcoming issues.

NOVEMBER/DECEMBER ISSUE

**Modern Libraries &
Healthcare Projects**

Including the Directory of General Contractors

JANUARY/FEBRUARY ISSUE

**Collegiate &
Multifamily Housing**

Including the Directory of Consulting Engineers

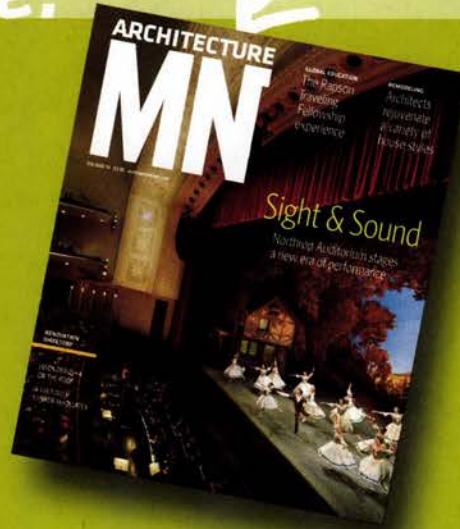

For more information, please contact:

Pam Nelson (612) 338-6763 nelson@aia-mn.org



driven by your
vision

CAMPBELL MITHUN

GENERAL CONTRACTING
CONSTRUCTION MANAGEMENT
DESIGN/BUILD
PRE-CONSTRUCTION

952-837-8600
RJMConstruction.com



Historic Park Inn

"Last Remaining Frank Lloyd Wright
designed and built hotel in the world"

- Park View/Suites
- Spa Packages
- 8000/sq. Ft. of Meeting/space
Including a Wine Room
- 2400 sq ft Ballroom Perfect for
Destination Weddings

1910
LOUNGE

- Monday-/aturday

1910
GRILLE

- Tuesday-/aturday

- Ask About the Chef's Table
or Our Balcony/eating

Listed in the National Registry of Historic Places



historicparkinn.com
7 West/ate/street
Mason City, Iowa 50401

Reservations: 800.659.2220

Design Procedure

<< continued from page 31

along the perimeter. In the main office space, six-foot-high cubicles were replaced with four-foot-high cube walls, making the large room more open and inviting.

The signature feature of the space is an acoustic shell whose elliptical shape broadly mimics a cutaway view of an artery. The curved edges of the shell are laser-cut aluminum. The shell was a creative and economical way to give the interior space a strong character—something the client wanted—while still addressing the demanding technical needs of other program areas.

"We have R&D, manufacturing, a clean room. We have shipping, packaging, offices. We have all the functions under one roof. So, we thought, how can we lay this out so it's not like every other building?" he says. After the building was gutted, the lab space was created in the center of the building. That allowed everything to flow from that core.

With a dramatic feature like the acoustic shell, you may think of a visionary architect having to fight to keep it in the design. But Bayer saw Architectural Alliance's idea for the shell as an important symbol and worked hard to bring it to life. "Any time you start putting curves into a building, the price goes up," says Dupree. "But upper management loved the idea of the artery, so we made it work."

The extensive use of natural lighting, as well as water management systems and recycled materials, helped the 64,000-square-foot renovation earn LEED certification. From start to finish, the project took roughly 18 months and cost \$8 million.

The building is a hit with employees; in a survey conducted about a month after completion, they gave the design high marks. Features such as informal group meeting rooms under the skylights make it an easy space to live in, and the company also invested in well-designed and space-efficient office furniture.

"The impression it provides is phenomenal—the way it meets and greets our customers," says Dan Janse, Bayer's national training manager, who often has doctors and other professionals in for days at a time to learn about the company's technology.

"It was a fun project," says Dupree. "A really great piece of work." **AMN**



Its Just Water Without Us

Providing:

Concept Development & Budgeting Assistance
Consultation
Engineering & Construction Document Services
Single Source- Design / Build Services



Specializing in The Complete Fountain

Structure
Waterproofing
Finishes
Mechanical Systems
Electrical & Control Systems

Contact gstoks@caqua.com
for a complimentary conceptual
design & budgetary analysis.



877.632.0503 | www.fountaindesigns.com

Northwest Architectural Archives

AT YOUR SERVICE...

We are the Northwest Architectural Archives. And we're here to help you.

Are you an architect searching for original building plans? Or perhaps you're a preservationist seeking information to save a historic building?

Either way, we can help!

We are known for our extensive collections of materials and broad range of building types and architectural styles that span over 150 years.

lib.umn.edu/scrbm/naa



UNIVERSITY OF MINNESOTA

LIBRARIES

Archives and Special Collections



HOME #7

ON THE HBA TOUR.

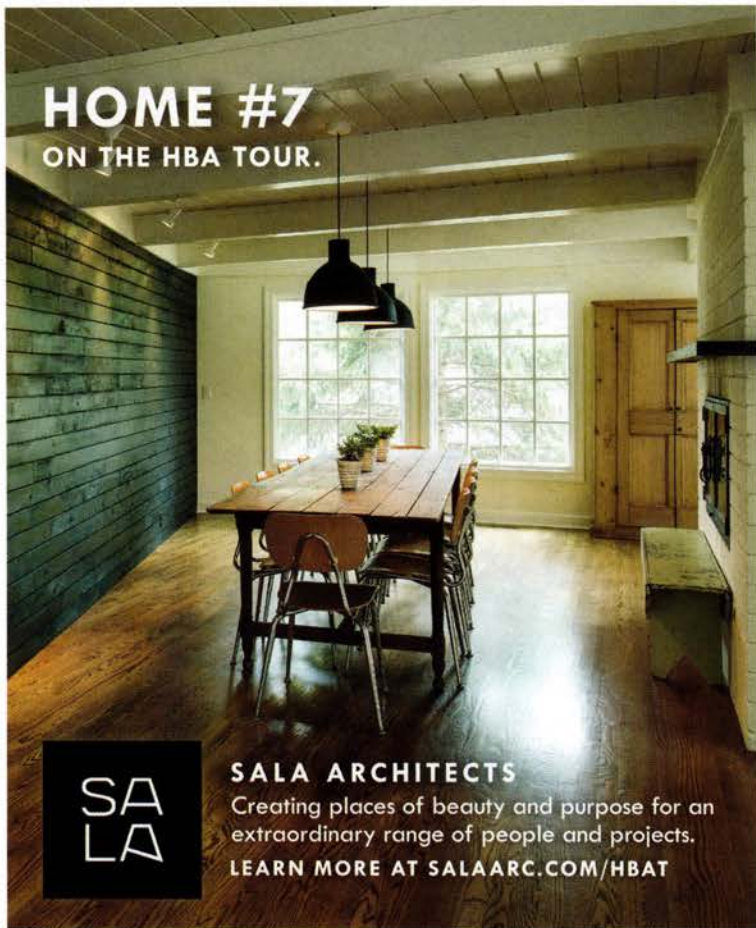

SALA

SALA ARCHITECTS

Creating places of beauty and purpose for an extraordinary range of people and projects.

LEARN MORE AT SALAARC.COM/HBAT

HOME #13

ON THE HBA TOUR.



SALA

SALA ARCHITECTS

Experience two SALA homes on the Homes By Architects Tour September 20-21.

LEARN MORE AT SALAARC.COM/HBAT

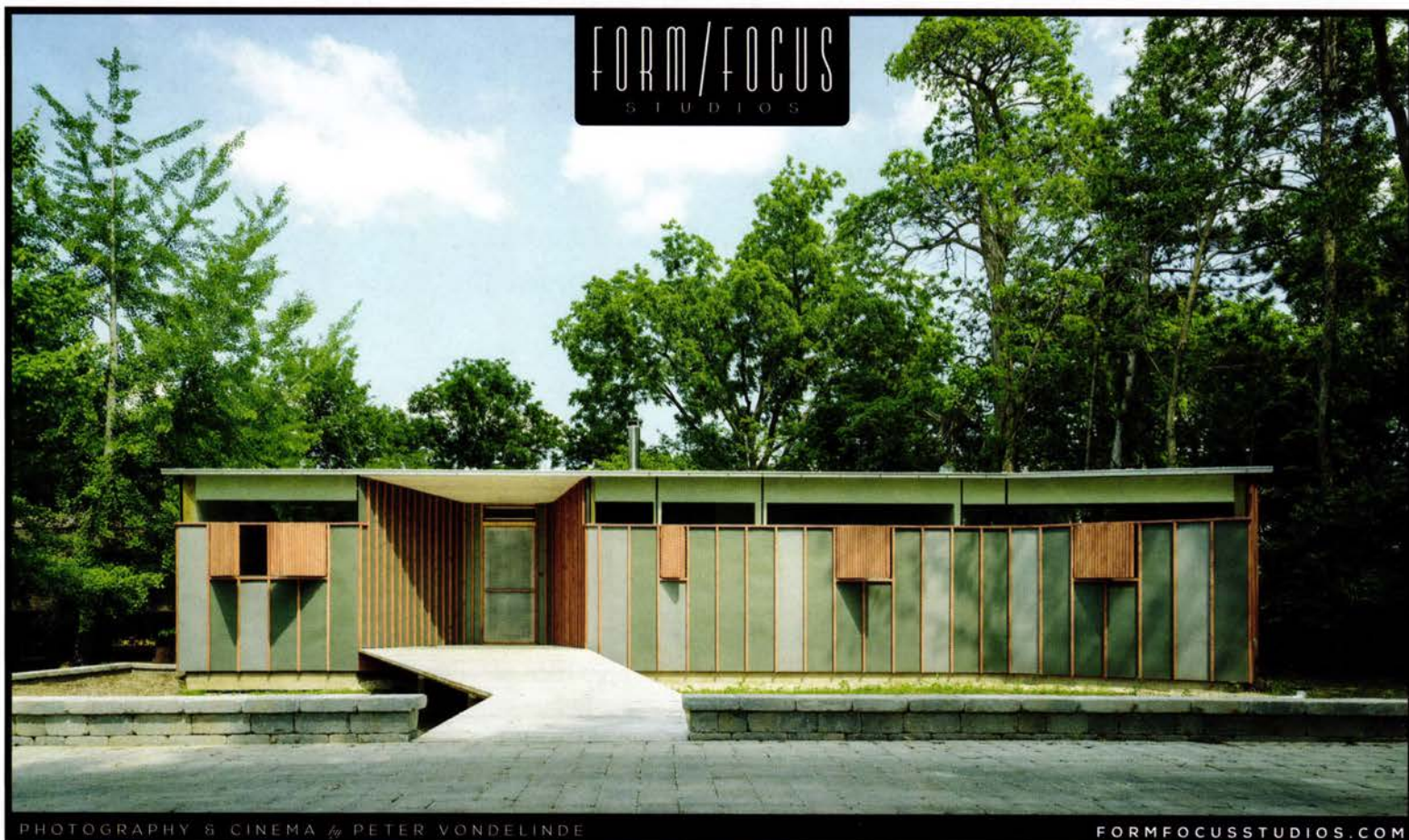

FORM/FOCUS
STUDIOS

PHOTOGRAPHY & CINEMA by PETER VONDELINDE

FORMFOCUSSTUDIOS.COM

mono space

<< continued from page 34

Creativity is also often fueled by food, so mono devoted a large area to a kitchen where employees can meet, make meals, and gather for Monday meetings. A 40-foot-long table formed from a single western hemlock dominates the space. Lazor hand-finished the piece himself. "Cooking is vital to the life of this place," he says.

The designers also used wood to soften the interior, infusing the space with some of the character employees had come to love about their old warehouse offices. They created conference rooms at two corners of the floor by stacking timbers like a child's set of Lincoln Logs. "It's the simplest form of building," notes Lazor. "You just take rough-sawn timber, stack it, screw down through the corners, and repeat." Glass between the logs helps block sound from the larger workspace. Sliding barn doors, painted the same blue hue as the mono logo, complete the rustic-modern enclosures.

Hart says the new space has made a big impression on people while promoting the company's desire for transparency, flat structure, simplicity, and egalitarianism. "You can understand how we work—our philosophy, our approach to work, and our cultural vibe—almost within seconds of walking into the space." **AMN**

The Writing on the Wall

<< continued from page 38

All employees have a cube, including Wethington, but most work happens in the collaboration areas—or on the popular treadmill workstations.

All of the workspaces overlap, just like the circles in Outsell's logo. And speaking of brand identity, Gensler used punches of blue, red, and yellow throughout the floor to "bring this classic modern design together with Outsell's brand colors," says Gensler senior associate Betsy Vohs, Assoc. AIA.

Then there's Bart's Room, a glassed-in space named after Wethington's former business partner, where technology is expressly prohibited. In fact, there's a \$100 fine if you're caught. The room, says Wethington, "is for people to meet and talk face to face." And maybe relax in the red Saarinen Womb Chairs? "That doesn't happen much around here," he says with a smile. **AMN**

A Masterpiece For Music

More than 14,000 sq. ft. of porcelain ceramic tile and 20,000 sq. ft. of honed and thermal finished stone add to the striking visual palette of the newly-renovated Orchestra Hall lobby. Gathering areas, stair treads and ramps of the multi-level space are aesthetically pleasing and easy-to-maintain.

Neutral tones of the Champagne Mist floor tile complement the distinctive brick auditorium wall, stone service counters and other interior design elements. It's a dramatic and revitalized multi-level gathering space for concert patrons.

JOB
Orchestra Hall
Addition and Remodeling
Minneapolis

OWNER
Minnesota Orchestra
Minneapolis

CONTRACTOR
M.A. Mortenson Co.
Minneapolis

ARCHITECT
KPMB Architects
Toronto

STRUCTURAL ENGINEER
MBJ
Minneapolis

TILE CONTRACTOR
Grazzini Brothers
& Company
Eagan

TILE/MATERIAL SUPPLIERS
Cold Spring Granite,
Dal-Tile,
Stone Tile International,
Terrazzo Marble Supply



Our skilled craftworkers install ceramic tile and stone products in commercial architecture and interior design applications.



Stop traffic with your brand, too.

Let Rubin Cordaro take your architectural vision to a whole new level of visibility.

- Award-winning graphic design
- 30 years of industry experience
- Smart solutions for your branding challenges

**Rubin
Cordaro
Design**

rubincordaro.com
612.343.0011

Home 6

<< continued from page 47

Soranno and Bolter also wanted a gathering place. “We both love to cook and entertain, and everyone always gravitates to the kitchen,” says Soranno. When the designers drew the living area at the front of the house, moved the dining room to the back, and joined the two with an open ceiling and a 21-foot-long kitchen island, the clients knew it was right.

The sense of space is exhilarating. A flat ceiling defines the nearly house-long kitchen, which ends in a boxy bay window overlooking the backyard and pool. The gable roof soars up from the unobstructed kitchen edge to the highest point at the entry hall. All that separates the living room from the dining space is the rectilinear fireplace and its simple, sculptural chimney. Supporting the entire space is one narrow steel post on one side of the gunmetal-steel and Venetian-plaster fireplace.

The balance of openness and enclosure is masterful. “It’s all very open, but there are very discrete areas,” says Soranno. “The window seat in the bay window, for instance, is a wonderful little nook for reading and relaxing.”

The island—of the pure white Calacatta marble that Michelangelo preferred—is the project’s pow-bang. Long and broad enough to accommodate cooking and studying, a buffet at one end and hors d’oeuvres at the other, “the island isn’t an island—it’s a continent,” says Streeter’s Near. Softened by the cerused walnut cabinets underneath and paired with an even longer wall of glossy white cabinets and appliances, it serves as anchor, centerpiece, and sculpture.

“We use it every day, in very different ways,” says Soranno.

It’s especially a hangout when the family’s pizza oven is in use, for roasting an Easter dinner or grilling salmon and vegetables. Soranno’s brother John, who owns Punch Pizza, insisted they get the oven. “We haven’t used it for pizza yet, but we will!” says Soranno.

Seven years ago, the couple regraded the backyard and installed a pool with a stone wall and patio. Now, with new windows on the back and the living space unlogged, the backyard view infuses the whole house.

Minimal yet warm, sleek but softened by textures and a play of neutrals, formal but suited for informal living, the Soranno-Bolter house makes the most of modernism. **AMN**



Building Our Future,

Clarence Wigington Minority Scholarship

Congratulations to the 2014 scholarship graduates, Vanessa Abin-Fuentes and Namdi Alexander!



The Clarence Wigington Minority Architectural Scholarship, created in 1992, provides tuition scholarships to minority students pursuing a professional degree in architecture at the University of Minnesota.

Making A Difference.

To make a donation go to: www.aia-mn.org/foundation

AKF

612.354.2442
www.akfgroup.com

Engineering • Commissioning • Testing • Technology • Sustainability • Lighting

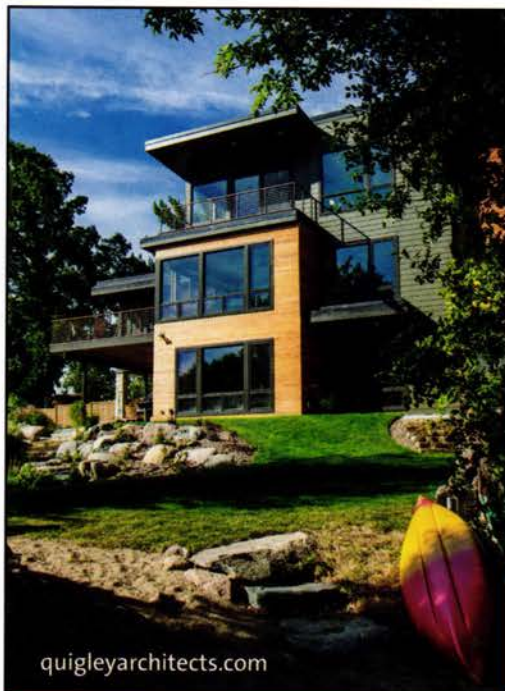

quigleyarchitects.com



**QUIGLEY
ARCHITECTS**

Add On | Build New

612.692.8850



www.chadholder.com

**CHAD HOLDER
PHOTOGRAPHY**

DIRECTORY

INTERIOR ARCHITECTURE FIRMS

The firms listed on the following pages include design professionals, members of the American Institute of Architects Minnesota (AIA Minnesota), who offer a broad range of architectural, space planning and interior design services. Each firm has special areas of expertise and project competence with capabilities ranging from homes to corporate headquarters, from hospitals to schools, restaurants to retail facilities, justice facilities to libraries, etc.

Contact these firms to discuss your specific project needs.

Legend

AIA	Registered Member, American Institute of Architects
Associate AIA	Associate Member, American Institute of Architects
ACHA	American College of Healthcare Architects
AICP	American Institute of Certified Planners
ASID	American Society of Interior Designers
CCS	Certified Construction Specifier
CDT	Construction Documents Technology (Certified)
CFM	Certified Facility Manager
CID	Certified Interior Designer
FAIA	Fellow, and Registered Member of the American Institute of Architects
IFMA	International Facilities Management Association
IIDA	International Interior Designers Association
LEED	Leadership in Energy and Environmental Design
LEED AP	Leadership in Energy and Environmental Design Accredited Professional
PE	Professional Engineer
RA	Registered Architect
*	Associate Owned Firm

ARCHITECTURAL ALLIANCE + 20 BELOW

ARCHITECTURAL ALLIANCE + 20below

400 Clifton Avenue
Minneapolis, MN 55403
Tel: (612) 874-4100
Fax: (612) 874-7212
Email: thysell@archalliance.com
www.archalliance.com
Other Offices: Minneapolis-St. Paul International Airport, St. Paul, MN; San Diego, CA
Contact: Tom Hysell

Firm Principals

Carey Brendalen, AIA, LEED AP
Thomas DeAngelo, FAIA, LEED AP
Joe Hamilton, AIA, CID
Mamie Harvey, AIA, LEED AP BD+C
Tom Hysell, AIA, LEED AP BD+C
Heather Rose-Dunning, IIDA, LEED AP
Eric Peterson, AIA, LEED AP
April Meyer, NCIDQ, LEED AP

We are specialists in using design to engage our clients. We unite people and place through design - through our vision, our leadership, technical expertise, and integrity. Our clients rely on us to provide them with effective and innovative solutions - including the workspace, public, civic, science and technology, lifestyle, and aviation environments. Our unique discovery and planning perspective fully integrates interior architecture and design throughout our project process to provide memorable, people-centric environments.

Representative Projects

Lindquist & Vennum, Planning and Strategic Services, Minneapolis, MN; Syngenta Biotechnology Headquarters, R&D, and Office Environments, Research Triangle Park, NC; 6Smith Restaurant, Bar, and Rooftop Deck, Wayzata, MN; Patterson Companies Alternative Workplace Pilot, Mendota Heights, MN; MBJ Structural Engineers' Office Repositioning and Relocation, Minneapolis, MN; LPM Luxury Apartments' Public and Amenities Spaces, Minneapolis, MN; Pine River and Two Harbors Investment Corporation, Plymouth, MN; Libertine Restaurant, Bar, and "Pop-up" Dining, Minneapolis, MN

BDH+YOUNG INTERIORS | ARCHITECTURE



7001 France Avenue South, Suite 200
Edina, MN 55435
Tel: (952) 893-9020
Fax: (952) 893-9299
Email: info@bdhyoung.com
www.bdhyoung.com
Contact: Kim Dennis | Jill Brecount

Firm Principals

Kim Dennis, CID, IIDA, LEED AP ID+C
Jill Brecount, CID, LEED AP ID+C
Darcy Hield, CID
Patrick Giordana, AIA

We are a client-focused, full service Architectural + Interior Design firm bringing an innovative + collaborative experience to every project. We truly listen to your vision, goals + objectives and are dedicated to our clients. bdh+young provides comprehensive architectural, interior design + space planning service for a wide range of project types + settings.

Representative Projects

CliftonLarsonAllen, Multiple Locations; Helene Houle Medical Center, Vadnais Heights, MN; Lime Apartments, Minneapolis, MN; Minnetonka Medical Center, Minnetonka, MN; The Terraces by St. Therese SW, Hopkins, MN; Tunheim, Minneapolis, MN; North Memorial Healthcare, Minnetonka, MN; Children's Hospitals and Clinics of Minnesota, Multiple Locations

BENTZ/THOMPSON/RIETOW, INC.

801 Nicollet Mall, Suite 801
Minneapolis, MN 55402
Phone: (612) 332-1234
Fax: (612) 332-1813
Email: info@btr-architects.com
www.btr-architects.com
Contact: Randy Moe or Ann Voda

Firm Principals:

Ann Voda, AIA, CID, LEED AP BD+C
Randy L. Moe, AIA, CID, LEED AP
Bob Zimmerman, AIA, CID

Our firm regards each client and every project as unique, presenting new challenges and design opportunities. Because it's where we live work and play on a daily level, Interior Architecture and Interior Design are often more up-close and personal to architects and clients alike. Believing that the client and architect are together responsible for the level of success of any project, we welcome the client as in integral part of the design team. We stress a sound, cooperative, working relationship between client and architect to achieve a superior design, a commitment to the project schedule and sticking to the clients budget.

Representative Projects

West Snarr Renovation, Minnesota State University Moorhead; Kryzsko Commons Addition & Renovation, Winona State University, Winona, MN; Ramsey County Library, White Bear Lake, MN; Hennepin County Plymouth Library, Plymouth, MN; Private Condominium @ 510 Groveland, Minneapolis, MN; IT Offices for Minnesota State Colleges & Universities, MCTC Campus, Minneapolis, MN; Energy Park Place Offices, Metro State University, St. Paul, MN; Nursing Department Renovation, College of St. Benedict, St. Joseph, MN

BWBR

B | W | B | R

380 St. Peter Street, Suite 600
Saint Paul, MN 55102
Tel: (651) 222-3701
Email: marketing@bwbr.com
www.bwbr.com
Other Offices: Madison, WI
Contact: Brian B. Buchholz, AIA, ACHA, CID

Firm Principals

Peter G. Smith, AIA
Timothy J. Sessions, AIA
John A. Strachota, AIA, LEED AP
Richard W. Dahl, AIA
Katherine J. Leonidas, AIA, LEED AP
Thomas J. Dornack, RA
Gregory E. Fenton, AIA
Don Thomas, CID

BWBR is a design solutions firm with practices in architecture, interior design, and master and strategic planning. One of the Upper Midwest's oldest and largest firms, BWBR has established a reputation for service and quality designing complex facilities in health care, higher education, corporate, justice, government, manufacturing, transportation, worship, and recreation markets. Working with organizations to leverage facility improvements for better service delivery and operations, BWBR designs solutions to enhance what people do.

Representative Projects

University of Minnesota Children's Hospital Child/Adolescent Mental Health Program, Minneapolis, MN; Mayo Clinic Dan Abraham Healthy Living Center Sports Medicine, Rochester, MN; HealthPartners RiverWay Clinics-Anoka, Anoka, MN; Gillette Children's Specialty Healthcare, Saint Paul, MN; Global Design Lab, Saint Paul, MN; Lakeview Medical Center, Rice Lake, WI; University of Minnesota School of Nursing Bentson Healthy Communities Innovation Center, Minneapolis, MN; University of Minnesota Medical Devices Center, Minneapolis, MN

**CLOSE ASSOCIATES INC.,
ARCHITECTS**



**CLOSE
ASSOCIATES, INC.**

3101 East Franklin Avenue
Minneapolis, MN 55406
Tel: (612) 339-0979
Email: gar@closearchitects.com
www.closearchitects.com
Contact: Gar Hargens, (612) 339-0979

Firm Principal

Gar Hargens, AIA, CID

Steeped in seventy-five years of Mid Century Modernism, Close Associates is also very skilled at remodeling, restoring and combining earlier styles. Owner Gar Hargens was a Saint Paul HPC Commissioner for nine years and is a registered Interior Designer. We enjoy helping reuse older buildings like the Seward Co-op, and have designed countless additions and remodelings. We work hard to help you maximize your budget.

Representative Projects

Seward Co-op Grocery & Deli renovation, Minneapolis, MN; Louis & Maude Hill House restoration, 260 Summit Avenue, St. Paul, MN; Saint John the Evangelist Church renovation, St. Paul, MN; River Towers Condominium Plaza restoration, Minneapolis, MN; Lakeside remodeling, Wayzata, MN (see website); Johnson Residence remodeling, St. Paul, MN; Cooper Foster addition, St. Paul, MN; Mann-Benson renovation-additions, Deephaven, MN

**CUNINGHAM GROUP
ARCHITECTURE, INC.**



201 Main Street SE,
Suite 325
Minneapolis, MN 55414
Tel: (612) 379-3400
Fax: (612) 379-4400
Email: hello@cunningham.com
cunningham.com
www.cunningham.com

Other Offices: Los Angeles, CA; Las Vegas, NV; Biloxi, MS; Denver, CO; San Diego, CA; Phoenix, AZ; Seoul, Republic of Korea; Beijing, China
Contact: Rebecca Martinez, Principal

Firm Principals

Timothy Dufault, AIA, NCARB, LEED AP
David Hyde, AIA
Jeffrey A. Schoenck, AIA, LEED AP
Thomas Hoskens, AIA, NCARB, LEED AP
David Solner, AIA, NCARB, LEED AP
Brian Tempas, AIA, NCARB
Chad Clow, AIA, NCARB
Margaret Parsons, AIA, NCARB, REFP, LEED AP BD+C

Awarded the AIA Minnesota Firm Award in 2013, Cunningham Group transcends tradition with architecture, interior design, urban design and landscape architecture services for a diverse mix of clients and project types. Through a client-centered, collaborative approach, our interior designers create innovative environments that offer an evolutionary perspective and provide sensitivity to the functional, social and environmental impact of each space. Founded in 1968, the firm has grown to over 275 employees in nine offices.

Representative Projects

Potawatomi Hotel and Casino, Milwaukee, WI; Radisson Hotel Interior Remodel, La Crosse, WI; Serendipity III at Caesars Palace, Las Vegas, NV; JA Nugget Casino Resort Renovation, Sparks, NV; The Walkway Apartments Lobby and Lounge, Minneapolis, MN; The Boat House, Orlando, FL; Alexandria High School, Alexandria, MN; Harrah's Gulf Coast, Biloxi, MS

**ELNESS SWENSON GRAHAM
ARCHITECTS, INC.**



500 Washington Ave
South, Suite 1080
Minneapolis, MN 55415
Tel: (612) 339-5508
Fax: (612) 339-5382
www.esgarchitects.com

architects

Firm Principals

Mark G. Swenson, FAIA, LEED AP
David L. Graham, FAIA, LEED AP
Dennis Sutliff, AIA, AICP
Art Bartels, AIA, LEED AP
Paul Mittendorf, AIA, CID, LEED AP
Aaron Roseth, Associate AIA

Since our founding, Elness Swenson Graham Architects has helped our clients create environments for business, community and leisure. Throughout our entire time, our commitment to enriching our built environment has remained steadfast. It's a commitment that drives us to go beyond the expected to deliver the superior, the timeless, the memorable and the unique; to create environments that capture the human spirit and uplift our lives. This is what we do best.

Representative Projects

Coup d'état, Minneapolis, MN; Borough Restaurant/Parlour Bar, Minneapolis, MN; Smack Shack, Minneapolis, MN; Junction Flats Apartments, Minneapolis, MN; Mill & Main Luxury Apartments, Minneapolis, MN; Dock Street Flats, Minneapolis, MN; Minneapolis Marriott Northwest Hotel & Executive Conference Center Brooklyn Park, MN; Latitude 45 Apartments, Minneapolis, MN

GENSLER *

Gensler

81 South 9th Street, Suite 220
Minneapolis, MN 55402

Tel: (612) 333-1113

Fax: (612) 333-1997

Email: betsy_vohs@gensler.com

www.gensler.com

Other Offices: Abu Dhabi, United Arab Emirates; Atlanta, GA; Austin, TX; Baltimore, MD; Bangalore, India; Bangkok, Thailand; Beijing, China; Boston, MA; Charlotte, NC; Chicago, IL; Dallas, TX; Denver, CO; Detroit, MI; Doha, Qatar; Dubai, United Arab Emirates; Hong Kong; Houston, TX; La Crosse, WI; Las Vegas, NV; London, United Kingdom; Los Angeles, CA; Mexico City, Mexico; Miami, FL; Morristown, NJ; New York, NY; Newport Beach, CA; Phoenix, AZ; Pittsburgh, PA; Raleigh-Durham, NC; San Diego, CA; San Francisco, CA; San Jose, CA; San José, Costa Rica; San Ramon, CA; Sao Paulo, Brazil; Seattle, WA; Seoul, South Korea; Shanghai, China; Singapore; Sydney, Australia; Tampa, FL; Tokyo, Japan; Toronto, Canada; Washington DC
Contact: Betsy Vohs

Firm Principal

Bill Lyons, Associate AIA, LEED AP

As architects, designers, planners and consultants, we partner with our clients on some 3,000 projects every year. These projects can be as small as a wine label or as large as a new urban district. With more than 4,200 professionals networked across 47 locations, we serve our clients as trusted advisors, combining localized expertise with global perspective wherever new opportunities arise. Our work reflects an enduring commitment to sustainability and the belief that design is one of the most powerful strategic tools for securing lasting competitive advantage.

Representative Projects

Twin Cities Habitat for Humanity, St. Paul, MN; Minneapolis Convention Center, Minneapolis, MN; Room & Board, Boston, MA; New York City, NY; Denver, CO; Loose-Wiles Building and The Freehouse, Minneapolis, MN; 3M, Maplewood, MN; Code42, Minneapolis, MN; Zelle Hofmann, Minneapolis, MN; Gaviidae Common, Minneapolis, MN

HGA ARCHITECTS
AND ENGINEERS

420 5th Street North, Suite 100

Minneapolis, MN 55401

Tel: (612) 758-4000

Fax: (612) 758-4199

Email: info@hga.com

www.hga.com

Other Offices: Rochester, MN; Milwaukee, WI; Sacramento, CA; San Francisco, CA; Los Angeles, CA; and Washington, DC

Contact: Debra Barnes, CID, IIDA, LEED AP ID+C

Firm Principals

Debra Barnes, CID, IIDA, LEED AP ID+C

Richard Bonnin

Rand Liedl, CID

Laurie Rother, CID, IIDA, LEED AP BC+C

Paula Storsteen, IIDA, LEED AP

Christine Guzzo Vickery, CID, EDAC

Recognizing the global nature of design today, HGA's team addresses the connection between an organization's strategic view and their customers. Our designs focus on understanding the unique needs of the occupants whether they be from corporate work environments, college campuses, hospitality, retail or healthcare design. We listen to our clients to understand their strategic needs and then respond with creative, flexible interior solutions that provide long-term value.

Representative Projects

Accenture, various international locations; Fairview Southdale Hospital, Emergency Department Expansion, Edina, MN; Hazelden Betty Ford Foundation, various national locations; Mayo Clinic, various national locations; Minnesota State Capitol, Interior Renovation, St. Paul, MN; Pohlad Companies, Minneapolis, MN; Surly Brewing, Destination Brewery, Minneapolis, MN; University of Minnesota, Northrop Auditorium Renovation, Minneapolis, MN

I+S GROUP (ISG)

ISG

I+S GROUP

115 E. Hickory Street, Suite 300

Mankato, MN 56001

Tel: (507) 387-6651

Fax: (507) 387-3583

Email: bryan.paulsen@is-grp.com

www.is-grp.com

Other Offices: Faribault, MN; La Crosse, WI;

Des Moines IA; Algona, IA; Sac City, IA;

Storm Lake, IA

Contact: Bryan Paulsen, AIA, CID, LEED AP

Firm Principals

Bryan Paulsen, AIA, CID, LEED AP

Chad Surprenant, PE

Staci Flemming, IIDA, CID, LEED AP

Paul Lawton, AIA, LEED AP

Brian Gjerde, PE

Lynn Bruns, PE, LEED AP

Alyssa Campbell, AIA, LEED AP

Chuck Brandel, PE

ISG's experienced and award winning architects and interior designers provide the vital link between aesthetics, function and efficiency. Our multi-disciplinary team of experts understands that each interior space plays an important, unique role in a building's overall vision and purpose. Our highly-creative designers provide space analysis, planning and integrated design solutions and are supported with the latest in digital technology to help our clients visualize a wide range of design options, sustainable strategies, and finish and furnishing choices.

Representative Projects

Mankato Public Safety Center, Mankato, MN; Coldwell Banker/Fisher Group Offices, Mankato, MN; Cannon Falls Clinic, Cannon Falls, MN; Millerbernd Manufacturing Co, Winstead, MN; Children's Museum Southern MN, Mankato, MN; Winthrop Clinic, Winthrop, MN; Mayo Clinic Health System Employee Health & Wellness Center, Mankato, MN; Massad's Mediterranean Grille, Mankato, MN

KODET ARCHITECTURAL
GROUP, LTD.

15 Groveland Terrace

Minneapolis, MN 55403

Tel: (612) 377-2737

Fax: (612) 377-1331

Email: arch@kodet.com

www.kodet.com

Contact: Edward Kodet, Jr., FAIA, LEED AP BD+C

Firm Principals

Edward Kodet, Jr., FAIA, CID, LEED AP BD+C

Kenneth Stone, AIA, CID, LEED AP BD+C

Mike Schellin, AIA

John Brandel, Assoc. AIA

Kodet Architectural Group provides a complete range of services statewide, including: architectural design, programming, master planning, cost estimating, project management, interior design, site planning, referendum assistance, feasibility studies, ADA accessibility and remodeling, historic preservation, renovation acoustics, indoor air quality, and sustainable and energy efficient design. Public design experience includes: educational facilities, libraries, parks and recreational facilities, maintenance and public works, fire stations and other community buildings.

Representative Projects

Gerald W. Heaney Federal Building Historic Restoration & Courtroom Renovation (GSA), Duluth, MN; Mn/DOT Maple Grove Maintenance Facility, Maple Grove, MN; Westwood Lutheran Church, St. Louis Park, MN; Calvin Christian School, Edina, MN; Burroughs Community School, Minneapolis, MN; Bloomington Aquatic & Recreation Center, Bloomington, MN

KRECH, O'BRIEN, MUELLER + ASSOCIATES, INC.

KRECH, O'BRIEN, MUELLER & ASSOCIATES, INC.

6115 Cahill Avenue
Inver Grove Heights, MN 55076
Tel: (651) 451-4605
www.komainc.com
Contact: Ashley Krech

Firm Principals

Brady R. Mueller, AIA, CID
James H. Krech, PE
Stephen T. Iaria, AIA
Marc. R DuBois, AIA
Matthew J. Van Hoof, PE
Michael J. Lisowski, PE
Brian L. Riley
Cindy Douthett Nagel, CID

For more than 29 years, KOMA has been creating inspiring, functional, people-oriented structures and spaces to meet the varied needs of organizations and industries. Our professional capabilities are comprehensive, offering complete architectural, structural engineering and interior design services.

Representative Projects

Oak Knoll Animal Hospital, St. Louis Park, MN; Great Clips Corporate, Edina, MN; Slurp and Snack, Mall of America, Bloomington, MN; Gopher Resource, Tampa, FL; American Dental Partners, various locations; Neuger Communications Group, Minneapolis, MN; Grey Cloud Elementary, Cottage Grove, MN

LEO A DALY

730 Second Avenue South, Ste. 1100
Minneapolis, MN 55402
Tel: (612) 338-8741
Fax: (612) 338-4840
Email: info@leoadaly.com
www.leoadaly.com
Other Offices: CA, CO, FL, GA, HI, NE, NV, TX, China, Russia, Saudi Arabia, Turkey, UAE
Contact: Ted Redmond, AIA

Firm Principals

Ted E. Redmond, AIA
William M. Baxley, AIA
Randy S. Gould
James G. Sokolowski, PE
Tim Bauer
Jeremy Klysen, PE
Cindy McCleary, AIA

Established in 1915, LEO A DALY is an international architecture, planning, engineering, and interior design firm. The company's portfolio includes award-winning projects in 75 countries, all 50 states and the District of Columbia. LEO A DALY currently employs approximately 1,000 architects, planners, engineers and interior designers in over 30 offices worldwide.

Representative Projects

Toro R&D Facility Expansion, Bloomington, MN; City of Forest Lake Public Safety Facility & City Hall, Forest Lake, MN; Owatonna Public Utilities, Owatonna, MN; Unity Hospital Surgery Suite, Fridley, MN; Defense Intelligence Agency, Intelligence Community Campus, Bethesda, MD; AAA Minnesota Headquarters Renovations, St. Louis Park, MN

LHB, INC.



PERFORMANCE DRIVEN DESIGN.

21 West Superior Street, Suite 500
Duluth, MN 55802
Tel: (218) 727-8446
Fax: (218) 727-8456
Email: info@LHBcorp.com
www.LHBcorp.com
Other Offices: Minneapolis, MN; Superior, WI
Contact: Joellyn Gum

Firm Principals

Bill Bennett, PE
Dave Sheedy, PE, SE, CCCA, CCS, CDT, LEED AP
Michael Fischer, AIA, LEED AP
Rick Carter, FAIA, LEED Fellow BD+C, CID
Kim Bretheim, AIA, LEED AP BD+C
Evan Aljoe, ASHE, LEED AP, CCCA
R. Bruce Cornwall, AIA, CID
Kevin Holm, AIA, LEED AP BD+C

LHB is a multi-disciplinary engineering, architecture, and planning firm known for our design leadership and loyalty to clients. LHB goes beyond good intentions and focuses on measurable performance. We are experts in public works, pipeline, industrial, housing, healthcare, government, education, and commercial design. LHB is dedicated to being environmentally responsible, reducing long term operating costs, and improving the quality of life for our clients.

Representative Projects

LHB Loose Wiles Office Renovation (2014 Best In Real Estate Award-Commercial Renovation); Minneapolis, MN; Mahtomedi Public School Wildwood Elementary School (Finance & Commerce Top Project); Mahtomedi, MN; Veterans Administration, Ward 3; Minneapolis, MN; Essentia Health East, NICU; Duluth, MN; Seward Franklin Creamery Renovation; Minneapolis, MN; Ridgewater College; Willmar, MN; Donaldson World Headquarters Lobby Renovation; Bloomington, MN; Ackerberg, McKesson Lobby Renovation; Minneapolis, MN

MEYER GROUP, PC

130 W. Superior Street, Suite 410
Duluth, MN 55802
Tel: (218) 727-1330
Fax: (218) 727-1338
Email: general.information@meyergroup.biz
www.meyergroupduluth.com
Other Offices: Superior, WI
Contact: Tim Meyer

Firm Principals

Tim Meyer, AIA, CID, NCARB, LEED AP
Terry Groshong, AIA

Meyer Group specializes in community development projects, including education facilities, government, community centers, child care, housing, and retail facilities. Meyer Group Architects also have extensive cultural and spiritual design experience.

Representative Projects

Leech Lake Elder Care, Cass Lake, MN; City of Ely City Hall, Ely, MN; City of Ely Library, Ely, MN; Cook County YMCA, Grand Marais, MN; LCO Cultural Center, Hayward, WI; Twin Buttes Housing, Halliday, ND; National Park Service, Bayfield, WI; Twin Ports Wellness Center, Superior, WI

**MILLER DUNWIDDIE
ARCHITECTURE, INC.****miller dunwiddie**
ARCHITECTURE

123 North Third Street, Suite 104
Minneapolis, MN 55401
Tel: (612) 337-0000
Fax: (612) 337-0031
Email: info@millerdunwiddie.com
www.millerdunwiddie.com
Contact: Kathryn Hunsley, CID, IIDA

Firm Principals

Craig Lau, AIA, NCARB
Mark Miller
John Mecum, AIA, NCARB
Chuck Liddy, FAIA, NCARB

Since 1963, Miller Dunwiddie has worked to shape and preserve the environment through responsible, creative design. From providing decades of service to the Metropolitan Airports Commission—to completing over 700 historic preservation projects—our range of work is a testament to the firm's commitment to improving and preserving the built environment through excellent design—both in new facilities and existing structures. Our architects, interior designers and building envelope staff offer clients complete planning and design services.

Representative Projects

T2-Humphrey Terminal Expansion; MSP International Airport, MN; Metropolitan Airports Commission General Office Building Lobby Remodel; MSP International Airport, MN; Unity Church - Unitarian Expansion and Renovation; St. Paul, MN; Sanford Middle School Renovation & Expansion, Minneapolis Public Schools; Minneapolis, MN; St. Cloud VA Community Living Cottages; St. Cloud, MN; Howe Community School Renovation, Minneapolis Public Schools; Minneapolis, MN; Bethel University Physician's Assistant Program; Arden Hills, MN; Tettegouche State Park Visitor Center & Rest Area; Silver Bay, MN

**MOHAGEN|HANSEN
ARCHITECTURAL GROUP****Mohagen
Hansen**
Architectural
Group

1000 Twelve Oaks Center Drive, Suite 200
Wayzata, MN 55391
Tel: (952) 426-7400
Fax: (952) 426-7440
Email: info@mohagenhansen.com
www.mohagenhansen.com
Contact: Susan Kimbrel, Marketing Director

Firm Principals

Todd E. Mohagen, AIA, NCARB
Mark L. Hansen, AIA, NCARB, LEED AP BD+C
Lyn A. Berglund, CID, ASID

Mohagen|Hansen is a full services planning, architecture and interior design firm specializing in the development of high quality, functional and creative design solutions. These solutions are provided to a variety of markets including healthcare, senior living, corporate, industrial, financial, retail, dental, government and housing. We have earned a reputation for providing design that responds to our clients vision, brand, goals and objectives, while being sensitive to schedules and budgets. We partner with our clients to create inspirational designs that result in lasting relationships.

Representative Projects

Cardiovascular Systems, Inc. New Headquarters, New Brighton, MN; South Lake Pediatrics Clinic Renovation and Addition, Maple Grove, MN; HealthPartners: Family Practice Clinic, Bloomington, MN; Mills Creek Commons Senior Living Facility, Harrisburg, SD; Anchor Bank Branch Relocation, Wayzata, MN; Woodlake Centre Public Space Renovation, Richfield, MN; Lakeview Health: Urology Clinic Renovation, Shakopee, MN; Nexstar Network Training Center, Shakopee, MN

NELSON**NELSON**

1201 Marquette Avenue South, Suite 200
Minneapolis, MN 55403
Tel: (612) 822-1211
Fax: (612) 822-1006
Email: rsutton@nelsononline.com
www.nelsononline.com
Other Offices: Atlanta, GA; Boston, MA; Chicago, IL; Dallas, TX; Los Angeles, CA; New York, NY; Philadelphia, PA
Contact: Rick Sutton

Firm Principals

Richard Sutton, AIA, CID, NCARB
Claudia Reichert, IIDA, CID
Scott Hierlinger, IIDA

NELSON's six lines of business provide professional services for Architecture, Interior Design, Engineering, Workplace Services and Information Services. Through a national platform, local offices design and implement business solutions and environments for clients in Corporate, Legal, Academic, Governmental, Housing and Entertainment fields. NELSON's tagline: Focused on Creation - Passion to Deliver, explains our philosophy of providing on-time and on-budget design solutions to our clients.

Representative Projects

Polaris Industries, Plymouth, MN; SPS Commerce, Minneapolis, MN; TCF Bank, Plymouth, MN; RBC Wealth Management, Denver, CO; Bell State Bank, Golden Valley, MN; RBC Global Asset Management, Minneapolis, MN; Triple Tree Financial, Edina, MN; Berkley Risk, Minneapolis, MN

PERKINS + WILL**P E R K I N S + W I L L**

84 10th Street South, Suite 200
Minneapolis, MN 55403
Tel: (612) 851-5000
Fax: (612) 851-5001
Email: jeff.ziebarth@perkinswill.com
www.perkinswill.com
Other Offices: Atlanta, GA; Austin, TX; Boston, MA; Charlotte, NC; Chicago, IL; Dallas, TX; Houston, TX; Los Angeles, CA; Miami, FL; New York, NY; Research Triangle Park, NC; San Francisco, CA; Seattle, WA; Washington DC; Dundas, Canada; Ottawa, Canada; Toronto, Canada; Vancouver, Canada; Dubai; London; Sao Paulo; Shanghai
Contact: Karen Severson

Firm Principals

Jeff Ziebarth, AIA, LEED AP
David Dimond, AIA, CID, LEED AP
Rick Hintz, AIA, ACHA, LEED AP
Lisa Pool, CID, LEED AP ID+C
Robert Novak, AIA, LEED AP BD+C
Tony Layne, AIA, LEED AP BD+C
Jeanne Ekholm, LEED AP DB+C

Since 1935, Perkins + Will has collaborated with globally recognized clients to set worldwide standards for design innovation and exceptional service. We are committed to trend-setting leadership in our aviation + transit, corporate + commercial + civic, healthcare, higher education, science + technology and sports + recreation practices. Our inclusive strategy focuses us on our clients, our communities, and our vision: to craft ideas + buildings that honor the broader goals of society.

Representative Projects

Café Inc., Edina, MN; Wells Fargo Bank Downtown East, Minneapolis, MN; Be The Match Coordinating Center, Minneapolis, MN; Land O'Lakes Corporate Headquarters Renovation, Arden Hills, MN; Capella Tower Lobby Transformation, Downtown Minneapolis, MN; Hudson Hospital Medical Office Building Addition and Renovation, Hudson, WI; Rice Memorial Hospital, Willmar, MN; Saint Louis County Government Center Renovation, Duluth, MN

PETERSEN/KELLER ARCHITECTURE



1610 West Lake Street
Minneapolis, MN 55408
Tel: (612) 353-4920
Fax: (612) 353-4932
Email: info@pkarch.com
www.pkarch.com

Contact: Lars Petersen or Gabriel Keller

Firm Principals

Lars Petersen, AIA
Gabriel Keller, Assoc. AIA

At Petersen/Keller, the design process is intuitive, organic and highly collaborative. "It's about finding the clients' unique story and using design to capture this lifestyle," says Gabriel Keller. "We view ourselves and our clients as stewards of the home and the land," says Lars Petersen, AIA. "We use light, material, texture and form to bring forth a style that speaks to the homeowners, creating an environment for living for the next hundred years."

Representative Projects

Cedar Lake Historic Modern Restoration/ Addition, Minneapolis, MN; Hudson River Astor Estate Renovation, Rhinebeck, NY; Enchanted Island Modern Residence, Minnetrista, MN; Cedar Lake International Style Restoration, Minneapolis, MN; Lake Minnetonka Modern Residence, Woodland, MN; Residential Projects and Cabins in MN, KY, WI, NY, CA and IA; Edgewater Custom Loft, Minneapolis, MN; Rolling Green Organic Modern Residence, Edina, MN

POPE ARCHITECTS, INC.



1295 Bandana Blvd. North, Suite 200
St. Paul, MN 55108
Tel: (651) 642-9200
Fax: (651) 642-1101
Email: elarson@popearch.com
www.popearch.com
Contact: Erica Larson, CID, AIA, LEED AP
BD+C, Director of Interior Design

Firm Principals

Jon R. Pope, AIA
Paul A. Holmes, AIA, LEED AP
Randal L. Peek, AIA, NCARB, CID
Ward M. Isaacson, AIA, LEED AP
Thomas B. Kuck, AIA, LEED AP
Tim D. Casey, AIA, NCARB, CID, LEED AP BD+C

Pope Architects is an established design firm located in St. Paul with a national practice. We bring a wealth of design experience and sound business practices together to create beautiful, sustainable and compelling building environments. Pope Architects has a diverse practice encompassing healthcare, commercial, senior housing, behavioral health and community design. Our interior design team delivers high quality services to our clients in all practice areas.

Representative Projects

C.H. Robinson Eden Bluff Tech Center, Eden Prairie, MN; Summit Orthopedics Medical Center, Vadnais Heights, MN; 71 France Mixed-Use Development, Edina, MN; PrairieCare Children's Psychiatric Hospital, Brooklyn Park, MN; Bielenberg Sports Center Expansion, Woodbury, MN; Pioneer-Endicott Apartments, St. Paul, MN; WesleyLife The Cottages, Pella, IA; North Memorial Minnetonka Clinic, Minnetonka, MN

RSP ARCHITECTS

R S P A R C H I T E C T S

1220 Marshall Street NE
Minneapolis, MN 55413
Tel: (612) 677-7100
Fax: (612) 677-7499
www.rsparch.com
Other Offices: Chicago, IL; Fort Worth, TX; Phoenix, AZ

Firm Principals

David Norback, AIA
Ted Davis, FAIA, IIDA, LEED AP
Mike Lyner, AIA, IFMA, SPF, LEED AP O+M
Jeremy Mayberg, AIA
Robert Lucius, AIA
Stephen Fautsch, AIA
Jim Fitzhugh, AIA, NCARB
Joe Tyndall, AIA

RSP delivers design that works. We design smart, effective spaces that engage and inspire. Whether a large scale corporate headquarters or small start-up business; new healthcare clinic, retail concept, distribution center, military facility or cultural institution, RSP brings a unique blend of curiosity and consistency to every project. For more than 35 years, RSP has forged strategic partnerships, honoring the business drivers of our clients and translating their vision and mission into the built environment.

Representative Projects

Mayo Clinic Square, Minneapolis, MN; LifeSource Headquarters, Minneapolis, MN; Millennium Hotel Minneapolis; Hennepin County Medical Center Pediatric Intensive Care Unit; Punch Pizza, various locations; Target Northern Campus, Minneapolis, MN; Ramsey County Strategic Facilities Plan; Olympus OSTA, Brooklyn Park, MN

SHEA



10 South 8th Street
Minneapolis, MN 55402
Tel: (612) 339-2257
Email: info@sheadesign.com
www.sheadesign.com
Contact: Jason Dvorak

Firm Principals

David Shea
Tanya Spaulding

Shea is a design and marketing firm that creates consumer experiences using a seamless integration of brand development, architecture, interior design, graphic design and marketing communications. Shea develops creative and effective design solutions by using every point of contact, and works with clients in the areas of restaurant/hospitality, retail and corporate office.

Representative Projects

Union & Union Rooftop; Brasserie Zentral / Foreign Legion; Marin; Lunds & Byerly's Kitchen; Lunds Penfield; Hot Mama; Macy's; RBC Plaza; International Plaza

SKD ARCHITECTS, INC.

11140 Highway 55,
Suite A
Plymouth, MN 55441
Tel: (763) 591-6115
Fax: (763) 591-6119
Email: kleineman@
skdarchitects.com

www.skdarchitects.com

Contact: Steven A. Kleineman

Firm Principal

Steven A. Kleineman, AIA, CID

SKD is both an architecture and interior design based company, providing a range of interior design services to both residential and commercial clients. As architects and interior designers we are known for our detailing. We understand the initial client goals and design aesthetic. Creative skill paired with our understanding of materials, has been refined over 37 years. Our work reflects a creative fresh look at how finish materials are used to enhance the architectural design.

Representative Projects

Cambria Gallery Rochester, Rochester, MN; Friedland Residence, Wayzata, MN; Cambria Gallery on 7th, Minneapolis, MN; Davisco History Center & Corporate Office Addition, Le Sueur, MN; Equitable Acceptance Corporation, Minnetonka, MN; Twin City Fan Corporate Offices addition, Plymouth, MN; Interlachen Circle Residence, Edina, MN; Cambria Suite, Target Field, Minneapolis, MN

STUDIO HIVE, INC.

901 North 3rd Street, Suite 228
Minneapolis, MN 55401
Tel: (612) 279-0430
Fax: (612) 279-0439
Email: info@studiohive.com
www.studiohive.com
Contact: Shawn Gaither

Firm Principals

Shari Bjork, LEED AP
Shawn Gaither, AIA, LEED AP
Janice Carleen Linster, FASID, CID, LEED AP

continued next column

Studio Hive is an architectural and interior design firm with a focus on the design of the interior environment. We perceive space as a business tool that expresses brand identity, inspires and motivates its occupants, and influences the working, learning, and living experiences of its users.

Representative Projects

Coffman Memorial Student Center, Minneapolis, MN; Hennepin County, Multiple Locations; JE Dunn Construction, Minneapolis, MN; Larkin Hoffman Attorneys, Minneapolis, MN; Minnesota Multipurpose Stadium, Minneapolis, MN; UCare, Minneapolis, MN; University of Minnesota 17th Ave Housing, Minneapolis, MN; Western National Insurance, Edina, MN

TKDA

444 Cedar Street, Suite 1500
Saint Paul, MN 55101
Tel: (651) 292-4400
Fax: (651) 292-0083
Email: dean.johnson@
tkda.com
www.tkda.com

Other Offices: Duluth, MN; Chicago, IL;
Contact: Dean Johnson, AIA, CID

Firm Principals

Dean Johnson, AIA, CID
Ken Johnson, AIA, CID
Kathryn Poore-Larson, AIA, CID
Elizabeth Samsa, IIDA, CID

TKDA is an employee-owned architecture, interior design, planning, and engineering firm with Minnesota offices in Saint Paul and Duluth. More than 200 employees deliver solutions nationwide to clients seeking single source, integrated services. TKDA interior design services are award-winning and serve public and private sector clients.

Representative Projects

Flint Hills North Office Building, Inver Grove Heights, MN; Metro Transit Control Center Remodeling, Minneapolis, MN; Bethune Community School Remodeling, Minneapolis, MN; Flint Hills Lab Renovation and Expansion, Rosemount, MN; Interior Renovation Fire Hall #1, Duluth, MN; NorShor Historic Theatre Rehabilitation, Duluth, MN; North Shore Community School, Duluth, MN; Duluth International Airport Terminal, Duluth, MN

LAUREL ULLAND ARCHITECTURE

1718 Logan Avenue South
Minneapolis, MN 55403
Tel: (612) 874-1086
Email: laurel@laurelulland.com
www.laurelulland.com
Contact: Laurel Ulland

Firm Principal

Laurel Ulland, Assoc AIA

LUA is a small residential architecture firm specializing in the remodeling of existing homes and the design of new residences. We offer a full range of design and management services, working with a variety of housing styles and types. We focus on all aspects of the construction process, including detailed cabinetry and millwork drawings, the selection of all interior finishes and products, and we provide a high level of project management and coordination.

Representative Projects

Lake of the Isles Dutch Colonial, Minneapolis, MN; Town & Country Spanish Revival, St. Paul, MN; Lake Harriet Mid-Century Modern, Minneapolis, MN; 510 Groveland Terrace Co-op, Minneapolis, MN; Woodlawn English Manor, St. Paul, MN; Lake of the Isles Arts & Crafts, Minneapolis, MN; Pelican Isle Yacht Club Penthouse, Naples, FL; Modern Minimalist New Residence, Golden Valley, MN

WCL ASSOCIATES, INC.

4931 West 35th Street, Suite 200
St. Louis Park, MN 55416
Tel: (952) 541-9969
Email: dave.c@wcla.com
www.wcla.com

Firm Principals

Dave Clark, AIA, LEED AP
Paul Dahl, AIA
Paul Anderson, AIA

WCL has a history of working with real estate developers to redevelop and release older buildings. WCL has created effective office environments that project and reinforce the company's brand and image.

Representative Projects

Remax Results, Hennepin; Sanctuary SalonSpa; Leeann Chin, Ridgedale; Peoples Organic, Wayzata; Reflections Printing; Remax Results, Edina; Erbert & Gerberts Sandwich Shop
WCL Associates, Inc.

4931 West 35th Street, Suite 200
St. Louis Park, MN 55416
Tel: (952) 541-9969
Email: dave.c@wcla.com
www.wcla.com

Firm Principals

Dave Clark, AIA, LEED AP
Paul Dahl, AIA
Paul Anderson, AIA

WCL has a history of working with real estate developers to redevelop and release older buildings. WCL has created effective office environments that project and reinforce the company's brand and image.

Representative Projects

Remax Results, Hennepin; Sanctuary SalonSpa; Leeann Chin, Ridgedale; Peoples Organic, Wayzata; Reflections Printing; Remax Results, Edina; Erbert & Gerberts Sandwich Shop

ARCHITECTURAL ALLIANCE + 20 BELOW**ARCHITECTURAL ALLIANCE + 20below**

400 Clifton Avenue
Minneapolis, MN 55403
Tel: (612) 874-4100
Fax: (612) 874-7212
Email: thysell@archalliance.com
www.archalliance.com
Other Offices: Minneapolis-St. Paul
International Airport, St. Paul, MN;
San Diego, CA
Contact: Tom Hysell

Firm Principals

Carey Brendalen, AIA, LEED AP
Thomas DeAngelo, FAIA, LEED AP
Joe Hamilton, AIA, CID
Mamie Harvey, AIA, LEED AP BD+C
Tom Hysell, AIA, LEED AP BD+C
Heather Rose-Dunning, IIDA, LEED AP
Eric Peterson, AIA, LEED AP
April Meyer, NCIDQ, LEED AP

We are specialists in using design to engage our clients. We unite people and place through design - through our vision, our leadership, technical expertise, and integrity. Our clients rely on us to provide them with effective and innovative solutions - including the workspace, public, civic, science and technology, lifestyle, and aviation environments. Our unique discovery and planning perspective fully integrates interior architecture and design throughout our project process to provide memorable, people-centric environments.

Representative Projects

Lindquist & Vennum, Planning and Strategic Services, Minneapolis, MN; Syngenta Biotechnology Headquarters, R&D, and Office Environments, Research Triangle Park, NC; 6Smith Restaurant, Bar, and Rooftop Deck, Wayzata, MN; Patterson Companies Alternative Workplace Pilot, Mendota Heights, MN; MBJ Structural Engineers' Office Repositioning and Relocation, Minneapolis, MN; LPM Luxury Apartments' Public and Amenities Spaces, Minneapolis, MN; Pine River and Two Harbors Investment Corporation, Plymouth, MN; Libertine Restaurant, Bar, and "Pop-up" Dining, Minneapolis, MN

**ATS&R PLANNERS/
ARCHITECTS/ENGINEERS**

8501 Golden Valley Road, Suite 300
Minneapolis, MN 55427
Tel: (763) 545-3731
Fax: (763) 525-3289
Email: information@atsr.com
Contact: Dean S. Beeninga, AIA, NCARB, REFP, LEED AP

Firm Principals

Paul W. Erickson, AIA, NCARB, REFP
David M. Maroney, AIA, NCARB
Dean S. Beeninga, AIA, NCARB, REFP, LEED AP
Mark G. Hayes, AIA
Daniel C. Moll, AIA, CID, NCARB, LEED AP

ATS&R provides comprehensive services throughout your project with in-house departments that offer architecture, educational facility planning, mechanical/electrical engineering, interior design, technology, site development, and field administration. Our interior designers bring a fresh outlook to planning, technology, furniture, fixtures, equipment and specifications. We respond to your needs for floor/wall/ceiling finishes, specialty systems, and LEED strategies for a cleaner environment. ATS&R understands the importance of life-cycle cost analysis in the selection of your building's materials and systems.

Representative Projects

I.J. Holton Intermediate School, Austin, MN; Maple Grove Junior High School Gym Addition, Maple Grove, MN; Anoka-Hennepin School District School Additions, MN; Mechanical Retrofits to Four Elementary Schools, Rochester, MN; Minnetonka Vantage Program, Minnetonka, MN; Southwest Minnesota Amateur Sports Complex, Marshall, MN; Southwest High School Addition, Minneapolis, MN; Arcadia Middle School Addition, Arcadia, WI

**BDH+YOUNG
INTERIORS | ARCHITECTURE**

interiors | architecture

7001 France Avenue South, Suite 200
Edina, MN 55435
Tel: (952) 893-9020
Fax: (952) 893-9299
Email: info@bdhyoung.com
www.bdhyoung.com
Contact: Kim Dennis | Jill Brecount

Firm Principals

Kim Dennis, CID, IIDA, LEED AP ID+C
Jill Brecount, CID, LEED AP ID+C
Darcy Hield, CID
Patrick Giordana, AIA

We are a client-focused, full service Architectural + Interior Design firm bringing an innovative + collaborative experience to every project. We truly listen to your vision, goals + objectives and are dedicated to our clients. bdh+young provides comprehensive architectural, interior design + space planning service for a wide range of project types + settings.

Representative Projects

CliftonLarsonAllen, Multiple Locations; Helene Houle Medical Center, Vadnais Heights, MN; Lime Apartments, Minneapolis, MN; Minnetonka Medical Center, Minnetonka, MN; The Terraces by St. Therese SW, Hopkins, MN; Tunheim, Minneapolis, MN; North Memorial Healthcare, Minnetonka, MN; Children's Hospitals and Clinics of Minnesota, Multiple Locations

INTERIOR DESIGN FIRMS

The firms listed in this directory include interior designers who are members of the American Society of Interior Designers (ASID) and the International Interior Designers Association (IIDA), or who have the designation of Certified Interior Designer (CID). They offer a broad range of interior design, space planning and furnishings selection experience. Each firm has specific areas of expertise and project competence. Contact them to discuss your specific project needs.

Legend

AIA	Registered Member, American Institute of Architects
Associate AIA	Associate Member, American Institute of Architects
ACHA	American College of Healthcare Architects
AICP	American Institute of Certified Planners
ASID	American Society of Interior Designers
CCS	Certified Construction Specifier
CID	Certified Interior Designer
CDT	Construction Documents Technology (Certified)
CFM	Certified Facility Manager
FAIA	Fellow and Registered Member of the American Institute of Architects
FASID	Fellow, American Society of Interior Designers
FIIDA	Fellow, International Interior Designers Association
IFMA	International Facilities Management Association
LEED	Leadership in Energy and Environmental Design
LEED AP	Leadership in Energy and Environmental Design Accredited Professional
PE	Professional Engineer
*	Associate Owned Firm

**BENTZ/THOMPSON/
RIETOW, INC.**

801 Nicollet Mall, Suite 801
Minneapolis, MN 55402
Phone: (612) 332-1234
Fax: (612) 332-1813
Email: info@btr-architects.com
www.btr-architects.com
Contact: Randy Moe or Ann Voda

Firm Principals:

Ann Voda, AIA, CID, LEED AP BD+C
Randy L. Moe, AIA, CID, LEED AP
Bob Zimmerman, AIA, CID

Our firm regards each client and every project as unique, presenting new challenges and design opportunities. Because it's where we live work and play on a daily level, Interior Architecture and Interior Design are often more up-close and personal to architects and clients alike. Believing that the client and architect are together responsible for the level of success of any project, we welcome the client as an integral part of the design team. We stress a sound, cooperative, working relationship between client and architect to achieve a superior design, a commitment to the project schedule and sticking to the client's budget.

Representative Projects

West Snarr Renovation, Minnesota State University Moorhead; Kryzsko Commons Addition & Renovation, Winona State University, Winona, MN; Ramsey County Library, White Bear Lake, MN; Hennepin County Plymouth Library, Plymouth, MN; Private Condominium @ 510 Groveland, Minneapolis, MN; IT Offices for Minnesota State Colleges & Universities, MCTC Campus, Minneapolis, MN; Energy Park Place Offices, Metro State University, St. Paul, MN; Nursing Department Renovation, College of St. Benedict, St. Joseph, MN

BKV GROUP**BKV
GROUP**

222 North Second Street
Minneapolis, MN 55401
Tel: (612) 339-3752
Fax: (612) 339-6212
Email: knaylor@bkgvgroup.com
www.bkgvgroup.com
Other Offices: Washington, DC; Chicago, IL
Contact: Kelly Naylor, Melissa Metzler

Firm Principals

Kelly Naylor, CID
Melissa Metzler, IIDA
Jack Boorman, AIA
Michael Krych, AIA
Gretchen Camp, AIA
William Jensen, AIA
Bruce Schwartzman, AIA
Brad Severson, PE, SE

Established in 1978, BKV Group is an established leader in architecture, engineering, interior design, and landscape architecture. Our multi-disciplinary firm consistently ranks as one of the top design firms with a portfolio that includes multiple award-winning projects. BKV Group strives to develop creative, innovative solutions that meet our client's goals & realize their vision. Our primary market sectors include multifamily housing and development, corporate and hospitality, government, and education.

Representative Projects

Soo Line Building City Apartments, Minneapolis, MN; The Penfield, St. Paul, MN; Schmidt Artist Lofts, St. Paul, MN; One Southdale Place, Edina, MN; West Fargo City Hall/Police, West Fargo, ND; Rochester Fire Station No. 2, Rochester, MN; Crowne Plaza Renovation, St. Paul, MN; Eddy's Resort, Onamia, MN

BWBR**B|W|B|R**

380 St. Peter Street, Suite 600
Saint Paul, MN 55102
Tel: (651) 222-3701
Email: marketing@bwbr.com
www.bwbr.com
Other Offices: Madison, WI
Contact: Brian B. Buchholz, AIA, ACHA, CID

Firm Principals

Peter G. Smith, AIA
Timothy J. Sessions, AIA
John A. Strachota, AIA, LEED AP
Richard W. Dahl, AIA
Katherine J. Leonidas, AIA, LEED AP
Thomas J. Dornack, RA
Gregory E. Fenton, AIA
Don Thomas, CID

BWBR is a design solutions firm with practices in architecture, interior design, and master and strategic planning. One of the Upper Midwest's oldest and largest firms, BWBR has established a reputation for service and quality designing complex facilities in health care, higher education, corporate, justice, government, manufacturing, transportation, worship, and recreation markets. Working with organizations to leverage facility improvements for better service delivery and operations, BWBR designs solutions to enhance what people do.

Representative Projects

University of Minnesota Children's Hospital Child/Adolescent Mental Health Program, Minneapolis, MN; Mayo Clinic Dan Abraham Healthy Living Center Sports Medicine, Rochester, MN; HealthPartners RiverWay Clinics-Anoka, Anoka, MN; Gillette Children's Specialty Healthcare, Saint Paul, MN; Global Design Lab, Saint Paul, MN; Lakeview Medical Center, Rice Lake, WI; University of Minnesota School of Nursing Benton Healthy Communities Innovation Center, Minneapolis, MN; University of Minnesota Medical Devices Center, Minneapolis, MN

**CLOSE ASSOCIATES
INC., ARCHITECTS**

3101 East Franklin Avenue
Minneapolis, MN 55406
Tel: (612) 339-0979
Email: gar@closearchitects.com
www.closearchitects.com
Contact: Gar Hargens, (612) 339-0979

Firm Principal

Gar Hargens, AIA, CID

Steeped in seventy-five years of Mid Century Modernism, Close Associates is also very skilled at remodeling, restoring and combining earlier styles. Owner Gar Hargens was a Saint Paul HPC Commissioner for nine years and is a registered Interior Designer. We enjoy helping reuse older buildings like the Seward Co-op, and have designed countless additions and remodelings. We work hard to help you maximize your budget.

Representative Projects

Seward Co-op Grocery & Deli renovation, Minneapolis, MN; Louis & Maude Hill House restoration, 260 Summit Avenue, St. Paul, MN; Saint John the Evangelist Church renovation, St. Paul, MN; River Towers Condominium Plaza restoration, Minneapolis, MN; Lakeside remodeling, Wayzata, MN (see website); Johnson Residence remodeling, St. Paul, MN; Cooper Foster addition, St. Paul, MN; Mann-Benson renovation-additions, Deephaven, MN

CUNINGHAM GROUP ARCHITECTURE, INC.



201 Main Street SE,
Suite 325
Minneapolis, MN 55414
Tel: (612) 379-3400
Fax: (612) 379-4400
Email: hello@cunningham.com
cunningham.com
www.cunningham.com

Other Offices: Los Angeles, CA; Las Vegas, NV; Biloxi, MS; Denver, CO; San Diego, CA; Phoenix, AZ; Seoul, Republic of Korea; Beijing, China
Contact: Rebecca Martinez, Principal

Firm Principals

Timothy Dufault, AIA, NCARB, LEED AP
David Hyde, AIA
Jeffrey A. Schoeneck, AIA, LEED AP
Thomas Hoskens, AIA, NCARB, LEED AP
David Solner, AIA, NCARB, LEED AP
Brian Tempas, AIA, NCARB
Chad Clow, AIA, NCARB
Margaret Parsons, AIA, NCARB, REFP, LEED AP BD+C

Awarded the AIA Minnesota Firm Award in 2013, Cunningham Group transcends tradition with architecture, interior design, urban design and landscape architecture services for a diverse mix of clients and project types. Through a client-centered, collaborative approach, our interior designers create innovative environments that offer an evolutionary perspective and provide sensitivity to the functional, social and environmental impact of each space. Founded in 1968, the firm has grown to over 275 employees in nine offices.

Representative Projects

Potawatomi Hotel and Casino, Milwaukee, WI; Radisson Hotel Interior Remodel, La Crosse, WI; Serendipity III at Caesars Palace, Las Vegas, NV; JA Nugget Casino Resort Renovation, Sparks, NV; The Walkway Apartments Lobby and Lounge, Minneapolis, MN; The Boat House, Orlando, FL; Alexandria High School, Alexandria, MN; Harrah's Gulf Coast, Biloxi, MS

ELNESS SWENSON GRAHAM ARCHITECTS, INC.



500 Washington Ave
South, Suite 1080
Minneapolis, MN 55415
Tel: (612) 339-5508
Fax: (612) 339-5382
www.esgarchitects.com

Firm Principals

Mark G. Swenson, FAIA, LEED AP
David L. Graham, FAIA, LEED AP
Dennis Sutliff, AIA, AICP
Art Bartels, AIA, LEED AP
Paul Mittendorf, AIA, CID, LEED AP
Aaron Roseth, Associate AIA

Since our founding, Elness Swenson Graham Architects has helped our clients create environments for business, community and leisure. Throughout our entire time, our commitment to enriching our built environment has remained steadfast. It's a commitment that drives us to go beyond the expected to deliver the superior, the timeless, the memorable and the unique; to create environments that capture the human spirit and uplift our lives. This is what we do best.

Representative Projects

Coup d'état, Minneapolis, MN; Borough Restaurant/Parlour Bar, Minneapolis, MN; Smack Shack, Minneapolis, MN; Junction Flats Apartments, Minneapolis, MN; Mill & Main Luxury Apartments, Minneapolis, MN; Dock Street Flats, Minneapolis, MN; Minneapolis Marriott Northwest Hotel & Executive Conference Center Brooklyn Park, MN; Latitude 45 Apartments, Minneapolis, MN

GENSLER *

Gensler

81 South 9th Street, Suite 220
Minneapolis, MN 55402

Tel: (612) 333-1113
Fax: (612) 333-1997
Email: betsy_vohs@gensler.com
www.gensler.com

Other Offices: Abu Dhabi, United Arab Emirates; Atlanta, GA; Austin, TX; Baltimore, MD; Bangalore, India; Bangkok, Thailand; Beijing, China; Boston, MA; Charlotte, NC; Chicago, IL; Dallas, TX; Denver, CO; Detroit, MI; Doha, Qatar; Dubai, United Arab Emirates; Hong Kong; Houston, TX; La Crosse, WI; Las Vegas, NV; London, United Kingdom; Los Angeles, CA; Mexico City, Mexico; Miami, FL; Morristown, NJ; New York, NY; Newport Beach, CA; Phoenix, AZ; Pittsburgh, PA; Raleigh-Durham, NC; San Diego, CA; San Francisco, CA; San Jose, CA; San José, Costa Rica; San Ramon, CA; Sao Paulo, Brazil; Seattle, WA; Seoul, South Korea; Shanghai, China; Singapore; Sydney, Australia; Tampa, FL; Tokyo, Japan; Toronto, Canada; Washington DC
Contact: Betsy Vohs

Firm Principal

Bill Lyons, Associate AIA, LEED AP

As architects, designers, planners and consultants, we partner with our clients on some 3,000 projects every year. These projects can be as small as a wine label or as large as a new urban district. With more than 4,200 professionals networked across 47 locations, we serve our clients as trusted advisors, combining localized expertise with global perspective wherever new opportunities arise. Our work reflects an enduring commitment to sustainability and the belief that design is one of the most powerful strategic tools for securing lasting competitive advantage.

Representative Projects

Twin Cities Habitat for Humanity, St. Paul, MN; Minneapolis Convention Center, Minneapolis, MN; Room & Board, Boston, MA; New York City, NY; Denver, CO; Loose-Wiles Building and The Freehouse, Minneapolis, MN; 3M, Maplewood, MN; Code42, Minneapolis, MN; Zelle Hofmann, Minneapolis, MN; Gaviidae Common, Minneapolis, MN

HGA ARCHITECTS AND ENGINEERS

420 5th Street North, Suite 100

Minneapolis, MN 55401

Tel: (612) 758-4000

Fax: (612) 758-4199

Email: info@hga.com

www.hga.com

Other Offices: Rochester, MN; Milwaukee, WI; Sacramento, CA; San Francisco, CA; Los Angeles, CA; and Washington, DC
Contact: Debra Barnes, CID, IIDA, LEED AP ID+C

Firm Principals

Debra Barnes, CID, IIDA, LEED AP ID+C
Richard Bonnin
Rand Liedl, CID
Laurie Rother, CID, IIDA, LEED AP BC+C
Paula Storsteen, IIDA, LEED AP
Christine Guzzo Vickery, CID, EDAC

Recognizing the global nature of design today, HGA's team addresses the connection between an organization's strategic view and their customers. Our designs focus on understanding the unique needs of the occupants whether they be from corporate work environments, college campuses, hospitality, retail or healthcare design. We listen to our clients to understand their strategic needs and then respond with creative, flexible interior solutions that provide long-term value.

Representative Projects

Accenture, various international locations; Fairview Southdale Hospital, Emergency Department Expansion, Edina, MN; Hazelden Betty Ford Foundation, various national locations; Mayo Clinic, various national locations; Minnesota State Capitol, Interior Renovation, St. Paul, MN; Pohlman Companies, Minneapolis, MN; Surly Brewing, Destination Brewery, Minneapolis, MN; University of Minnesota, Northrop Auditorium Renovation, Minneapolis, MN

I+S GROUP (ISG)**ISG****I+S GROUP**

115 E. Hickory Street, Suite 300
Mankato, MN 56001
Tel: (507) 387-6651
Fax: (507) 387-3583
Email: bryan.paulsen@is-grp.com
www.is-grp.com
Other Offices: Faribault, MN; La Crosse, WI;
Des Moines IA; Algona, IA; Sac City, IA,
Storm Lake, IA
Contact: Bryan Paulsen, AIA, CID, LEED AP

Firm Principals

Bryan Paulsen, AIA, CID, LEED AP
Chad Surprenant, PE
Staci Flemming, IIDA, CID, LEED AP
Paul Lawton, AIA, LEED AP
Brian Gjerde, PE
Lynn Bruns, PE, LEED AP
Alyssa Campbell, AIA, LEED AP
Chuck Brandel, PE

ISG's experienced and award winning architects and interior designers provide the vital link between aesthetics, function and efficiency. Our multi-disciplinary team of experts understands that each interior space plays an important, unique role in a building's overall vision and purpose. Our highly-creative designers provide space analysis, planning and integrated design solutions and are supported with the latest in digital technology to help our clients visualize a wide range of design options, sustainable strategies, and finish and furnishing choices.

Representative Projects

Mankato Public Safety Center, Mankato, MN; Coldwell Banker/Fisher Group Offices, Mankato, MN; Cannon Falls Clinic, Cannon Falls, MN; Millerbernd Manufacturing Co., Winstead, MN; Children's Museum Southern MN, Mankato, MN; Winthrop Clinic, Winthrop, MN; Mayo Clinic Health System Employee Health & Wellness Center, Mankato, MN; Massad's Mediterranean Grille, Mankato, MN

KODET ARCHITECTURAL GROUP, LTD.

15 Groveland Terrace
Minneapolis, MN 55403
Tel: (612) 377-2737
Fax: (612) 377-1331
Email: arch@kodet.com
www.kodet.com
Contact: Edward Kodet, Jr., FAIA, LEED AP BD+C

Firm Principals

Edward Kodet, Jr., FAIA, CID, LEED AP BD+C
Kenneth Stone, AIA, CID, LEED AP BD+C
Mike Schellin, AIA
John Brandel, Assoc. AIA

Kodet Architectural Group provides a complete range of services statewide, including: architectural design, programming, master planning, cost estimating, project management, interior design, site planning, referendum assistance, feasibility studies, ADA accessibility and remodeling, historic preservation, renovation acoustics, indoor air quality, and sustainable and energy efficient design. Public design experience includes: educational facilities, libraries, parks and recreational facilities, maintenance and public works, fire stations and other community buildings.

Representative Projects

Gerald W. Heaney Federal Building Historic Restoration & Courtroom Renovation (GSA), Duluth, MN; Mn/DOT Maple Grove Maintenance Facility, Maple Grove, MN; Westwood Lutheran Church, St. Louis Park, MN; Calvin Christian School, Edina, MN; Burroughs Community School, Minneapolis, MN; Bloomington Aquatic & Recreation Center, Bloomington, MN

KRECH, O'BRIEN, MUELLER + ASSOCIATES, INC.**KRECH, O'BRIEN, MUELLER & ASSOCIATES, INC.**

6115 Cahill Avenue
Inver Grove Heights, MN 55076
Tel: (651) 451-4605
www.komainc.com
Contact: Ashley Krech

Firm Principals

Brady R. Mueller, AIA, CID
James H. Krech, PE
Stephen T. Iaria, AIA
Marc R. DuBois, AIA
Matthew J. Van Hoof, PE
Michael J. Lisowski, PE
Brian L. Riley
Cindy Douthett Nagel, CID

For more than 29 years, KOMA has been creating inspiring, functional, people-oriented structures and spaces to meet the varied needs of organizations and industries. Our professional capabilities are comprehensive, offering complete architectural, structural engineering and interior design services.

Representative Projects

Oak Knoll Animal Hospital, St. Louis Park, MN; Great Clips Corporate, Edina, MN; Slurp and Snack, Mall of America, Bloomington, MN; Gopher Resource, Tampa, FL; American Dental Partners, various locations; Neuger Communications Group, Minneapolis, MN; Grey Cloud Elementary, Cottage Grove, MN

LEO A DALY

730 Second Avenue South, Ste. 1100
Minneapolis, MN 55402
Tel: (612) 338-8741
Fax: (612) 338-4840
Email: info@leoadaly.com
www.leoadaly.com
Other Offices: CA, CO, FL, GA, HI, NE, NV, TX, China, Russia, Saudi Arabia, Turkey, UAE
Contact: Ted Redmond, AIA

Firm Principals

Ted E. Redmond, AIA
William M. Baxley, AIA
Randy S. Gould
James G. Sokolowski, PE
Tim Bauer
Jeremy Klysen, PE
Cindy McCleary, AIA

Established in 1915, LEO A DALY is an international architecture, planning, engineering, and interior design firm. The company's portfolio includes award-winning projects in 75 countries, all 50 states and the District of Columbia. LEO A DALY currently employs approximately 1,000 architects, planners, engineers and interior designers in over 30 offices worldwide.

Representative Projects

Toro R&D Facility Expansion, Bloomington, MN; City of Forest Lake Public Safety Facility & City Hall, Forest Lake, MN; Owatonna Public Utilities, Owatonna, MN; Unity Hospital Surgery Suite, Fridley, MN; Defense Intelligence Agency, Intelligence Community Campus, Bethesda, MD; AAA Minnesota Headquarters Renovations, St. Louis Park, MN

LHB, INC.**PERFORMANCE
DRIVEN DESIGN.**

21 West Superior Street, Suite 500
Duluth, MN 55802
Tel: (218) 727-8446
Fax: (218) 727-8456
Email: info@LHBcorp.com
www.LHBcorp.com
Other Offices: Minneapolis, MN;
Superior, WI
Contact: Joellyn Gum

Firm Principals

Bill Bennett, PE
Dave Sheedy, PE, SE, CCA, CCS, CDT, LEED AP
Michael Fischer, AIA, LEED AP
Rick Carter, FAIA, LEED Fellow BD+C, CID
Kim Bretheim, AIA, LEED AP BD+C
Evan Aljoe, ASHE, LEED AP, CCA
R. Bruce Cornwall, AIA, CID
Kevin Holm, AIA, LEED AP BD+C

LHB is a multi-disciplinary engineering, architecture, and planning firm known for our design leadership and loyalty to clients. LHB goes beyond good intentions and focuses on measurable performance. We are experts in public works, pipeline, industrial, housing, healthcare, government, education, and commercial design. LHB is dedicated to being environmentally responsible, reducing long term operating costs, and improving the quality of life for our clients.

Representative Projects

LHB Loose Wiles Office Renovation (2014 Best In Real Estate Award-Commercial Renovation); Minneapolis, MN; Mahtomedi Public School Wildwood Elementary School (Finance & Commerce Top Project); Mahtomedi, MN; Veterans Administration, Ward 3; Minneapolis, MN; Essentia Health East, NICU; Duluth, MN; Seward Franklin Creamery Renovation; Minneapolis, MN; Ridgewater College; Willmar, MN; Donaldson World Headquarters Lobby Renovation; Bloomington, MN; Ackerberg, McKesson Lobby Renovation; Minneapolis, MN

**MILLER DUNWIDDIE
ARCHITECTURE, INC.****miller dunwiddie**
ARCHITECTURE

123 North Third Street, Suite 104
Minneapolis, MN 55401
Tel: (612) 337-0000
Fax: (612) 337-0031
Email: info@millerdunwiddie.com
www.millerdunwiddie.com
Contact: Kathryn Hunsley, CID, IIDA

Firm Principals

Craig Lau, AIA, NCARB
Mark Miller
John Mecum, AIA, NCARB
Chuck Liddy, FAIA, NCARB

Since 1963, Miller Dunwiddie has worked to shape and preserve the environment through responsible, creative design. From providing decades of service to the Metropolitan Airports Commission—to completing over 700 historic preservation projects—our range of work is a testament to the firm's commitment to improving and preserving the built environment through excellent design—both in new facilities and existing structures. Our architects, interior designers and building envelope staff offer clients complete planning and design services.

Representative Projects

T2-Humphrey Terminal Expansion; MSP International Airport, MN; Metropolitan Airports Commission General Office Building Lobby Remodel; MSP International Airport, MN; Unity Church - Unitarian Expansion and Renovation; St. Paul, MN; Sanford Middle School Renovation & Expansion, Minneapolis Public Schools; Minneapolis, MN; St. Cloud VA Community Living Cottages; St. Cloud, MN; Howe Community School Renovation, Minneapolis Public Schools; Minneapolis, MN; Bethel University Physician's Assistant Program; Arden Hills, MN; Tettegouche State Park Visitor Center & Rest Area; Silver Bay, MN

**MOHAGEN|HANSEN
ARCHITECTURAL GROUP****Mohagen
Hansen**
Architectural
Group

1000 Twelve Oaks Center Drive, Suite 200
Wayzata, MN 55391
Tel: (952) 426-7400
Fax: (952) 426-7440
Email: info@mohagenhansen.com
www.mohagenhansen.com
Contact: Susan Kimbrel, Marketing Director

Firm Principals

Todd E. Mohagen, AIA, NCARB
Mark L. Hansen, AIA, NCARB, LEED AP BD+C
Lyn A. Berglund, CID, ASID

Mohagen|Hansen is a full services planning, architecture and interior design firm specializing in the development of high quality, functional and creative design solutions. These solutions are provided to a variety of markets including healthcare, senior living, corporate, industrial, financial, retail, dental, government and housing. We have earned a reputation for providing design that responds to our clients vision, brand, goals and objectives, while being sensitive to schedules and budgets. We partner with our clients to create inspirational designs that result in lasting relationships.

Representative Projects

Cardiovascular Systems, Inc. New Headquarters, New Brighton, MN; South Lake Pediatrics Clinic Renovation and Addition, Maple Grove, MN; HealthPartners: Family Practice Clinic, Bloomington, MN; Mills Creek Commons Senior Living Facility, Harrisburg, SD; Anchor Bank Branch Relocation, Wayzata, MN; Woodlake Centre Public Space Renovation, Richfield, MN; Lakeview Health: Urology Clinic Renovation, Shakopee, MN; Nexstar Network Training Center, Shakopee, MN

MSR

710 South 2nd Street, 8th Floor
Minneapolis, MN 55401-2822
Tel: (612) 375-0336
Fax: (612) 342-2216
Email: info@msrdesign.com
www.msrdesign.com
Other Offices: Hyattsville, MD
Contact: Garth Rockcastle

Firm Principals

Thomas Meyer, FAIA
Jeffrey Scherer, FAIA
Garth Rockcastle, FAIA
Jack Poling, AIA
Traci Engel Lesneski, CID
Josh Stowers, AIA
Paul Melblom, AIA
Matthew Krontorad, AIA

MS&R is an award-winning architecture and interior design firm committed to excellence. Since 1981, our firm has produced work of enduring value: buildings that are diverse in type, size, and location, with specific depth of experience serving library, office, cultural, higher education, and residential clients. The firm has earned a national reputation for both designing exceptional new spaces and, through preservation, renovation, and adaptive reuse, designing innovative ways to reuse buildings.

Representative Projects

Madison Public Library Central Library Renovation/Expansion, Madison, WI; Urban Outfitters Corporate Campus Building 18 Adaptive Reuse, Philadelphia, PA; Minnesota Children's Museum Renovation/Expansion, Saint Paul, MN; The Rose Multifamily Mixed-Income Housing Complex, Minneapolis, MN; Lake City Public Library Renovation/Expansion, Lake City, MN; Aimia Minneapolis Corporate Headquarters, Minneapolis, MN; Honeywell Design Studio, Golden Valley, MN; Leech Lake Tribal College Library, Cass Lake, MN

NELSON

NELSON

1201 Marquette Avenue South, Suite 200
Minneapolis, MN 55403

Tel: (612) 822-1211

Fax: (612) 822-1006

Email: rsutton@nelsononline.com

www.nelsononline.com

Other Offices: Atlanta, GA; Boston, MA;
Chicago, IL; Dallas, TX; Los Angeles, CA;
New York, NY; Philadelphia, PA
Contact: Rick Sutton

Firm Principals

Richard Sutton, AIA, CID, NCARB

Claudia Reichert, IIDA, CID

Scott Hierlinger, IIDA

NELSON's six lines of business provide professional services for Architecture, Interior Design, Engineering, Workplace Services and Information Services. Through a national platform, local offices design and implement business solutions and environments for clients in Corporate, Legal, Academic, Governmental, Housing and Entertainment fields. NELSON's tagline: Focused on Creation - Passion to Deliver, explains our philosophy of providing on-time and on-budget design solutions to our clients.

Representative Projects

Polaris Industries, Plymouth, MN; SPS Commerce, Minneapolis, MN; TCF Bank, Plymouth, MN; RBC Wealth Management, Denver, CO; Bell State Bank, Golden Valley, MN; RBC Global Asset Management, Minneapolis, MN; Triple Tree Financial, Edina, MN; Berkley Risk, Minneapolis, MN

PERKINS + WILL

PERKINS + WILL

84 10th Street South, Suite 200
Minneapolis, MN 55403

Tel: (612) 851-5000

Fax: (612) 851-5001

Email: jeff.ziebarth@perkinswill.com

www.perkinswill.com

Other Offices: Atlanta, GA; Austin, TX;
Boston, MA; Charlotte, NC; Chicago, IL;
Dallas, TX; Houston, TX; Los Angeles, CA;
Miami, FL; New York, NY; Research Triangle
Park, NC; San Francisco, CA; Seattle, WA;
Washington DC; Dundas, Canada;
Ottawa, Canada; Toronto, Canada;
Vancouver, Canada; Dubai; London;
Sao Paulo; Shanghai
Contact: Karen Severson

Firm Principals

Jeff Ziebarth, AIA, LEED AP

David Dimond, AIA, CID, LEED AP

Rick Hintz, AIA, ACHA, LEED AP

Lisa Pool, CID, LEED AP ID+C

Robert Novak, AIA, LEED AP BD+C

Tony Layne, AIA, LEED AP BD+C

Jeanne Ekholm, LEED AP DB+C

Since 1935, Perkins + Will has collaborated with globally recognized clients to set worldwide standards for design innovation and exceptional service. We are committed to trend-setting leadership in our aviation + transit, corporate + commercial + civic, healthcare, higher education, science + technology and sports + recreation practices. Our inclusive strategy focuses us on our clients, our communities, and our vision: to craft ideas + buildings that honor the broader goals of society.

Representative Projects

Café Inc., Edina, MN; Wells Fargo Bank Downtown East, Minneapolis, MN; Be The Match Coordinating Center, Minneapolis, MN; Land O'Lakes Corporate Headquarters Renovation, Arden Hills, MN; Capella Tower Lobby Transformation, Downtown Minneapolis, MN; Hudson Hospital Medical Office Building Addition and Renovation, Hudson, WI; Rice Memorial Hospital, Willmar, MN; Saint Louis County Government Center Renovation, Duluth, MN

PETERSSSEN/KELLER
ARCHITECTURE

1610 West Lake Street

Minneapolis, MN 55408

Tel: (612) 353-4920

Fax: (612) 353-4932

Email: info@pkarch.com

www.pkarch.com

Contact: Lars Peterssen or Gabriel Keller

Firm Principals

Lars Peterssen, AIA

Gabriel Keller, Assoc. AIA

At Peterssen/Keller, the design process is intuitive, organic and highly collaborative. "It's about finding the clients' unique story and using design to capture this lifestyle," says Gabriel Keller. "We view ourselves and our clients as stewards of the home and the land," says Lars Peterssen, AIA. "We use light, material, texture and form to bring forth a style that speaks to the homeowners, creating an environment for living for the next hundred years."

Representative Projects

Cedar Lake Historic Modern Restoration/ Addition, Minneapolis, MN; Hudson River Astor Estate Renovation, Rhinebeck, NY; Enchanted Island Modern Residence, Minnetrista, MN; Cedar Lake International Style Restoration, Minneapolis, MN; Lake Minnetonka Modern Residence, Woodland, MN; Residential Projects and Cabins in MN, KY, WI, NY, CA and IA; Edgewater Custom Loft, Minneapolis, MN; Rolling Green Organic Modern Residence, Edina, MN

PLANFORCE COMMERCIAL
INTERIORS, LLC

4931 West 35th Street

St. Louis Park, MN 55416

Tel: (952) 541-9969

Fax: (952) 541-9554

Email: info@planforcegroup.com

www.planforcegroup.com

PLANFORCE
COMMERCIAL
INTERIORS

Contact: Weld Ransom, (952) 512-9547

Firm Principal

Weld Ransom, CID

PlanForce Commercial Interiors is a business devoted to design and service excellence for clients in the commercial office, healthcare, retail and manufacturing industries across the Midwest. We work collaboratively with real estate brokers, developers, business owners and tenants to successfully address the specific space needs, timing, and economic factors that are present in each design project. Our design work promotes worker safety, productivity, comfort and beauty in the commercial setting. This is the power of interior design at work.

Representative Projects

Blue Belt Technologies, Plymouth, MN; Zimmer Spine, Edina, MN; Nick's Wraps-City Café, Bloomington, MN; New Reflections/ Aveda Salon, Plymouth, MN; Electro Mechanical, Plymouth, MN; Fairview-Xerxes Clinic, Bloomington, MN

POPE ARCHITECTS, INC.

POPE ARCHITECTS

1295 Bandana Blvd. North, Suite 200
St. Paul, MN 55108
Tel: (651) 642-9200
Fax: (651) 642-1101
Email: elarson@popearch.com
www.popearch.com
Contact: Erica Larson, CID, AAID, LEED
AP BD+C, Director of Interior Design

Firm Principals

Jon R. Pope, AIA
Paul A. Holmes, AIA, LEED AP
Randal L. Peek, AIA, NCARB, CID
Ward M. Isaacson, AIA, LEED AP
Thomas B. Kuck, AIA, LEED AP
Tim D. Casey, AIA, NCARB, CID, LEED AP BD+C

Pope Architects is an established design firm located in St. Paul with a national practice. We bring a wealth of design experience and sound business practices together to create beautiful, sustainable and compelling building environments. Pope Architects has a diverse practice encompassing healthcare, commercial, senior housing, behavioral health and community design. Our interior design team delivers high quality services to our clients in all practice areas.

Representative Projects

C.H. Robinson Eden Bluff Tech Center, Eden Prairie, MN; Summit Orthopedics Medical Center, Vadnais Heights, MN; 71 France Mixed-Use Development, Edina, MN; PrairieCare Children's Psychiatric Hospital, Brooklyn Park, MN; Bielenberg Sports Center Expansion, Woodbury, MN; Pioneer-Endicott Apartments, St. Paul, MN; WesleyLife The Cottages, Pella, IA; North Memorial Minnetonka Clinic, Minnetonka, MN

SHEA



10 South 8th Street
Minneapolis, MN 55402
Tel: (612) 339-2257
Email: info@sheadesign.com
www.sheadesign.com
Contact: Jason Dvorak

continued next column

Firm Principals

David Shea
Tanya Spaulding

Shea is a design and marketing firm that creates consumer experiences using a seamless integration of brand development, architecture, interior design, graphic design and marketing communications. Shea develops creative and effective design solutions by using every point of contact, and works with clients in the areas of restaurant/hospitality, retail and corporate office.

Representative Projects

Union & Union Rooftop; Brasserie Zentrol / Foreign Legion; Marin; Lunds & Byerly's Kitchen, Lunds Penfield; Hot Mama; Macy's; RBC Plaza; International Plaza

SKD ARCHITECTS, INC.



11140 Highway 55, Suite A
Plymouth, MN 55441
Tel: (763) 591-6115
Fax: (763) 591-6119
Email: kleineman@skdarchitects.com
www.skdarchitects.com

Contact: Steven A. Kleineman

Firm Principal

Steven A. Kleineman, AIA, CID

SKD is both an architecture and interior design based company, providing a range of interior design services to both residential and commercial clients. As architects and interior designers we are known for our detailing. We understand the initial client goals and design aesthetic. Creative skill paired with our understanding of materials, has been refined over 37 years. Our work reflects a creative fresh look at how finish materials are used to enhance the architectural design.

Representative Projects

Cambria Gallery Rochester, Rochester, MN; Friedland Residence, Wayzata, MN; Cambria Gallery on 7th, Minneapolis, MN; Davisco History Center & Corporate Office Addition, LeSueur, MN; Equitable Acceptance Corporation, Minnetonka, MN; Twin City Fan Corporate Offices addition, Plymouth, MN; Interlachen Circle Residence, Edina, MN; Cambria Suite, Target Field, Minneapolis, MN

STUDIO HIVE, INC.

901 North 3rd Street, Suite 228
Minneapolis, MN 55401
Tel: (612) 279-0430
Fax: (612) 279-0439
Email: info@studiohive.com
www.studiohive.com
Contact: Shawn Gaither

Firm Principals

Shari Bjork, LEED AP
Shawn Gaither, AIA, LEED AP
Janice Carleen Linster, FASID, CID, LEED AP

Studio Hive is an architectural and interior design firm with a focus on the design of the interior environment. We perceive space as a business tool that expresses brand identity, inspires and motivates its occupants, and influences the working, learning, and living experiences of its users.

Representative Projects

Coffman Memorial Student Center, Minneapolis, MN; Hennepin County, Multiple Locations; JE Dunn Construction, Minneapolis, MN; Larkin Hoffman Attorneys, Minneapolis, MN; Minnesota Multipurpose Stadium, Minneapolis, MN; UCare, Minneapolis, MN; University of Minnesota 17th Ave Housing, Minneapolis, MN; Western National Insurance, Edina, MN

TKDA



444 Cedar Street,
Suite 1500
Saint Paul, MN 55101
Tel: (651) 292-4400
Fax: (651) 292-0083
Email: dean.johnson@tkda.com

www.tkda.com

Other Offices: Duluth, MN; Chicago, IL;
Contact: Dean Johnson, AIA, CID

Firm Principals

Dean Johnson, AIA, CID
Ken Johnson, AIA, CID
Kathryn Poore-Larson, AIA, CID
Elizabeth Samsa, IIDA, CID

continued next column

TKDA is an employee-owned architecture, interior design, planning, and engineering firm with Minnesota offices in Saint Paul and Duluth. More than 200 employees deliver solutions nationwide to clients seeking single source, integrated services. TKDA interior design services are award-winning and serve public and private sector clients.

Representative Projects

Flint Hills North Office Building, Inver Grove Heights, MN; Metro Transit Control Center Remodeling, Minneapolis, MN; Bethune Community School Remodeling, Minneapolis, MN; Flint Hills Lab Renovation and Expansion, Rosemount, MN; Interior Renovation Fire Hall #1, Duluth, MN; NorShor Historic Theatre Rehabilitation, Duluth, MN; North Shore Community School, Duluth, MN; Duluth International Airport Terminal, Duluth, MN

WCL ASSOCIATES, INC.

4931 West 35th Street, Suite 200
St. Louis Park, MN 55416
Tel: (952) 541-9969
Email: dave.c@wcla.com
www.wcla.com

Firm Principals

Dave Clark, AIA, LEED AP
Paul Dahl, AIA
Paul Anderson, AIA

WCL has a history of working with real estate developers to redevelop and release older buildings. WCL has created effective office environments that project and reinforce the company's brand and image.

Representative Projects

Remax Results, Hennepin; Sanctuary SalonSpa; Leeann Chin, Ridgedale; Peoples Organic, Wayzata; Reflections Printing; Remax Results, Edina; Erbert & Gerberts Sandwich Shop

Pohlad Companies
Page 24

Location: Minneapolis, Minnesota
 Client: Pohlad Companies
 Owner's project manager: Cushman & Wakefield
 Architect: HGA Architects and Engineers
 Principal-in-charge: Dan Avchen, FAIA
 Project lead designer: Joan M. Soranno, FAIA
 Project manager: Debbi Barnes
 Project architect: John Cook, FAIA
 Project team: Doug Gerlach, AIA; Rob Good, AIA; Michael Koch, AIA; Matt Hart; Paula Storsteen; Ariane Laxo
 Structural, mechanical, and electrical engineer: HGA Architects and Engineers
 Lighting design: Schuler and Shook
 Interior design: HGA Architects and Engineers
 General contractor: RJM Construction
 Art glass: Architectural Glass Art
 Stair, railings, and glass doors: M.G. McGrath/All Metro Glass (AMG)
 Cabinetwork/millwork: Wilkie Sanderson
 Flooring systems/materials: Grazzini Brothers (terrazzo); Chilewich (vinyl floor)
 Venetian plaster: Armourcoat
 Furniture systems: Herman Miller (open offices); Nucraft (private offices); Intereum (vendor)
 Ceilings: Armstrong; Barrisol (translucent ceiling)
 Photographer: Paul Crosby

Bayer Healthcare, Phase 1
Page 29

Location: Coon Rapids, Minnesota
 Client: Bayer AG
 Architect: Architectural Alliance
 Principal-in-charge: Peter Vesterholt, AIA
 Project lead designer: Tom DeAngelo, FAIA
 Project designer/architect: Ross Naylor, AIA
 Interior designer: Deb Gil
 Project team: Carrie Bly, Assoc. AIA; David Bower; Marcelo Pinto, AIA; Amber Sausen, Assoc. AIA; Jon Stone, AIA; Charlie Vowels
 Owner's representative: CBRE
 Energy modeling: Dunham Associates (2011); CRB (2012)
 Structural engineer: Meyer Borgman Johnson
 Mechanical and electrical engineer: Dunham Associates
 Lighting design: Dunham Associates
 Interior design: Architectural Alliance
 General contractors: PCL Construction (2011); McGough (2012)
 Lab casework: Innovative Laboratory Systems, Inc.
 Ceiling: Twin City Acoustics, Inc. (Armstrong, USG, and Acoustigreen products)
 Tile: Dal-tile
 Flooring systems/materials: Patcraft
 Flooring subcontractor: Becker Brothers
 Window systems: W.L. Hall Company
 Concrete polishing work: Gopher State Cleaning
 Millwork: Commercial Fixtures, Inc.
 Branding: Art Partners Group
 Furniture manufacturers: Steelcase; Coalesse
 Furniture dealer: General Office Products
 Photographer: Paul Crosby

Mono
Page 32

Location: Minneapolis, Minnesota
 Client: Mono
 Architect: AWH Architects with Lazor Office
 Principals-in-charge: Charlie Lazor, Assoc. AIA, and Alex Haecker, AIA
 Project lead designers: Charlie Lazor, Assoc. AIA, and Alex Haecker, AIA
 Project manager: Alex Haecker, AIA
 Project architect: Alex Haecker, AIA
 Project team: Dan Gruel and Kyle Snyder
 Lighting design: Gallina Design
 Interior design: AWH Architects and Lazor Office
 General contractor: RJM Construction
 Timberwork: WD Flooring; Finishing Touch Builders
 Metal canopy: Stern Drywall
 Photographer: Chad Holder

Outsell
Page 36

Location: Minneapolis, Minnesota
 Client: Outsell
 Architect: Gensler
 Design team: Bill Lyons, Assoc. AIA; Betsy Vohs, Assoc. AIA; Courtney Armstrong; Jason Hall; Amy Barthel; Kate Levine, AIA; Mark Spencer, AIA
 Lighting and interior design: Gensler
 General contractor: Gardner Builders
 Stone: CD Tile & Stone
 Cabinetwork and millwork: Artifex Millwork
 Flooring systems/materials: Interface; Chilewich
 Window systems: Pollack Drapery
 Drapery system: Cascade Coil
 Concrete work: Concrete Arts
 Photographer: Jasper Sanidad

Braemar Hills Modern
Page 44

Location: Edina, Minnesota
 Clients: Linda Soranno and Howard Bolter
 Architect: Peterssen/Keller Architecture
 Principal-in-charge: Lars Peterssen, AIA
 Project manager and lead designer: Carl Olson, Assoc. AIA
 Project architect: Lars Peterssen, AIA
 Project team: Lars Peterssen, AIA; Carl Olson, Assoc. AIA; Gabriel Keller, Assoc. AIA; Brent Nelson, Assoc. AIA
 Interior design: Andrew Flesher Interiors
 Lighting design: Schuler Shook
 Structural engineer: Mattson Macdonald Young
 General contractor: Streeter & Associates
 Cabinetry: Braaten Creative Woods
 Venetian plaster and cerused walnut: Otto Painting Design
 Fireplace metalwork: Custom Stainless Steel
 Flooring systems/materials: Du Chateau
 Window systems: Western Window Systems
 Decorative glass: Glass Art Design
 Fireplace: Spark Modern Fires
 Wood-fired pizza oven: Mugnaini Medio 110
 Appliances: SubZero; Wolf; Miele; Bosch; Fisher Paykel
 Countertops: Granite Creations (Calacatta marble); Innovative Surfaces (Corian)
 Lighting: Lucifer; Halo
 Photographer: Karen Melvin Photography

Contact these advertisers
for more information on
the products and services
they offer.

AIA Contract Documents	C3
AIA Minneapolis Merit Awards	16
AIA Minnesota	18
AIA Minnesota Convention & Exhibit	22
Aia-mn.org	48
AKF Group	59
Borgert Products, Inc.	8
Commercial Aquatic Engineering	55
<i>Directories of Interior Architecture & Interior Design</i>	60-73
Form/Focus Studios	56
Francois & Co.	C2
Gaffer Photography	49
Gausman & Moore	50

Historic Park Inn	54
Chad Holder Photography	59
Homes by Architects Tour	19
Knutson Construction	1
Marvin Windows & Doors	C4
Minnesota Architectural Foundation	58
Minnesota Brick & Tile	10
Minnesota Ceramic Tile Industry	57
MSR	52
Sarah Nettleton Architects	51
Northwest Architectural Archives	55
Orijin Stone	6
Quigley Architects	59
Rehkamp Larson	49

RJM Construction	54
Room & Board	12
Rubin Cordaro Design	58
SALA Architects	56
Schuler Shook	53
Morgan Sheff Photography	51
Ryan Siemers Architectural Filmmaker & Photographer	14
SKD Architects	48
Brandon Stengel - Farm Kid Studios	52
Stonwerk	50
Synergy Products	4
Laurel Ulland Architecture	53

When Bang Brewing owners **Jay and Sandy Boss Febbo** (seated) arrive at their year-old facility in an industrial area of St. Paul's St. Anthony neighborhood, they often find handprints on the glass garage door—from passersby who stopped to peer into the highly distinctive building. Those handprints tell you everything you need to know about the special appeal of this 1,300-square-foot agrarian charmer, designed by weeHouse creator **Geoff Warner**, AIA (standing), and built by Stinson Builders. And the motivations underlying the design are every bit as compelling as the building itself.

"We originally wanted to repurpose an existing space, because sustainability is a big deal for us," says Sandy. "When we determined to pursue a build, we wanted, as much as we could, to keep our material use down. So when the idea to do a grain bin hit the table in the brainstorming session with Geoff and his team, Jay immediately said, 'Yes!' It just made so much sense. We're a hyper-local brewery, and brewing organically and having that visual tie to the Midwestern farm . . . it was the perfect design solution in every way."

PHOTOGRAPH BY COREY GAFFER

We built a better way to access AIA Contract Documents.



THE FREEDOM TO WORK ON YOUR TERMS

Transform the way you access, edit, and manage design and construction documents and forms with ACD5.

- Create, share, and edit over 180 contracts and forms online with a Mac or PC
- Get editable contracts as you need them — one at a time, bundles of documents, or unlimited use of the entire AIA portfolio of documents
- Easily save and manage your personal custom clauses and templates for future use

Find out the benefits of working on your terms at aia.org/contractdocs.

AIA Contract Documents®
Powered by **ACD5**



**HANDCRAFTED
IN AMERICA**

Ultimate Sliding French Door (12 rated), Pine Interior,
Ashley Norton Satin Nickel handle sets,
Ultimate Casement Awning (12 rated), Pine Interior,
Custom windows created by Marvin Signature Services

Builder: Michael K. Walker & Associates Inc.
Architect: Sweet Sparkman Architects

SUPERIOR CRAFTSMANSHIP TURNS BLUEPRINTS INTO BEAUTIFUL SPACES.

At Marvin, we can make your creative vision a reality through attention to detail, four generations of experience, and a commitment to quality and service. From concept to installation, we work as your partner to create a window as unique as your imagination. Experience the Marvin difference at MARVIN.COM



Built around you.®

To explore creative solutions for your next project, contact your local, independent Marvin dealer today.

MARVIN DESIGN GALLERY by Shaw/Stewart

645 Johnson St. NE
Minneapolis, MN 55413
612-331-3128
MDGbySS.com

Arrow Building Centers

15 Locations
Minnesota and Wisconsin
651-439-3138
ABC-CLC.com

Automated Building Components Millwork Division

Chanhassen, MN 55317
952-937-9060
ABCMillwork.com

Custom Millwork, Inc.

2298 N 2nd St.
North Saint Paul, MN 55109
651-770-2356
CustomMillworkInc.com

Dakota County Lumber

28 8th St.
Farmington, MN 55024
651-460-6646
DakotaCountyLumber.com

Fullerton Lumber The Builder's Choice

Ellsworth - 715-273-5032
Glencoe - 320-864-5103
Osceola - 715-294-2000
Watertown - 952-955-2237
FullertonLBR.com

Glenbrook Lumber & Supply

5215 Gershwin Ave. N
Oakdale, MN 55128
651-770-9071
GlenbrookLumber.com

Hamel Building Center

18710 Hwy. 55
Plymouth, MN 55446
763-478-6601
HamelBuildingCenter.com
MN LIC #BC631040

Hiawatha Lumber Co.

3233 E 40th St.
Minneapolis, MN 55406
612-729-2358
HiawathaLumber.com

Lampert Lumber

Apple Valley - Lake Elmo
North Branch - Northfield
Rockford - St. Croix Falls
651-695-3600
LampertLumber.com

McCarron's Building Center

23840 Lake Blvd.
Forest Lake, MN 55025
651-464-5427
McCarronsBuildingCenter.com

Scherer Bros. Lumber Co.

Arden Hills
Hopkins
Shakopee
952-938-2741
SchererBros.com

Spring Lake Park Lumber

8329 Central Ave. NE
Minneapolis, MN 55432
763-784-3062
SLPLumber.com